

STATE OF ILLINOIS  
DEPARTMENT OF TRANSPORTATION

F.A.P. RTE.	SECTION	COUNTY	TOTAL SHEETS	SHEET NO.
322	11-1	CHRISTIAN	437	129
STA.		TO STA.		
FED. ROAD DIST. NO.		ILLINOIS	FED. AID PROJECT	

SE 1/4 SEC 23, T12N, R1E, 3RD PM

PARCEL NO 6069120 A & B  
CLARADO FAMILY LIMITED  
PARTNERSHIP, AN ILLINOIS  
LIMITED PARTNERSHIP  
SEE TABULATIONS ON SHEET 10

FAP 322 CURVE \*SMI DATA  
PI STA = 495+42.92  
 $\Delta = 00^\circ 39' 51''$  (LT)  
D = 00° 07' 57"  
R = 43,200.00'  
T = 250.40'  
L = 500.80'  
E = 0.73'  
SE = NONE  
PC STA = 492+92.51  
PT STA = 497+93.31

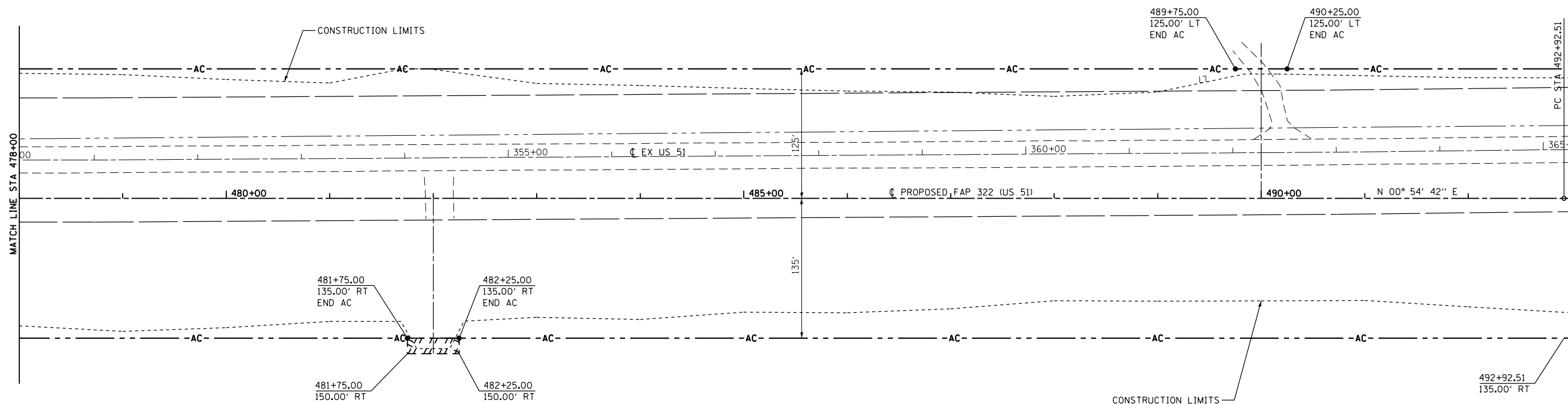

PARCEL NO 6069121 & TE  
GRACE P. FRIBLEY  
SEE TABULATIONS ON SHEET 10

SW 1/4 SEC 24, T12N, R1E, 3RD PM

NOTES:  
BEARINGS ARE BASED ON THE ILLINOIS STATE PLANE  
COORDINATE SYSTEM, NAD83 1986 - WEST ZONE  
SURVEYED IN ENGLISH.

PLAT DISTANCES AND STATIONING ARE IN GRID ENGLISH.  
TO CONVERT TO GROUND DIVIDE BY GRID FACTOR.  
GRID FACTOR = 1.00003150

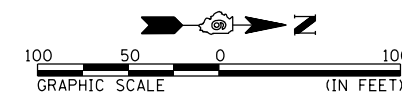

RIGHT OF WAY PLANS

ROUTE F.A.P. 322 (US 51)  
SECTION 11-1  
PROJECT  
COUNTY CHRISTIAN  
JOB NO. R-96-008-95  
STA 478+00 TO STA 493+00  
SCALE 1 = 50'