

NOTES:

- ALL REGULATORY SIGNS & MAILBOXES THAT INTERFERE WITH CONSTRUCTION OPERATIONS MUST BE MOVED AND RE-INSTALLED AT A DIFFERENT LOCATION AS DIRECTED BY THE ENGINEER.
- ALL OTHER SIGNS THAT INTERFERE WITH CONSTRUCTION OPERATIONS MAY BE REMOVED THROUGH THE DURATION OF THE WORK AND RE-INSTALLED AT THE SAME LOCATION UPON THE COMPLETION OF THE WORK.
- THE CONTRACTOR SHALL BE RESPONSIBLE FOR REPLACING ANY SIGN PANEL, SIGN POST, MAILBOX, OR MAILBOX POST THAT IS DAMAGED DURING THE REMOVAL/RE-INSTALLATION PROCESS.
- SEE THE PRIVATE ENTRANCE DETAILS SHEET FOR THE NORTH AND SOUTH ENTRANCE.

SEC 19, T5N, R8W, 4TH PM

PATRICK EWING
PARCEL NO. 6298102

MARY C. SIBBING
PARCEL NO. 6298101

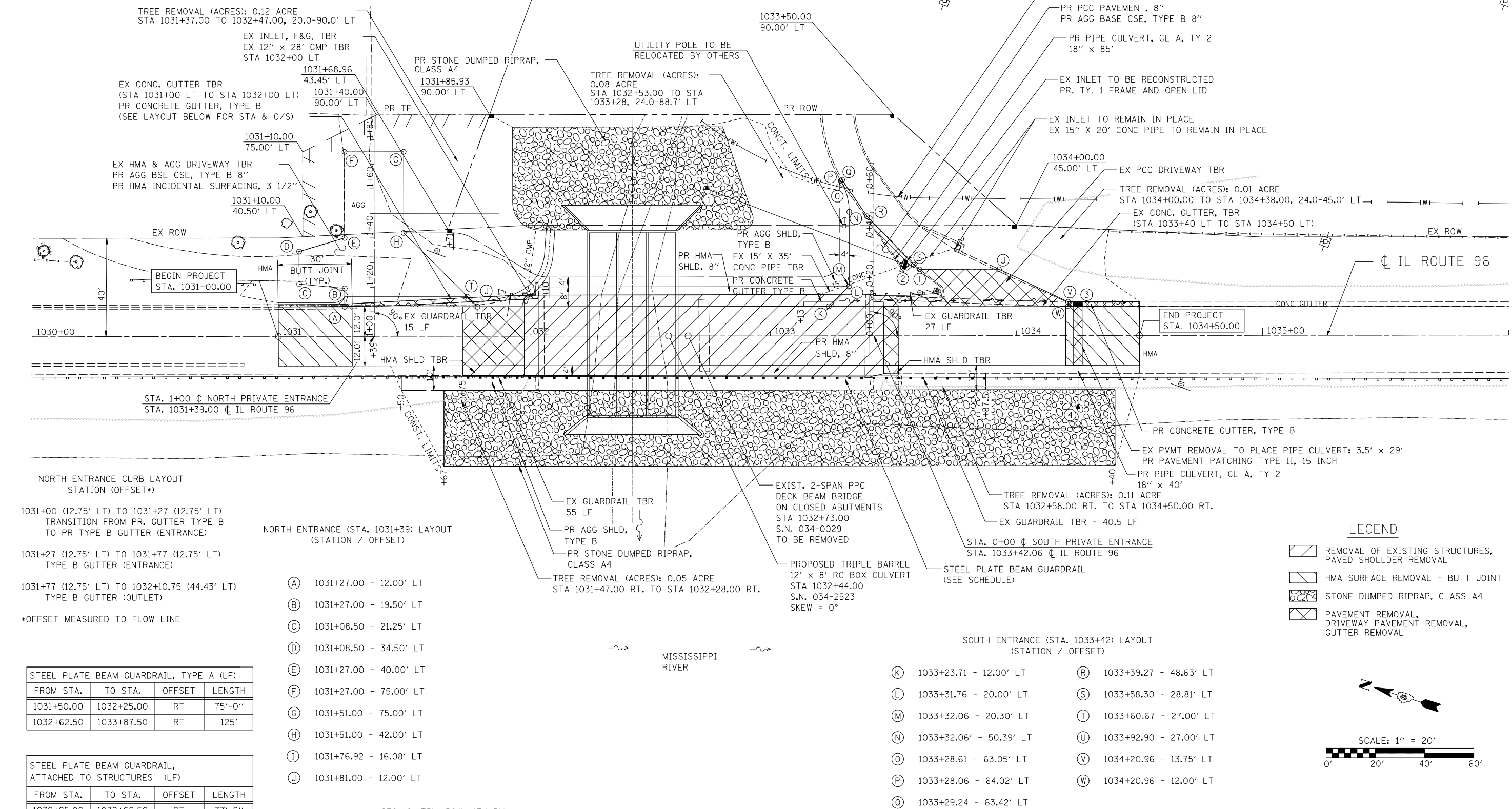

- NORTH ENTRANCE CURB LAYOUT STATION (OFFSET*)**
- 1031+00 (12.75' LT) TO 1031+27 (12.75' LT) TRANSITION FROM PR. GUTTER TYPE B TO PR TYPE B GUTTER (ENTRANCE)
 - 1031+27 (12.75' LT) TO 1031+77 (12.75' LT) TYPE B GUTTER (ENTRANCE)
 - 1031+77 (12.75' LT) TO 1032+10.75 (44.43' LT) TYPE B GUTTER (OUTLET)
- *OFFSET MEASURED TO FLOW LINE

- NORTH ENTRANCE (STA. 1031+39) LAYOUT (STATION / OFFSET)**
- (A) 1031+27.00 - 12.00' LT
 - (B) 1031+27.00 - 19.50' LT
 - (C) 1031+08.50 - 21.25' LT
 - (D) 1031+08.50 - 34.50' LT
 - (E) 1031+27.00 - 40.00' LT
 - (F) 1031+27.00 - 75.00' LT
 - (G) 1031+51.00 - 75.00' LT
 - (H) 1031+51.00 - 42.00' LT
 - (I) 1031+76.92 - 16.08' LT
 - (J) 1031+81.00 - 12.00' LT

STEEL PLATE BEAM GUARDRAIL, TYPE A (LF)			
FROM STA.	TO STA.	OFFSET	LENGTH
1031+50.00	1032+25.00	RT	75'-0"
1032+62.50	1033+87.50	RT	125'

STEEL PLATE BEAM GUARDRAIL, ATTACHED TO STRUCTURES (LF)			
FROM STA.	TO STA.	OFFSET	LENGTH
1032+25.00	1032+62.50	RT	37'-6"

LEGEND

- REMOVAL OF EXISTING STRUCTURES, PAVED SHOULDER REMOVAL
- HMA SURFACE REMOVAL - BUTT JOINT
- STONE DUMPED RIPRAP, CLASS A4
- PAVEMENT REMOVAL, DRIVEWAY PAVEMENT REMOVAL, GUTTER REMOVAL

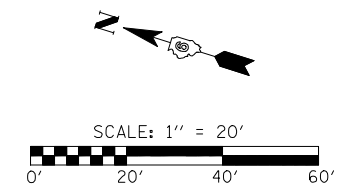

SEC 19, T5N, R8W, 4TH PM



USER NAME = Plotted by Roadways7	DESIGNED - SGL	REVISED -
PLOT SCALE = 40.0000' / IN.	DRAWN - SGL	REVISED -
PLOT DATE = 10/19/2012	CHECKED - FML	REVISED -
	DATE - 9/2012	REVISED -

**STATE OF ILLINOIS
DEPARTMENT OF TRANSPORTATION**

IL ROUTE 96 OVER INLET DITCH ROADWAY PLAN		
SCALE: 1"=20'	SHEET NO. 01 OF 01 SHEETS	STA. 1030+00.00 TO STA. 1036+00.00

F.A.P. RTE.	SECTION	COUNTY	TOTAL SHEETS	SHEET NO.
510	120B-3	HANCOCK	38	19
FED. ROAD DIST. NO. 6 ILLINOIS FED. AID PROJECT			CONTRACT NO. 72B67	