

LIGHTING GENERAL NOTES

1. CONTRACTOR SHALL BE RESPONSIBLE TO COORDINATE ELECTRICAL WORK WITH OTHER TRADES.
2. LIGHT POLE FOUNDATIONS SHALL BE INSTALLED PLUMB AND FLUSH WITH THE PROPOSED GRADE AND SHALL MEET THE HEIGHT REQUIREMENTS OF ARTICLE 836.03 OF THE STANDARD SPECIFICATIONS. AFTER UNIT DUCT IS INSTALLED, FOUNDATIONS SHALL BE FILLED WITH FINE AGGREGATE ACCORDING TO ARTICLE 836.03. WASHERS USED TO INSATLL THE POLE SHALL BE LARGE ENOUGH TO FULLY COVER THE SLOTTED HOLES IN THE POLE BASE PLATE.
3. THE CONTRACTOR IS RESPONSIBLE FOR UNCOVERING OR HAND DIGGING AROUND UTILITIES AS NECESSARY. THE COST OF THIS WORK IS TO BE INCLUDED WITH THE UNIT DUCT PAY ITEM.
4. LUMINAIRES SHALL BE ORIENTED WITH OPTICS PERPENDICULAR TO THE CENTERLINE OF THE ROADWAY AS REQUIRED BY ARTICLE 821.04 OF THE STANDARD SPECIFICATIONS.
5. ALL LIGHTING WORK SHOWN ON THE PLANS SHALL BE INSTALLED AND MADE OPERATIONAL PRIOR TO COMMENCEMENT OF CONSTRUCTION.
6. ALL LIGHTING CIRCUITS FED FROM THE EXISTING CONTROLLER SHALL REMAIN OPERATIONAL DURING CONSTRUCTION.
7. NO POLE TO BE INSATLLED IN THE FLOWLINE OF DITCH. POLE SETBACK TO BE INCREASED IF NECESSARY AS DIRECTED BY THE ENGINEER, NOT TO EXCEED 20 FEET.
8. THE CONTRACTOR SHALL PLACE A COPY OF AS-BUILT PLANS INSIDE THE EXISTING LIGHTING CONTROLLER.

P.C. STA. = 114+74.80
P.T. STA. = 118+08.99

	1.0 EA.	RELOCATE EXISTING LIGHTING UNIT
	260.0 FT.	UNIT DUCT, 600V, 2-1C NO.4, 1/C NO.6 GROUND, (XLP-TYPE USE), 1" DIA. POLYETHYLENE
	1.0 EA.	LIGHT POLE FOUNDATION, METAL, 15" BOLT CIRCLE, 8" X 6"
	1.0 EA.	REMOVAL OF POLE FOUNDATION

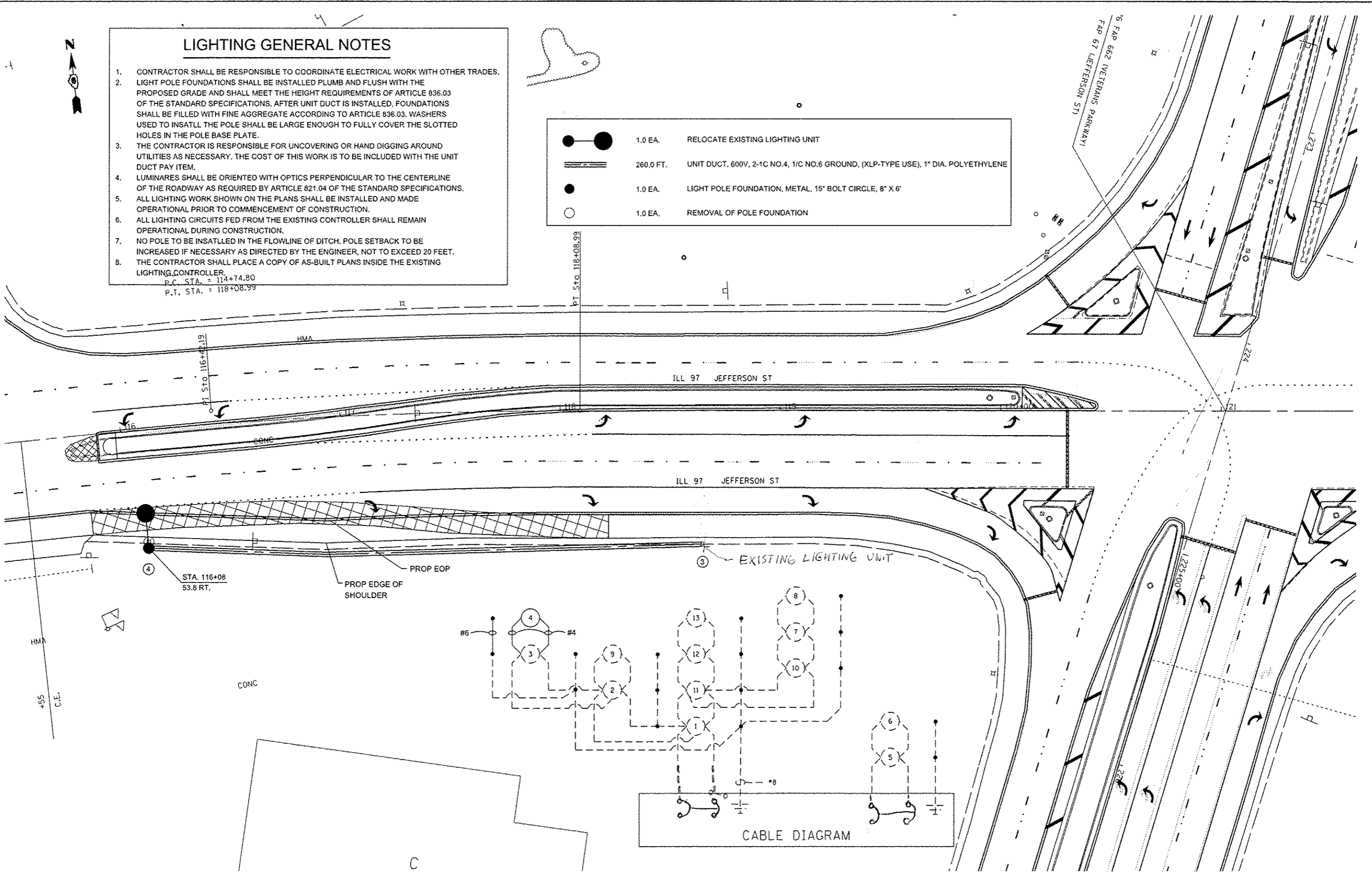

FILE NAME *	USER NAME * sporksgv	DESIGNED -	REVISED -	STATE OF ILLINOIS DEPARTMENT OF TRANSPORTATION	LIGHTING PLAN SHEET FAP 67 (IL 97)			F.A.P. RTE.	SECTION	COUNTY	TOTAL SHEETS	SHEET NO.	
Default	ct:\pvc\work\p\idot\sporksgv\d0290859\72f23-shd-light.dgn	DRAWN -	REVISED -		SCALE:	SHEET	OF	SHEETS	STA.	TO STA.	SANGAMON	116	88
	PLOT SCALE * 40.0000' / in.	CHECKED -	REVISED -									CONTRACT NO.	72F23
	PLOT DATE * Oct-19-2012 03:56:20PM	DATE -	REVISED -									[ILLINOIS] FED. AID PROJECT	