

LOCATION #1  
EFFINGHAM COUNTY  
STRUCTURE 025-0083

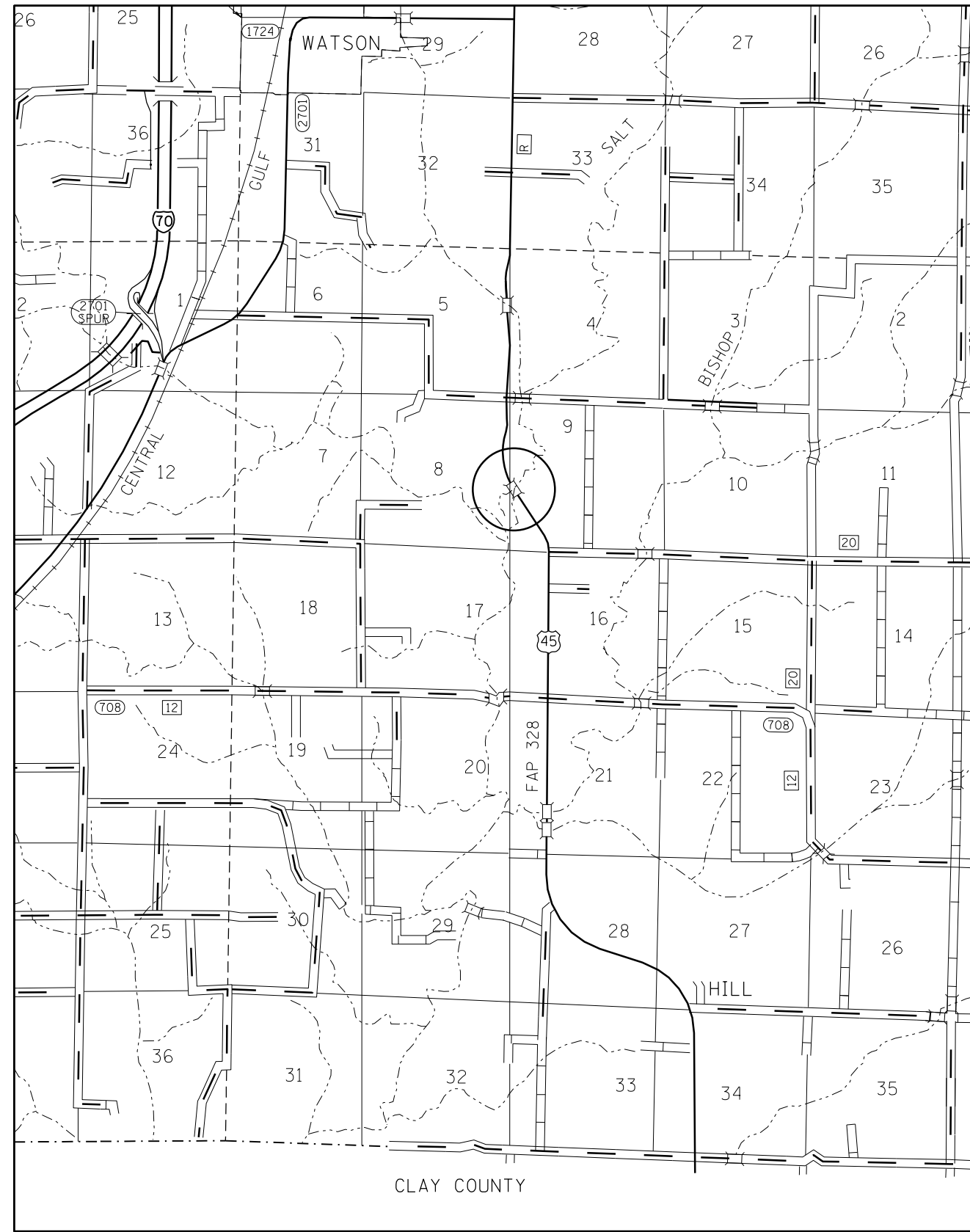

LOCATION #2  
FAYETTE COUNTY  
STRUCTURES 026-0009 (EB) & 026-0010 (WB)

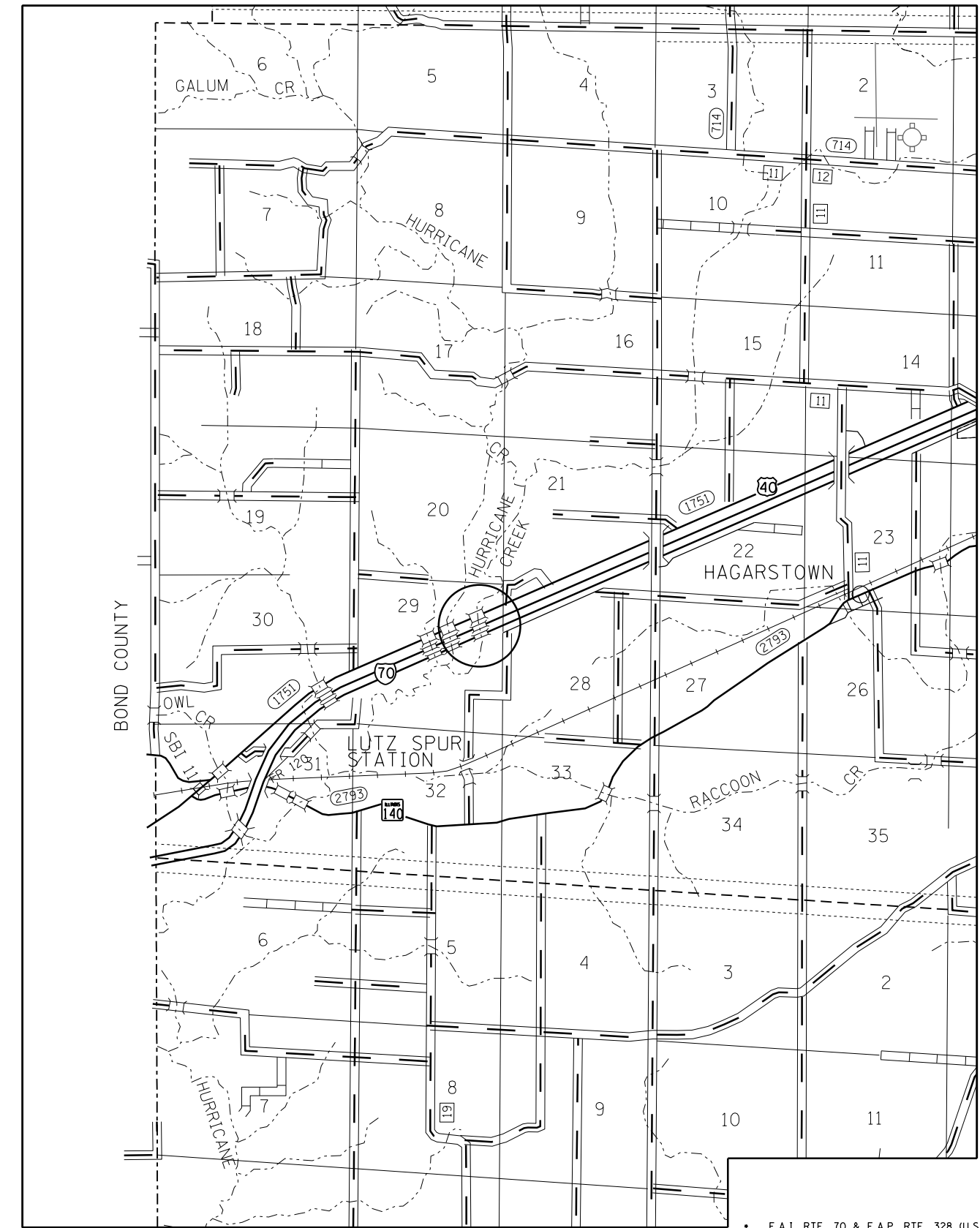

FILE NAME =	USER NAME = steffenmk	DESIGNED -	REVISED -
ct:\pw\work\p\dot\steffenmk\d0307265\0774579-sht-location.dgn		DRAWN -	REVISED -
Default	PLOT SCALE = 100.0000' / in.	CHECKED -	REVISED -
	PLOT DATE = 10/23/2012	DATE -	REVISED -

STATE OF ILLINOIS  
DEPARTMENT OF TRANSPORTATION

LOCATION MAPS			
SCALE: N/A	SHEET 1	OF 1 SHEETS	STA. TO STA.

F.A. RTE.	SECTION	COUNTY	TOTAL SHEETS	SHEET NO.
•	07 BRIDGE PAINTING 2013-	••	11	4
CONTRACT NO. 74579				
ILLINOIS FED. AID PROJECT				

•• F.A.I. RTE. 70 & F.A.P. RTE. 328 (U.S. RTE. 45)  
FAYETTE & EFFINGHAM COUNTIES