

RAMP 1
SEE SHEET 17
MATCH LINE
STA 107+00.00

MATCH LINE STA 471+00.00

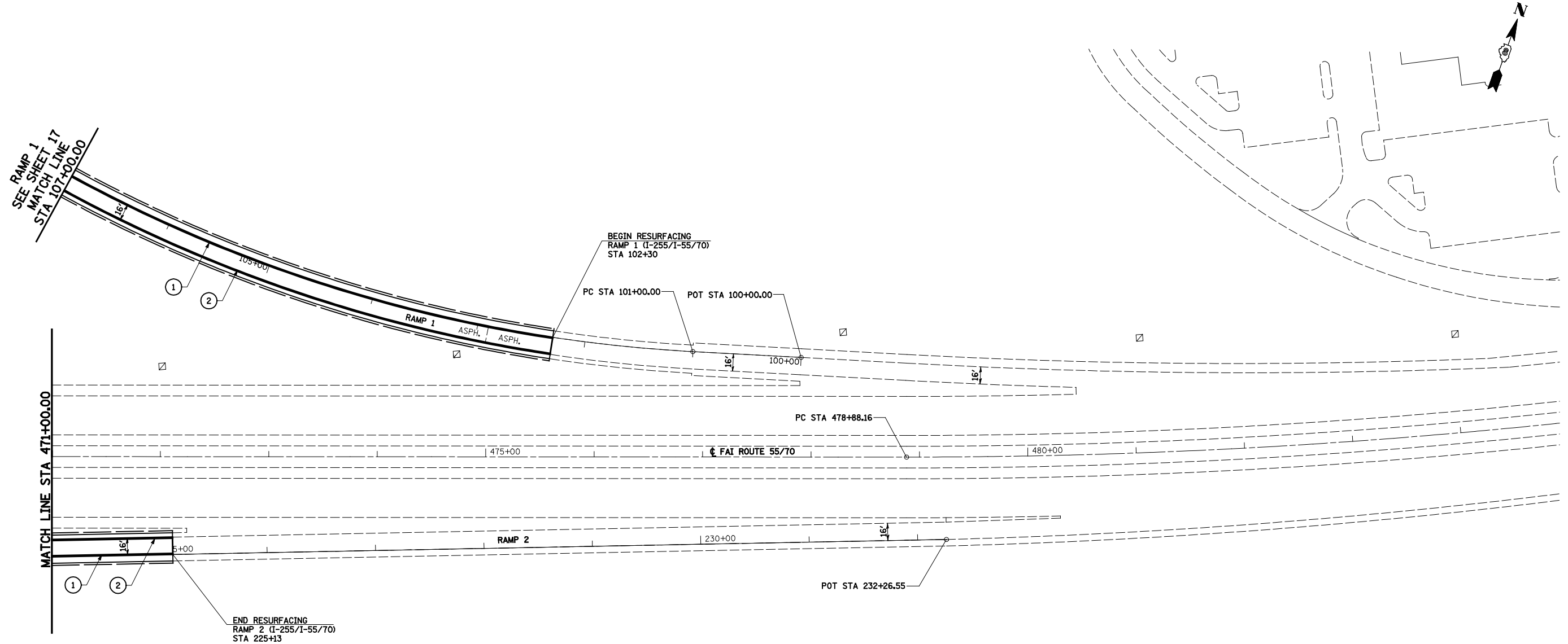

BEGIN RESURFACING
RAMP 1 (I-255/I-55/70)
STA 102+30

END RESURFACING
RAMP 2 (I-255/I-55/70)
STA 225+13

LEGEND

- ① PREFORMED PLASTIC PAVEMENT MARKING, TYPE B INLAID LINE - 4" SOLID WHITE
- ② PREFORMED PLASTIC PAVEMENT MARKING, TYPE B INLAID LINE - 4" SOLID YELLOW
- ③ PREFORMED PLASTIC PAVEMENT MARKING, TYPE B INLAID LINE - 4" SKIP DASH WHITE
- ④ PREFORMED PLASTIC PAVEMENT MARKING, TYPE B INLAID LINE - 8" SOLID WHITE
- ⑤ PREFORMED PLASTIC PAVEMENT MARKING, TYPE B INLAID LINE - 8" SKIP DASH WHITE
- ⑥ RAISED REFLECTIVE PAVEMENT MARKERS - CRYSTAL, ONE-WAY
- ⑦ RAISED REFLECTIVE PAVEMENT MARKERS - AMBER, ONE-WAY



FILE NAME = #FILEL#	USER NAME = Paul	DESIGNED - JWS	REVISED -	STATE OF ILLINOIS DEPARTMENT OF TRANSPORTATION	RAMP PAVEMENT MARKING AND SIGNING PLANS, FAI ROUTE 255			F.A.I. RTE. 255	SECTION 60-(7,8)RS-2	COUNTY MADISON	TOTAL SHEETS 261	SHEET NO. 112			
					SCALE: 1"=50'			SHEET NO. 16 OF 22 SHEETS			STA. 471+00.00 TO STA. 484+80.00		CONTRACT NO. 76A89		
					ILLINOIS FED. AID PROJECT										
PLOT SCALE = 100.0000' / IN.		CHECKED - BRM	REVISED -												
PLOT DATE = 7/31/2012		DATE - 7-27-11	REVISED -												