

8/24/2012 10:06:57 PM - G:\CHIN\013\Bridges\CADD\060-0216&0217-76A89-08 - South.Abnt Exp.Joint.dgn

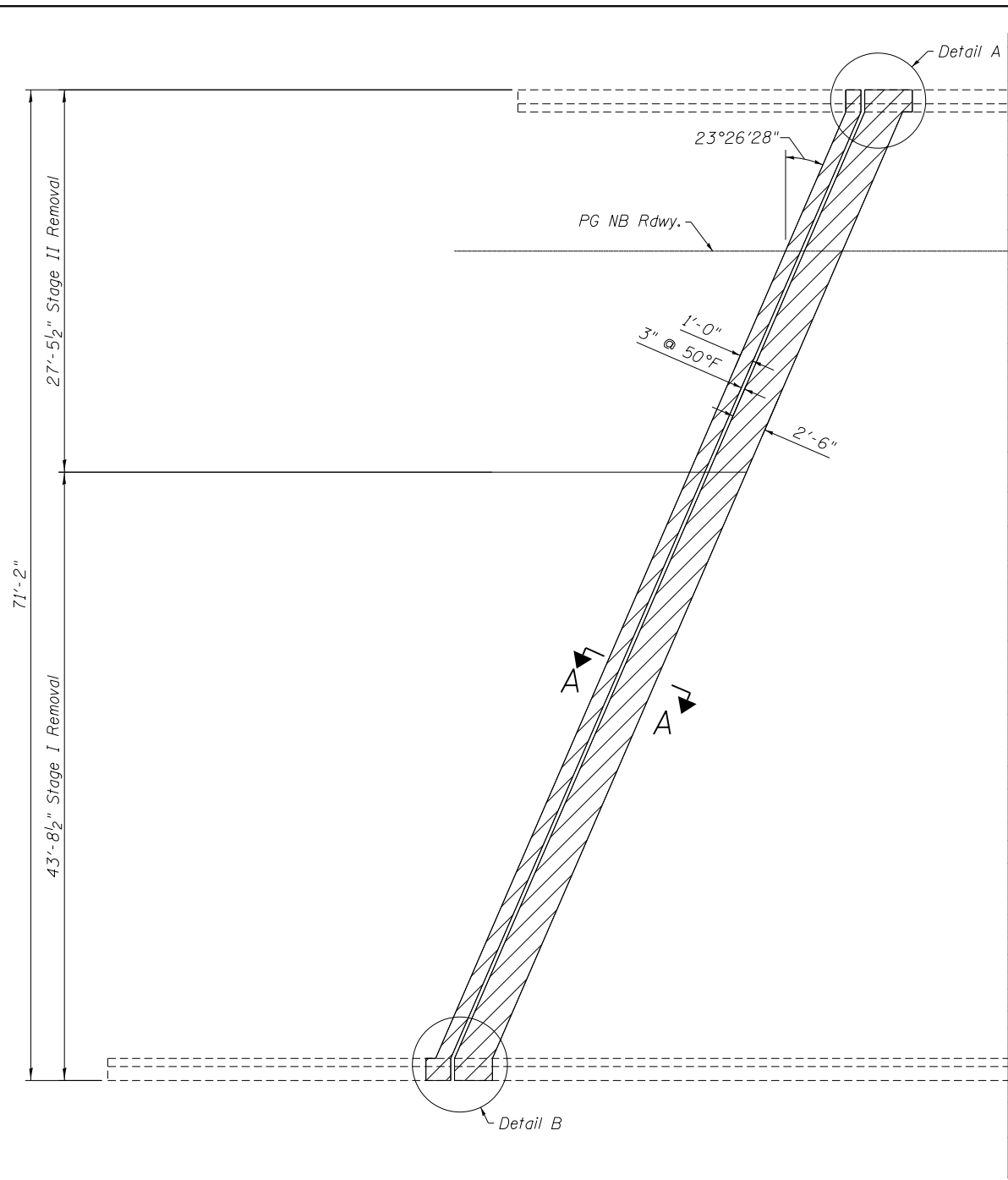

CONCRETE REMOVAL
(NB South Abutment shown)
(SB South Abutment similar)

MIN. LAP
#5 Bar 2'-7" Min. Lap.

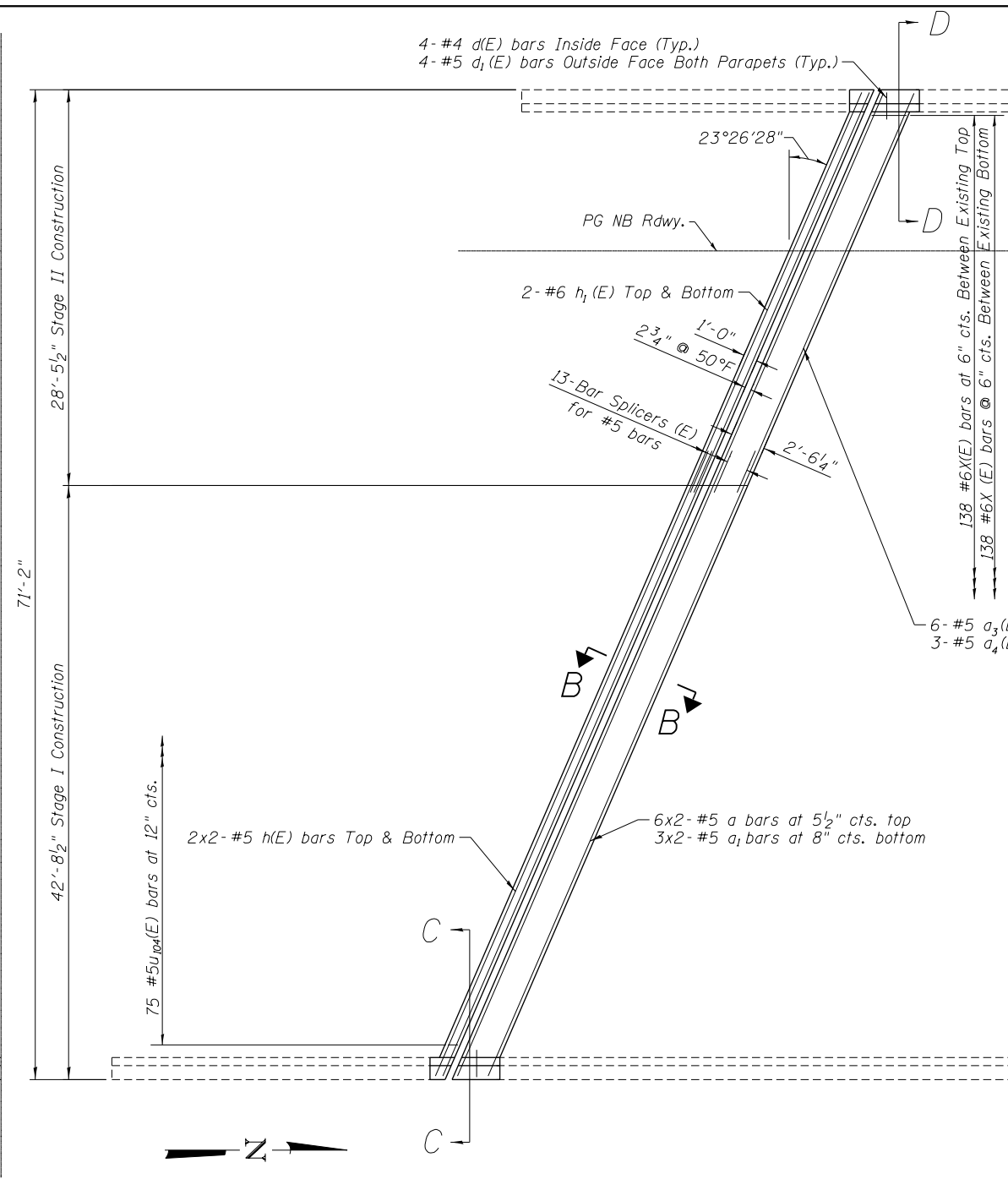

CONCRETE REPLACEMENT
(NB South Abutment shown)
(SB South Abutment similar)

- NOTES:**
- Existing reinforcement extending into the removal area shall be cleaned, straightened and incorporated into the new construction. Any reinforcement bars that are damaged during concrete removal shall be replaced with an approved bar splicer or anchorage system. Cost shall be included with Concrete Removal.
 - Trim existing reinforcement to accommodate proposed expansion joint.
 - See sheet 9 for section A-A, B-B, C-C and D-D.
 - Bars indicated thus: "4x2-#5 etc...", indicates 4 lines of bars with 2 lengths per line.
 - Protective coat applied to new concrete and top and face of parapets.

BILL OF MATERIAL

Item	Unit	Total
Concrete Removal	Cu. Yd.	25.6
Concrete Superstructure	Cu. Yd.	28.5
Protective Coat	Sq. Yd.	66

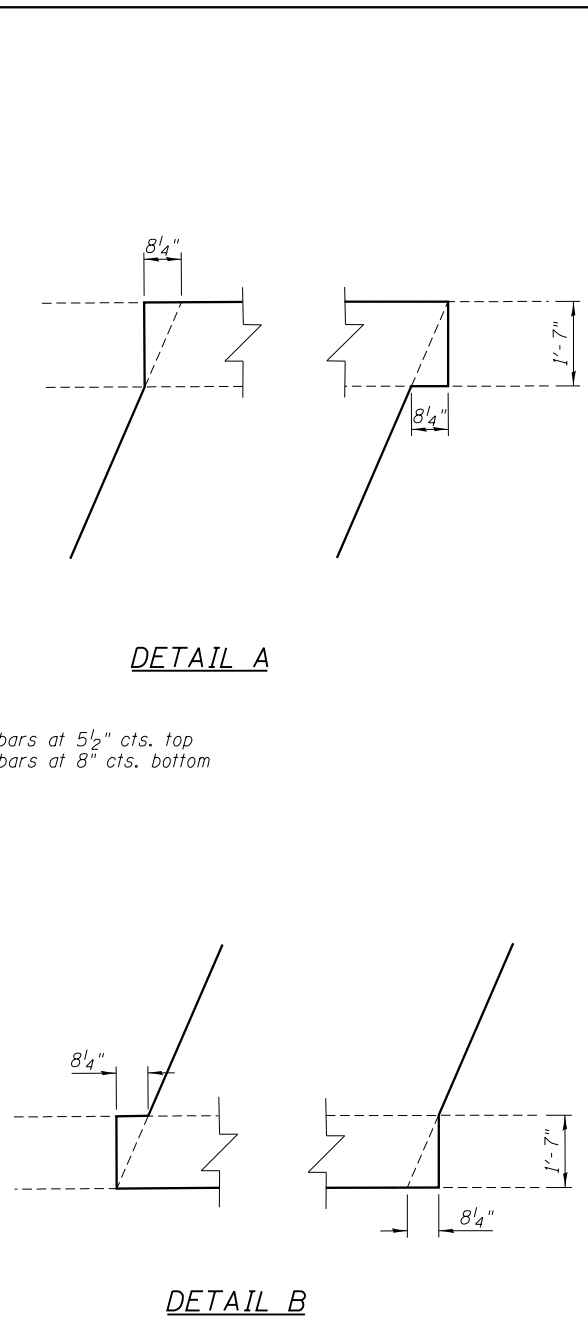

DETAIL A

DETAIL B

LEGEND

	Concrete Removal
--	------------------

FILE NAME = 0600216&0217-76A89-08 - South.Abnt Exp.Joint.dgn



USER NAME = DMG01010	DESIGNED - WAE	REVISED -
PLOT SCALE = 1/8" = 1'-0"	CHECKED - FAS	REVISED -
PLOT DATE = 8/24/2012	DRAWN - DMG	REVISED -
	CHECKED - SLZ	REVISED -

**STATE OF ILLINOIS
DEPARTMENT OF TRANSPORTATION**

**SOUTH ABUTMENT EXPANSION JOINT CONCRETE
REMOVAL AND REPLACEMENT N.B. AND S.B.
STRUCTURE NO. 060-0216 & 060-0217**

SHEET NO. 8 OF 14 SHEETS

F.A.I. RTE.	SECTION	COUNTY	TOTAL SHEETS	SHEET NO.
255	60-(7,8) RS-2	MADISON	261	251
ILLINOIS FED. AID PROJECT			CONTRACT NO. 76A89	