

DATE	
BY	
FINAL SURVEY	SURVEYED
NOTE BOOK	PLOTTED
NO.	TEMPLATE
	AREAS
	CHECKED
	AREAS
	CHECKED

DATE	
BY	
ORIGINAL SURVEY	SURVEYED
NOTE BOOK	PLOTTED
NO.	TEMPLATE
	AREAS
	CHECKED
	AREAS
	CHECKED

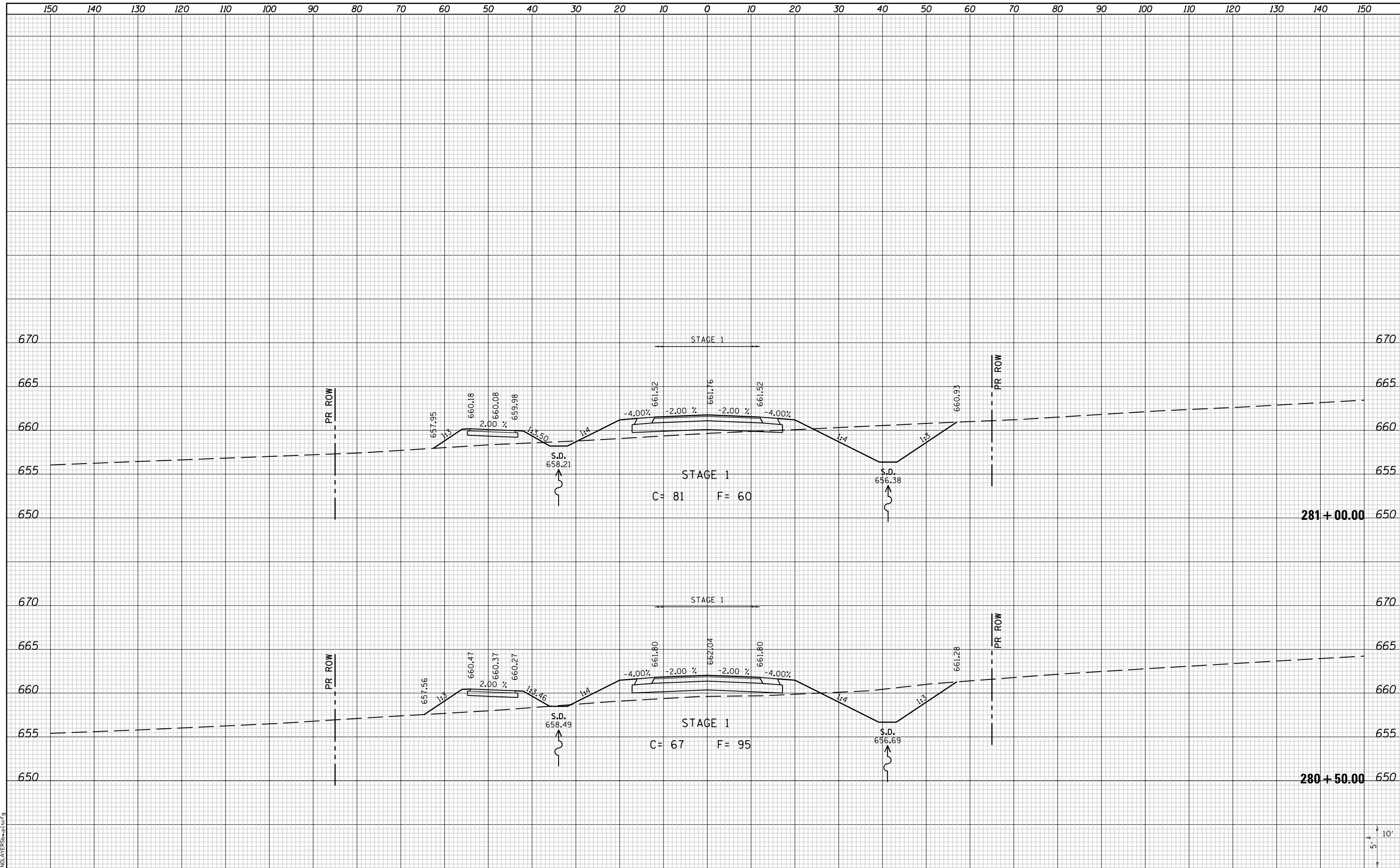

LAST SAVED = 10/3/2012
 PEN TABLE = 161-Half.tbl
 PLOT DRIVER = PdfPlotterSpw.bat

FILE NAME = I:\1001100\Phase II - 76F51\Cad\T\Plans\100.0876F51-sht-Relocated.Vandebrook-Dr-xssht.dgn	USER NAME = jepettibone	DESIGNED -	REVISED -
PLOT SCALE = 20.0000' / in.	PLOT DATE = 10/4/2012 5:11:47 PM	DRAWN -	REVISED -
		CHECKED -	REVISED -
		DATE -	REVISED -

STATE OF ILLINOIS
 DEPARTMENT OF TRANSPORTATION



SCALE: 10H:5V
 SHEET NO. 13 OF 31 SHEETS
 STA. 280+50.00 TO STA. 281+00.00

CROSS SECTIONS
 RELOCATED VANDEBROOK DRIVE

F.A.U. RTE.	SECTION	COUNTY	TOTAL SHEETS	SHEET NO.
9324	68-R-1	MONROE	192	122
CONTRACT NO. 76F51			ILLINOIS FED. AID PROJECT	