

PLAN

* Tilt #9 b102(E) bars as required to maintain clearance.
 ** Space between a113(E) bars, typ. each parapet.

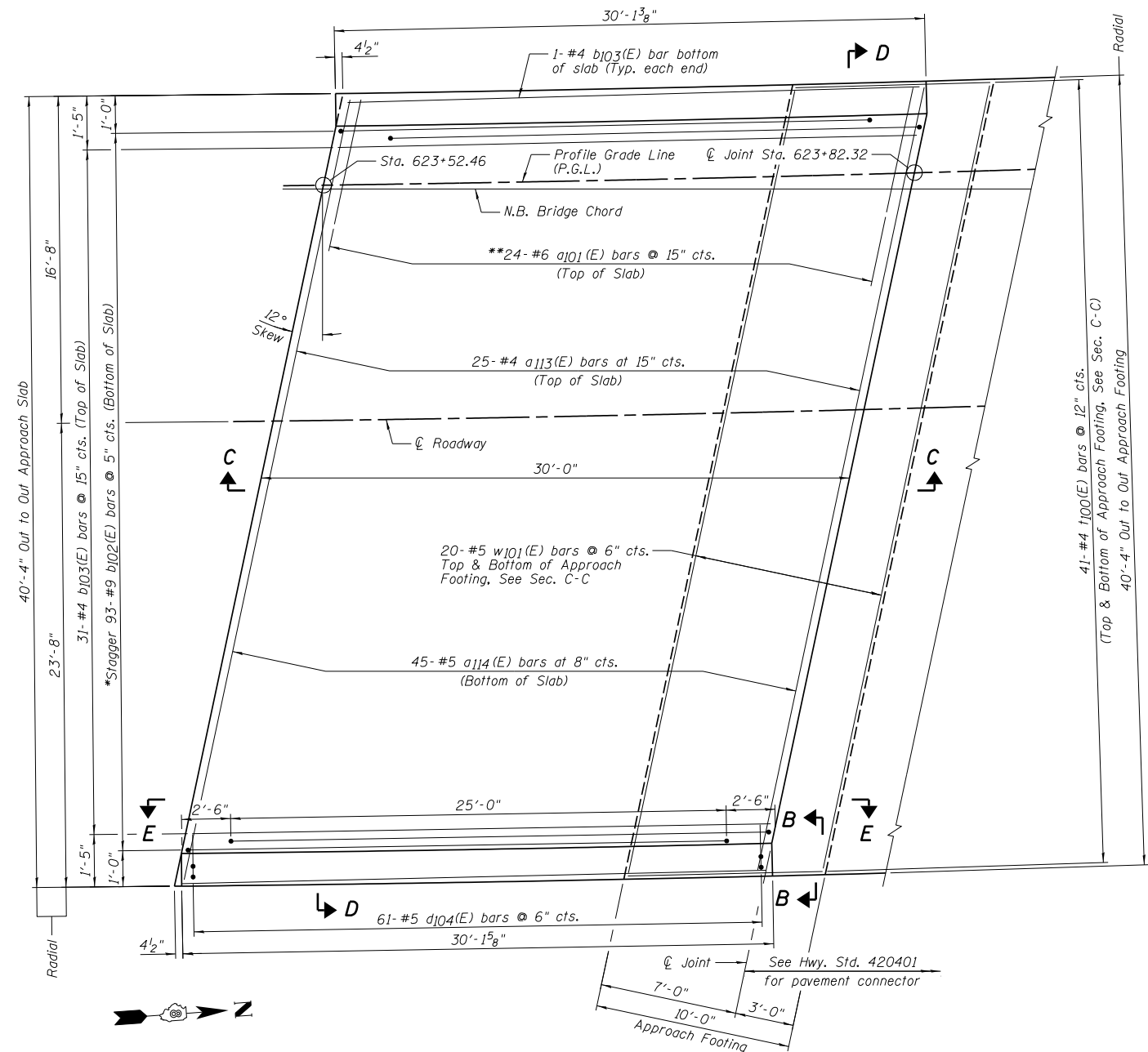

PLAN

* Tilt #9 b102(E) bars as required to maintain clearance.
 ** Space between a113(E) bars, typ. each parapet.

NOTES:

- 1.) See Sheet A23 for Sections C-C & D-D and Views B-B & E-E.
- 2.) a113(E) and a114(E) bar spacings measured along ϕ Rdwy.



DESIGNED - TCR/JCZ	REVISED
CHECKED - JML	REVISED
DRAWN - DJM/JWK	REVISED
CHECKED - MSW	REVISED
DATE - 06/26/12	

**STATE OF ILLINOIS
 DEPARTMENT OF TRANSPORTATION**

**BRIDGE APPROACH SLAB DETAILS, NORTHBOUND ROADWAY
 STRUCTURE NO. 082-0385 NB & 082-0386 SB**

SHEET NO. A22 OF 48 SHEETS

F.A.P. RTE.	SECTION	COUNTY	TOTAL SHEETS	SHEET NO.
788	520-1-2B	ST. GLAIR	94	53
CONTRACT NO. 76F69			ILLINOIS FED. AID PROJECT	