

DATE	
BY	
FINAL SURVEY	SURVEYED
NOTE BOOK	PLOTTED
NO.	TEMPLATE
	AREAS CHECKED

DATE	
BY	
ORIGINAL SURVEY	SURVEYED
NOTE BOOK	PLOTTED
NO.	TEMPLATE
	AREAS CHECKED

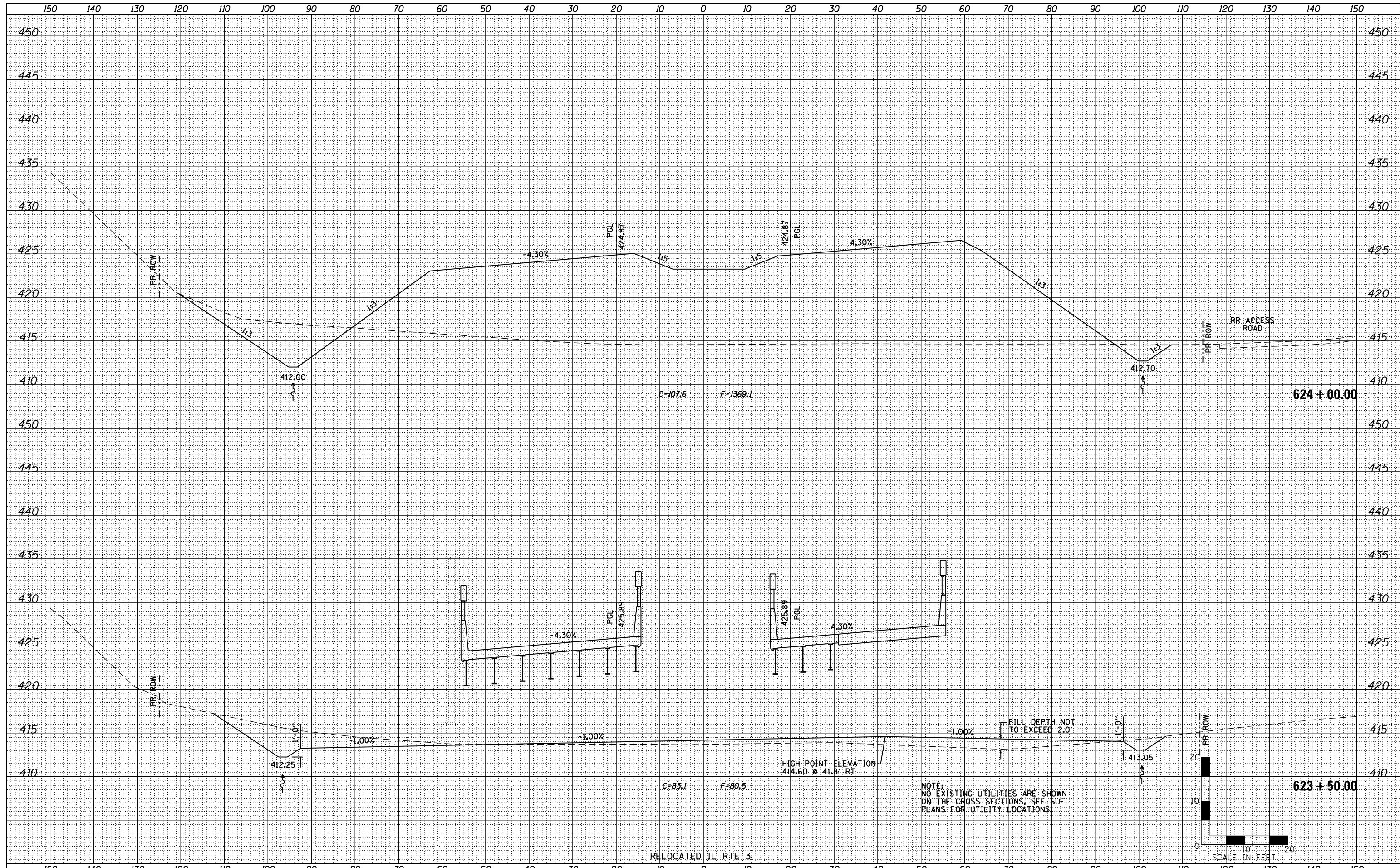

**Farnsworth GROUP INC.**  
 2709 McGraw Drive  
 Bloomington, Illinois 61704  
 309/663-8435, 309/663-1571 fax

USER NAME = jochaner	DESIGNED - JJ0	REVISED -
	DRAWN - JJ0	REVISED -
PLOT SCALE = 1/2" = 20.0000' / in.	CHECKED - PJM	REVISED -
PLOT DATE = 7/29/2012	DATE - 06/26/12	REVISED -

**STATE OF ILLINOIS  
 DEPARTMENT OF TRANSPORTATION**

**CROSS SECTIONS**

SCALE: SHEET NO. OF SHEETS STA. 623+50.00 TO STA. 624+00.00

F.A.P. RTE.	SECTION	COUNTY	TOTAL SHEETS	SHEET NO.
788	520-1-2B	ST. CLAIR	94	82
CONTRACT NO. 76F69				
ILLINOIS FED. AID PROJECT				