

PAGE NO.	INDEX OF SHEETS
1	TITLE SHEET
2	GENERAL NOTES & SUMMARY OF QUANTITIES
3-4	TYPICAL SECTIONS
5-7	SCHEDULE OF QUANTITIES
8	DETAILS
9-10	PLAN SHEETS
11-12	STRIPING DETAILS
13-14	CITY OF MOLINE DETAILS
15	IDOT STD 91.2 ROUGH GROOVED SURFACE SIGN
16	IDOT STD. 94.2 TRAFFIC CONTROL AND PROTECTION AT TURN BAYS (TO REMAIN OPEN TO TRAFFIC)

ILLINOIS HIGHWAY STANDARDS	
000001-06	STANDARD SYMBOLS, ABBREVIATIONS, PATTERNS
001001-02	AREAS OF REINFORCEMENT BARS
001006	DECIMAL OF INCH & FOOT
280001-07	TEMPORARY EROSION CONTROL SYSTEMS
424001-07	PERPENDICULAR CURB RAMPS
424006-01	DIAGONAL CURB RAMPS
424011-01	CORNER PARALLEL CURB RAMPS
442101-07	CLASS B PATCHES
602401-03	MANHOLE TYPE A
604001-03	FRAME & LIDS TYPE 1
606001-05	CONCRETE CURB TYPE B & COMBINATION CONCRETE CURB & GUTTER
701006-04	OFF-ROAD OPERATIONS, 2L, 2W, 15' TO 24" FROM PV EDGE
701011-03	OFF-ROAD MOVING OPERATIONS, 2L, 2W, DAY ONLY
701501-06	URBAN LANE CLOSURE 2L2W - UNDIVIDED
701601-08	URBAN LANE CLOSURE MULTILANE 1W2W & NONTRANSVERSABLE MEDIAN
701602-06	URBAN LANE CLOSURE MULTILANE, 2W WITH BIDIRECTIONAL LEFT TURN LANE
701606-08	URBAN LANE CLOSURE MULTILANE 2W, MOUNTABLE MEDIAN
701701-08	URBAN LANE CLOSURE MULTILANE INTERSECTION
701801-05	SIDEWALK CORNER OR CROSSWALK CLOSURE
701901-02	TRAFFIC CONTROL DEVICES
720001-01	SIGN PANEL MOUNTING DETAILS
720006-03	SIGN PANEL ERECT DETAILS
720011-01	METAL POSTS FOR SIGNS, MARKERS, & DELINEATORS
728001-01	TELESCOPING STEEL SIGN SUPPORT
729001-01	APPLICATIONS OF TYPES A & B METAL POSTS
780001-03	TYPICAL PAVEMENT MARKINGS
781001-03	RAISED REFLECTIVE PAVEMENT MARKERS

STATE OF ILLINOIS
DEPARTMENT OF TRANSPORTATION
PLANS FOR
PROPOSED LOCAL AGENCY IMPROVEMENT
URBAN PROJECT

FAU 5773 (AVENUE OF THE CITIES)
SECTION 12-00253-00-RS
ROCK ISLAND COUNTY
PROJECT NO M-5074(091)

CITY OF MOLINE
JOB NO. C-92-119-12
CONTRACT 85567

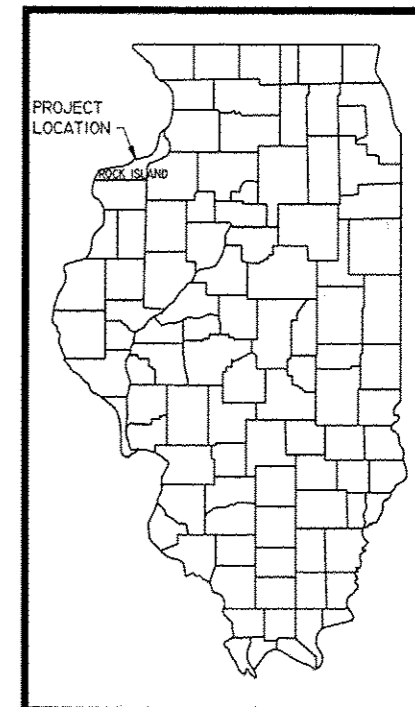

PROJECT LOCATION
AVE. OF THE CITIES
AND 41ST ST.

PROJECT LIMITS (41ST ST)
STA. 39+20

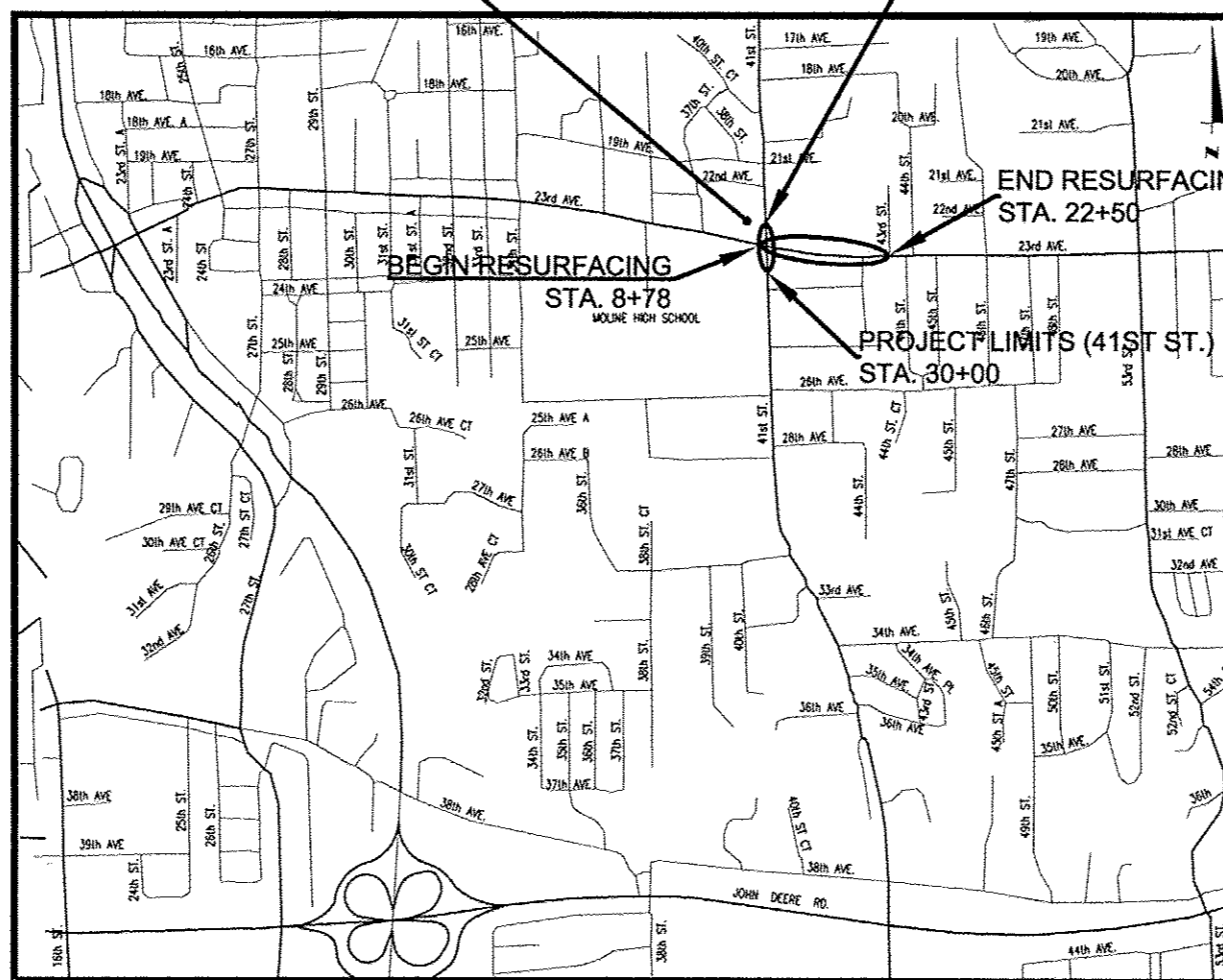

PROJECT LENGTH: AVE. OF THE CITIES: 1,372' (0.260 mi)
41ST STREET: 845' (0.160 mi)

CALL J.U.L.I.E.
BEFORE YOU DIG
1-800-892-0123

UTILITIES

THE FOLLOWING UTILITY COMPANIES MAY HAVE UTILITIES LOCATED ON THIS PROJECT:

- MID AMERICA GAS AND ELECTRIC COMPANY
- SBC - AMERITECH - TELEPHONE
- MEDIACOM CABLE T.V.
- CITY OF MOLINE WATER DEPT.
- STREET DEPT.
- WATER POLLUTION CONTROL DEPT.
- ELECTRICAL MAINTENANCE DEPT.

CONTRACTOR SHALL CALL J.U.L.I.E. TO CONTACT ALL UTILITY COMPANIES WHICH MAY HAVE FACILITIES IN THE AREA OF CONSTRUCTION AND OBTAIN THE EXACT LOCATION OF THESE FACILITIES.

FOR FIELD LOCATIONS CALL J.U.L.I.E. AT 1-800-892-0123.

URBAN ARTERIAL
ADT (2012) = 22,544
TRUCKS = 2.3%

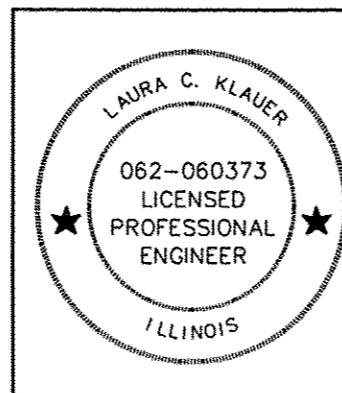

I HEREBY CERTIFY THAT THESE PLANS WERE PREPARED BY ME OR UNDER MY DIRECT PERSONAL SUPERVISION AND THAT I AM A DULY REGISTERED PROFESSIONAL ENGINEER UNDER THE LAWS OF THE STATE OF ILLINOIS.

Laura Klauer 10/23/12
LAURA C. KLAUER P.E.
LICENSE NO. 062-060373 DATE EXPIRES 11-30-13

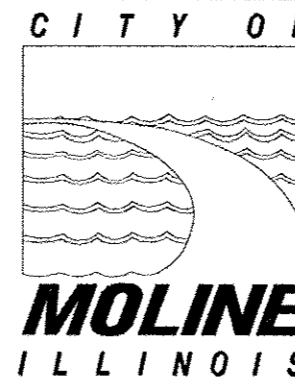

APPROVED	<i>[Signature]</i>
DATE	10/23/12
	SCOTT HINTON, P.E. CITY ENGINEER
PASSED	<i>[Signature]</i>
DATE	Nov. 5, 2012
	DISTRICT 2 ENGINEER OF LOCAL ROADS & STREETS
RELEASED FOR BID BASED ON LIMITED REVIEW	<i>[Signature]</i>
DATE	Nov. 5, 2012
	DEPUTY DIRECTOR OF HIGHWAYS, REGION 2 ENGINEER

85567

SUMMARY OF QUANTITIES - CONSTRUCTION TYPE CODE: 0005

NO.	ITEM	UNIT	80/20 FED FUND QUANTITY	NON-PARTICIPATING QUANTITY	TOTAL QUANTITY
Δ 20800150	TRENCH BACKFILL	CY	-	66	66
40600100	BITUMINOUS MATERIALS (PRIME COAT)	GAL	1,278	-	1,278
40600400	MIXTURE FOR CRACKS, JOINTS, & FLANGEWAYS	TON	45	-	45
40600827	POLYMERIZED LEVELING BINDER (MACHINE METHOD), IL 4.75, N50	TON	871	-	871
40600990	TEMPORARY RAMP	SY	722	-	722
40603535	POLYMERIZED HOT-MIX ASPHALT SURFACE COURSE MIX D N50	TON	1,789	-	1,789
42300300	PORTLAND CEMENT CONCRETE DRIVEWAY PAVEMENT 7 INCH	SY	147	-	147
42400100	PORTLAND CEMENT CONCRETE SIDEWALK 4 INCH	SF	2,265	-	2,265
42400800	DETECTABLE WARNINGS	SF	64	-	64
44000161	HOT-MIX ASPHALT SURFACE REMOVAL, 3"	SY	15,972	-	15,972
44000200	DRIVEWAY PAVEMENT REMOVAL	SY	147	-	147
44000300	CURB REMOVAL	FT	55	-	55
44000500	COMBINATION CURB AND GUTTER REMOVAL	FT	376	-	376
44000600	SIDEWALK REMOVAL	SF	2,066	-	2,066
44200934	CLASS B PATCHES, TYPE II, 8 INCH	SY	64	-	64
44200942	CLASS B PATCHES, TYPE III, 8 INCH	SY	162	-	162
44200944	CLASS B PATCHES, TYPE IV, 8 INCH	SY	552	-	552
Δ 60218400	MANHOLES, TYPE A, 4'-DIAMETER, TYPE 1 FRAME, CLOSED LID	EA	-	1	1
60255500	MANHOLES TO BE ADJUSTED	EA	8	-	8
60260100	INLETS TO BE ADJUSTED	EA	8	-	8
60265700	VALVE VAULTS TO BE ADJUSTED	EA	6	-	6
60266600	VALVE BOXES TO BE ADJUSTED	EA	4	-	4
Δ 60500040	REMOVING MANHOLES	EA	-	1	1
60605100	COMBINATION CURB AND GUTTER, TYPE B6.24 (ABUTTING EXISTING PAVEMENT)	FT	376	-	376
67100100	MOBILIZATION	L.SUM	1	-	1
70300100	SHORT TERM PAVEMENT MARKING	FT	3,621	-	3,621
70301000	WORK ZONE PAVEMENT MARKING REMOVAL	SF	402	-	402
Δ 78000100	THERMOPLASTIC PAVEMENT MARKING - LETTERS AND SYMBOLS	SF	416	-	416
Δ 78000200	THERMOPLASTIC PAVEMENT MARKING - LINE 4"	FT	7,254	-	7,254
Δ 78000400	THERMOPLASTIC PAVEMENT MARKING - LINE 6"	FT	925	-	925
Δ 78000600	THERMOPLASTIC PAVEMENT MARKING - LINE 12"	FT	711	-	711
Δ 78000650	THERMOPLASTIC PAVEMENT MARKING - LINE 24"	FT	275	-	275
Δ 78100100	RAISED REFLECTIVE PAVEMENT MARKER	EA	143	-	143
78300200	RAISED REFLECTIVE PAVEMENT MARKER REMOVAL	EA	143	-	143
Δ 89502210	MODIFY EXISTING CONTROLLER CABINET	EA	1	-	1
X7010216	TRAFFIC CONTROL AND PROTECTION, SPECIAL	L.SUM	1	-	1
X8140115	HANDHOLES TO BE ADJUSTED	EA	3	-	3
Δ XX002119	STORM SEWER, DUCTILE IRON, 18"	FT	-	6	6
XX006343	SEEDING COMPLETE	SY	19	-	19
Δ XX007739	WIRELESS VEHICLE DETECTION SYSTEM	EA	2	-	2
Δ Z0058300	SANITARY SEWER TYPE 1 8 INCH	FT	-	105	105

GENERAL NOTES

"STANDARD SPECIFICATIONS FOR ROAD AND BRIDGE CONSTRUCTION" ADOPTED JAN 1, 2012, THE SUPPLEMENTAL SPECIFICATIONS AND RECURRING SPECIAL PROVISIONS BY THE ILLINOIS DEPARTMENT OF TRANSPORTATION, AND THE SUPPLEMENTAL SPECIFICATIONS BY MOLINE SHALL CONTROL THIS PROJECT.

ALL POINTS OF POSSIBLE CONFLICT WITH UTILITIES ARE TO BE EXCAVATED AS NECESSARY TO VERIFY EXACT LOCATION AND ELEVATION BEFORE COMMENCEMENT OF CONSTRUCTION.

TRAFFIC CONTROL SHALL CONFORM TO THE "MANUAL ON UNIFORM TRAFFIC CONTROL" AND SHALL BE IN ACCORDANCE WITH THE "STANDARD SPECIFICATIONS" AND THE SPECIAL PROVISIONS FOR THIS PROJECT.

THE PRESENCE OF TEMPORARY TRAFFIC CONTROL DRAWINGS OR STANDARDS IN THE PROJECT PLANS, WHETHER A PAY ITEM OR NOT, DOES NOT RELIEVE THE CONTRACTOR OF HIS OBLIGATION TO PROVIDE PROTECTION TO THE PUBLIC IN ACCORDANCE WITH ARTICLE 107.14 OF THE "STANDARD SPECIFICATIONS FOR ROAD AND BRIDGE CONSTRUCTION". FURTHERMORE, THE CONTRACTOR SHALL PROVIDE, TO THE SATISFACTION OF THE ENGINEER, ALL PROTECTION DEEMED NECESSARY BEYOND THAT SHOWN IN THE PLANS OR SPECIAL PROVISIONS. THE EXPENSE OF THIS WORK TO THE CONTRACTOR SHALL BE CONSIDERED INCIDENTAL TO THE LUMP SUM UNIT PRICE OF TRAFFIC CONTROL AND PROTECTION SPECIAL.

ADDITIONAL NOTES:

- 1) CONTRACTOR SHALL RELOCATE AND TEMPORARILY INSTALL MAILBOXES DURING CONSTRUCTION AND PLACE IN ORIGINAL LOCATION AFTER COMPLETION OF CONSTRUCTION. (INCIDENTAL - IF NECESSARY)
- 2) CONTRACTOR SHALL REMOVE AND RE-ERECT ALL SIGNAGE FOR CONSTRUCTION ACTIVITIES. (INCIDENTAL - IF NECESSARY)
- 3) CONTRACTOR SHALL PROVIDE A MINIMUM ONE LANE OF TRAFFIC THROUGH CONSTRUCTION. (PAID FOR BY TRAFFIC CONTROL)
- 4) SIDEWALK AND PAVEMENT NOT MARKED FOR REMOVAL SHALL BE PROTECTED. ANY SIDEWALK OR PAVEMENT DAMAGED DURING CONSTRUCTION SHALL BE REPLACED AT THE CONTRACTOR'S EXPENSE.

AVENUE OF THE CITIES, 41ST TO 43RD STREETS

Mixture Use	Surface	Level Binder	Road Classification	I
PG:	SBS PG 70-22	SBS 70-22	Design Period	20
Design Air Voids	4.0 @ N50	4.0 @ N50	PV = 24,088	SU= 444 MU= 123
Mixture Composition: (Gradation Mixture)	IL 9.5	IL 4.75		
Friction Aggregate	D	N/A		
20 Year ESAL	1.1			
Mixture Weight	112 lbs/sy/in	109 lbs/sy/in		

SYMBOLS LEGEND

EXISTING		PROPOSED
	LIGHT STRUCTURE	
	STREET SIGN	
	BENCH MARK	
	DRAINAGE	
	ROW MARKER	
	LIGHT POLE	
	BUSH	
	EVERGREEN TREE	
	STUMP	
	TREE	
	WATER VALVE	
	CATCH BASIN	
	CLEAN OUT	
	CATCH BASIN SPECIAL	
	FLARED END SECTION	
	FIRE HYDRANT	
	MANHOLE	
	INLET	
	VALVE VAULT	
	GAS VALVE	
	GUY WIRE	
	JUNCTION BOX	
	SERVICE VALVE	
	RAISED REFLECTIVE PAVEMENT MARKERS	
	CONTOURS	
	RETAINING WALL	
	POLE	
	STORM SEWER	
	WATER MAIN	
	SANITARY SEWER	
	RESURFACING AREA	
	CLASS B PATCH	
	CURB REMOVAL OR COMB CC&G REM & REPL	
	SIDEWALK REMOVE & REPLACE	
	DRIVEWAY REMOVE & PCC DRIVE 7"	
	DETECTABLE WARNINGS	

Δ SPECIALTY ITEMS

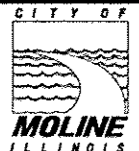

CITY OF MOLINE
DEPARTMENT OF PUBLIC WORKS - ENGINEERING DIVISION
3635 4TH AVENUE, MOLINE, IL 61285
(309) 524-2350
CITY ENGINEER - SCOTT HINTON, P.E.

AVE. OF THE CITIES RESURFACING
41ST TO 43RD STREET & 41ST ST. 24TH AVE. TO 22ND AVE.
SEC. 12-00253-00-RS

Date	09-07-12
Revision	LCK

Date	07-02-12	Sheet	2
Scale	1" = 20'	of	16
Design Engineer	LCK	Contract	85567

85567

20800150	
TRENCH BACKFILL	
STA. 9+08 LT	60.9 C.Y.
TOTAL	61.0 C.Y.

40600100	
BIT MATLS PR CT	
STA. 8+78 - 22+50	823.4 GAL
STA. 30+00 - 33+33	188.8 GAL
STA. 34+08 - 39+20	265.5 GAL
TOTAL	1278.0 GAL

40600400	
MIX CR JTS FLANGEWYS	
VARIOUS LOCATIONS	45.0 TON
TOTAL	45.0 TON

40600827	
P LB MM IL-4.75 N50	
STA. 8+78 - 22+50	561.0 TON
STA. 30+00 - 33+33	128.6 TON
STA. 34+08 - 39+20	180.9 TON
TOTAL	871.0 TON

40600990	
TEMPORARY RAMP	
STA. 8+78 - 8+83 (2 APPLICATIONS)	81.6 S.Y.
STA. 9+43 - 10+46 LT (2 APPLICATIONS)	125.6 S.Y.
STA. 9+50 - 10+63 RT (2 APPLICATIONS)	114.4 S.Y.
STA. 11+55 RT	3.3 S.Y.
STA. 12+12 RT	3.0 S.Y.
STA. 12+59 LT	6.7 S.Y.
STA. 12+89 RT	2.8 S.Y.
STA. 13+43 RT	4.2 S.Y.
STA. 13+50 LT	6.7 S.Y.
STA. 14+67 LT	2.9 S.Y.
STA. 14+93 RT	3.3 S.Y.
STA. 15+56 RT	3.7 S.Y.
STA. 15+63 LT	3.7 S.Y.
STA. 16+16 RT	3.1 S.Y.
STA. 16+23 LT	2.9 S.Y.
STA. 17+27 LT	2.7 S.Y.
STA. 18+62 RT	2.9 S.Y.
STA. 19+75 LT	3.0 S.Y.
STA. 20+05 - 21+30 RT (2 APPLICATIONS)	138.9 S.Y.

40600990	
TEMPORARY RAMP (CONT.)	
STA. 22+23 RT	3.3 S.Y.
STA. 22+23 LT	3.8 S.Y.
STA. 22+45 - 22+50 (2 APPLICATIONS)	71.4 S.Y.
STA. 30+00 - 30+05 (2 APPLICATIONS)	50.8 S.Y.
STA. 31+31 RT	12.8 S.Y.
STA. 31+75 LT	5.3 S.Y.
STA. 36+18 RT	5.0 S.Y.
STA. 37+64 RT	2.8 S.Y.
STA. 37+94 LT	3.9 S.Y.
STA. 38+50 LT	2.7 S.Y.
STA. 38+52 RT	5.1 S.Y.
STA. 39+15 - 39+20 (2 APPLICATIONS)	39.6 S.Y.
TOTAL	722.0 S.Y.

40603535	
P HMA SC "D" N50	
STA. 8+78 - 22+50	1152.8 TON
STA. 30+00 - 33+33	264.3 TON
STA. 34+08 - 39+20	371.8 TON
TOTAL	1789.0 TON

42300300	
PCC DRIVEWAY PAVT 7	
STA. 11+73 RT	12.4 S.Y.
STA. 12+14 RT	20.6 S.Y.
STA. 12+92 RT	20.6 S.Y.
STA. 13+46 LT	7.8 S.Y.
STA. 15+48 RT	2.5 S.Y.
STA. 16+05 RT	3.2 S.Y.
STA. 16+19 LT	19.6 S.Y.
STA. 16+39 RT	1.5 S.Y.
STA. 17+24 LT	14.4 S.Y.
STA. 31+62 RT	31.2 S.Y.
STA. 36+15 RT	12.9 S.Y.
TOTAL	147.0 S.Y.

42400100	
PC CONC SIDEWALK 4	
STA. 11+53 RT	29.5 S.F.
STA. 11+89 RT	168.5 S.F.
STA. 12+37 RT	400.1 S.F.
STA. 13+19 RT	158.5 S.F.

42400100	
PC CONC SIDEWALK 4 (CONT.)	
STA. 13+21 LT	123.4 S.F.
STA. 14+00 LT	81.3 S.F.
STA. 15+97 LT	34.9 S.F.
STA. 16+42 RT	56.5 S.F.
STA. 16+48 LT	40.1 S.F.
STA. 17+73 RT	34.0 S.F.
STA. 18+53 RT	31.8 S.F.
STA. 31+62 LT	107.1 S.F.
STA. 32+19 LT	89.6 S.F.
STA. 33+02 RT	117.0 S.F.
STA. 33+29 LT	114.2 S.F.
STA. 34+03 RT	89.5 S.F.
STA. 34+35 LT	407.8 S.F.
STA. 38+38 RT	73.2 S.F.
STA. 38+96 RT	107.5 S.F.
TOTAL	2265.0 S.F.

42400800	
DETECTABLE WARNINGS	
STA. 9+42 LT	8.0 S.F.
STA. 9+47 RT	8.0 S.F.
STA. 10+49 LT	8.0 S.F.
STA. 10+66 RT	8.0 S.F.
STA. 38+51 RT	8.0 S.F.
STA. 39+00 RT	24.0 S.F.
TOTAL	64.0 S.F.

44000161	
HMA SURF REM 3	
STA. 8+78 - 22+50	10293.0 S.Y.
STA. 30+00 - 33+33	2359.7 S.Y.
STA. 34+08 - 39+20	3319.3 S.Y.
TOTAL	15972.0 S.Y.

44000200	
DRIVE PAVEMENT REM	
STA. 11+73 RT	12.4 S.Y.
STA. 12+14 RT	20.6 S.Y.
STA. 12+92 RT	20.6 S.Y.
STA. 13+46 LT	7.8 S.Y.
STA. 15+48 RT	2.5 S.Y.
STA. 16+05 RT	3.2 S.Y.
STA. 16+19 LT	19.6 S.Y.

44000200	
DRIVE PAVEMENT REM (CONT.)	
STA. 16+39 RT	1.5 S.Y.
STA. 17+24 LT	14.4 S.Y.
STA. 31+62 RT	31.2 S.Y.
STA. 36+15 RT	12.9 S.Y.
TOTAL	147.0 S.Y.

44000300	
CURB REM	
STA. 33+29 LT	19.4 FT
STA. 34+02 RT	19.9 FT
STA. 34+37 LT	16.0 FT
TOTAL	55.0 FT

44000500	
COMB CURB AND GUTTER REM	
STA. 10+53 RT	222.8 FT
STA. 15+43 RT	97.2 FT
STA. 34+24 RT	19.4 FT
STA. 37+98 LT	37.0 FT
TOTAL	376.0 FT

44000600	
SIDEWALK REMOVAL	
STA. 11+53 RT	29.5 S.F.
STA. 11+89 RT	168.5 S.F.
STA. 12+37 RT	400.1 S.F.
STA. 13+19 RT	47.9 S.F.
STA. 13+21 LT	123.4 S.F.
STA. 14+00 LT	81.3 S.F.
STA. 15+97 LT	34.9 S.F.
STA. 16+42 RT	56.5 S.F.
STA. 16+48 LT	40.1 S.F.
STA. 17+73 RT	34.0 S.F.
STA. 18+53 RT	31.8 S.F.
STA. 31+62 LT	107.1 S.F.
STA. 32+19 LT	89.6 S.F.
STA. 33+02 RT	109.2 S.F.
STA. 33+29 LT	104.9 S.F.
STA. 34+03 RT	80.1 S.F.
STA. 34+35 LT	396.4 S.F.
STA. 38+38 RT	52.1 S.F.
STA. 38+96 RT	78.4 S.F.
TOTAL	2066.0 S.F.



CITY OF MOLINE
DEPARTMENT OF PUBLIC WORKS - ENGINEERING DIVISION
3635 4TH AVENUE, MOLINE, IL 61265
(309) 524-2350
CITY ENGINEER - SCOTT HINTON, P.E.

AVE. OF THE CITIES RESURFACING
41ST TO 43RD STREET & 41ST ST. 24TH AVE. TO 22ND AVE.
SEC. 12-00253-00-RS

09-07-12	LCK		
Date	Revision		

Date 07-02-12	Sheet 3
Scale 1" = 20'	of 16
Design Engineer LCK	Contract 85567

44200934		
CL B PATCH T2 B		
STA. 13+90 RT	9.6 S.Y.	
STA. 14+24 LT	6.4 S.Y.	
STA. 14+28 LT	7.4 S.Y.	
STA. 20+59 RT	14.7 S.Y.	
STA. 32+20 LT	6.8 S.Y.	
STA. 34+33 LT	11.4 S.Y.	
STA. 36+24 LT	8.1 S.Y.	
TOTAL	64.0 S.Y.	

44200942		
CL B PATCH T3 B		
STA. 11+40 LT (SPLIT)	42.4 S.Y.	
STA. 12+49 LT (SPLIT)	45.8 S.Y.	
STA. 19+10 LT (SPLIT)	30.9 S.Y.	
STA. 30+77 R/L (SPLIT)	43.2 S.Y.	
TOTAL	162.0 S.Y.	

44200944		
CL B PATCH T4 B		
STA. 9+08 LT	94.6 S.Y.	
STA. 13+32 LT	71.7 S.Y.	
STA. 14+06 R/T (SPLIT)	118.6 S.Y.	
STA. 14+98 LT	117.8 S.Y.	
STA. 17+20 LT	53.2 S.Y.	
STA. 18+28 LT	30.2 S.Y.	
STA. 38+43 RT	66.1 S.Y.	
TOTAL	552.0 S.Y.	

60218400		
MAN TA 4 DIA T1F CL		
STA. 10+15 LT	1.0 EA.	
TOTAL	1.0 EA.	

60255500		
MAN ADJUST		
STA. 9+13 LT	1.0 EA	
STA. 18+14 LT	1.0 EA	
STA. 20+65 RT	1.0 EA	
STA. 20+65 LT	1.0 EA	
STA. 33+03 LT	1.0 EA	

60255500		
MAN ADJUST (CONT.)		
STA. 34+44 LT	1.0 EA	
STA. 35+05 LT	1.0 EA	
STA. 36+31 LT	1.0 EA	
TOTAL	8.0 EA	

60260100		
INLETS ADJUST		
STA. 12+12 LT	1.0 EA	
STA. 14+75 RT	1.0 EA	
STA. 14+92 LT	1.0 EA	
STA. 18+03 LT	1.0 EA	
STA. 18+11 RT	1.0 EA	
STA. 33+27 LT	1.0 EA	
STA. 34+35 LT	1.0 EA	
STA. 36+28 LT	1.0 EA	
TOTAL	8.0 EA	

60265700		
VV ADJUST		
STA. 9+20 LT	1.0 EA	
STA. 9+45 RT	1.0 EA	
STA. 16+20 LT	1.0 EA	
STA. 34+04 RT	1.0 EA	
STA. 34+10 RT	1.0 EA	
STA. 34+33 LT	1.0 EA	
TOTAL	6.0 EA	

60266600		
VALVE BOX ADJ		
STA. 30+23 LT	1.0 EA	
STA. 32+23 LT	1.0 EA	
STA. 33+23 LT	1.0 EA	
STA. 37+00 LT	1.0 EA	
TOTAL	4.0 EA	

60500040		
REMOV MANHOLES		
STA. 10+15 LT	1.0 EA.	
TOTAL	1.0 EA.	

60605100		
COMB CC&G TB6.24 AEP		
STA. 10+53 RT	222.8 FT	
STA. 15+43 RT	97.2 FT	
STA. 34+24 RT	19.4 FT	
STA. 37+98 LT	37.0 FT	
TOTAL	376.0 FT	

67100100		
MOBILIZATION		
ENTIRE PROJECT	1.0 L.SUM	
TOTAL	1.0 L.SUM	

70300100		
SHORT TERM PAVT MKING		
STA. 8+78 - 9+37	100.0 FT.	
STA. 10+63 - 20+15	576.0 FT.	
STA. 21+48 - 22+50	116.0 FT.	
STA. 30+00 - 33+15	190.0 FT.	
STA. 34+32 - 37+80	225.0 FT.	
TOTAL (3 APPLICATIONS)	3621.0 FT	

70301000		
WORK ZONE PAVEMENT MARKING REMOVAL		
STA. 8+78 - 9+37	33.3 S.F.	
STA. 10+63 - 20+15	192.0 S.F.	
STA. 21+48 - 22+50	38.7 S.F.	
STA. 30+00 - 33+15	63.3 S.F.	
STA. 34+32 - 37+80	75.0 S.F.	
TOTAL	402.0 S.F.	

78000100		
THPL PVT MK LTR & SYM		
STA. 8+88 RT	20.8 S.F.	
STA. 9+04	15.6 S.F.	
STA. 9+16 RT	15.6 S.F.	
STA. 10+84	15.6 S.F.	
STA. 11+31	20.8 S.F.	
STA. 11+77	15.6 S.F.	
STA. 18+58	15.6 S.F.	
STA. 18+97	20.8 S.F.	
STA. 19+30	15.6 S.F.	
STA. 21+55	15.6 S.F.	
STA. 21+73	20.8 S.F.	
STA. 21+89	15.6 S.F.	

78000100		
THPL PVT MK LTR & SYM (CONT.)		
STA. 30+14	20.8 S.F.	
STA. 30+32	15.6 S.F.	
STA. 32+00	15.6 S.F.	
STA. 32+45	20.8 S.F.	
STA. 32+94	15.6 S.F.	
STA. 34+48	15.6 S.F.	
STA. 34+95	20.8 S.F.	
STA. 35+41	15.6 S.F.	
STA. 35+84	15.6 S.F.	
STA. 37+34	15.6 S.F.	
STA. 37+51	20.8 S.F.	
STA. 37+65	15.6 S.F.	
TOTAL	416.0 S.F.	

78000200		
THPL PVT MK LINE 4		
STA. 8+78 - 9+34 LT	117.6 FT.	
STA. 8+78 - 9+34 LT	20.0 FT.	
STA. 8+78 - 9+34 RT	180.0 FT.	
STA. 10+61 - 12+01 LT	280.0 FT.	
STA. 10+63 - 19+50 RT	230.0 FT.	
STA. 10+63 - 19+55	3565.1 FT.	
STA. 11+99 - 19+23 LT	180.0 FT.	
STA. 18+36 - 19+51 RT	115.0 FT.	
STA. 21+48 - 22+50 LT	30.0 FT.	
STA. 21+48 - 21+98 LT	50.0 FT.	
STA. 21+48 - 22+50 RT	30.0 FT.	
STA. 21+48 - 22+50	414.0 FT.	
STA. 30+00 - 33+16	633.2 FT.	
STA. 30+00 - 30+40 LT	40.0 FT.	
STA. 31+65 - 33+10 RT	290.0 FT.	
STA. 31+84 - 33+15 LT	40.0 FT.	
STA. 34+31 - 37+81	701.4 FT.	
STA. 34+35 - 36+14 LT	180.0 FT.	
STA. 34+43 - 36+13 LT	50.0 FT.	
STA. 34+44 - 36+15 RT	50.0 FT.	
STA. 37+35 - 37+75 RT	45.0 FT.	
STA. 39+13 - 39+20	12.6 FT.	
TOTAL	7254.0 FT.	

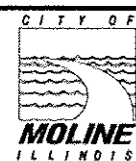

CITY OF MOLINE
DEPARTMENT OF PUBLIC WORKS - ENGINEERING DIVISION
3635 4TH AVENUE, MOLINE, IL 61265
(309) 524-2350
CITY ENGINEER - SCOTT HINTON, P.E.

AVE. OF THE CITIES RESURFACING
41ST TO 43RD STREET & 41ST ST. 24TH AVE. TO 22ND AVE.
SEC. 12-00253-00-RS

Date	07-02-12	Sheet	4
Scale	1" = 20'	OF	16
Design Engineer	LCK	Contract	85567
Date	09-07-12	Revision	LCK

Date	07-02-12	Sheet	4
Scale	1" = 20'	OF	16
Design Engineer	LCK	Contract	85567

78000400	
THPL PVT MK LINE 6	
STA. 9+43	194.0 FT.
STA. 10+50	179.2 FT.
STA. 21+36	142.4 FT.
STA. 33+20	215.0 FT.
STA. 34+20	194.8 FT.
TOTAL	925.0 FT.

78000600	
THPL PVT MK LINE 12	
STA. 9+43	153.0 FT.
STA. 10+50	135.0 FT.
STA. 21+37	108.0 FT.
STA. 33+20	162.0 FT.
STA. 34+20	153.0 FT.
TOTAL	711.0 FT.

78000650	
THPL PVT MK LINE 24	
STA. 9+37 RT	52.4 FT.
STA. 10+60 LT	45.4 FT.
STA. 19+51 RT	40.0 FT.
STA. 21+49 LT	37.0 FT.
STA. 33+16 RT	51.1 FT.
STA. 34+32 LT	49.5 FT.
TOTAL	275.0 FT.

78100100	
RAISED REFL PAVT MKR	
STA. 8+78 - 9+37	9.0 EA.
STA. 10+63 - 20+15	78.0 EA.
STA. 21+49 - 22+50	12.0 EA.
STA. 30+00 - 33+15	23.0 EA.
STA. 34+32 - 37+81	21.0 EA.
TOTAL	143.0 EA.

78300200	
RAISED REFL PAVT MK REM	
STA. 8+78 - 9+37	9.0 EA.
STA. 10+63 - 20+15	78.0 EA.
STA. 21+49 - 22+50	12.0 EA.
STA. 30+00 - 33+15	23.0 EA.
STA. 34+32 - 37+81	21.0 EA.
TOTAL	143.0 EA.

89502210	
MODIFY EXISTING CONTROLLER CABINET	
AVE OF THE CITIES & 41ST ST.	1.0 EA.
TOTAL	1.0 EA.

X7010216	
TRAF CONT AND PROT SPECIAL	
ENTIRE PROJECT	1.0 L.SUM
TOTAL	1.0 L.SUM

X8140115	
HANDHOLE ADJ	
STA. 13+21 RT	1.0 EA.
STA. 16+51 RT	1.0 EA.
STA. 31+72 RT	1.0 EA.
TOTAL	3.0 EA.

XX002119	
SS DI 18	
STA. 20+65 RT	6.0 FT.
TOTAL	6.0 FT.

XX006343	
SEEDING COMPLETE	
STA. 11+53 RT	0.6 S.Y.
STA. 13+19 RT	0.3 S.Y.
STA. 13+21 LT	1.4 S.Y.
STA. 15+97 LT	1.0 S.Y.
STA. 31+62 LT	1.9 S.Y.
STA. 32+19 LT	1.7 S.Y.
STA. 33+02 RT	2.4 S.Y.
STA. 33+29 LT	2.0 S.Y.
STA. 34+03 RT	2.0 S.Y.
STA. 38+38 RT	2.8 S.Y.
STA. 38+96 RT	3.0 S.Y.
TOTAL	19.0 S.Y.

XX007739	
WIRELESS VEH DET SYS	
AVE OF THE CITIES & 41ST ST.	1.0 EA.
HY=VEE/ALDI'S ENTRANCE	1.0 EA.
TOTAL	2.0 EA.

20058300	
SAN SEW T1 8	
STA. 9+08 LT	105.0 FT.
TOTAL	105.0 FT.



CITY OF MOLINE
DEPARTMENT OF PUBLIC WORKS - ENGINEERING DIVISION
3635 4TH AVENUE, MOLINE, IL 61265
(309) 524-2350
CITY ENGINEER - SCOTT HINTON, P.E.

AVE. OF THE CITIES RESURFACING
41ST TO 43RD STREET & 41ST ST. 24TH AVE. TO 22ND AVE.
SEC. 12-00253-00-RS

09-07-12	LCK
Date	Revision

Date	07-02-12	Sheet	5
Scale	1" = 20'	OF	16
Design Engineer	LCK	Contract	85567

RIGHT OF WAY (VARIES 80-90')

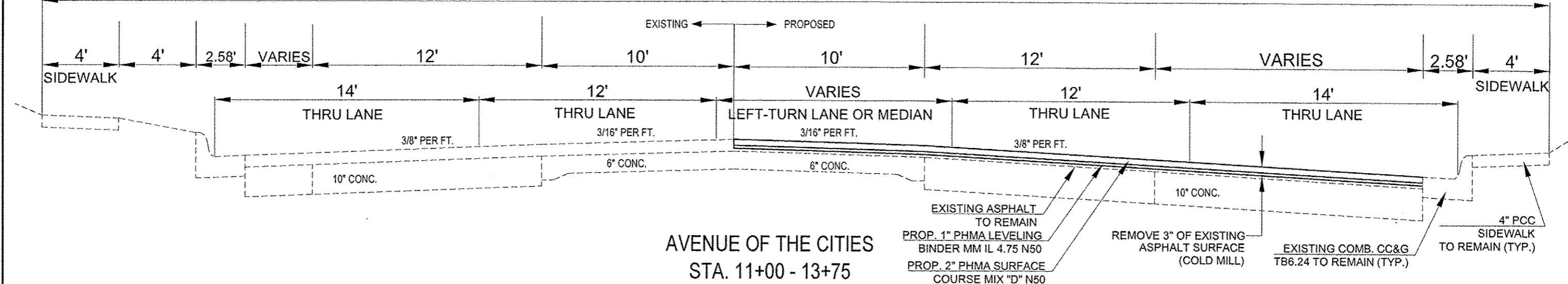

AVENUE OF THE CITIES
STA. 11+00 - 13+75

RIGHT OF WAY (80')

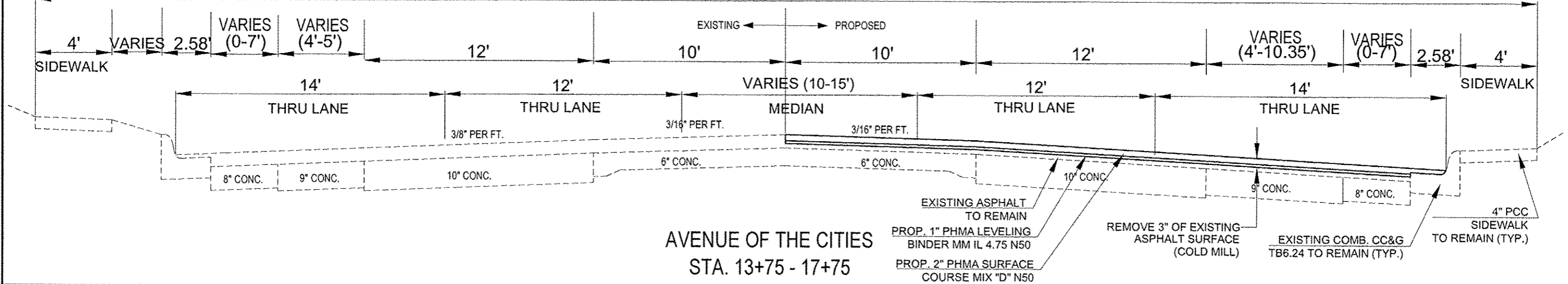

AVENUE OF THE CITIES
STA. 13+75 - 17+75

RIGHT OF WAY (80')

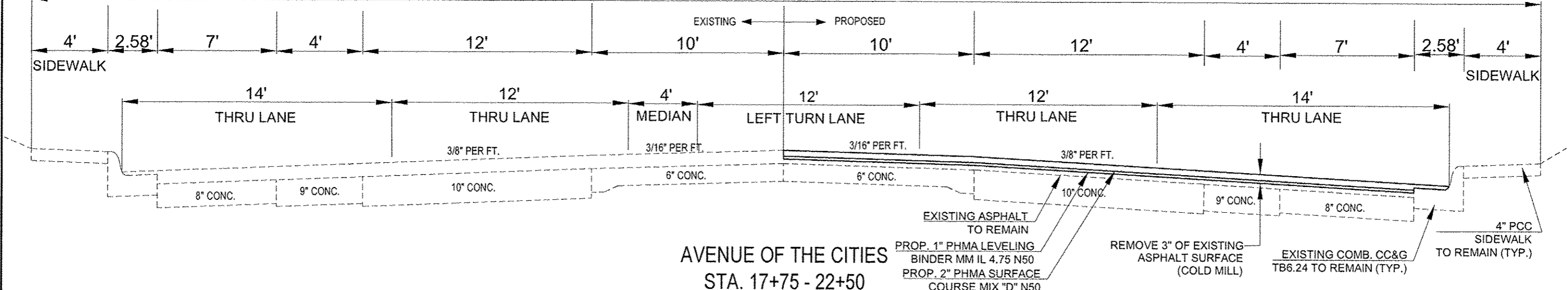

AVENUE OF THE CITIES
STA. 17+75 - 22+50



CITY OF MOLINE
DEPARTMENT OF PUBLIC WORKS - ENGINEERING DIVISION
3635 4TH AVENUE, MOLINE, IL 61265
(309) 524-2350
CITY ENGINEER - SCOTT HINTON, P.E.

AVE. OF THE CITIES RESURFACING
41ST TO 43RD STREET & 41ST ST. 24TH AVE. TO 22ND AVE.
SEC. 12-00253-00-RS

Date	09-07-12	Revision	LCK
------	----------	----------	-----

Date	07-02-12	Sheet	6
Scale	N.T.S.	of	16
Design Engineer	LCK	Contract	85567

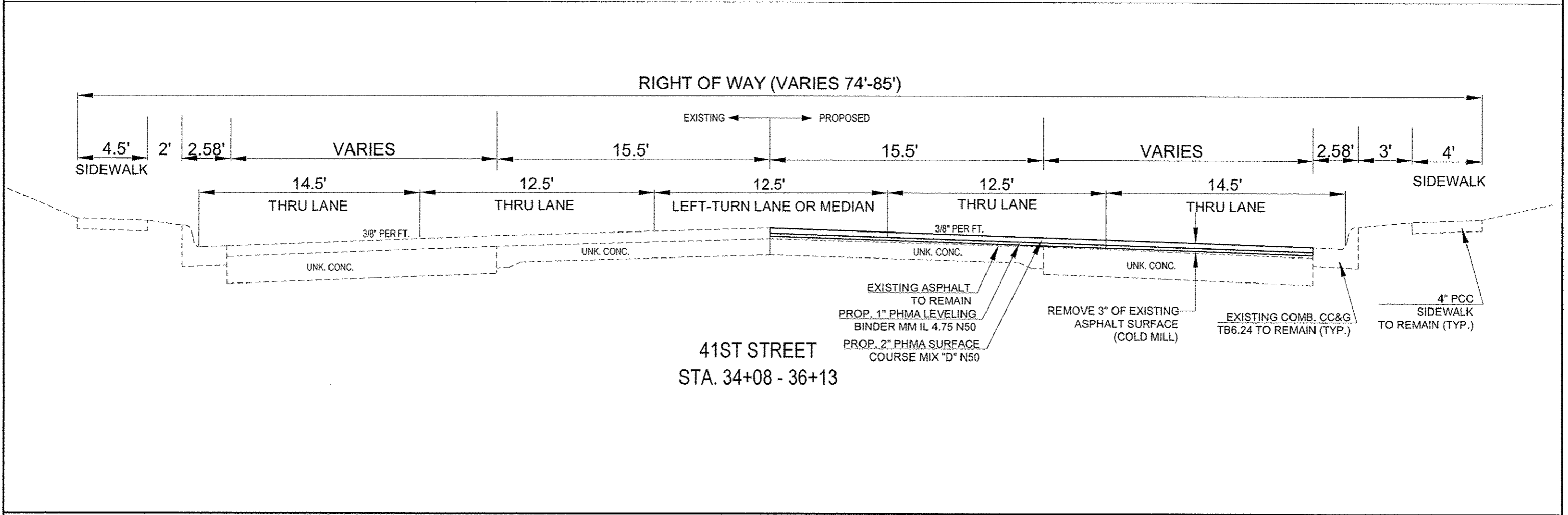
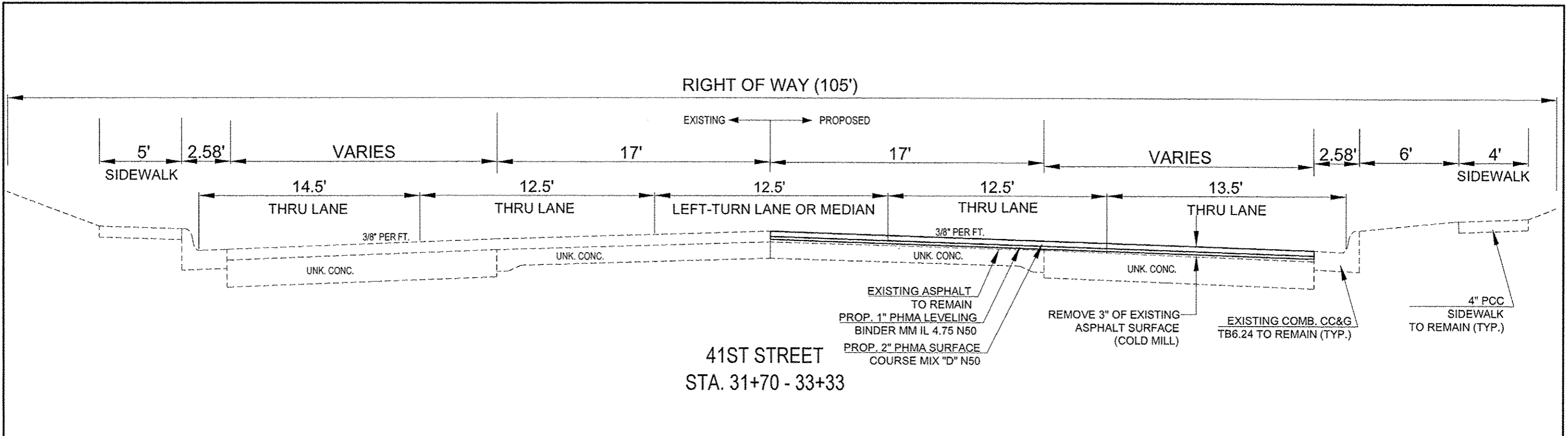

CITY OF MOLINE
DEPARTMENT OF PUBLIC WORKS - ENGINEERING DIVISION
3635 4TH AVENUE, MOLINE, IL 61265
(309) 524-2350
CITY ENGINEER - SCOTT HINTON, P.E.

AVE. OF THE CITIES RESURFACING
41ST TO 43RD STREET & 41ST ST. 24TH AVE. TO 22ND AVE.
SEC. 12-00253-00-RS

09-07-12	LCK
Date	Revision

Date	07-02-12	Sheet	7
Scale	N.T.S.	OF	16
Design Engineer	LCK	Contract	85567

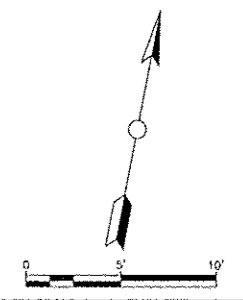
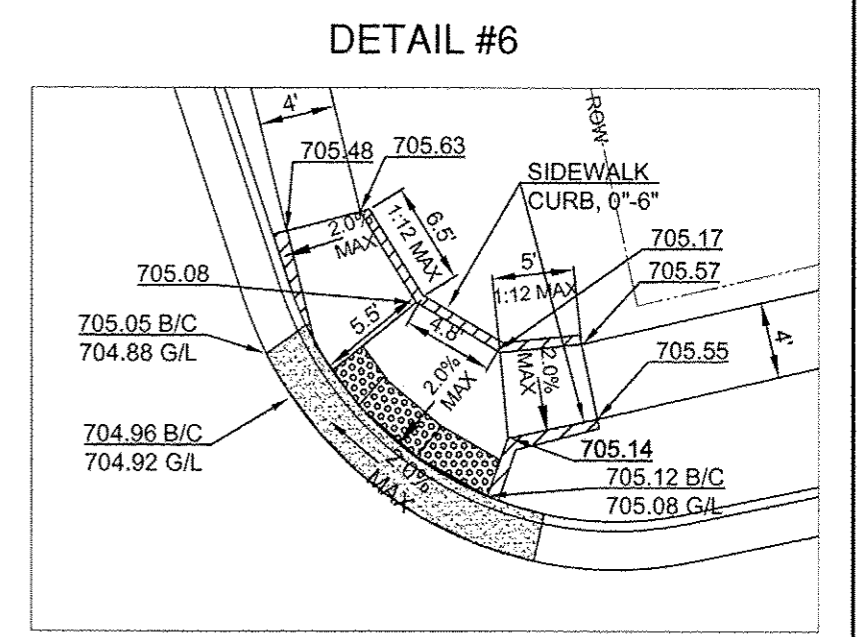
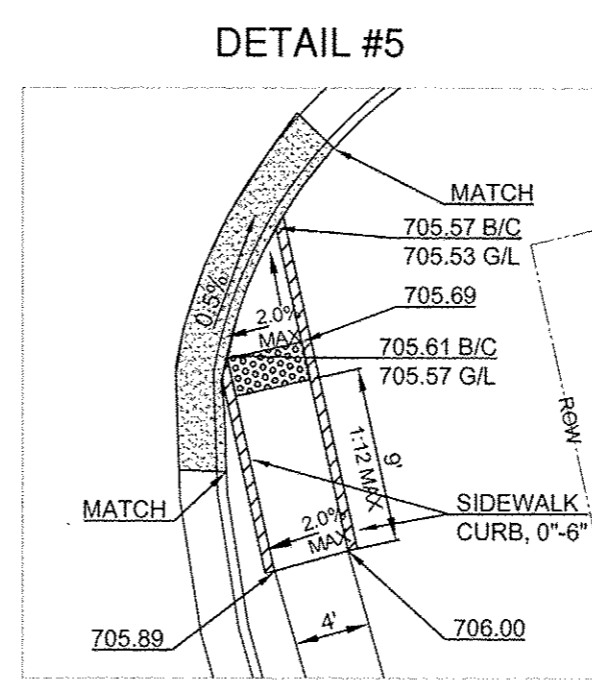
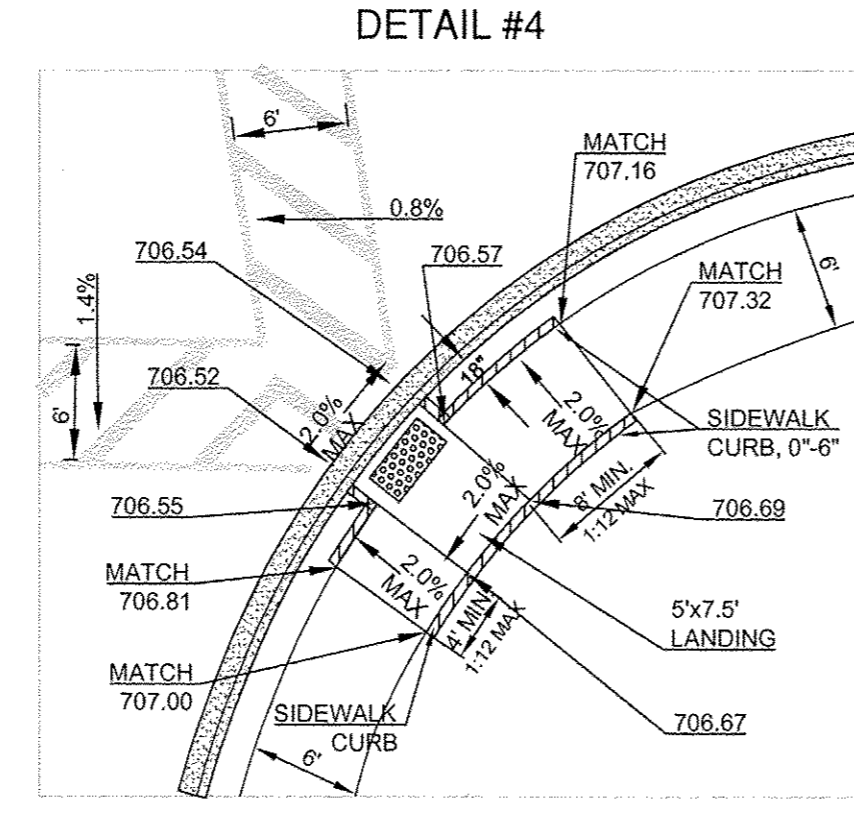
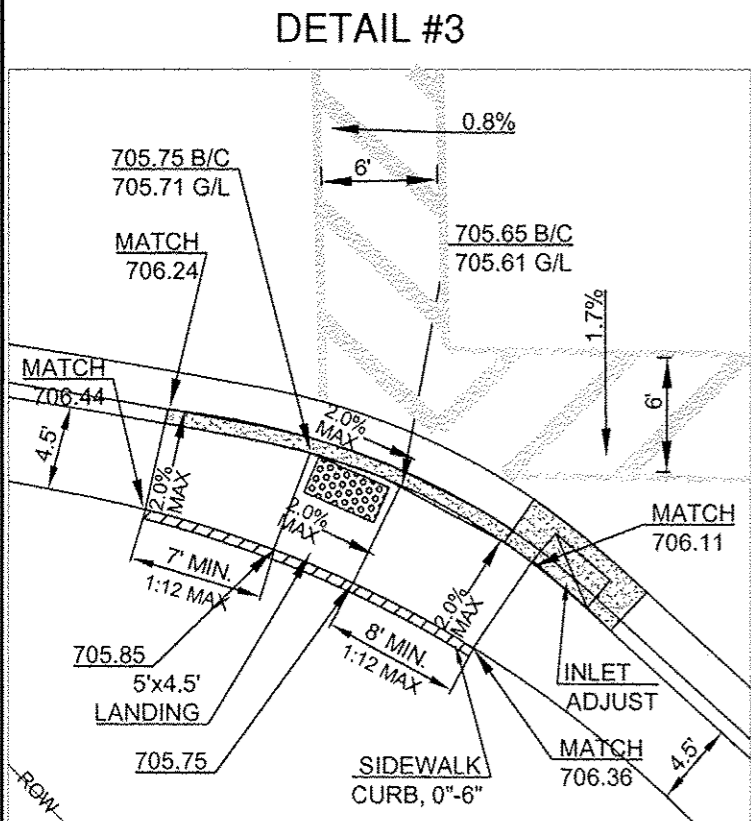
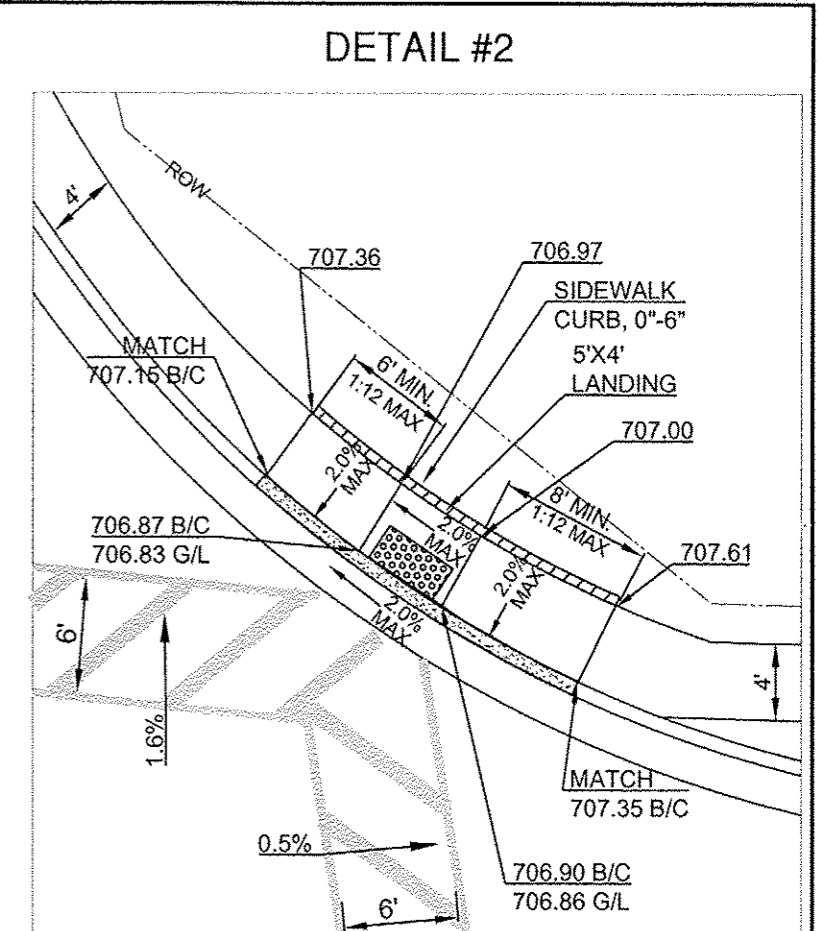
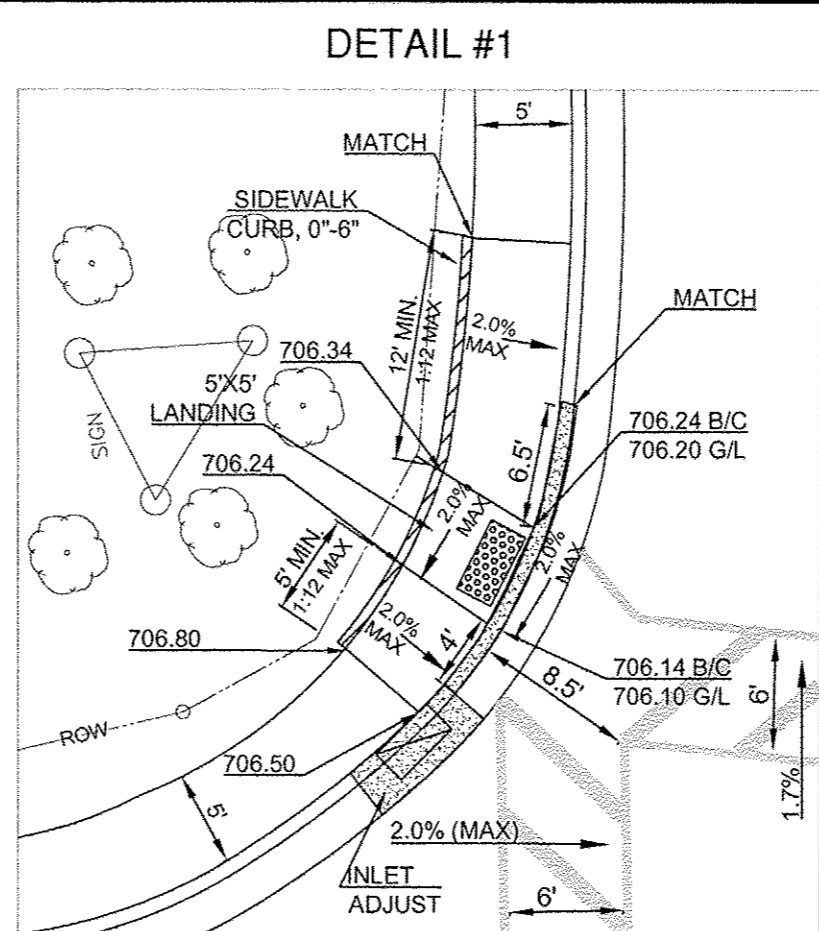
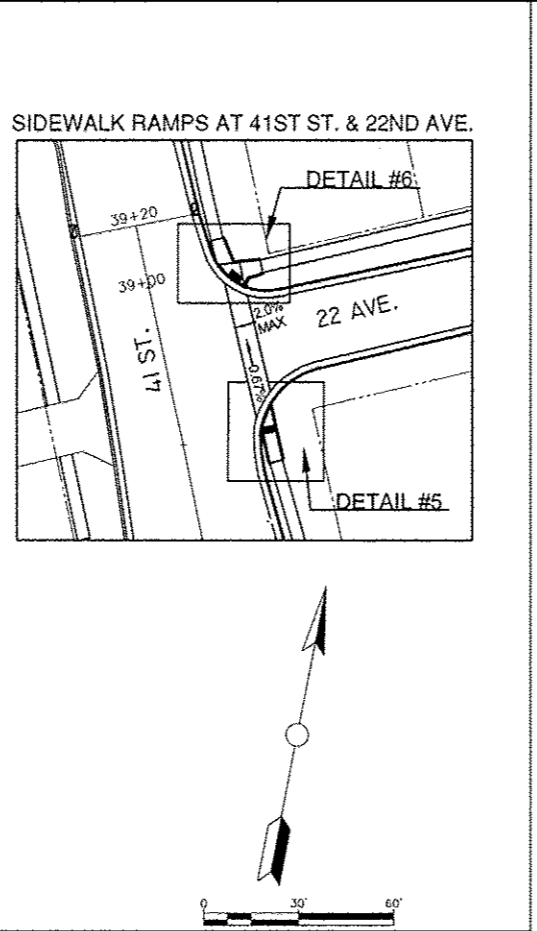
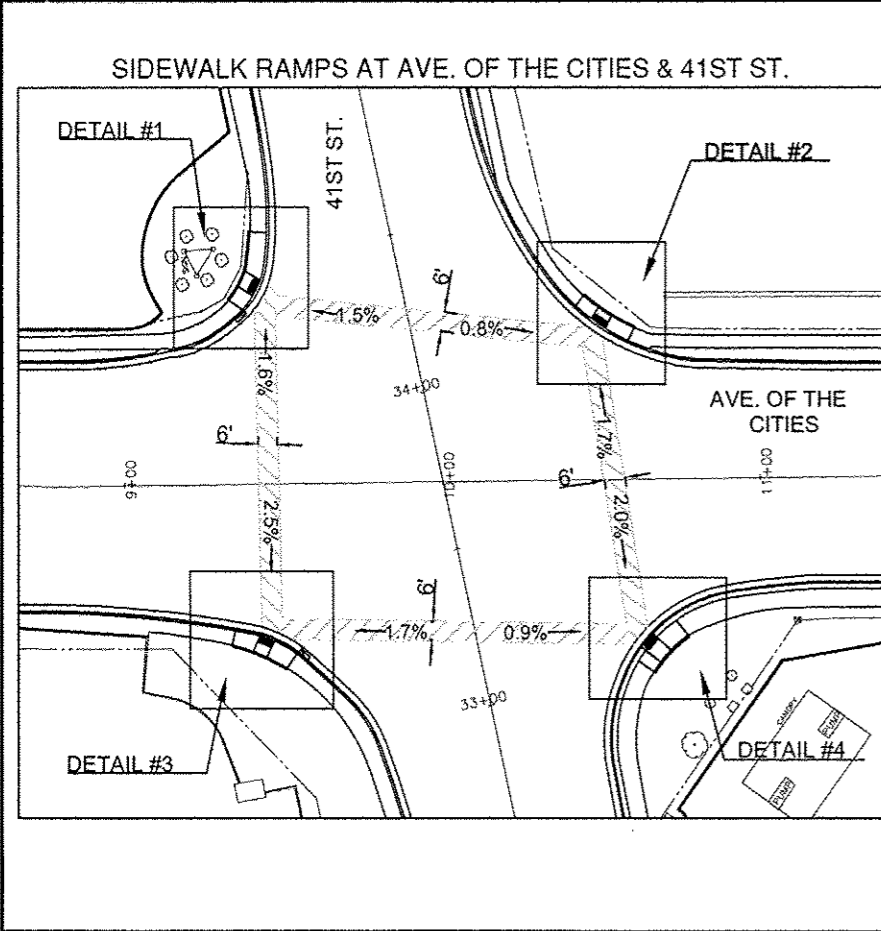

CITY OF MOLINE
 DEPARTMENT OF PUBLIC WORKS - ENGINEERING DIVISION
 3635 4TH AVENUE, MOLINE, IL 61265
 (309) 524-2350
 CITY ENGINEER - SCOTT HINTON, P.E.

AVE. OF THE CITIES RESURFACING
 41ST TO 43RD STREET & 41ST ST. 24TH AVE. TO 22ND AVE.
 SEC. 12-00253-00-RS

Date	Revision
10-16-12	LCK
09-07-12	LCK

Date	Sheet
07-02-12	8
1" = 20'	OF 16
Design Engineer	Contract
LCK	85567

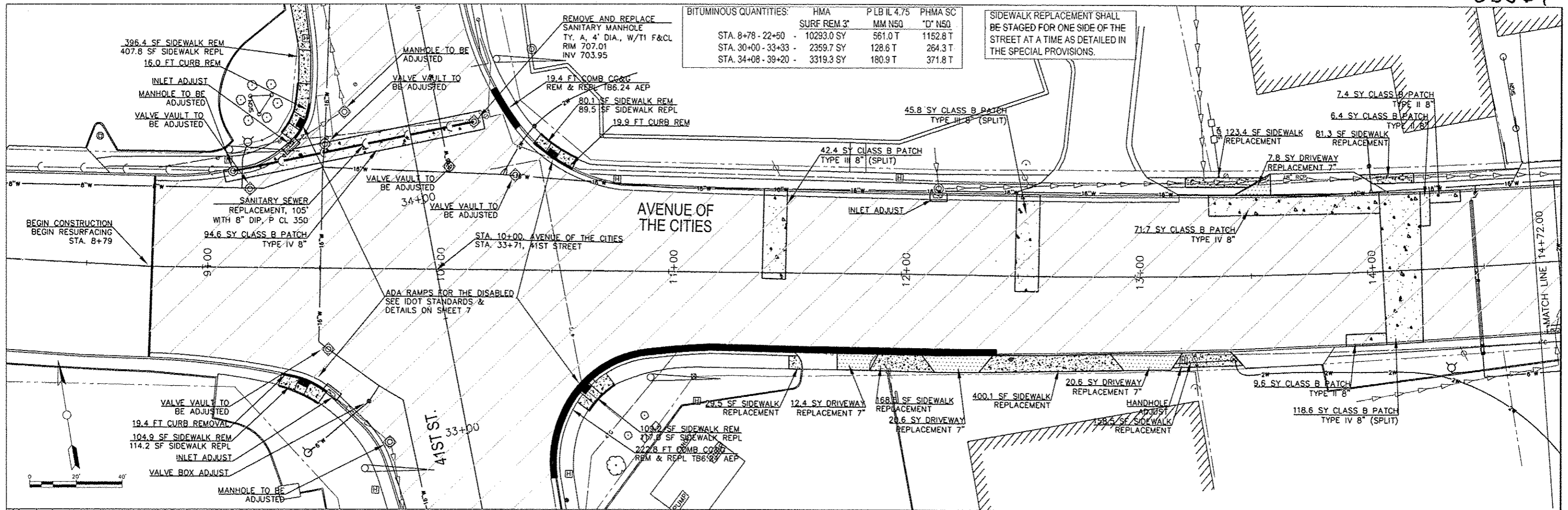

BITUMINOUS QUANTITIES:

	HMA	P/LB IL 4.75	PHMA SC
STA. 8+78 - 22+50	SURF REM 3"	MM NSQ	"D" NSQ
	10293.0 SY	561.0 T	1152.8 T
STA. 30+00 - 33+33		2359.7 SY	128.6 T
			264.3 T
STA. 34+08 - 39+20		3319.3 SY	180.9 T
			371.8 T

SIDEWALK REPLACEMENT SHALL BE STAGED FOR ONE SIDE OF THE STREET AT A TIME AS DETAILED IN THE SPECIAL PROVISIONS.

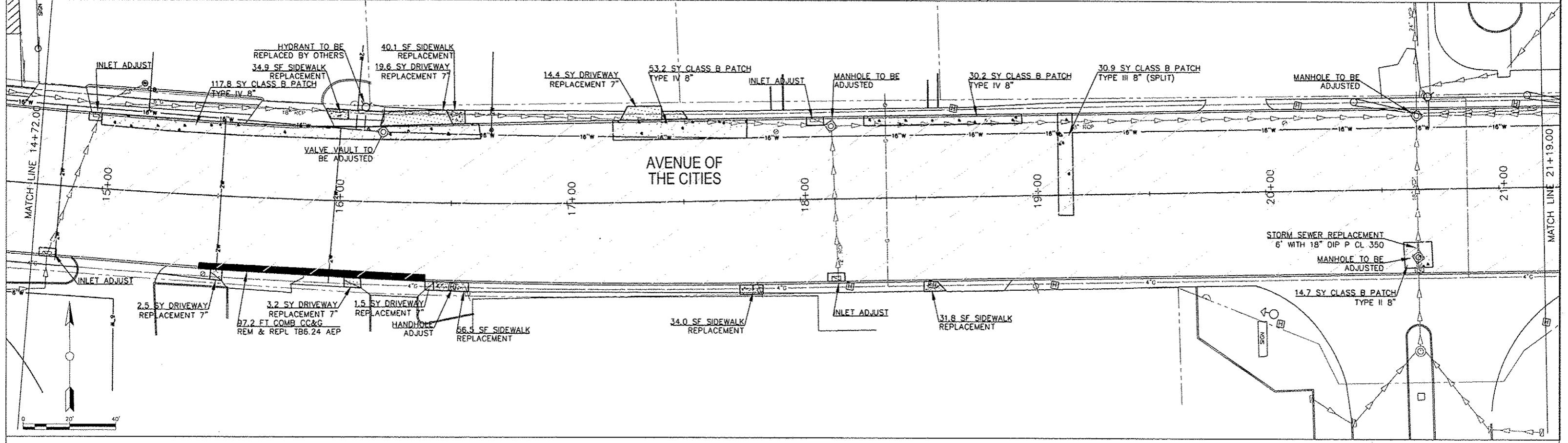

CITY OF MOLINE
 DEPARTMENT OF PUBLIC WORKS - ENGINEERING DIVISION
 3635 4TH AVENUE, MOLINE, IL 61265
 (309) 524-2350
 CITY ENGINEER - SCOTT HINTON, P.E.

AVE. OF THE CITIES RESURFACING
 41ST TO 43RD STREET & 41ST ST. 24TH AVE. TO 22ND AVE.
 SEC. 12-00253-00-RS

Date	09-07-12
Revision	LCK

Date	07-02-12	Sheet	9
Scale	1" = 20'	of	16
Design Engineer	LCK	Contract	85567

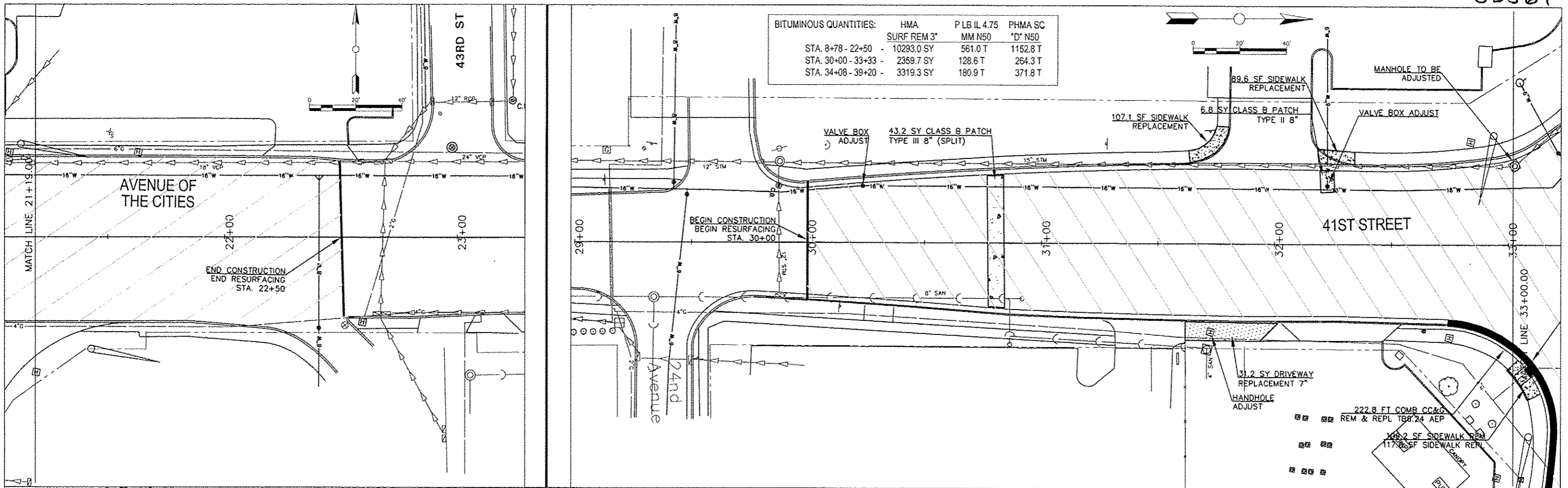

BITUMINOUS QUANTITIES:			
	HMA	P LB IL 4.75	PHMA SC
STA. 8+78 - 22+50	SURF REM 3"	MM N50	"D" N50
STA. 30+00 - 33+33	10293.0 SY	561.0 T	1152.8 T
STA. 34+08 - 39+20	2359.7 SY	128.6 T	264.3 T
	3319.3 SY	180.9 T	371.8 T

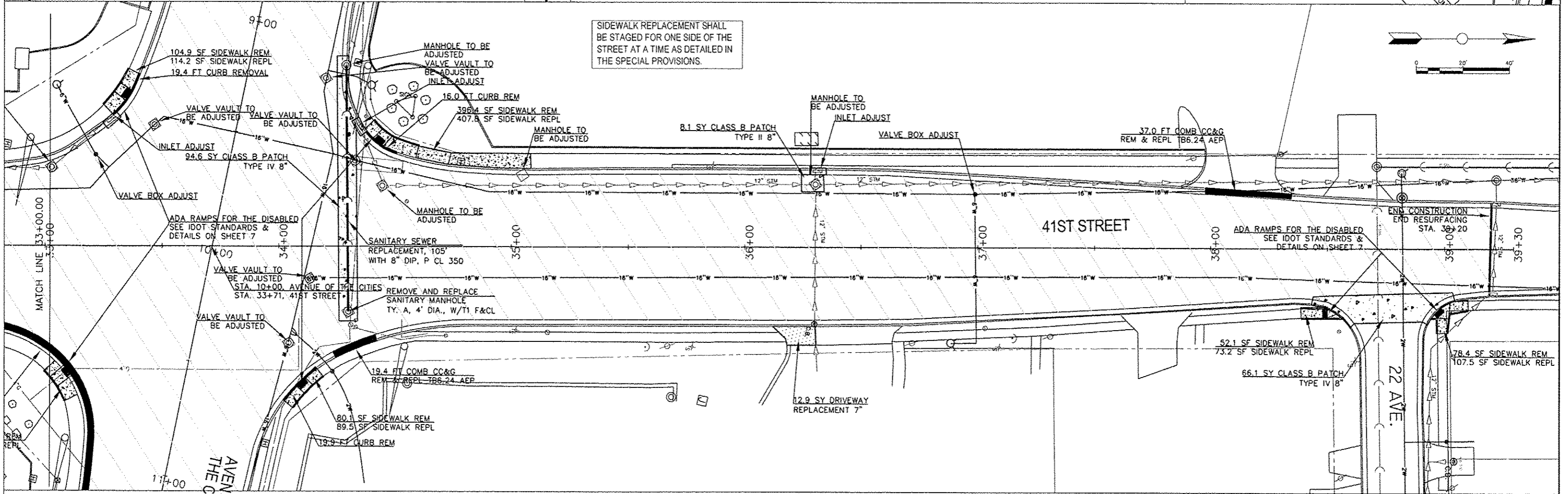

SIDEWALK REPLACEMENT SHALL BE STAGED FOR ONE SIDE OF THE STREET AT A TIME AS DETAILED IN THE SPECIAL PROVISIONS.

CITY OF MOLINE
 DEPARTMENT OF PUBLIC WORKS - ENGINEERING DIVISION
 3635 4TH AVENUE, MOLINE, IL 61265
 (309) 524-2350
 CITY ENGINEER - SCOTT HINTON, P.E.

AVE. OF THE CITIES RESURFACING
 41ST TO 43RD STREET & 41ST ST. 24TH AVE. TO 22ND AVE.
 SEC. 12-00253-00-RS

Date	09-07-12	Revision	LCK
------	----------	----------	-----

Date	07-02-12	Sheet	10
Scale	1" = 20'	of	16
Design Engineer	LCK	Contract	85567

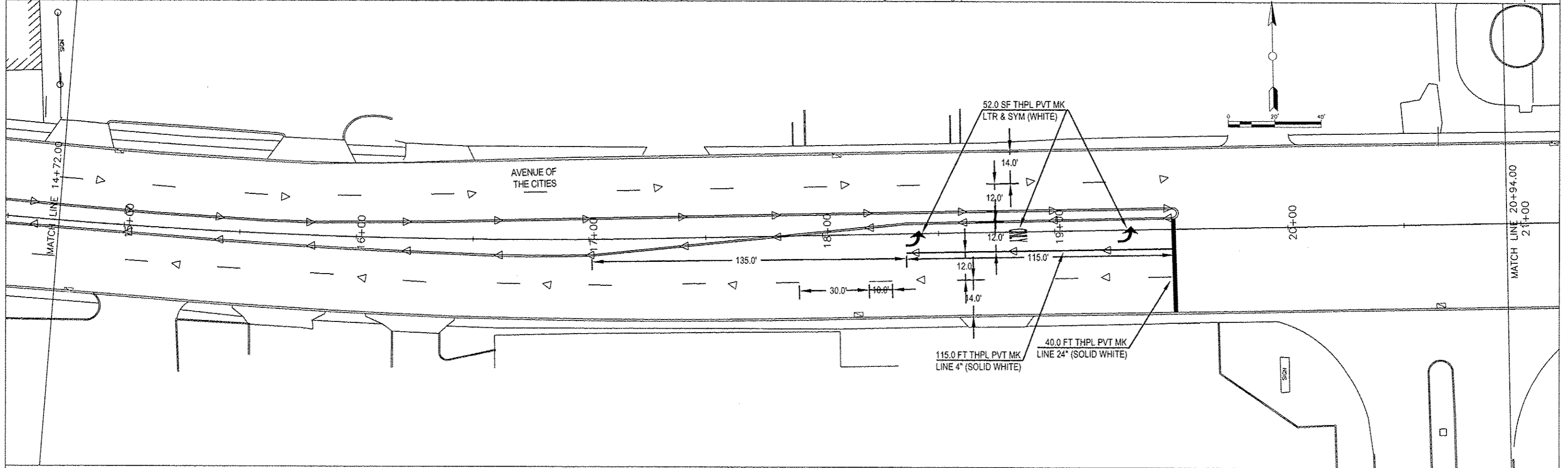
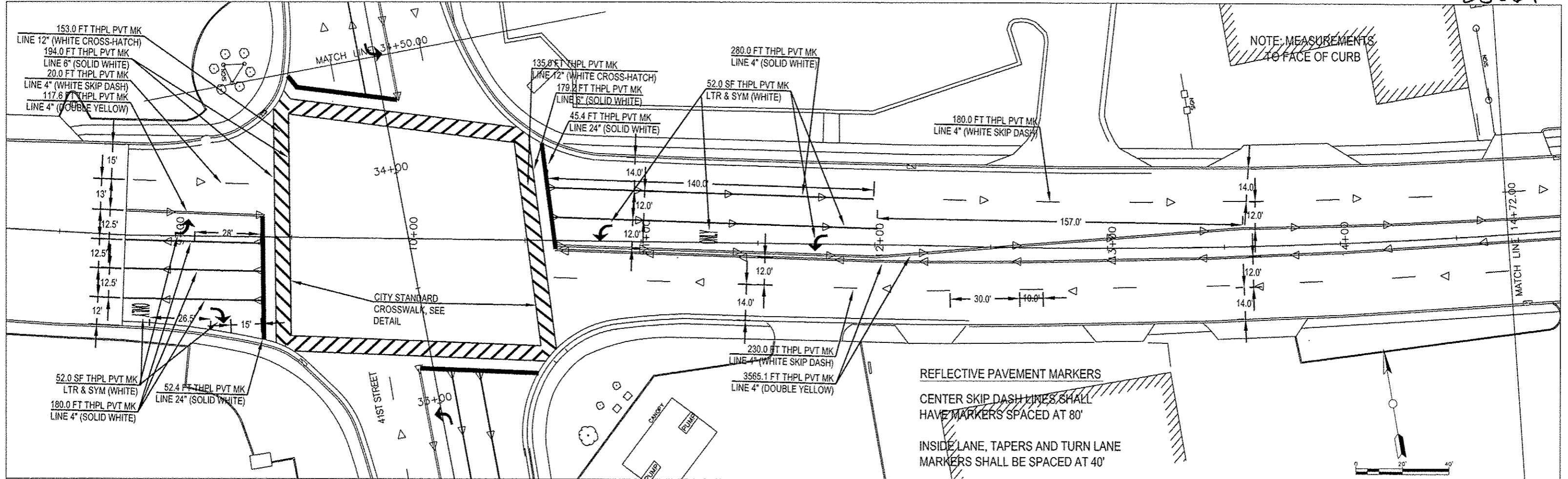

REFLECTIVE PAVEMENT MARKERS
 CENTER SKIP DASH LINES SHALL
 HAVE MARKERS SPACED AT 80'
 INSIDE LANE, TAPERS AND TURN LANE
 MARKERS SHALL BE SPACED AT 40'

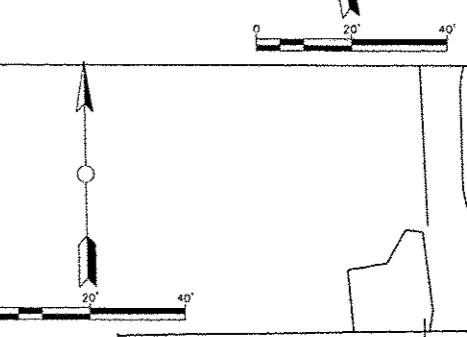

CITY OF MOLINE
 DEPARTMENT OF PUBLIC WORKS - ENGINEERING DIVISION
 3635 4TH AVENUE, MOLINE, IL 61265
 (309) 524-2350
 CITY ENGINEER - SCOTT HINTON, P.E.

AVE. OF THE CITIES RESURFACING
 41ST TO 43RD STREET & 41ST ST. 24TH AVE. TO 22ND AVE.
 SEC. 12-00253-00-RS

Date	09-07-12	Revision	LCK
------	----------	----------	-----

Date	07-02-12	Sheet	11
Scale	1" = 20'	of	16
Design Engineer	LCK	Contract	85567

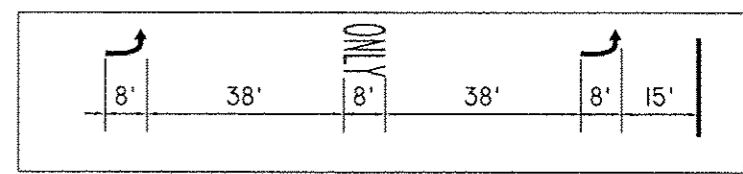
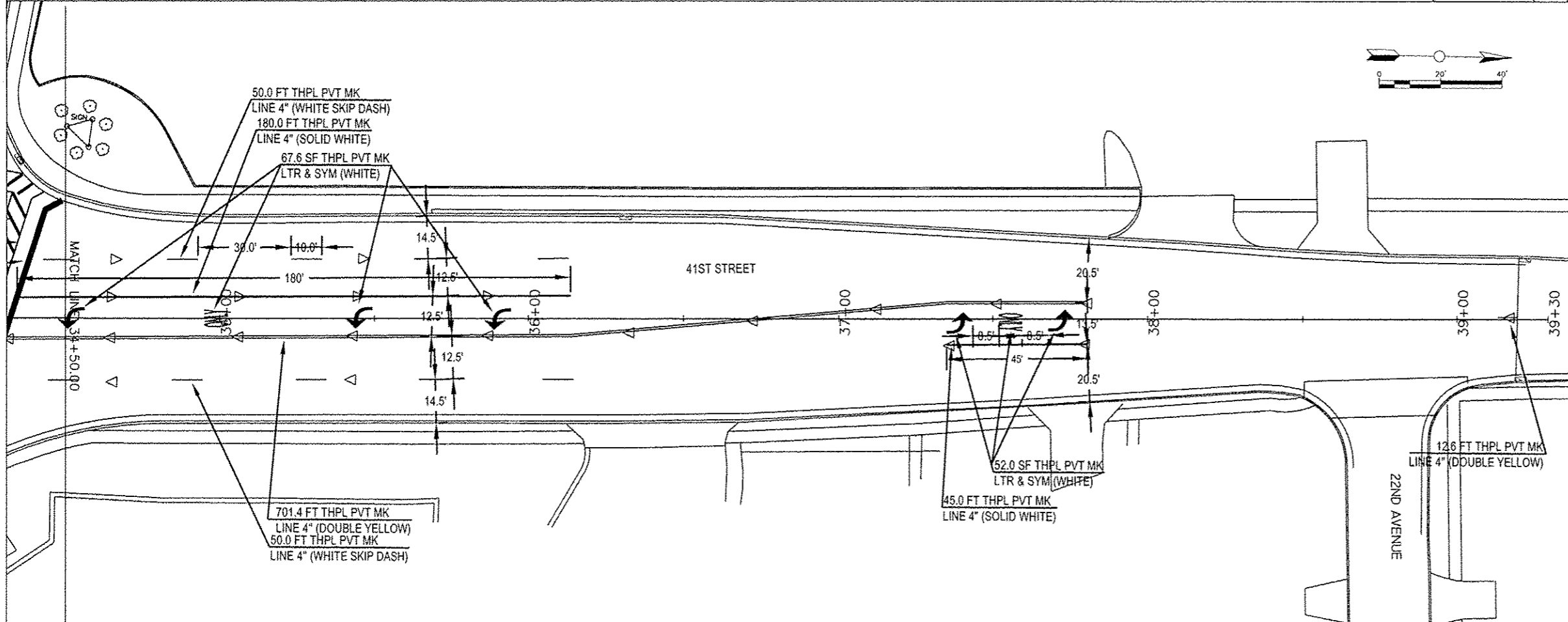
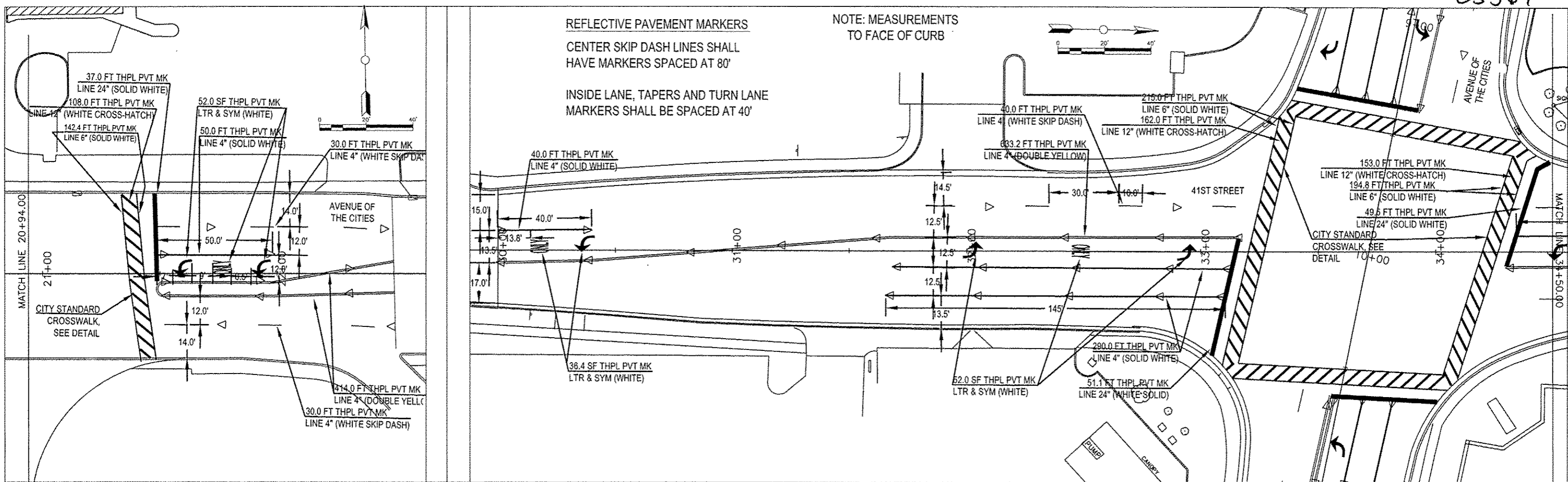

TYPICAL TURN LANE LAYOUT (UNLESS OTHERWISE NOTED)

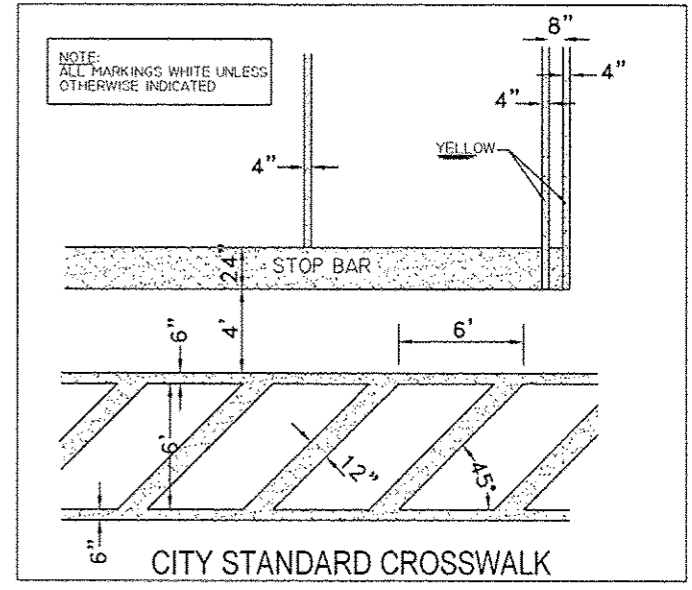

CITY OF MOLINE
DEPARTMENT OF PUBLIC WORKS - ENGINEERING DIVISION
3635 4TH AVENUE, MOLINE, IL 61265
(309) 524-2350
CITY ENGINEER - SCOTT HINTON, P.E.

AVE. OF THE CITIES RESURFACING
41ST TO 43RD STREET & 41ST ST. 24TH AVE. TO 22ND AVE.
SEC. 12-00253-00-RS

Date	09-07-12	Revision	LCK
------	----------	----------	-----

Date	07-02-12	Sheet	12
Scale	1" = 20'	OF	16
Design Engineer	LCK	Contract	85567

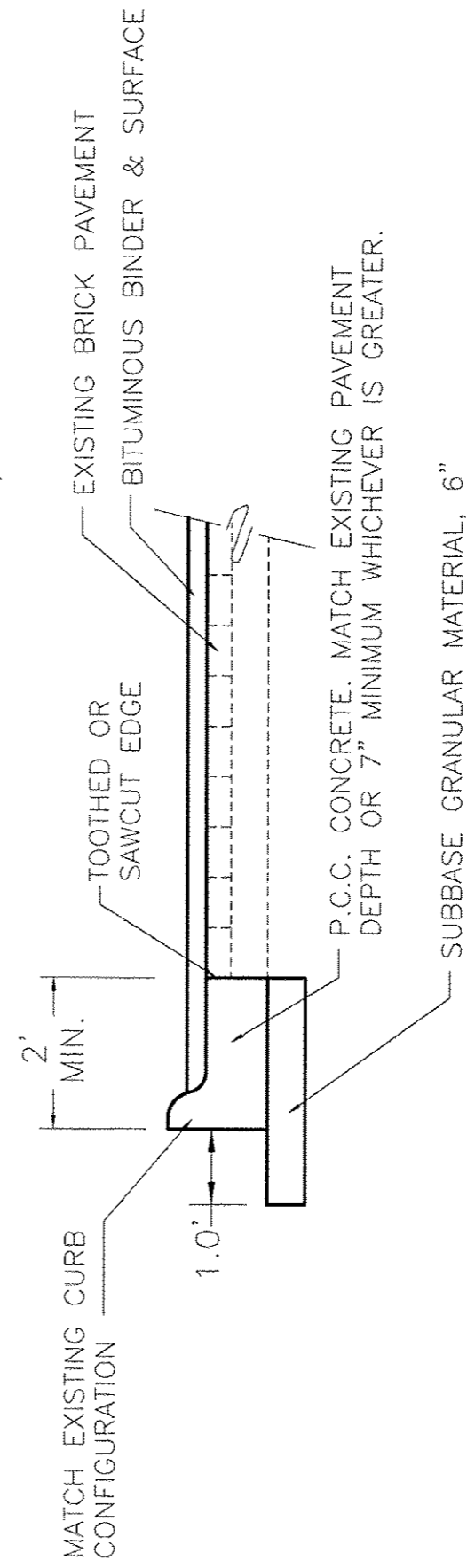
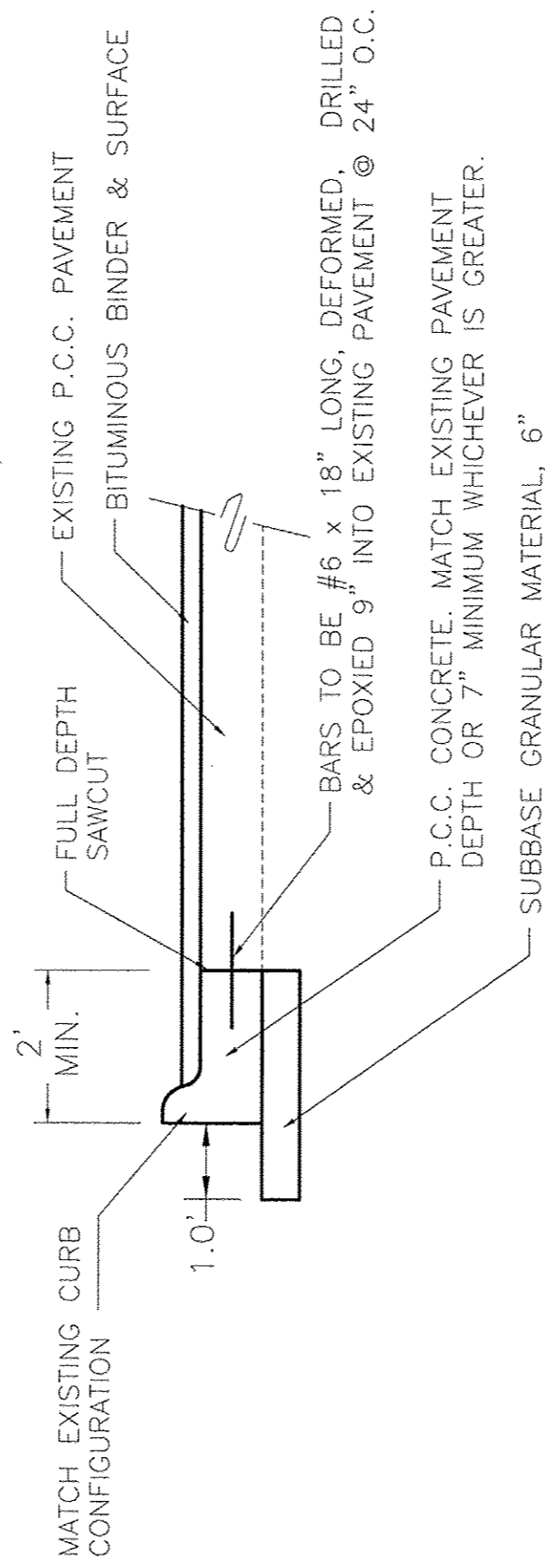
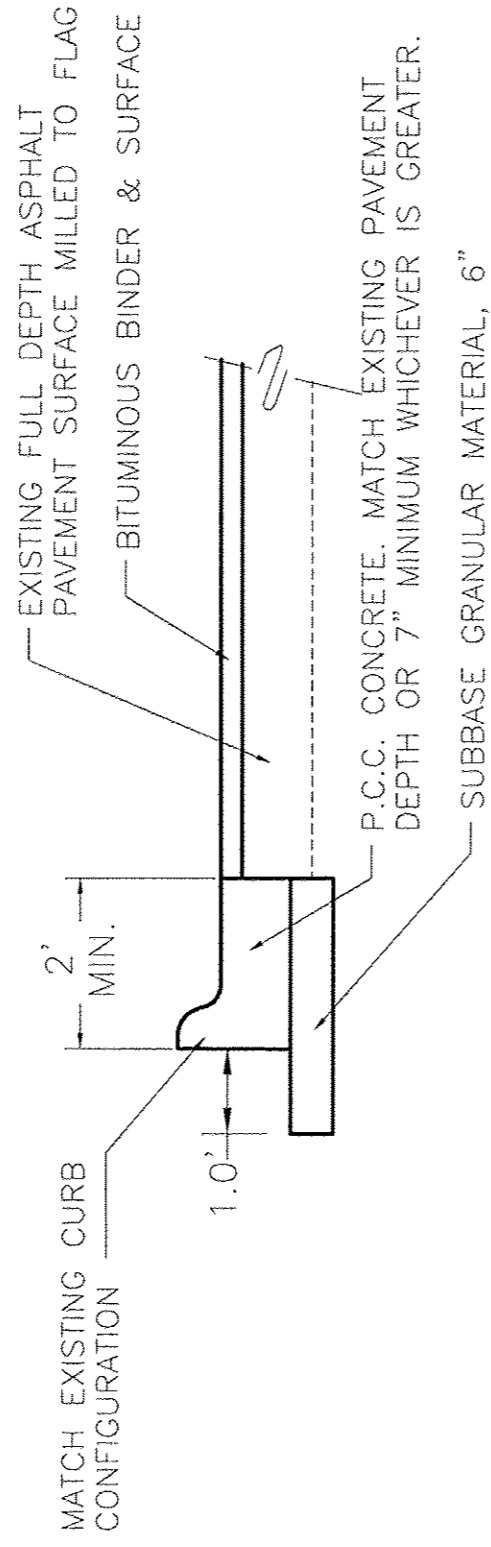
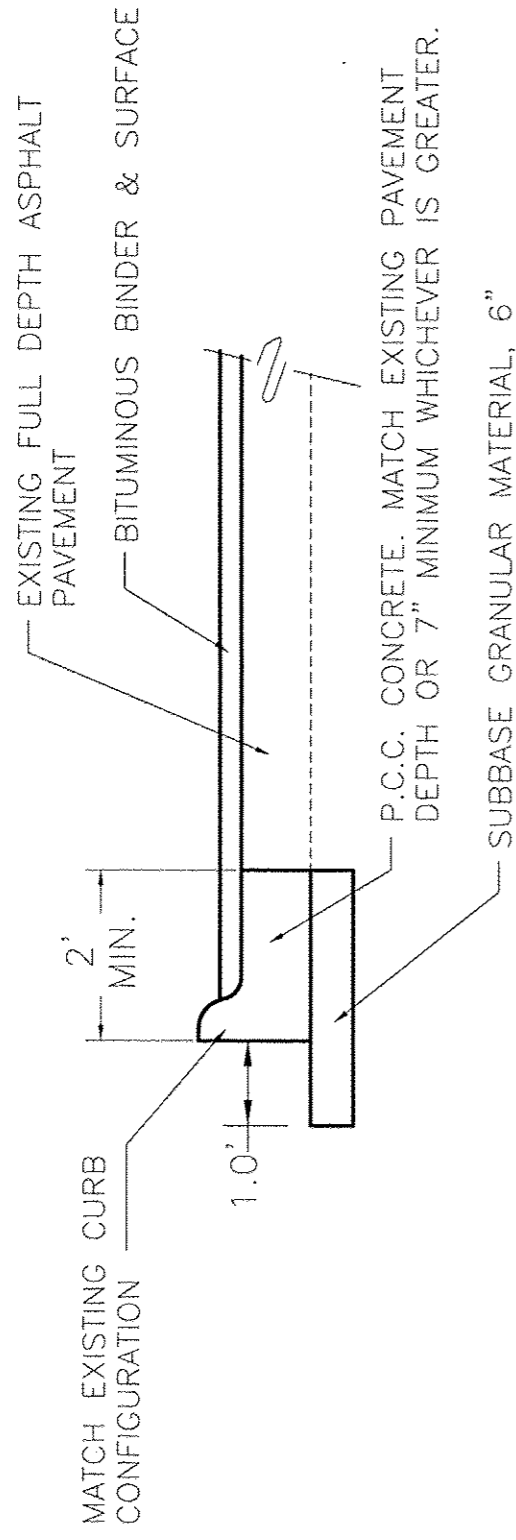

REMOVE & REPLACE
COMBINATION
CURB & GUTTER

DATE	CITY OF MOLINE	SHEET
5/05	STANDARD	13/16

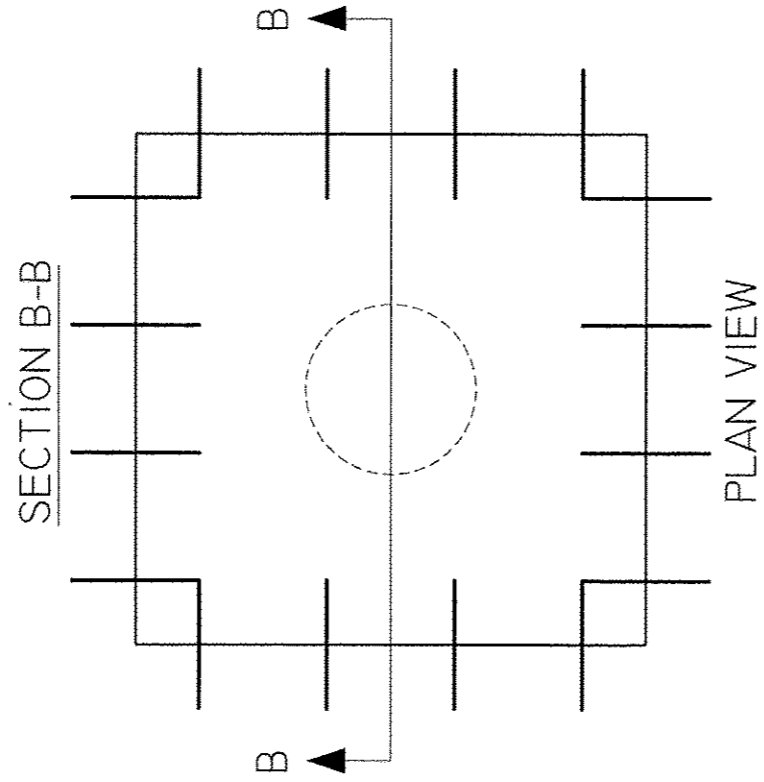
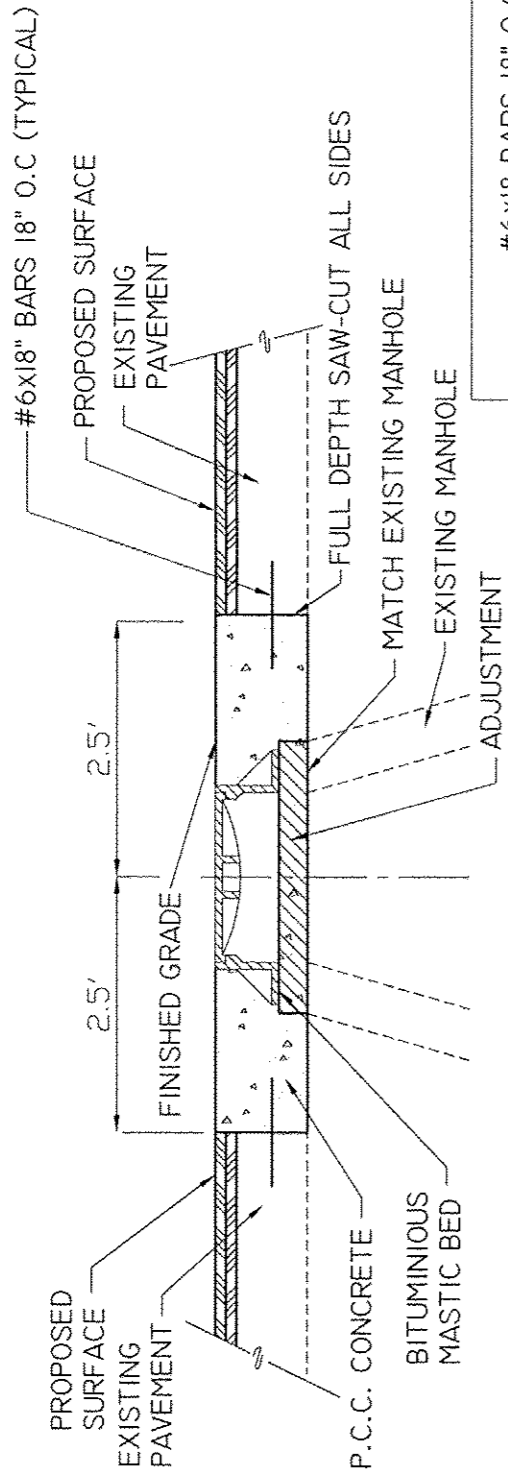

SECTION B-B

PLAN VIEW

MANHOLE ADJUSTMENT DETAIL

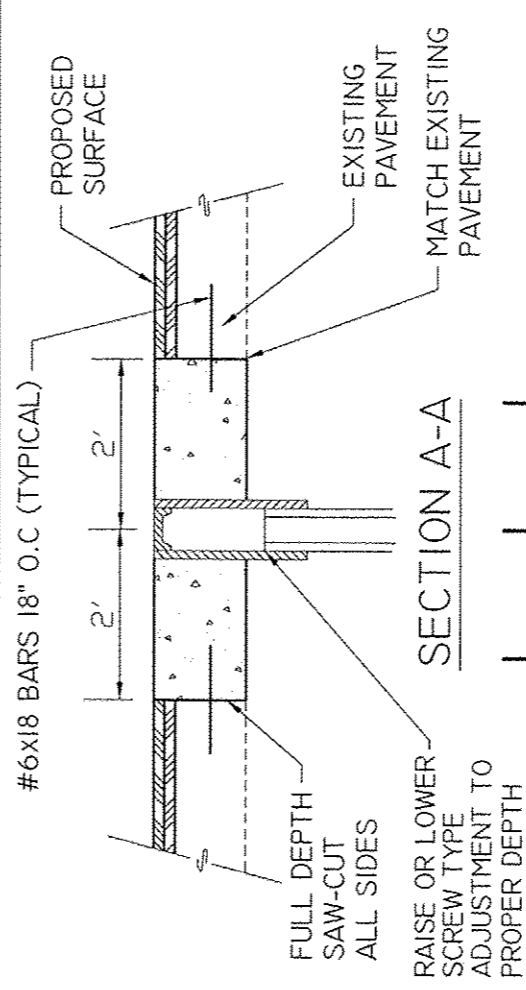

SECTION A-A

PLAN VIEW

B - BOX ADJUSTMENT
DETAIL

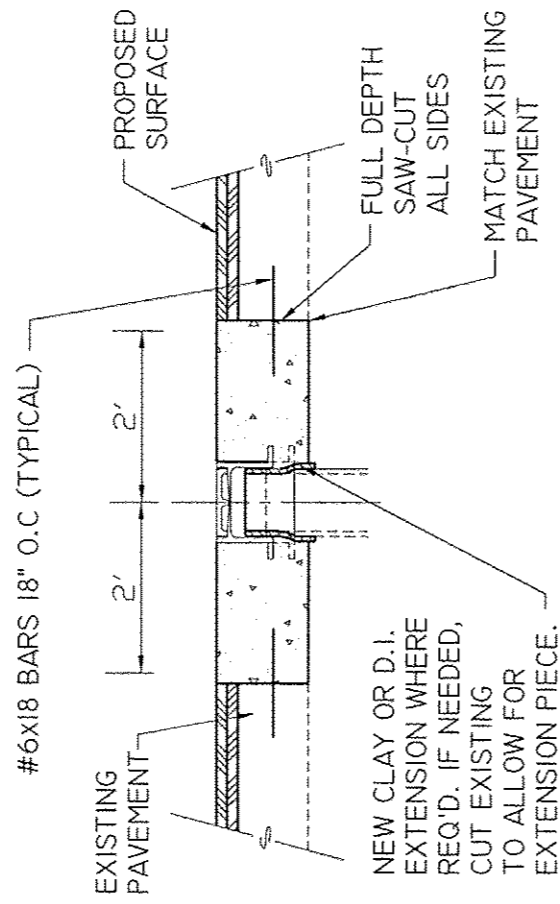

SECTION C-C

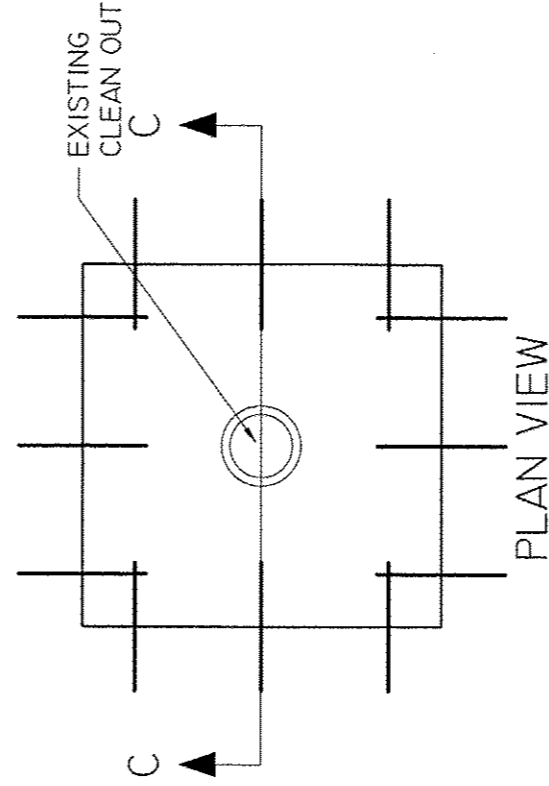

PLAN VIEW

CLEAN OUT ADJUSTMENT
DETAIL

NOTE:
ALL REINFORCING BARS SHALL BE EPOXY COATED

TYPICAL ADJUSTMENT DETAIL		DATE	SHEET
		10/11	14/16
		CITY OF MOLINE STANDARD	

ROUGH GROOVED SURFACE SIGN

ILLINOIS STANDARD W8-I107

SIGN PANEL TYPE 1

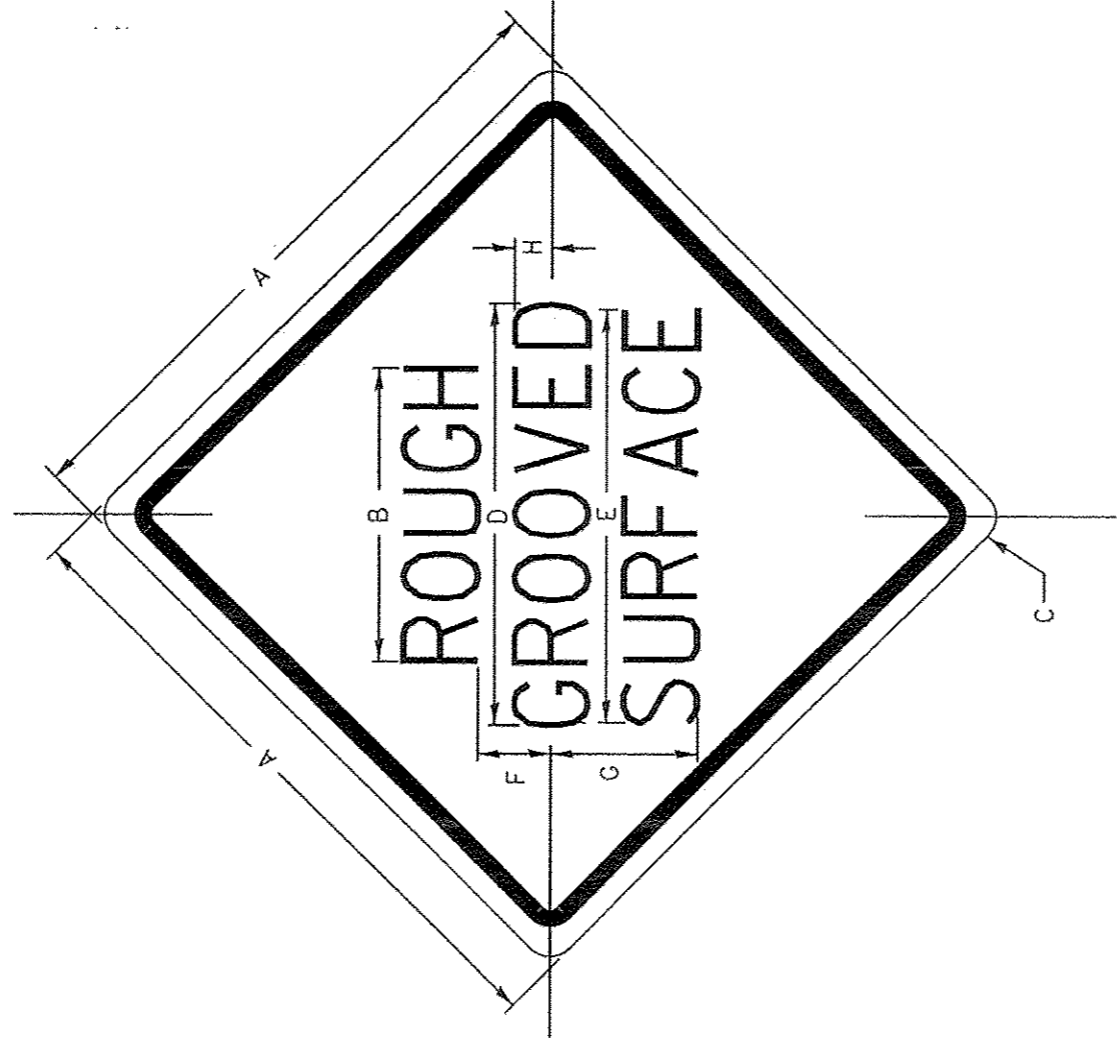

COLOR: LEGEND AND BORDER - BLACK NON-REFLECTIVE
BACKGROUND - ORANGE REFLECTORIZED

SIGN SIZE	DIMENSIONS							
	A	B	C	D	E	F	G	H
48x48	48.0	24.1	3.0	34.0	33.0	6.0	13.0	3.5

SIGN SIZE	SERIES LINES		MARGIN		BORDER	BLANK STD.
	1	2	3			
48x48	7C	7C	7C	0.8	1.2	B4-48D

ALL DIMENSIONS IN INCHES.

GENERAL NOTES

SIGN PANELS AND FACE MATERIALS SHALL BE ACCORDING TO SECTION 720 OF THE STANDARD SPECIFICATIONS

METAL POSTS SHALL BE IN ACCORDANCE WITH STD. 720011.

ALL MOUNTING HARDWARE SHALL BE ALUMINUM, STAINLESS STEEL, ZINC OR CADMIUM PLATED STEEL AND SHALL BE INCLUDED TO THE COST OF THE INSTALLATION.

ALL DIMENSIONS ARE IN INCHES UNLESS OTHERWISE NOTED.

REVISED - 10-14-11	REGION 2 / DISTRICT 2 STANDARD			F.A. RTE.	SECTION	COUNTY	TOTAL SHEETS	SHEET NO.
REVISED -								
REVISED -								
REVISED -								
PLOT DATE - Mon Oct 24 14:57:29 2011	SCALE: 1:0000	/ in.	SHEET NO. OF SHEETS	STA.	TO STA.	ILLINOIS FED. AID PROJECT CONTRACT NO.		

ROUGH GROOVED SURFACE SIGN 91.2



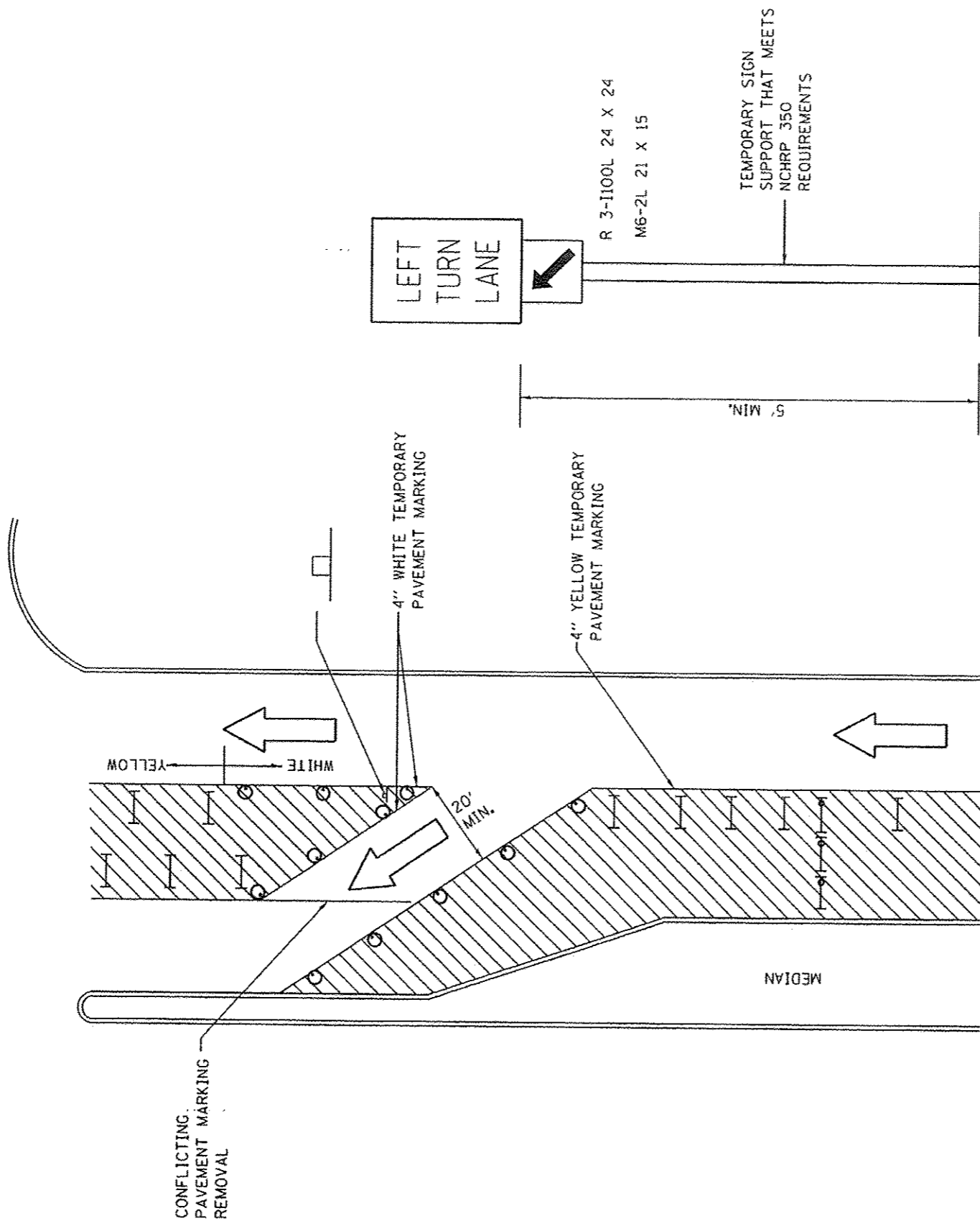

85567

SHEET 15/16

TRAFFIC CONTROL AND PROTECTION AT TURN BAYS (TO REMAIN OPEN TO TRAFFIC)

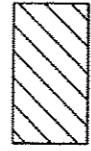
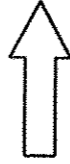

LEGEND

-  WORK AREA
-  LANE OPEN TO TRAFFIC
-  TYPE I OR II BARRICADE OR DRUM WITH FLASHING BURNING LIGHT
-  DRUM OR BARRICADE WITH STEADY BURN LIGHT
-  SIGN (SEE DETAIL)
-  TYPE I OR II CHECK BARRICADE WITH STEADY LIGHT BURN

GENERAL NOTES

- CONES MAY BE SUBSTITUTED FOR BARRICADES OR DRUMS AT HALF THE SPACING DURING DAY OPERATIONS. CONES SHALL BE A MINIMUM OF 28 IN HEIGHT.
- STEADY BURNING LIGHTS WILL NOT BE REQUIRED ON BARRICADES OR DRUMS FOR DAY OPERATIONS. ALL LIGHTS WILL BE MONODIRECTIONAL.
- TEMPORARY PAVEMENT MARKING SHALL BE PLACED THROUGHOUT THE BARRICADED AREA OF EACH BAY WHERE THE CLOSURE TIME IS GREATER THAN FOURTEEN DAYS.
- THIS APPLICATION ALSO APPLIES WHEN WORK IS BEING PERFORMED IN THE RIGHT LANE(S) AND THE RIGHT TURN BAY IS TO REMAIN OPEN. UNDER THIS CONDITION, "RIGHT TURN LANE" R3-100 24 X 24 AND M6-2R 21 X 15 SHALL BE USED.
- THESE CONTROLS SHALL SUPPLEMENT MAINLINE TRAFFIC CONTROL FOR LANE CLOSURES. LONGITUDINAL DIMENSIONS MAY BE ADJUSTED TO FIT FIELD CONDITIONS.
- TRAFFIC CONTROL AND PROTECTION AT TURN BAYS (TO REMAIN OPEN TO TRAFFIC) SHALL BE INCLUDED IN THE COST SPECIFIED TRAFFIC CONTROL STANDARDS OR ITEMS. ALL DIMENSIONS ARE IN INCHES UNLESS OTHERWISE NOTED.

REVISED - 10-14-11	REGION 2 / DISTRICT 2 STANDARD				F.A. R.T.E.	SECTION	COUNTY	TOTAL SHEET NO.
REVISED -	SCALE: 1:8000 / in.	SHEET NO.	OF	SHEETS	STA.	TO STA.	ILLINOIS FED. AID PROJECT	CONTRACT NO.
REVISED -	TRAFFIC CONTROL AND PROTECTION AT TURN BAYS (TO REMAIN OPEN TO TRAFFIC) 94.2							

85567

SHEET 16/16