

| F.A.S. RTE. | SECTION | COUNTY | TOTAL SHEETS | SHEET NO. |
|-----------------------|----------------|--------------------|--------------|-----------|
| 334 | 08-00130-02-BR | IROQUOIS | 27 | 1 |
| FED. ROAD DIST. NO. 7 | ILLINOIS | CONTRACT NO. 87524 | | |

STATE OF ILLINOIS
DEPARTMENT OF TRANSPORTATION
PLANS FOR PROPOSED
HIGHWAY BRIDGE PROGRAM
IROQUOIS COUNTY
SECTION 08-00130-02-BR
F.A.S. 334 (CH 9) OVER LOUIS CREEK TRIBUTARY
PROJECT NO. BRS-0334(113)
JOB NUMBER C-93-067-12

INDEX OF SHEETS

| SHEET NO. | DESCRIPTION |
|-----------|--|
| 1. | COVER SHEET |
| 2. | GENERAL NOTES, DETAILS, TYPICAL SECTIONS |
| 3. | SUMMARY OF QUANTITIES, SCHEDULES OF QUANTITIES |
| 4. | TRAFFIC CONTROL PLAN |
| 5. | EROSION CONTROL PLAN |
| 6. | PLAN AND PROFILE |
| 7.-21. | STRUCTURE PLANS |
| 22.-27. | CROSS SECTIONS |

REQUIRED HIGHWAY STANDARDS

- 000001-06
- 280001-06
- 442201-03
- 515001-03
- 601101-01
- 630301-05
- 631032-07
- 635006-03
- 701901-02
- BLR 21-9

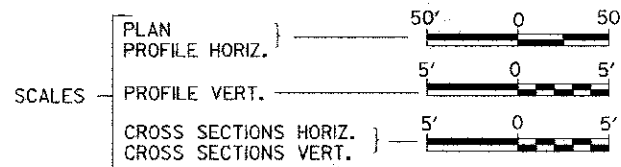
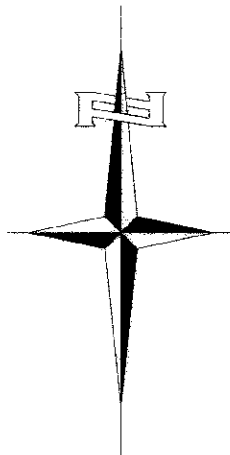

PROPOSED STRUCTURE SN 038-3014
 SINGLE SPAN STEEL I BM STRUCTURE
 ON INTEGRAL ABUTMENTS, 67'-0" BK.
 TO BK., AND 30'-0" O. TO O. DECK,
 NO SKEW

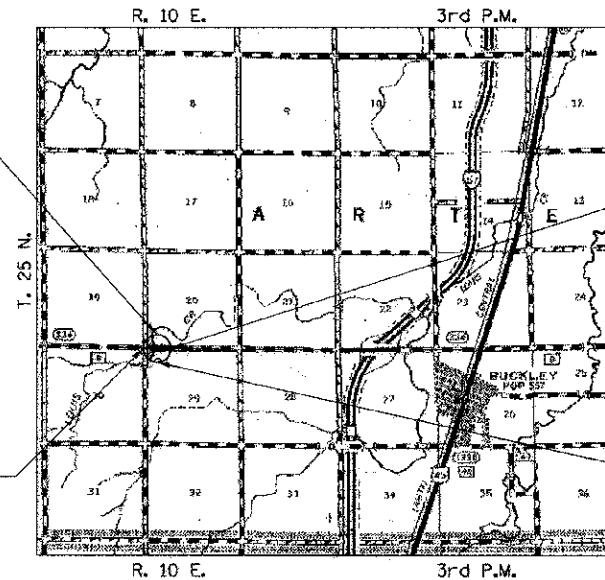

SECTION 08-00130-02-BR
 ENDS
 STATION 217+00.00

SECTION 08-00130-02-BR
 BEGINS
 STATION 213+00.00

EXISTING STRUCTURE SN 038-3000
 SINGLE SPAN T-BEAM WITH CONCRETE
 DECK ON CONCRETE CLOSED ABUTMENTS,
 ±32'-0" BK. TO BK., ±27'-0" O. TO O.,
 NO SKEW (TO BE REMOVED)

LOCATION MAP

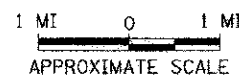

NET LENGTH OF PROJECT = 400.00 FEET = 0.076 MILES
 DESIGN CLASSIFICATION: MAJOR COLLECTOR (NON-URBAN)
 DESIGN ADT = 925 (32)
 DESIGN SPEED = 50 MPH

Hutchison Engineering, Inc.
 JACKSONVILLE-SHOREWOOD-PEORIA

2012 JOB#2969

PLANS DESIGNED IN ACCORDANCE WITH BUREAU
 OF LOCAL ROADS AND STREETS MANUAL GUIDELINES
 FOR TWO LANE RURAL COLLECTORS - 3R GUIDELINES

APPROVED: June 4, 2012

[Signature]
 IROQUOIS COUNTY ENGINEER

PASSED: June 14, 2012

[Signature]
 PROJECT IMPLEMENTATION ENGINEER

Released For
 Bid Based on
 Limited Review June 14, 2012

[Signature]
 DEPUTY DIRECTOR OF HIGHWAYS,
 REGION TWO ENGINEER

STATE OF ILLINOIS
 DEPARTMENT OF TRANSPORTATION

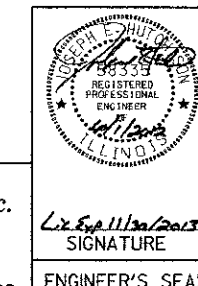

UTILITY COMPANIES

AMEREN CIPS
 PAXTON, ILLINOIS

EASTERN ILLINELECTRICAL COOPERATIVE
 PAXTON, ILLINOIS

FRONTIER COMMUNICATIONS
 BLOOMINGTON, ILLINOIS

J.U.L.I.E.
 JOINT UTILITY LOCATION INFORMATION FOR EXCAVATION
 1-800-892-0123
 OR 811

CONTRACT NO. 87524

2969E001