

POT STA 207+00.00  
MAG NAIL

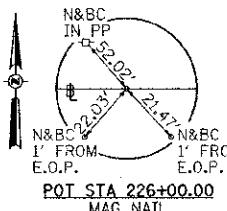

POT STA 226+00.00  
MAG NAIL

T 25 N, R 10 E, 3rd PM  
SECTION 20

LILLIAN SALZWEDEL

CULTIVATED

EXISTING STRUCTURE SN 038-3000  
TO BE REMOVED

- ① PROPOSED CLASS D PATCHES, TYPE III, 8 INCH
- ② PROPOSED CLASS D PATCHES, TYPE IV, 8 INCH

CULTIVATED

PROPOSED TRAFFIC BARRIER TERMINALS, TYPE 6A AND TYPE I (SPECIAL) TANGENT

B SURVEY & C CONSTRUCTION

SECTION 08-00130-02-BR  
ENDS  
STATION 217+00.00

SECTION 08-00130-02-BR  
BEGINS  
STATION 213+00.00

BM OPP

208

209

210

211

212

213

214

215

216

217

218

219

220

221

222

EXISTING R.O.W.

(HMA)

40'

50'

40'

50'

40'

50'

40'

50'

40'

50'

40'

50'

40'

50'

40'

50'

40'

50'

40'

50'

40'

50'

40'

50'

40'

50'

40'

50'

40'

50'

40'

50'

40'

50'

40'

50'

40'

50'

40'

50'

40'

50'

40'

50'

40'

50'

40'

50'

40'

50'

40'

50'

40'

50'

40'

50'

40'

50'

40'

50'

40'

50'

40'

50'

40'

50'

40'

50'

40'

50'

40'

50'

40'

50'

PROPOSED TRAFFIC BARRIER TERMINALS, TYPE 6A AND TYPE I (SPECIAL) TANGENT

PROPOSED STRUCTURE SN 038-3014  
STATION 214+96.00  
SEE SH.#7 THRU 21 FOR DETAILS  
SEE SH.#7 FOR HYDRAULICS

DONALD & BARBARA GROSCOP

T 25 N, R 10 E, 3rd PM  
SECTION 29

LEGEND

- PROPOSED PAVEMENT PATCHING
- PROPOSED RIPRAP PLACEMENT
- SPECIAL DITCH WITH FLOW DIRECTION

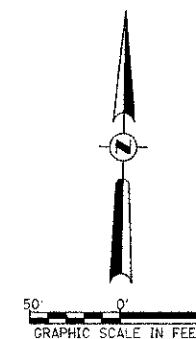

PLAN	SURVEYED	DATE
	PLOTTED	
	NOTED	
	BY	
	DATE	

PROFILE	SURVEYED	DATE
	PLOTTED	
	NOTED	
	BY	
	DATE	

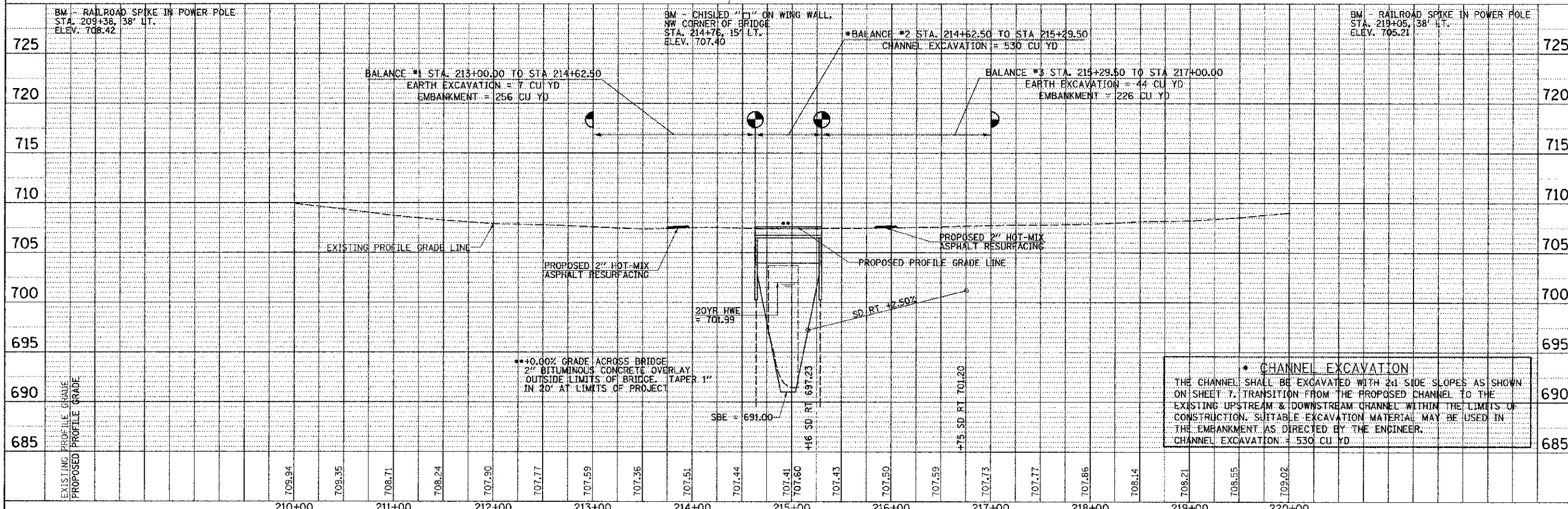

FILE NAME =	USER NAME = jhutonson	DESIGNED -	REVISED -	F.A.S. RTE.	SECTION	COUNTY	TOTAL SHEETS	SHEET NO.
V:\Bridges\2189-Iroquois\2189P001.dwg		DRAWN -	REVISED -	334	08-00130-02-BR	IRROQUOIS	27	6
		CHECKED -	REVISED -					
		DATE -	REVISED -					

IROQUOIS COUNTY  
COUNTY HIGHWAY 9 OVER  
LOUIS CREEK TRIBUTARY

PLAN AND PROFILE

SCALE: 1"=50' SHEET NO. 1 OF 1 SHEETS STA. 213+00.00 TO STA. 217+00.00

FED. ROAD DIST. NO. 7 ILLINOIS FED. AID PROJECT BR5-0334(113)