

CONTRACT NO.	SECTION	COUNTY	TOTAL SHEETS	SHEET NO.
89585	*	MARSHALL COUNTY	16	9
* SECTION 10-00001-00-SW		ILLINOIS		

FIELDCREST
MIDDLE
SCHOOL

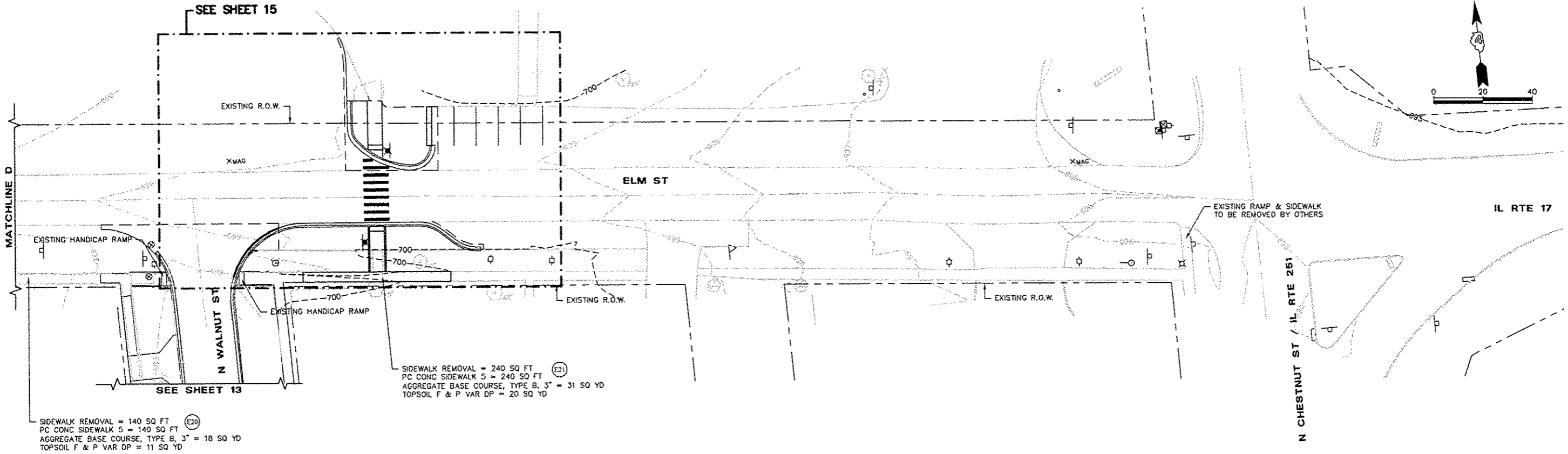

SIDEWALK REMOVAL = 140 SQ FT (E20)
 PC CONC SIDEWALK 5 = 140 SQ FT
 AGGREGATE BASE COURSE, TYPE B, 3" = 18 SQ YD
 TOPSOIL F & P VAR DP = 11 SQ YD

SIDEWALK REMOVAL = 240 SQ FT (E21)
 PC CONC SIDEWALK 5 = 240 SQ FT
 AGGREGATE BASE COURSE, TYPE B, 3" = 31 SQ YD
 TOPSOIL F & P VAR DP = 20 SQ YD

NOTE: EARTH EXCAVATION WILL NOT BE MEASURED FOR PAYMENT
 BUT SHALL BE CONSIDERED INCIDENTAL TO PC CONC SIDEWALK 5.

McClure
 Engineering Associates, Inc.
 1138 Columbus Street, Ottawa, Illinois 61350
 (618) 433-7080 FAX 618/433-5930
 Design Firm License: Illinois 184-000818
 Copyright 2011 By McClure Engineering Associates, Inc.

REVISIONS		NAME	DATE	ELM STREET / IL RTE 17 PLAN SHEET
NO.	DESCRIPTION			
1		KED	11/5/12	

SCALE: AS NOTED DRAWN BY: KED
 DATE: 2011 CHECKED BY: SMK
 FILE: G:\Drawings\Monona\10-0001-00-SW-09 Revise\09 PS A.dwg