

CONTRACT NO.	SECTION	COUNTY	TOTAL SHEETS	SHEET NO.
89585	*	MARSHALL COUNTY	16	12
* SECTION 10-0001-00-SW		ILLINOIS		

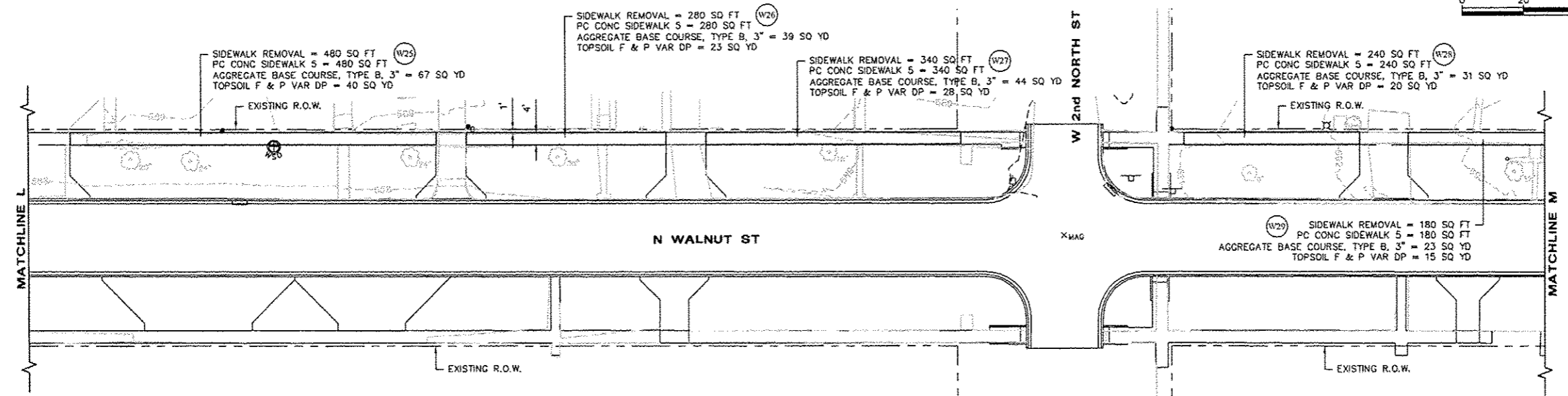
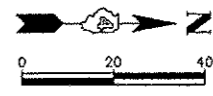
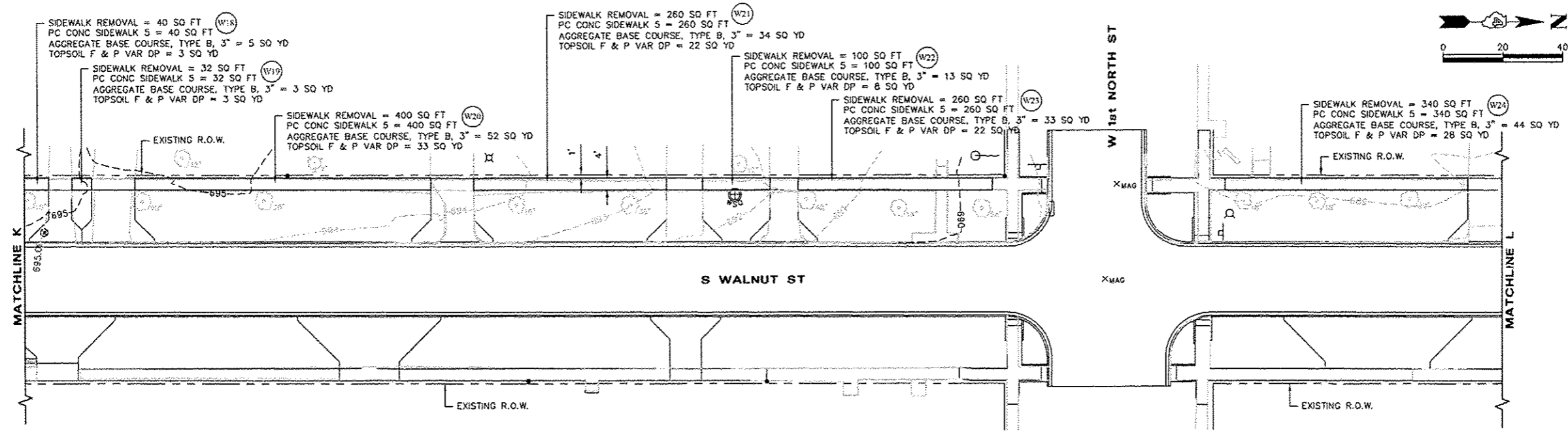

NOTE: EARTH EXCAVATION WILL NOT BE MEASURED FOR PAYMENT BUT SHALL BE CONSIDERED INCIDENTAL TO PC CONC SIDEWALK 5.

McClure
Engineering Associates, Inc.
1136 Columbus Street
Ottawa, Illinois 61350
18151 433-7080
Fax 18151 433-9930
Design Firm License: Illinois 18A-000818
Copyright 2011 By McClure Engineering Associates, Inc.

REVISIONS	
NAME	DATE
KED	11/5/12

**WALNUT STREET
PLAN SHEET**

SCALE: AS NOTED
DATE: 2011
FILE: Q:\Drawings\Winona\10-0001-00-Sw Route\12 PS 7.dwg

DRAWN BY: KED
CHECKED BY: SMK