

STATE OF ILLINOIS
 DEPARTMENT OF TRANSPORTATION
 DIVISION OF HIGHWAYS
 PLANS FOR PROPOSED
 FEDERAL-AID HIGHWAY BRIDGE PROGRAM

TR 167
 WAYNE COUNTY
 SECTION 08-18110-00-BR
 STRUCTURE NO. 096-3448
 PROJECT NO. BROS-191(059)
 JOB NO. C-97-106-09

INDEX OF SHEETS

- 1 COVER SHEET
- 2 PLAN & PROFILE
- 3 CROSS SECTIONS
- 4-10 BRIDGE PLANS
- 11-12 BORINGS

STANDARDS: 280001-07 - EROSION CONTROL
 515001-03 - NAME PLATES
 701901-02 - TRAFFIC CONTROL
 BLR 21-9 - TRAFFIC CONTROL
 BLR 22-7 - TRAFFIC CONTROL
 6/25/06/26

SUMMARY OF QUANTITIES

0.6	ACRE	SEEDING, CLASS 2 (SPECIAL)	X2501000
102	TON	AGGREGATE DITCH (SPECIAL)	X2830495
1	L SUM	TRAFFIC CONTROL AND PROTECTION, (SPECIAL)	X7010216
50	UNIT	TREE REMOVAL (OVER 15 UNITS DIAMETER)	20100210
0.67	ACRE	TREE REMOVAL, ACRES	20100500
383	CU YD	EARTH EXCAVATION	20200100
290	CU YD	CHANNEL EXCAVATION	20300100
1,884	CU YD	FURNISHED EXCAVATION	20400800
48	FOOT	TEMPORARY DITCH CHECKS	28000305
60	FOOT	PERIMETER EROSION BARRIER	28000400
168	TON	STONE DUMPED RIPRAP, CLASS A4	28100807
560	TON	AGGREGATE BASE COURSE, TYPE B	35101400
1	EACH	REMOVE EXISTING STRUCTURES	50100100
25.2	CU YD	CONCRETE STRUCTURES	50300225
2.8	CU YD	CONCRETE ENCASEMENT	50300280
1,800	SQ FT	PRECAST PRESTRESSED CONCRETE DECK BEAMS (33" DEPTH)	50400605
2,660	POUND	REINFORCEMENT BARS	50800105
146	FOOT	STEEL RAILING, TYPE S1	50900205 *
435	FOOT	FURNISHING STEEL PILES HP 12 X 53	51201600
435	FOOT	DRIVING PILES	51202305
1	EACH	TEST PILE STEEL HP 12 X 53	51203600
1	EACH	NAME PLATES	51500100
40	FOOT	PIPE CULVERTS, CLASS D, TYPE 1 15"	542D0220
1	L SUM	MOBILIZATION	67100100

* SPECIALTY ITEMS

SCALES

- PLAN 1 INCH = 50 FEET
- PROFILE HORZ. 1 INCH = 50 FEET
- PROFILE VERT. 1 INCH = 10 FEET
- CROSS SECTION 1 INCH = 5 FEET

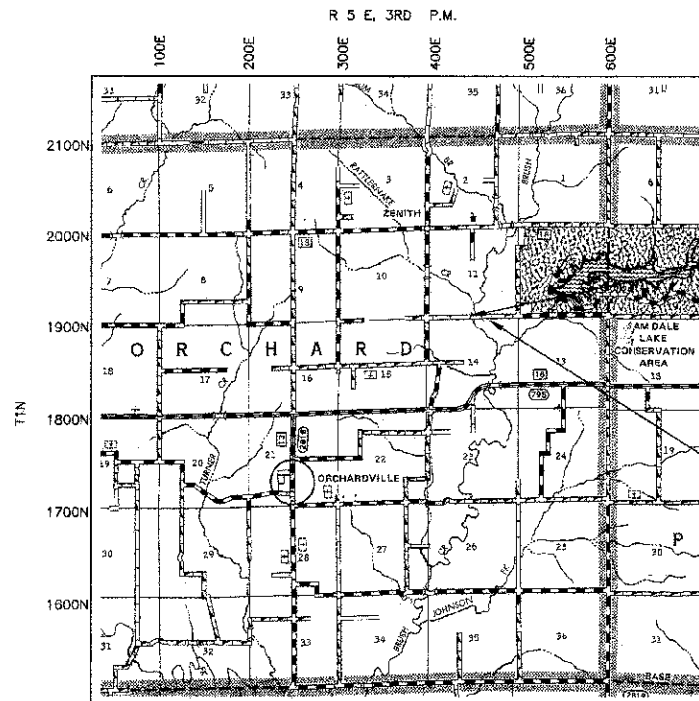

SECTION 08-18110-00-BR
 BEGINS STA. 0+00

STA. 3+48 - SPECIAL BRIDGE DESIGN
 PROPOSED PRECAST PRESTRESSED CONCRETE
 DECK BEAM BRIDGE, 1 SPAN @ 75'
 FILE BENT SPILL-THRU ABUTMENTS
 24' ROWY., SKEW = 0'
 PROPOSED STRUCT. NO. 096-3448
 EXISTING STRUCT. NO. 096-3078

SECTION 08-18110-00-BR
 ENDS STA. 8+00

FUNCTIONAL CLASS: RURAL LOCAL ROAD
 ADT = 50
 DESIGN SPEED = 30 MPH

LOCATION MAP

APPROXIMATE SCALE: 1 INCH = 1 MILE
 NET LENGTH = 800 L.F. = 0.152 MILES



John A. Stone
 10/30/2012
 ILLINOIS REGISTERED PROFESSIONAL ENGINEER # 55012
 LICENSE EXPIRES NOVEMBER 30, 2013

PROFESSIONAL DESIGN FIRM #184-000832

TOLL FREE U-GIT UTILITY LOCATING
 INFORMATION FOR EXCAVATORS (J.U.L.I.E.)
 TELEPHONE NO. 1-800-892-0122 OR 811

ILLINOIS DEPARTMENT OF TRANSPORTATION	
APPROVED	10/30, 2012
<i>Wayne Henderson</i> WAYNE COUNTY ENGINEER	
PASSED	11/15, 2012
<i>Murphy</i> DISTRICT SEVEN ENGINEER OF LOCAL ROADS & STREETS	
RELEASING FOR BID BASED ON LIMITED REVIEW	11/15, 2012
<i>Roger D. Drachler</i> DEPUTY DIRECTOR OF HIGHWAYS REGION FOUR ENGINEER STATE OF ILLINOIS DEPARTMENT OF TRANSPORTATION	