

ROUTE	SECTION	COUNTY	TOTAL SHEETS	SHEET NO.
TR 272A	10-04119-00-BR	SALINE	12	2
PROJECT NO. BROS-165(35)			CONTRACT NO. 99479	

B.M. - Double nail in Power Pole  
 20' Lt. Station 16+46  
 Assumed Elev. 385.00  
 (Approximately equal to 369.0 USGS)

Existing Structure - Timber deck on steel stringers with closed concrete abutments. 19.9' W x 55.6' L.

Station 15+00 - Single span precast prestressed concrete deck beam bridge  
 82'-2 1/8" bk-bk Abutments  
 Skewed 40° Rt. Forward

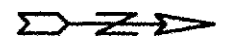
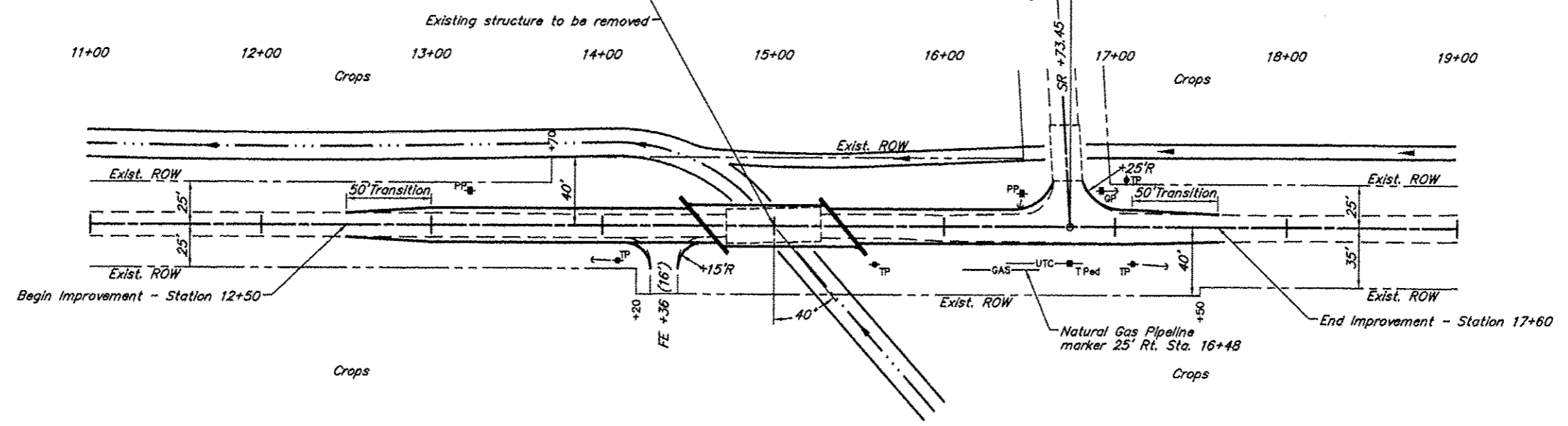

SCALES:  
 1" = 80' HOR  
 1" = 10' VER

