

051

01-18-2019 LETTING ITEM 051

STATE OF ILLINOIS
DEPARTMENT OF TRANSPORTATION

F.A.P. RTE.	SECTION	COUNTY	TOTAL SHEETS	SHEET NO.
796	(104)CR	FORD	10	1
ILLINOIS			CONTRACT NO. 66J42	

INDEX OF SHEETS

1. COVER SHEET
2. GENERAL NOTES
3. SUMMARY OF QUANTITIES
4. TYPICAL SECTION
5. SCHEDULES
- 6 - 7. CULVERT DETAILS
- 8 - 9. CLASS B PATCHING DETAILS
10. DETAILS

STANDARDS

- | | |
|-----------|--|
| 000001-07 | STANDARD SYMBOLS, ABBREVIATIONS AND PATTERNS |
| 001006 | DECIMAL OF AN INCH AND OF A FOOT |
| 542306-03 | PRECAST REINFORCED CONCRETE ELLIPTICAL FLARED END SECTION |
| 701001-02 | OFF-ROAD OPERATIONS 2L, 2W, MORE THAN 15' (4.5 m) AWAY |
| 701006-05 | OFF-ROAD OPERATIONS 2L, 2W, 15' (4.5 m) TO 24" (600 mm) FROM PAVEMENT EDGE |
| 701201-05 | LANE CLOSURE, 2L, 2W, DAY ONLY, FOR SPEEDS \geq 45 MPH |
| 701206-05 | LANE CLOSURE, 2L, 2W, NIGHT ONLY, FOR SPEEDS \geq 45 MPH |
| 701301-04 | LANE CLOSURE, 2L, 2W, SHORT TIME OPERATIONS |
| 701901-08 | TRAFFIC CONTROL DEVICES |

**PROPOSED
HIGHWAY PLANS**
F.A.P. ROUTE 796 (IL 115)
SECTION (104)CR
PROJECT
BOX CULVERT REMOVAL AND REPLACEMENT
FORD COUNTY

C-93-090-18



FUNCTIONAL CLASSIFICATION

RURAL
MAJOR COLLECTOR
F.A.P. ROUTE 796 (IL 115)
2017 ADT = 700
P.V. 80.0% S.U. 11.4% M.U. 8.6%

PROJECT LOCATION

3'x2' CONCRETE BOX CULVERT
STA: 1084+33
0.7 MILES SOUTH OF MAIN STREET
IN CABERY

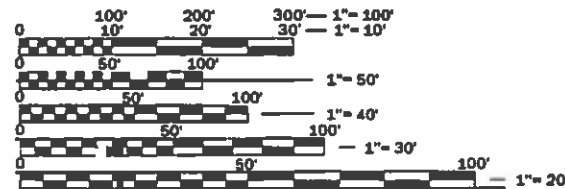

FULL SIZE PLANS HAVE BEEN PREPARED USING STANDARD ENGINEERING SCALES. REDUCED SIZED PLANS WILL NOT CONFORM TO STANDARD SCALES. IN MAKING MEASUREMENTS ON REDUCED PLANS, THE ABOVE SCALES MAY BE USED.

J.U.L.I.E.
JOINT UTILITY LOCATION INFORMATION FOR EXCAVATION
1-800-892-0123
OR 811

PROJECT ENGINEER JOE KANNEL P.E.
UNIT CHIEF RON WOODSHANK
DISTRICT 3 NO. (815) 434-6131

CONTRACT NO. 66J42

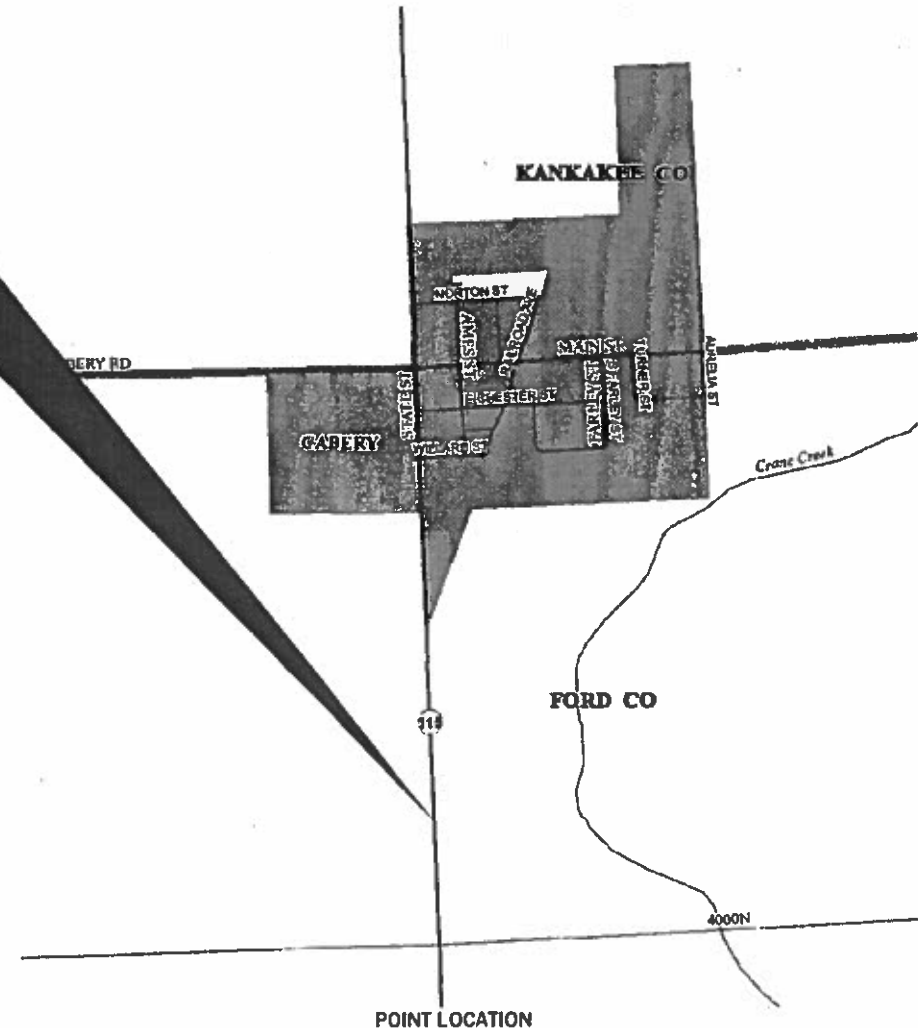

STATE OF ILLINOIS
DEPARTMENT OF TRANSPORTATION

SUBMITTED 10/18/2018
[Signature] REGIONAL ENGINEER

Dec 7 2018
[Signature] ENGINEER OF DESIGN AND ENVIRONMENT

Dec 20 2018
[Signature] DIRECTOR OF HIGHWAYS PROJECT IMPLEMENTATION

PRINTED BY THE AUTHORITY
OF THE STATE OF ILLINOIS

GENERAL NOTES

PLAN DIMENSIONS AND DETAILS RELATIVE TO EXISTING PLANS ARE SUBJECT TO NOMINAL CONSTRUCTION VARIATIONS. THE CONTRACTOR SHALL FIELD VERIFY EXISTING DIMENSIONS AND DETAILS AFFECTING NEW CONSTRUCTION AND MAKE NECESSARY APPROVED ADJUSTMENTS PRIOR TO CONSTRUCTION OR ORDERING OF MATERIALS. SUCH VARIATIONS SHALL NOT BE CAUSE FOR ADDITIONAL COMPENSATION FOR A CHANGE IN SCOPE OF WORK; HOWEVER, THE CONTRACTOR WILL BE PAID FOR THE QUANTITY ACTUALLY FURNISHED AT THE UNIT PRICE BID FOR THE WORK.

EXCEPT AS NOTED ON THE PLANS, PAVEMENT GRADES SHOWN ARE AT THE TOP OF PAVEMENT SURFACES.

BEFORE ORDERING PIPE CULVERTS OR PIPE DRAINS, THE CONTRACTOR SHALL CONSULT THE ENGINEER FOR EXACT LENGTHS.

FOR STABILIZATION, ALL TYPE III BARRICADES WILL REQUIRE A MINIMUM OF FOUR SAND BAGS PER BARRICADE.

PERMANENT SEEDING WILL NOT BE PERMITTED AT ANY TIME WHEN THE GROUND IS FROZEN, WET, OR IN AN UNTILLABLE CONDITION.

THE FINISHED EARTHWORK SHALL HAVE A VEGETATION SUSTAINING SOIL COVERING THE TOP FOUR INCHES (100 MILLIMETERS) IN AREAS TO BE SEEDED OR SODDED. THE VEGETATION SUSTAINING SOIL REQUIRED WILL NOT BE PAID FOR SEPARATELY BUT WILL BE INCLUDED IN THE COST OF FURNISHED EXCAVATION.

ALL ELEVATIONS REFERRING TO U.S.G.S. MEAN SEA LEVEL DATUM.

ABANDONED UNDERGROUND UTILITIES THAT CONFLICT WITH CONSTRUCTION SHALL BE DISPOSED OF OUTSIDE THE LIMITS OF THE RIGHT OF WAY ACCORDING TO ARTICLE 202.03 OF THE STANDARD SPECIFICATIONS AND AS DIRECTED BY THE ENGINEER. THIS WORK WILL NOT BE PAID FOR SEPARATELY, BUT WILL BE INCLUDED IN THE COST OF EARTH EXCAVATION.

THE FOLLOWING RATES OF APPLICATION HAVE BEEN USED IN CALCULATING PLAN QUANTITIES:

GRANULAR MATERIALS	2.05	TONS / CU YD
--------------------	------	--------------

COMMITMENTS

STATE OF ILLINOIS
DEPARTMENT OF TRANSPORTATION
DISTRICT THREE
AS BUILT INFORMATION

SUPERVISING CONSTRUCTION FIELD ENGINEER

RESIDENT ENGINEER / TECHNICIAN

START & END DATES
OF CONSTRUCTION:

INSPECTORS:

STATE OF ILLINOIS
DEPARTMENT OF TRANSPORTATION
DISTRICT THREE

PREPARED BY: *Don Bennett*
DISTRICT STUDIES & PLANS ENGINEER

DATE: 10-18-18

EXAMINED BY: *Kyle Vidaguro*
DISTRICT CONSTRUCTION ENGINEER

Michael Ashurst
DISTRICT MATERIALS ENGINEER

Tommy
DISTRICT OPERATIONS ENGINEER

FILE NAME =	USER NAME = woodshankr	DESIGNED - RW	REVISED -
pw:\IL\084EBID\INTEG.\ilnols.gov\FW\DOT\Documents\DOT Office\District 3\Projects\0366J42\CA0\Detail\66J42-cover.dgn		DRAWN - RW	REVISED -
	PLOT SCALE = 100.0000' / in.	CHECKED - JW	REVISED -
Default	PLOT DATE = 9/14/2018	DATE - 7/12/2018	REVISED -

STATE OF ILLINOIS
DEPARTMENT OF TRANSPORTATION

GENERAL NOTES

SCALE: SHEET 1 OF 1 SHEETS STA. TO STA.

F.A.P. RTE.	SECTION	COUNTY	TOTAL SHEETS	SHEET NO.
798	(104)CR	FORD	10	2
			CONTRACT NO. 66J42	
ILLINOIS FED. AID PROJECT				

CODE NO.	ITEM	UNIT	TOTAL QUANTITY	CONSTRUCTION CODE	
				CONTRACT MAINTENANCE .	
				100% STATE	
				PIPE CULVERT	
		0004		RURAL	
20400800	FURNISHED EXCAVATION	CUYD	11.6	11.6	
20800150	TRENCH BACKFILL	CUYD	5.2	5.2	
28000400	PERIMETER EROSION BARRIER	FOOT	200	200	
44200982	CLASS B PATCHES, TYPE 11, 11 INCH	SQYD	18	18	
44201299	DOWEL BARS 1 1/2"	EACH	40	40	
44213200	SAW CUTS	FOOT	79	79	
48101200	AGGREGATE SHOULDERS, TYPE B	TON	41	41	
50100100	REMOVAL OF EXISTING STRUCTURES	EACH	1	1	
542A5485	PIPE CULVERTS, CLASS A, TYPE 1 EQUIVALENT ROUND-SIZE 30"	FOOT	32	32	
54214725	PRECAST REINFORCED CONCRETE FLARED END SECTIONS - ELLIPTICAL, EQUIVALENT ROUND-SIZE 30"	EACH	2	2	
63500310	REMOVE AND REINSTALL DELINEATORS	EACH	2	2	
67100100	MOBILIZATION	LSUM	1	1	
70100450	TRAFFIC CONTROL AND PROTECTION, STANDARD 701201	LSUM	1	1	
Z0030850	TEMPORARY INFORMATION SIGNING	SQFT	42	42	

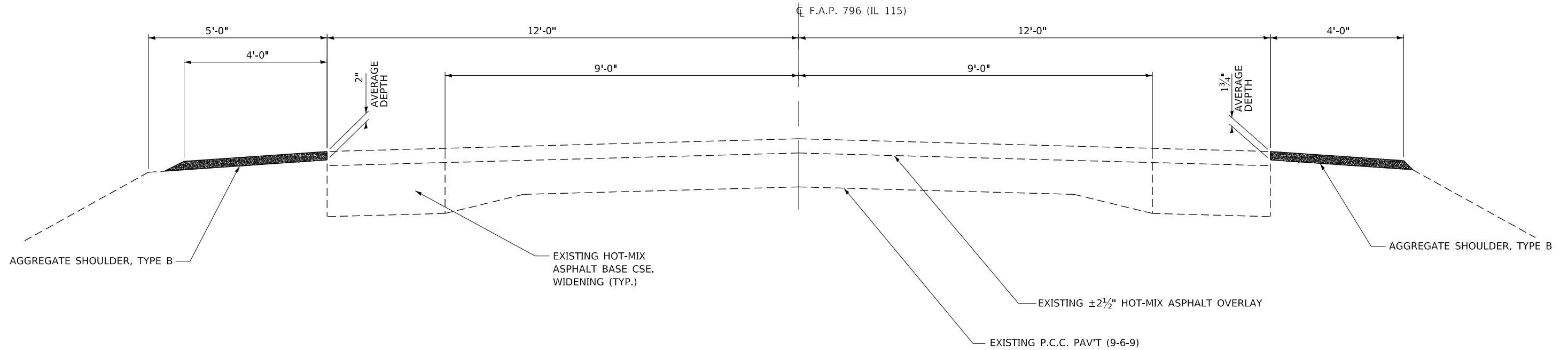

TYPICAL SECTION
STA. 1083+00 TO STA. 1087+00
 LOOKING SOUTH

FILE NAME =	USER NAME = woodshank1	DESIGNED - RW	REVISED -
pw:\IL084EBIDINTEG\Illinois.gov\PWIDOT\Documents\DOT Offices\District 3\Projects\0366J42\CADDData\66J42-cover.dgn		DRAWN - RW	REVISED -
Default	PLOT SCALE = 100,0000' / in.	CHECKED - JW	REVISED -
	PLOT DATE = 9/14/2018	DATE - 7/12/2018	REVISED -

STATE OF ILLINOIS
DEPARTMENT OF TRANSPORTATION

TYPICAL SECTION	
SCALE:	SHEET 1 OF 1 SHEETS STA. TO STA.

F.A.P. RTE.	SECTION	COUNTY	TOTAL SHEETS	SHEET NO.
796	(104)CR	FORD	10	4
CONTRACT NO. 66J42				
ILLINOIS FED. AID PROJECT				

DRAINAGE SCHEDULE

LOCATION	REMOVE EXISTING STRUCTURE	PIPE CULVERTS CLASS A, TY 1 EQRS 30"	PRC FLARED END SECTION ELLIPTICAL EQRS 30"
STATION	EACH	FOOT	EACH
1084+33 LT.	0.5	16	1
1084+33 RT.	0.5	16	1
TOTAL	1	32	2

PATCHING SCHEDULE

LOCATION	CLASS B PATCH TYPE II 11"	SAW CUTS	DOWEL BARS
STATION	SQ YD	FT	EACH
1084+33 LT.	9	43	20
1084+33 RT.	9	36	20
TOTAL	18	79	40

AGGREGATE SCHEDULE

LOCATION				TRENCH BACKFILL	AGGREGATE SHOULDERS TYPE B
STATION	TO	STATION	LT/RT	CU YD	TON
1083+00	TO	1084+29	LT		7
1083+00	TO	1084+29	RT		6
1084+29	TO	1084+37	LT	2.6	1
1084+29	TO	1084+37	RT	2.6	1
1084+37	TO	1087+00	LT		14
1084+37	TO	1087+00	RT		12
TOTAL				5.2	41

EXCAVATION SCHEDULE

LOCATION	FURNISHED EXCAVATION
STATION	CU YD
1084+33 LT.	5.8
1084+33 RT.	5.8
TOTAL	11.6

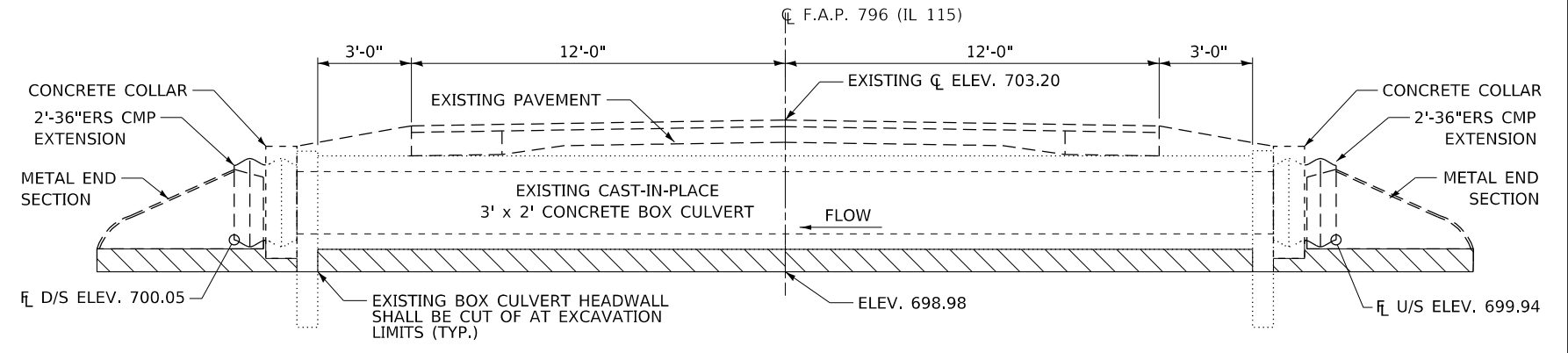
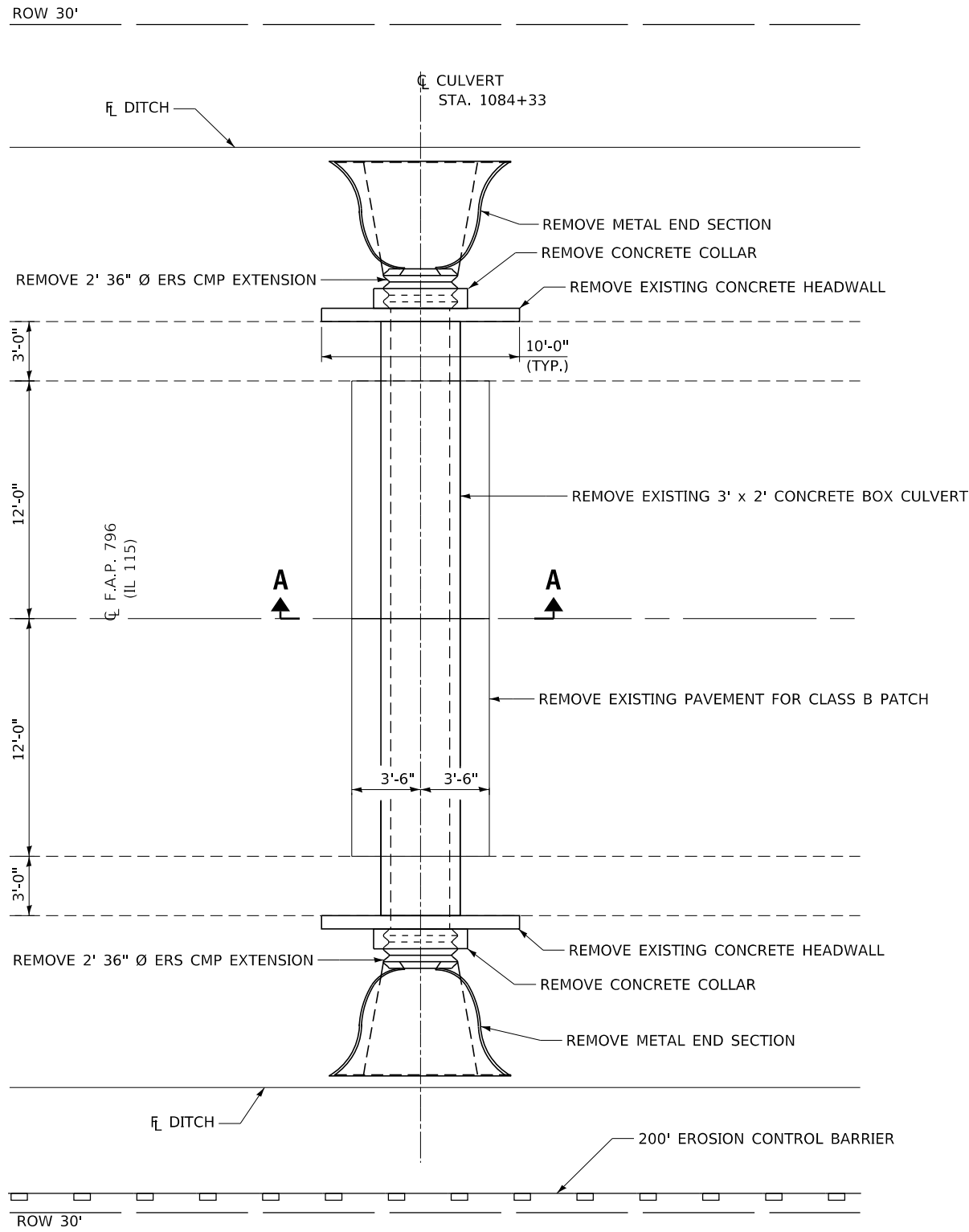

CROSS SECTION

STA. 1084+33
LOOKING SOUTH

LEGEND

- LIMITS OF EXCAVATION
- PAVEMENT REMOVAL FOR CLASS B PATCH

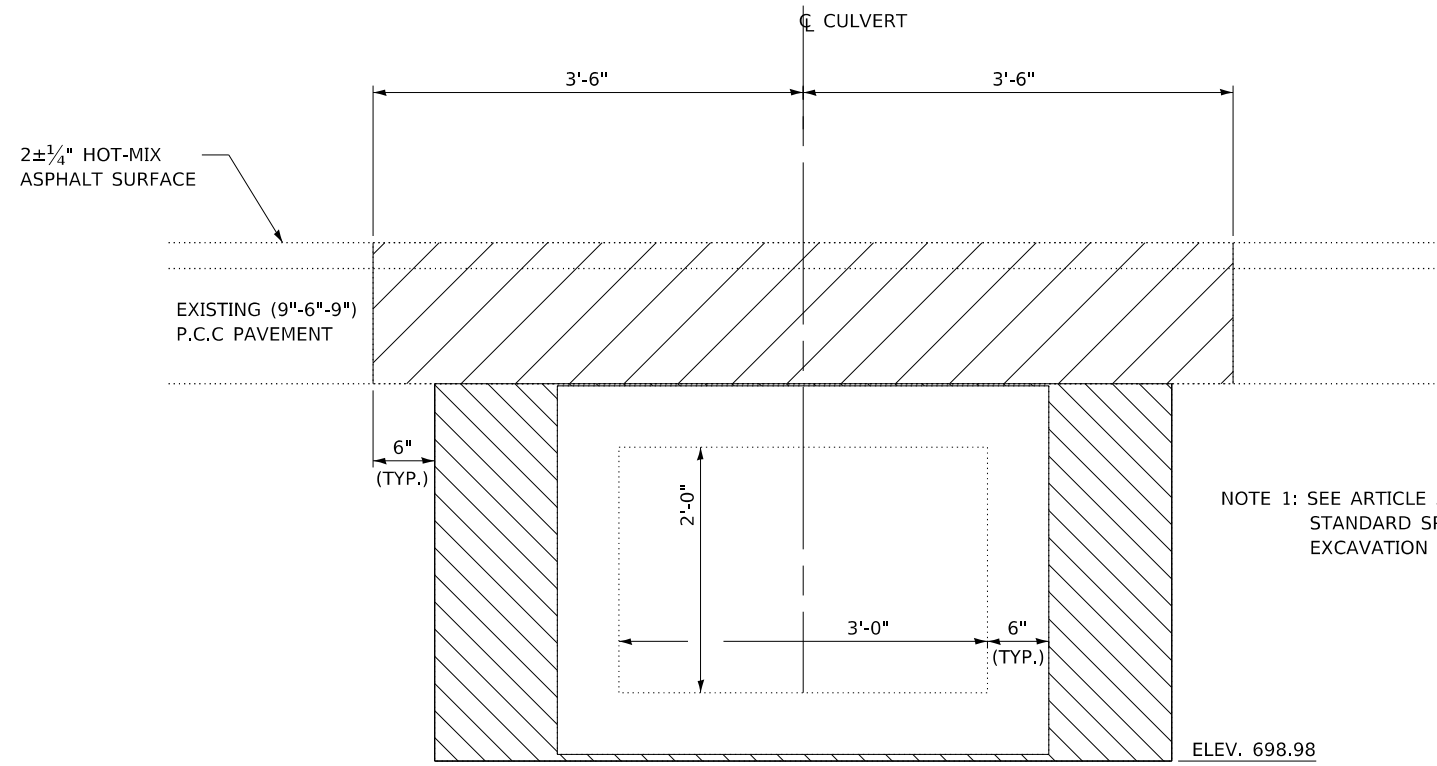

NOTE 1: SEE ARTICLE 542.04 OF THE STANDARD SPECIFICATIONS FOR EXCAVATION LIMITS

SECTION A-A

FILE NAME =	USER NAME = woodshank1	DESIGNED - RW	REVISED -
pw:\IL084EB\INTEG\Illinois.gov\PWIDOT\Documents\DOT\Office\District 3\Projects\13\66J42\CADData\66J42-cover.dgn		DRAWN - RW	REVISED -
		CHECKED - JW	REVISED -
		DATE - 7/12/2018	REVISED -

STATE OF ILLINOIS
DEPARTMENT OF TRANSPORTATION

EXISTING CULVERT DETAILS

SCALE: SHEET 1 OF 1 SHEETS STA. TO STA.

F.A.P. RTE.	SECTION	COUNTY	TOTAL SHEETS	SHEET NO.
798	(104)CR	FORD	10	6
CONTRACT NO. 66J42				
ILLINOIS FED. AID PROJECT				

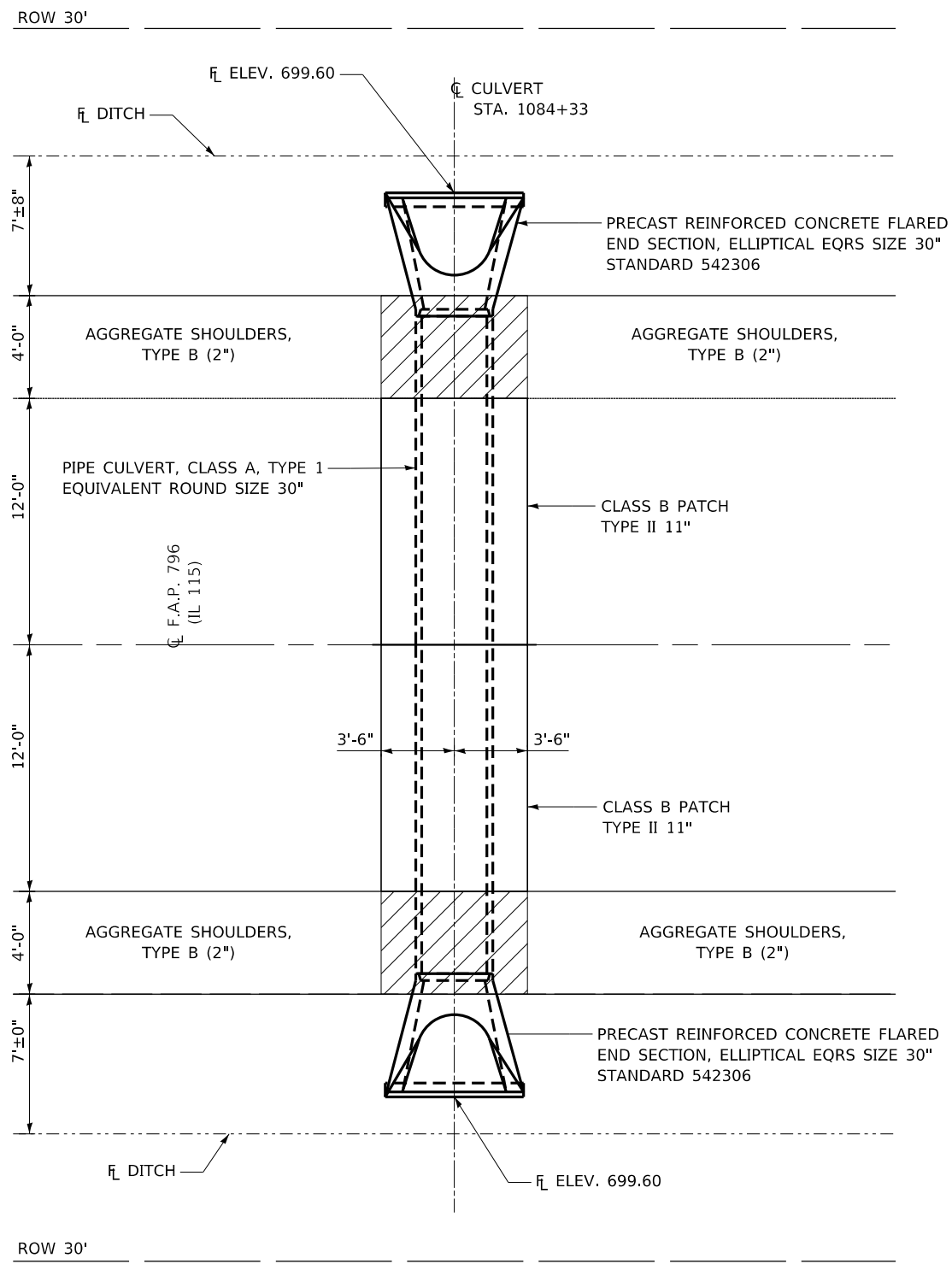

PLAN

STA. 1084+33

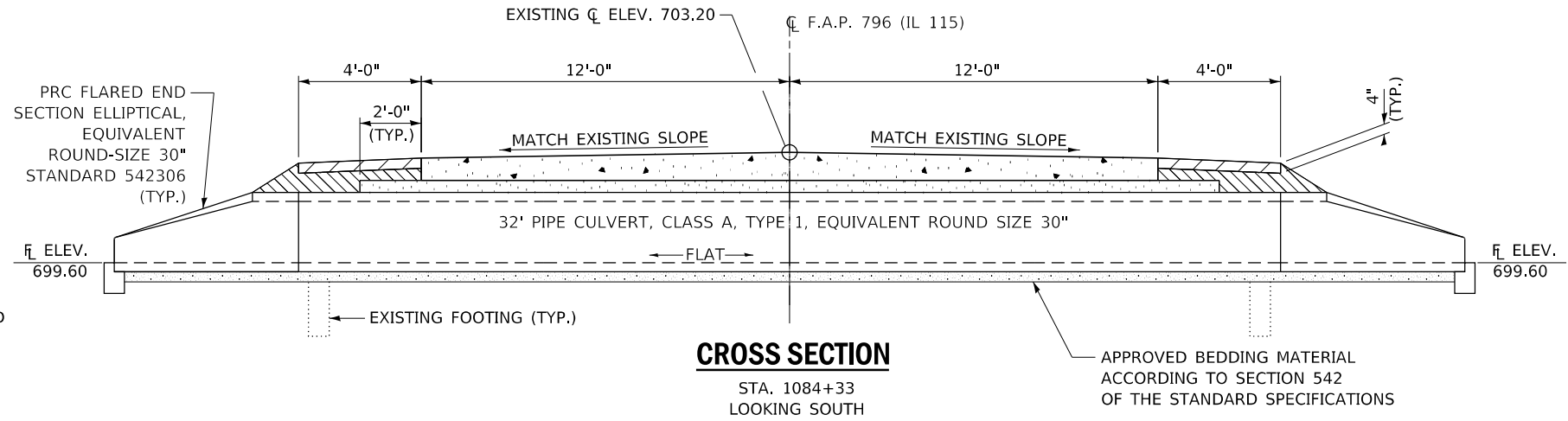

CROSS SECTION

STA. 1084+33
LOOKING SOUTH

LEGEND

- SUITABLE EXCAVATED MATERIAL OR FURNISHED EXCAVATION
- CLASS B PATCH, 11"
- TRENCH BACKFILL
- AGGREGATE SHOULDERS, TYPE B (4")
- AGGREGATE SUBBASE ACCORDING TO SECTION 542 OF THE STANDARD SPECIFICATIONS

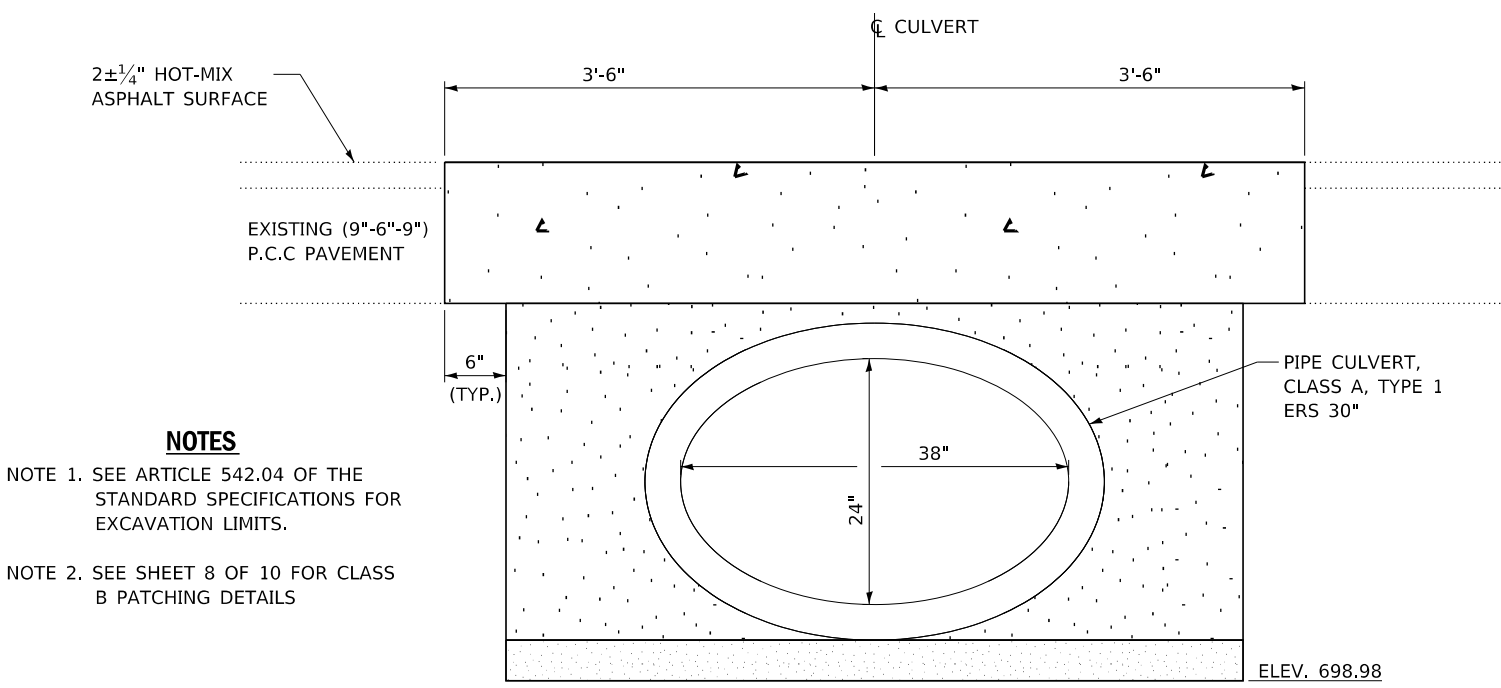

PROPOSED SECTION A-A

- NOTES**
- NOTE 1. SEE ARTICLE 542.04 OF THE STANDARD SPECIFICATIONS FOR EXCAVATION LIMITS.
 - NOTE 2. SEE SHEET 8 OF 10 FOR CLASS B PATCHING DETAILS

FILE NAME =	USER NAME = woodshank1	DESIGNED - RW	REVISED -
pw:\IL084EB\INTEG\Illinois.gov\PWIDOT\Documents\DOT Offices\District 3\Projects\10366\42\CADData\66J42-cover.dgn		DRAWN - RW	REVISED -
Default	PLOT SCALE = 100,0000' / in.	CHECKED - JW	REVISED -
	PLOT DATE = 9/14/2018	DATE - 7/12/2018	REVISED -

**STATE OF ILLINOIS
DEPARTMENT OF TRANSPORTATION**

PROPOSED CULVERT DETAILS

SCALE: SHEET 1 OF 1 SHEETS STA. TO STA.

F.A.P. RTE. 798	SECTION (104)CR	COUNTY FORD	TOTAL SHEETS 10	SHEET NO. 7
			CONTRACT NO. 66J42	
ILLINOIS FED. AID PROJECT				

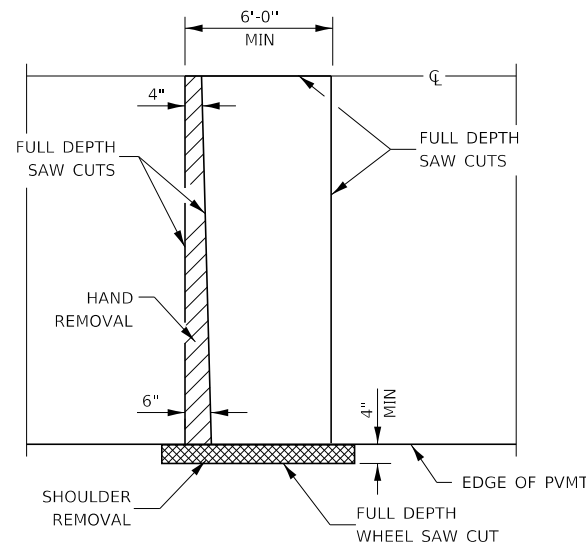

PAVEMENT SAWING DETAIL

(HMA SHOULDER)

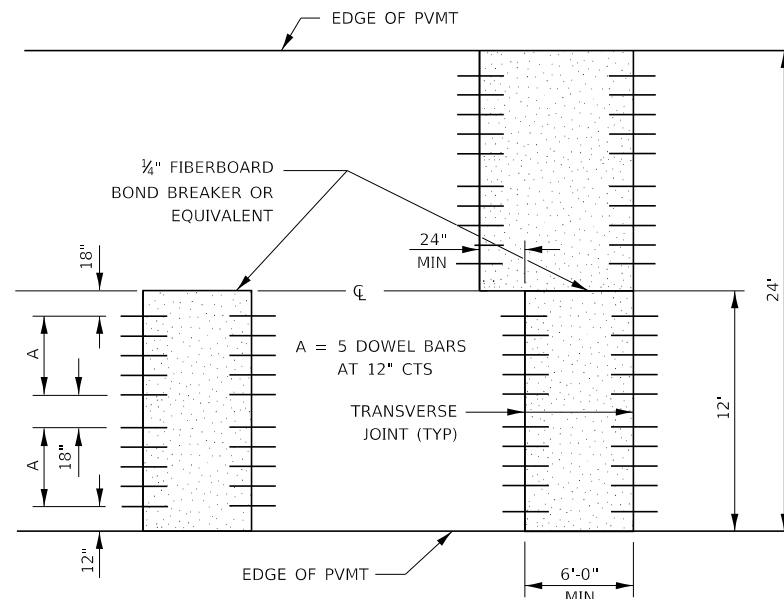

12' WIDE LANES

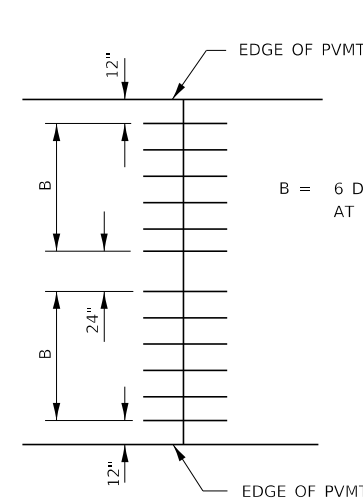

14' WIDE RAMP

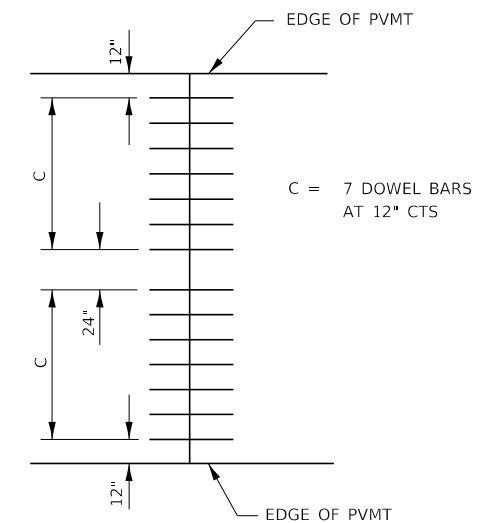

16' WIDE RAMP

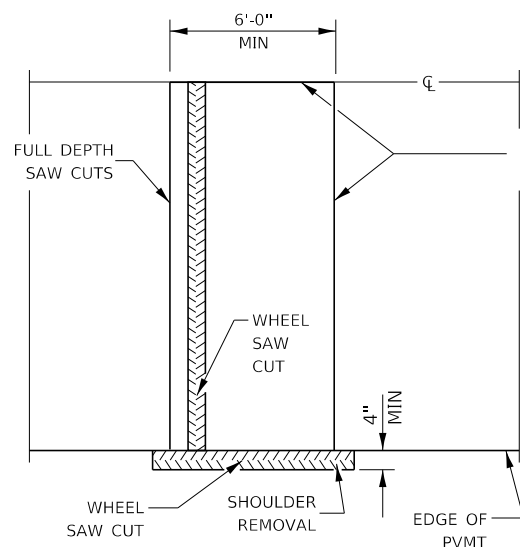

ALTERNATE SAWING DETAIL

(HMA SHOULDER)

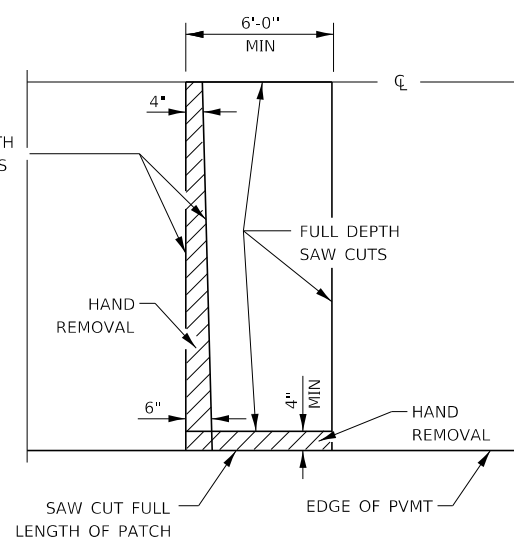

PAVEMENT SAWING DETAIL

(PCC SHOULDER)

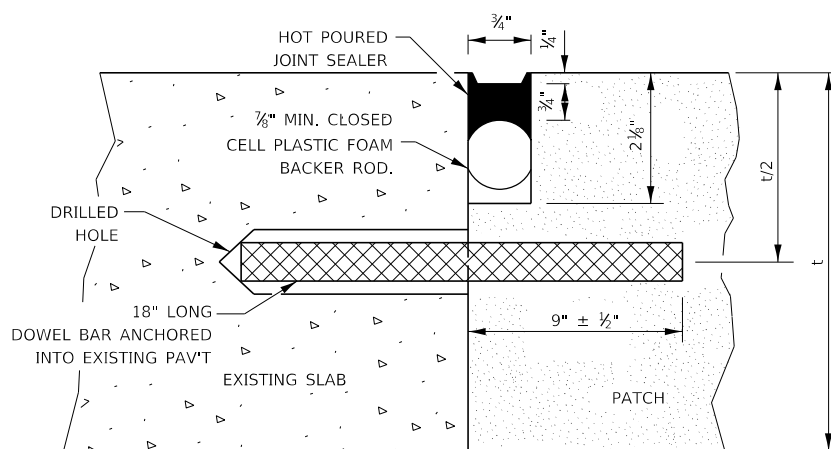

TRANSVERSE JOINT

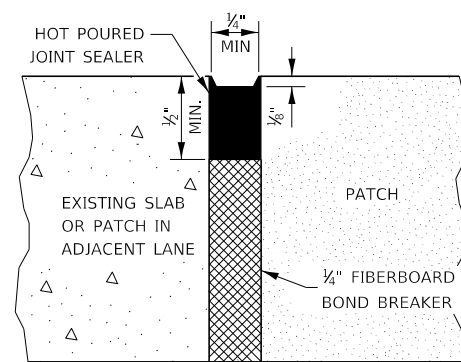

CENTERLINE JOINT

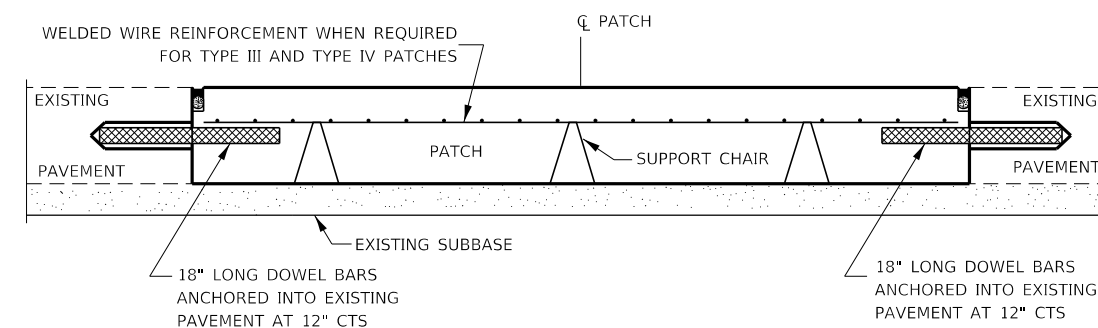

PATCHING WITHOUT HMA OVERLAY

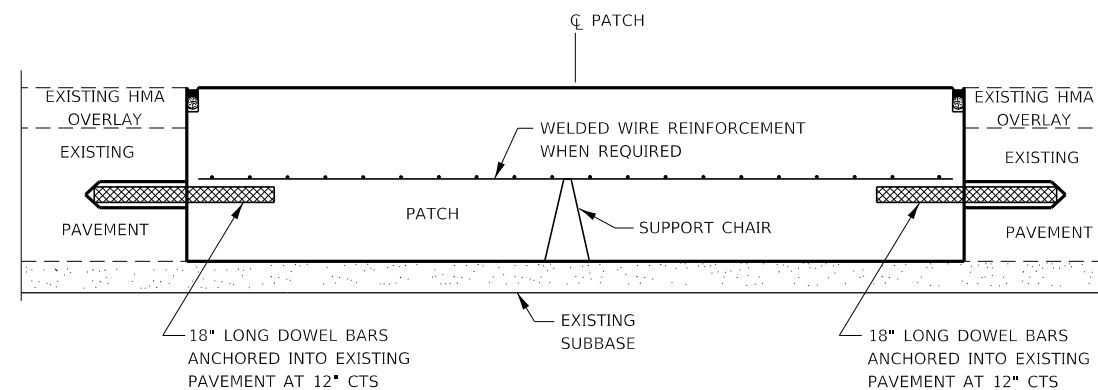

PATCHING WITH HMA OVERLAY

DOWEL BAR TABLE		
PAVEMENT THICKNESS	DOWEL BAR DIAMETER	HOLE DIAMETER
8" OR GREATER	1 1/2"	1 3/8"
7" THRU 7.99"	1 1/4"	1 3/8"
LESS THAN 7"	1"	1 1/8"

GENERAL NOTES

THE TRANSVERSE JOINTS FOR CLASS B PATCHES SHALL ALIGN WITH JOINTS OR CRACKS IN THE ADJACENT LANE WHENEVER POSSIBLE.

FILE NAME =	USER NAME = woodshank1	DESIGNED - RW	REVISED -
pw:\IL084EB\INTEG\Illinois.gov\PWIDOT\Documents\DOT\Office\District 3\Projects\13\66J42\CADD\166J42-cover.dgn		DRAWN - RW	REVISED -
	PLOT SCALE = 100,0000' / in.	CHECKED - JW	REVISED -
Default	PLOT DATE = 9/14/2018	DATE - 7/12/2018	REVISED -

**STATE OF ILLINOIS
DEPARTMENT OF TRANSPORTATION**

CLASS B PATCHING DETAILS

SCALE: SHEET 1 OF 2 SHEETS STA. TO STA.

F.A.P. RTE.	SECTION	COUNTY	TOTAL SHEETS	SHEET NO.
798	(104)CR	FORD	10	8
CONTRACT NO. 66J42				
ILLINOIS FED. AID PROJECT				

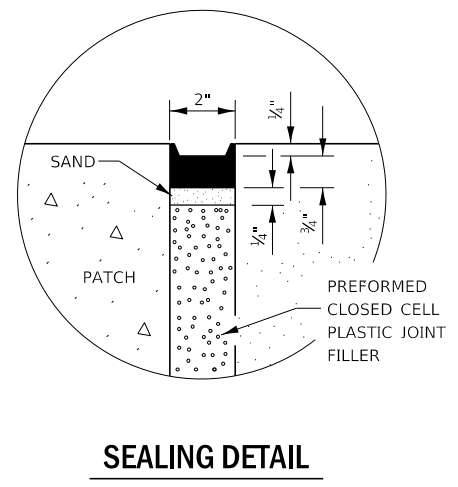
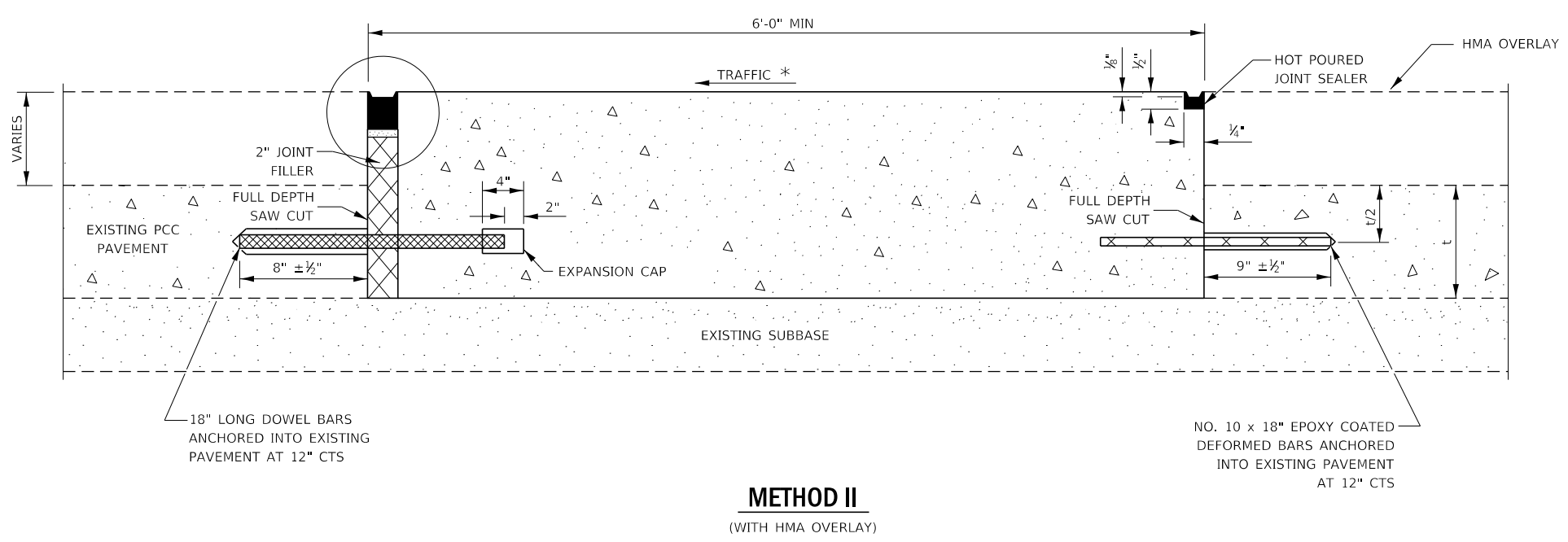
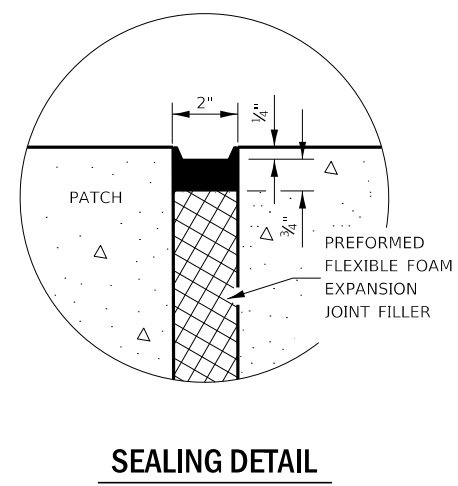
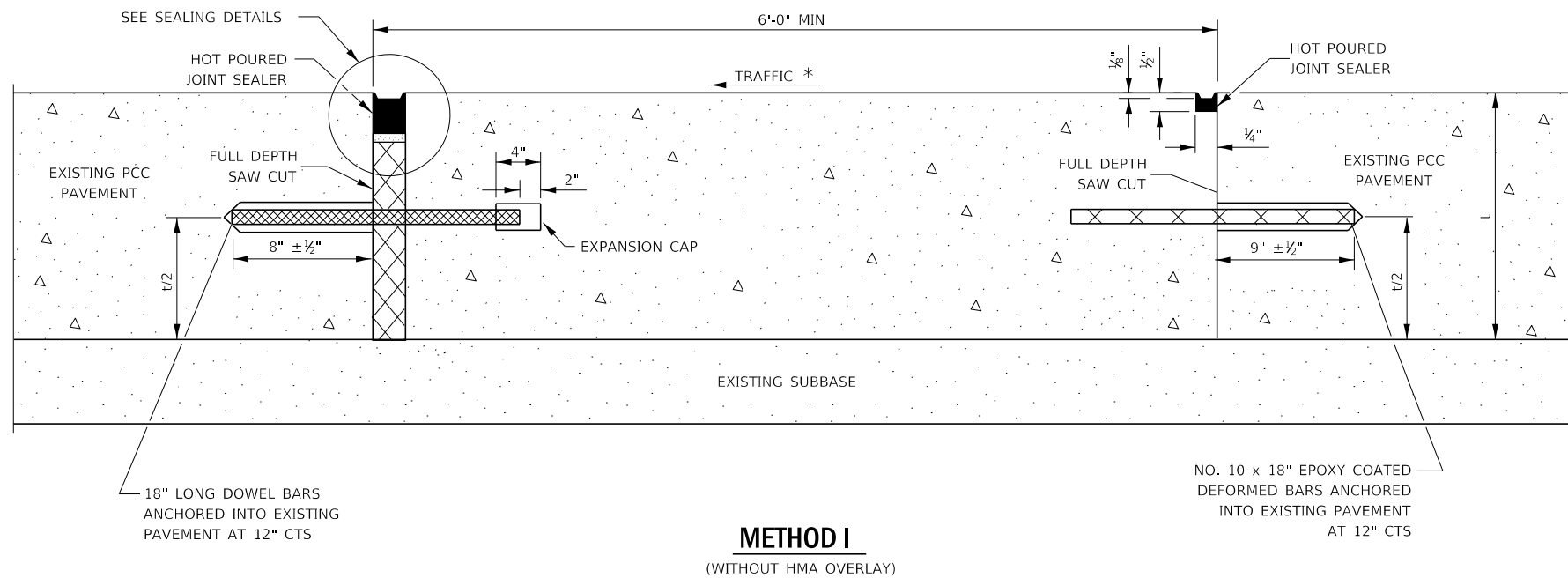

NOTE
* WHEN RE-ESTABLISHING A TRANSVERSE EXPANSION JOINT ON A TWO-WAY ROAD, REVERSE THE ORIENTATION OF THE DOWEL BARS WITH RESPECT TO TRAFFIC FOR ONE OF THE PATCHES SUCH THAT THE JOINT WILL BE CONTINUOUS ACROSS BOTH LANES.

FILE NAME =	USER NAME = woodshank1	DESIGNED - RW	REVISED -	STATE OF ILLINOIS DEPARTMENT OF TRANSPORTATION	CLASS B PATCHING DETAILS			F.A.P. RTE.	SECTION	COUNTY	TOTAL SHEETS	SHEET NO.
pw\1\084EB\INTEG\Illinois.gov\PWIDOT\Documents\DOT Offices\District 3\Projects\0366\42\CADData\66J42-cover.dgn		DRAWN - RW	REVISED -					798	(104)CR	FORD	10	9
Default	PLOT SCALE = 100,0000 / in.	CHECKED - JW	REVISED -		SCALE: SHEET 2 OF 2 SHEETS STA. TO STA.			CONTRACT NO. 66J42				
	PLOT DATE = 9/14/2018	DATE - 7/12/2018	REVISED -					ILLINOIS FED. AID PROJECT				

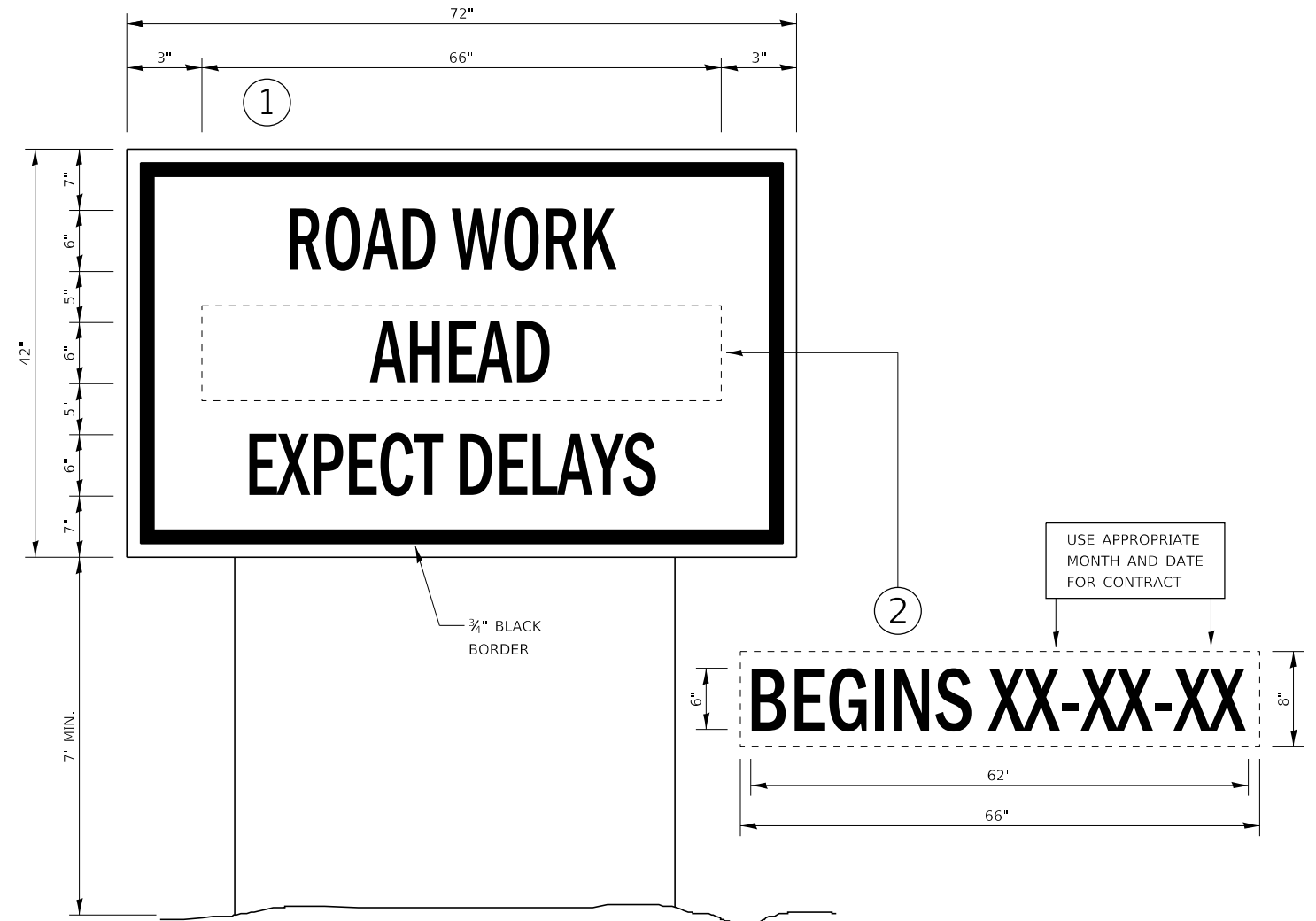

TEMPORARY INFORMATION SIGNING

NOTES:

1. USE 6" D BLACK LETTERING ON FLUORESCENT ORANGE BACKGROUND.
2. ERECT SIGNS AT LOCATIONS IN ADVANCE OF THE "ROAD CONSTRUCTION AHEAD" SIGNS AS DIRECTED BY THE ENGINEER.
3. ERECT SIGN ① WITH INSTALLED PANEL ② A MINIMUM OF ONE WEEK PRIOR TO THE START OF THE LANE CLOSURE.
4. REMOVE PANEL ② ON THAT DATE.
5. SEE SPECIAL PROVISION "TEMPORARY INFORMATION SIGNING" FOR ADDITIONAL INFORMATION.
6. WILL BE PAID FOR PER SQ FT AS "TEMPORARY INFORMATION SIGNING". EACH SIGN = 21 SQ FT AND THE DATE PANEL ② WILL NOT BE MEASURED SEPARATELY FOR PAYMENT.

FILE NAME =	USER NAME = woodshank1	DESIGNED - RW	REVISED -	STATE OF ILLINOIS DEPARTMENT OF TRANSPORTATION	DETAILS			F.A.P. RTE.	SECTION	COUNTY	TOTAL SHEETS	SHEET NO.
pw:\IL084EBIDINTEG\Illinois.gov\PWIDOT\Documents\DOT Offices\District 3\Projects\0366J42\CADDData\66J42-cover.dgn		DRAWN - RW	REVISED -		798	(104)CR	FORD	10	10			
Default	PLOT SCALE = 100.0000' / in.	CHECKED - JW	REVISED -		CONTRACT NO. 66J42			ILLINOIS FED. AID PROJECT				
	PLOT DATE = 9/14/2018	DATE - 7/12/2018	REVISED -		SCALE:	SHEET 1 OF 1 SHEETS	STA.	TO STA.				