

STATE OF ILLINOIS  
DEPARTMENT OF TRANSPORTATION

FILE NO.	SECTION	COUNTY	TOTAL SHEETS	SHEET NO.
187-3HB-1BP		HENRY	24	1
		ILLINOIS	CONTRACT NO. 64N09	

D-92-054-18

FOR INDEX OF SHEETS, SEE SHEET NO. 2  
FOR STATE STANDARDS, SEE SHEET NO. 2

# PROPOSED HIGHWAY PLANS

FAI ROUTE 74 (I-74)  
SECTION: (37-3HB-1)BP  
PROJECT: NHPP-W8N3(372)  
TYPE of IMPROVEMENT: BRIDGE PAINTING  
HENRY COUNTY

C-92-083-18



HENRY COUNTY  
WESTERN TOWNSHIP - SECTION 36  
LYNN TOWNSHIP - SECTION 1

SN 037-0104

R.1E.



T.16N./T.15N.

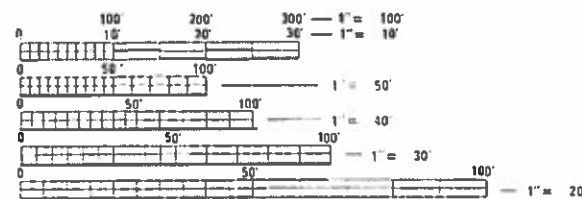

FULL SIZE PLANS HAVE BEEN PREPARED USING STANDARD  
ENGINEERING SCALES. REDUCED SIZED PLANS WILL NOT  
CONFORM TO STANDARD SCALES. IN MAKING MEASUREMENTS  
ON REDUCED PLANS, THE ABOVE SCALES MAY BE USED.

J.U.L.I.E.  
JOINT UTILITY LOCATION INFORMATION FOR EXCAVATION  
1-800-892-0123  
OR 811

PROJECT ENGINEER: DAVID DOSS (815) 284-5416  
PROJECT MANAGER: MAHMOUD ETEMADI (815) 284-5393

CONTRACT NO. 64N09

STATE OF ILLINOIS  
DEPARTMENT OF TRANSPORTATION

SUBMITTED 10-5-2018  
*[Signature]*  
REGIONAL ENGINEER

Dec 7 2018  
*[Signature]*  
ENGINEER OF DESIGN AND ENVIRONMENT

Dec 7 2018  
*[Signature]*  
DIRECTOR OF HIGHWAYS PROJECT IMPLEMENTATION

PRINTED BY THE AUTHORITY  
OF THE STATE OF ILLINOIS

# INDEX OF SHEETS

- 1 COVER SHEET
- 2 INDEX OF SHEETS / STATE STANDARDS / GENERAL NOTES
- 3 SUMMARY OF QUANTITIES
- 4 SCHEDULE OF QUANTITIES
- 5 STAGING TYPICAL
- 6-9 TRAFFIC CONTROL PLAN - STAGE I FOR SN 037-0104
- 10-13 TRAFFIC CONTROL PLAN - STAGE II FOR SN 037-0104
- 14-17 TRAFFIC CONTROL PLAN - STAGE III FOR SN 037-0104
- 18-21 TRAFFIC CONTROL PLAN - STAGE IV FOR SN 037-0104
- 22-24 EXISTING PLAN SHEETS (FOR INFORMATION ONLY)

# STATE STANDARDS

- 701101-05 OFF-ROAD OPERATIONS, MULTILANE, 15' (4.5m) TO 24" (600mm) FROM PAVEMENT EDGE
- 701301-04 LANE CLOSURE, 2L, 2W, SHORT TIME OPERATIONS
- 701400-09 APPROACH TO LANE CLOSURE, FREEWAY/EXPRESSWAY
- 701401-12 LANE CLOSURE, FREEWAY/EXPRESSWAY
- 701402-12 LANE CLOSURE, FREEWAY/EXPRESSWAY WITH BARRIER
- 701426-09 LANE CLOSURE, MULTILANE, INTERMITTENT OR MOVING OPERATIONS, FOR SPEEDS  $\geq$  45 MPH
- 701901-08 TRAFFIC CONTROL DEVICES
- 704001-08 TEMPORARY CONCRETE BARRIER
- 720011-01 METAL POSTS FOR SIGNS, MARKERS & DELINEATORS
- 728001-01 TELESCOPING STEEL SIGN SUPPORT
- 729001-01 APPLICATIONS OF TYPES A & B METAL POSTS (FOR SIGNS & MARKERS)

# GENERAL NOTES

A MINIMUM OF 2 AIR MONITORS WILL BE REQUIRED TO MONITOR ABRASIVE BLASTING OPERATIONS, SEE SPECIAL PROVISION FOR "CONTAINMENT AND DISPOSAL OF LEAD PAINT CLEANING RESIDUES".

THE CONTRACTOR SHALL SEED ALL DISTURBED AREAS WITHIN THE PROJECT LIMITS. SEEDING CLASS 2A SHALL BE USED. THIS WORK WILL BE INCLUDED IN THE CONTRACT UNIT PRICE PER LUMP SUM FOR CLEANING AND PAINTING STEEL BRIDGE NO. 1.

FERTILIZER SHALL BE APPLIED TO ALL DISTURBED AREAS AND INCORPORATED INTO THE SEEDBED PRIOR TO SEEDING OR PLACEMENT OF SOD AT THE RATE SPECIFIED IN SECTIONS 250 AND 252 OF THE STANDARD SPECIFICATIONS. THIS WORK SHALL BE INCLUDED IN THE COST OF CLEANING AND PAINTING STEEL BRIDGE NO. 1.

MULCH METHOD II SHALL BE APPLIED OVER ALL SEEDED AREAS. THIS SHALL BE INCLUDED IN THE COST OF THE CLEANING AND PAINTING STEEL BRIDGE NO. 1.

ALL BORROW/WASTE/USE SITES MUST BE APPROVED BY THE DEPARTMENT PRIOR TO REMOVING ANY MATERIAL FROM THE PROJECT OR INITIATING ANY EARTHMOVING ACTIVITIES, INCLUDING TEMPORARY STOCKPILING OUTSIDE THE LIMITS OF CONSTRUCTION.

TEMPORARY IMPACT ATTENUATORS WILL BE MEASURED AS EACH FOR EACH ATTENUATOR SUPPLIED ON THE JOB AS SPECIFIED IN THE PLANS, AND SHALL INCLUDE THE COST OF RENTING/OWNING THE ATTENUATOR FOR THE TIME REQUIRED ON THE JOB PLUS HAULING TO AND FROM THE PROJECT SITE, AS WELL AS ONE PLACEMENT AND REMOVAL FROM THE ROADWAY. THIS SHALL BE PAID FOR AT THE CONTRACT UNIT PRICE PER EACH FOR IMPACT ATTENUATORS, TEMPORARY OF THE TYPE SPECIFIED.

RELOCATE TEMPORARY IMPACT ATTENUATOR WILL BE PAID FOR AS EACH AND WILL BE PAID FOR EACH TIME THE ATTENUATOR IS REQUIRED BY STAGING TO BE PICKED UP AND MOVED TO A DIFFERENT LOCATION ON THE PROJECT, WHETHER IT IS TO ANOTHER LOCATION ON THE ROADWAY OR TO A STORAGE/STAGING LOCATION FOR THE PROJECT. THIS SHALL BE PAID FOR AT THE CONTRACT UNIT PRICE PER EACH FOR IMPACT ATTENUATORS, RELOCATE OF THE TYPE SPECIFIED.

THIS WORK SHALL BE DONE IN ACCORDANCE WITH SECTION 704 OF THE STANDARD SPECIFICATIONS. TEMPORARY CONCRETE BARRIER WILL BE MEASURED IN FEET ALONG THE CENTERLINE OF THE BARRIER AND SHALL INCLUDE THE COST OF RENTING/OWNING THE BARRIER FOR THE TIME REQUIRED ON THE JOB PLUS HAULING TO AND FROM THE PROJECT SITE, AS WELL AS ONE PLACEMENT AND REMOVAL FROM THE ROADWAY IN ACCORDANCE WITH SECTION 704 OF THE STANDARD AND SPECIFICATION. THIS SHALL BE PAID FOR AT THE CONTRACT UNIT PRICE PER FOOT FOR TEMPORARY CONCRETE BARRIER.

RELOCATE TEMPORARY CONCRETE BARRIER WILL BE PAID FOR IN FEET ALONG THE CENTERLINE OF THE BARRIER, AND WILL BE PAID FOR EACH TIME THE BARRIER IS REQUIRED BY STAGING TO BE PICKED UP AND MOVED TO A DIFFERENT LOCATION ON THE PROJECT, WHETHER IT IS TO ANOTHER LOCATION ON THE ROADWAY OR TO A STORAGE/STAGING LOCATION FOR THE PROJECT. THIS SHALL BE PAID FOR AT THE CONTRACT UNIT PRICE PER FOOT FOR RELOCATE TEMPORARY CONCRETE BARRIER.

THE CONTRACTOR SHALL BE RESPONSIBLE FOR PROTECTING UTILITY PROPERTY DURING CONSTRUCTION OPERATIONS AS OUTLINED IN ARTICLE 107.31 OF THE STANDARD SPECIFICATIONS. A MINIMUM OF 48 HOURS ADVANCE NOTICE IS REQUIRED FOR NON-EMERGENCY WORK. THE JULIE NUMBER IS 800-892-0123.

THE SSPC QP1 & QP2 CONTRACT CERTIFICATIONS WILL BE REQUIRED FOR THIS CONTRACT.

MODEL: Default  
FILE: \\nas0101\B&E\BID\NTEC\Illinois\gov\PIV\DOT\Documents\1007-9\104616109\CADD\02-shr-convec.dgn

USER NAME = drossdd	DESIGNED - _____	REVISED - _____	<b>STATE OF ILLINOIS DEPARTMENT OF TRANSPORTATION</b>	<b>INDEX OF SHEETS, STATE STANDARDS &amp; GENERAL NOTES</b>		F.A.I. RTE.	SECTION	COUNTY	TOTAL SHEETS	SHEET NO.
	DRAWN - _____	REVISED - _____		74	(37-3HB-1)BP	HENRY	24	2		
PLOT SCALE = 40.0000 ' / in.	CHECKED - _____	REVISED - _____		CONTRACT NO. 64N09						
PLOT DATE = Oct-01-2018 01:54:13 PM	DATE - _____	REVISED - _____		SCALE: _____	SHEET _____ OF _____ SHEETS	STA. _____ TO STA. _____	ILLINOIS FED. AID PROJECT			

# SUMMARY OF QUANTITIES

0047  
90% NHPP  
10% STATE

CODE NUMBER	ITEM	UNIT	HENRY COUNTY	TOTAL QUANTITY
67100100	MOBILIZATION	L SUM	1	1
70100207	TRAFFIC CONTROL AND PROTECTION, STANDARD 701402	EACH	2	2
70100800	TRAFFIC CONTROL AND PROTECTION, STANDARD 701401	L SUM	1	1
70107004	PAVEMENT MARKING BLACKOUT TAPE, 4"	FOOT	1320	1320
70300150	SHORT TERM PAVEMENT MARKING REMOVAL	SQ FT	440	440
70300904	PAVEMENT MARKING TAPE, TYPE IV 4"	FOOT	8675	8675
70400100	TEMPORARY CONCRETE BARRIER	FOOT	462.5	462.5
70400200	RELOCATE TEMPORARY CONCRETE BARRIER	FOOT	700	700
70600250	IMPACT ATTENUATORS, TEMPORARY (NON-REDIRECTIVE), TEST LEVEL 3	EACH	1	1
70600350	IMPACT ATTENUATORS, RELOCATE ( NON-REDIRECTIVE), TEST LEVEL 3	EACH	3	3
X5067501	BRIDGE CLEANING AND PAINTING WARRANTY NUMBER 1	L SUM	1	1
X7030005	TEMPORARY PAVEMENT MARKING REMOVAL	SQ FT	2897	2897
Z0007101	CONTAINMENT AND DISPOSAL OF LEAD PAINT CLEANING RESIDUES NO. 1	L SUM	1	1
Z0010501	CLEANING AND PAINTING STEEL BRIDGE NO. 1	L SUM	1	1

MODEL: Default  
FILE NAME: P:\11108\B&E\BID\NTEC\Illinois.gov.PWD\DOT\Documents\DOT\_Offices\District 2\Projects\Operations\Bridges\_Section\Henry037.0\06161409\CADD\02-shit-cover.dgn

USER NAME = dossdd	DESIGNED - _____	REVISED - _____
DRAWN - _____	REVISIONS - _____	
PLOT SCALE = 40.0000' / in.	CHECKED - _____	REVISED - _____
PLOT DATE = Oct-01-2018 01:54:21 PM	DATE - _____	REVISED - _____

**STATE OF ILLINOIS  
DEPARTMENT OF TRANSPORTATION**

**SUMMARY OF QUANTITIES**

SCALE: \_\_\_\_\_ SHEET \_\_\_\_ OF \_\_\_\_ SHEETS STA. \_\_\_\_\_ TO STA. \_\_\_\_\_

F.A.I. RTE.	SECTION	COUNTY	TOTAL SHEETS	SHEET NO.
74	(37-3HB-1)BP	HENRY	24	3
CONTRACT NO. 64N09				
ILLINOIS FED. AID PROJECT				

# SCHEDULE OF QUANTITIES

70400100	TEMPORARY CONCRETE BARRIER <u>LOCATION</u> <u>COMMENTS</u> <u>FOOT</u> STAGE I STA 1155+15-1158+40      TANGENT                      325 STA 1158+40-1159+52.5      TAPER                      112.5 STAGE II STA 1159+52.5-1159+77.5      TAPER                      25 <div style="text-align: right;">TOTAL                      <u>462.5</u></div>	70300150	SHORT TERM PAVEMENT MARKING REMOVAL <u>LOCATION</u> <u>COMMENTS</u> <u>SQ FT</u> STAGE II 660'                      BLACKOUT TAPE, 4"                      220 STAGE III 660'                      BLACKOUT TAPE, 4"                      220 <div style="text-align: right;">TOTAL                      <u>440</u></div>
----------	---	----------	---

70400200	RELOCATE TEMPORARY CONCRETE BARRIER <u>LOCATION</u> <u>COMMENTS</u> <u>FOOT</u> STAGE II STA 1158+40-1159+77.5      TAPER                      137.5 STAGE III STA 1153+52.5-1154+90      TAPER                      137.5 STA 1154+90-1158+15      TANGENT                      325 STAGE IV STA 1153+90-1154+90      TAPER                      100 <div style="text-align: right;">TOTAL                      <u>700</u></div>	70300904	PAVEMENT MARKING TAPE, TYPE IV 4" <u>LOCATION</u> <u>COMMENTS</u> <u>FOOT</u> STAGE I STA 1155+15-1163+40      TANGENT                      825 STA 1163+40-1173+40      TAPER                      1000 STAGE II STA 1153+70-1155+10      TAPER x2                      280 STA 1155+10-1158+90      TANGENT x2                      760 STA 1158+90-1160+30      TAPER x2                      280 STA 1163+40-1165+30      TANGENT                      190 STA 1165+30-1175+30      TAPER                      1000 STAGE III STA 1138+00-1148+00      TAPER                      1000 STA 1148+00-1153+00      TANGENT                      500 STA 1153+00-1154+40      TAPER x2                      280 STA 1154+40-1158+20      TANGENT x2                      760 STA 1158+20-1159+60      TAPER x2                      280 STAGE IV STA 1139+40-1149+40      TAPER                      1000 STA 1153+00-1158+20      TANGENT                      520 <div style="text-align: right;">TOTAL                      <u>8675</u></div>
----------	--	----------	--

70107004	PAVEMENT MARKING BLACKOUT TAPE, 4" <u>LOCATION</u> <u>COMMENTS</u> <u>FOOT</u> STAGE I NONE REQUIRED STAGE II STA 1153+70-1155+10      TAPER (LEFT SHOULDER)      140 STA 1155+10-1158+90      TANGENT (LEFT SHOULDER)      380 STA 1158+90-1160+30      TAPER (LEFT SHOULDER)      140 STAGE III STA 1153+00-1154+40      TAPER (RIGHT SHOULDER)      140 STA 1154+40-1158+20      TANGENT (RIGHT SHOULDER)      380 STA 1158+20-1159+60      TAPER (RIGHT SHOULDER)      140 STAGE IV NONE REQUIRED <div style="text-align: right;">TOTAL                      <u>1320</u></div>	X7030005	TEMPORARY PAVEMENT MARKING REMOVAL <u>LOCATION</u> <u>COMMENTS</u> <u>SQ FT</u> STAGE I 1825'                      MARKING TAPE, TYPE IV, 4"                      609 STAGE II 2510'                      MARKING TAPE, TYPE IV, 4"                      837 STAGE III 2830'                      MARKING TAPE, TYPE IV, 4"                      944 STAGE IV 1520'                      MARKING TAPE, TYPE IV, 4"                      507 <div style="text-align: right;">TOTAL                      <u>2897</u></div>
----------	--	----------	--

MODEL: Default  
 FILE: \\mhc-pw\ulb\B&E\ID\NTEC\Illinois.gov\FW\DOT\Documents\1\DOT\_Offices\Illinet\2\Projects\Operations\Bldg\_Section\Henry\037-0106\64N09\CADD\02-sh-cover.dgn

# STAGING TYPICAL

STAGES I & IV SN 037-0104 N 1200th AVE OVER I-74

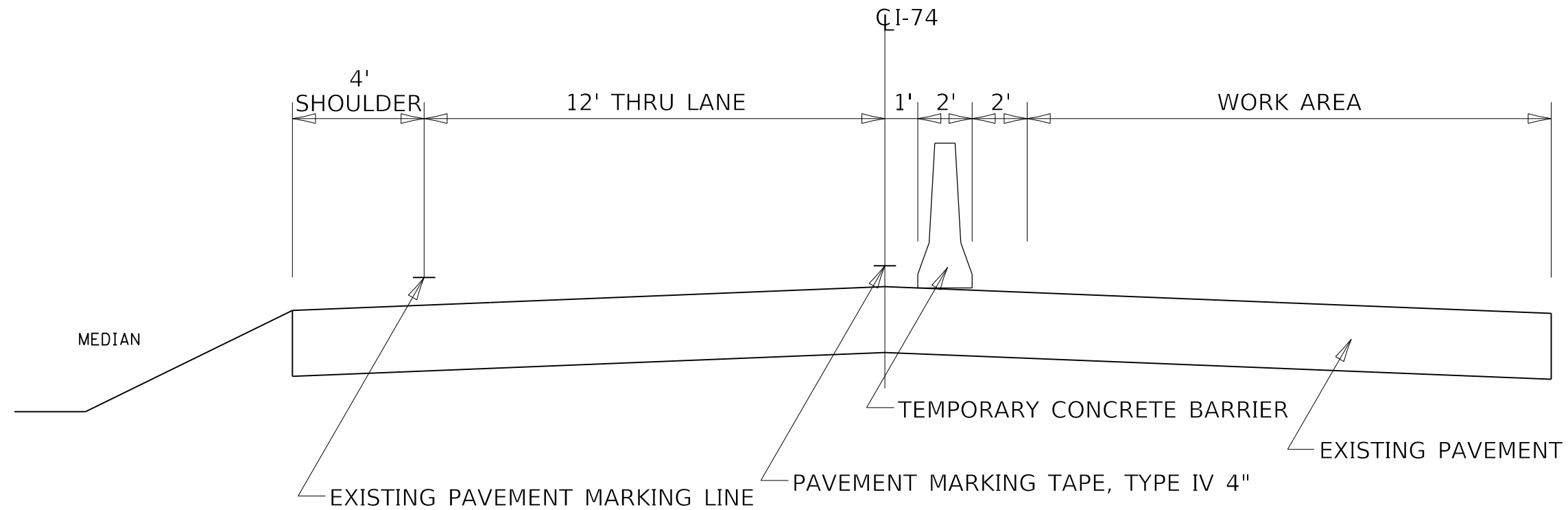

STAGES II & III SN 037-0104 N 1200th AVE OVER I-74

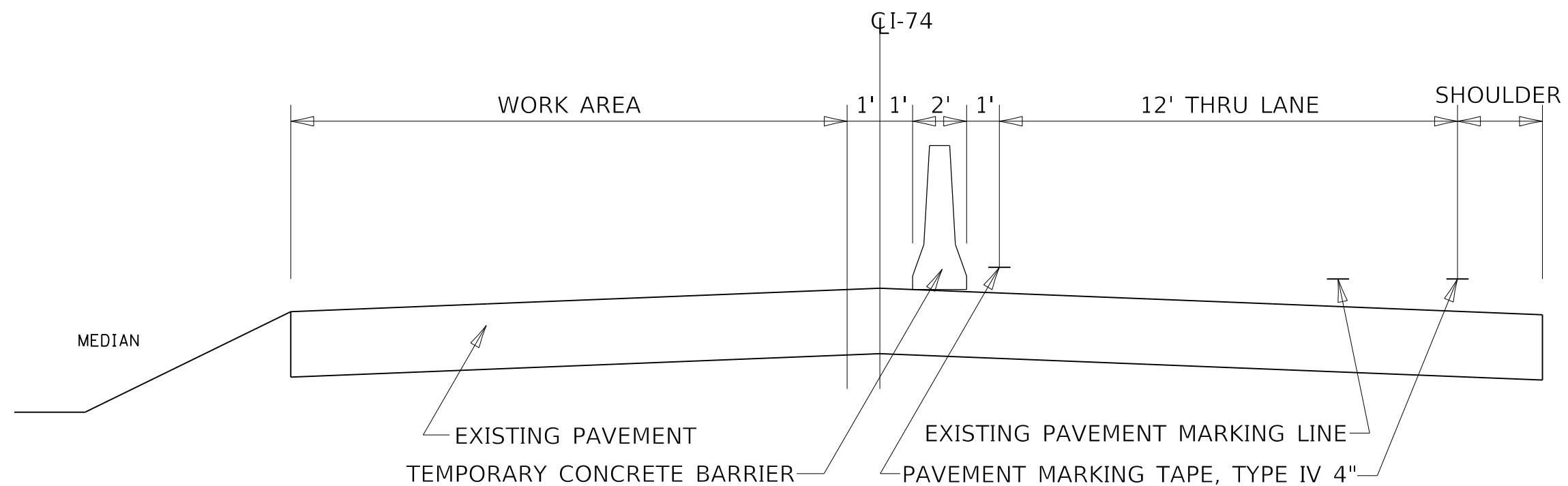

MODEL: Default  
 FILE: \\nas0101\B&E\BID\NTEC\Illinois\gov\PIV\DOT\Documents\1\DOT\_Offices\Director\2\Projects\Operations\B&E\Stage\_Section\Henry\037-0104\64109\CADD\02-shc-cover.dgn

USER NAME = drossdd	DESIGNED - _____	REVISED - _____
	DRAWN - _____	REVISED - _____
PLOT SCALE = 40,0000 ' / in.	CHECKED - _____	REVISED - _____
PLOT DATE = Oct-01-2018 01:55:17 PM	DATE - _____	REVISED - _____

**STATE OF ILLINOIS  
DEPARTMENT OF TRANSPORTATION**

**STAGING TYPICAL**

SCALE: \_\_\_\_\_ SHEET \_\_\_\_ OF \_\_\_\_ SHEETS STA. \_\_\_\_\_ TO STA. \_\_\_\_\_

F.A.I. RTE.	SECTION	COUNTY	TOTAL SHEETS	SHEET NO.
74	(37-3HB-1)BP	HENRY	24	5
CONTRACT NO. 64N09				
ILLINOIS FED. AID PROJECT				





# TRAFFIC CONTROL PLAN – STAGE I FOR SN 037-0104

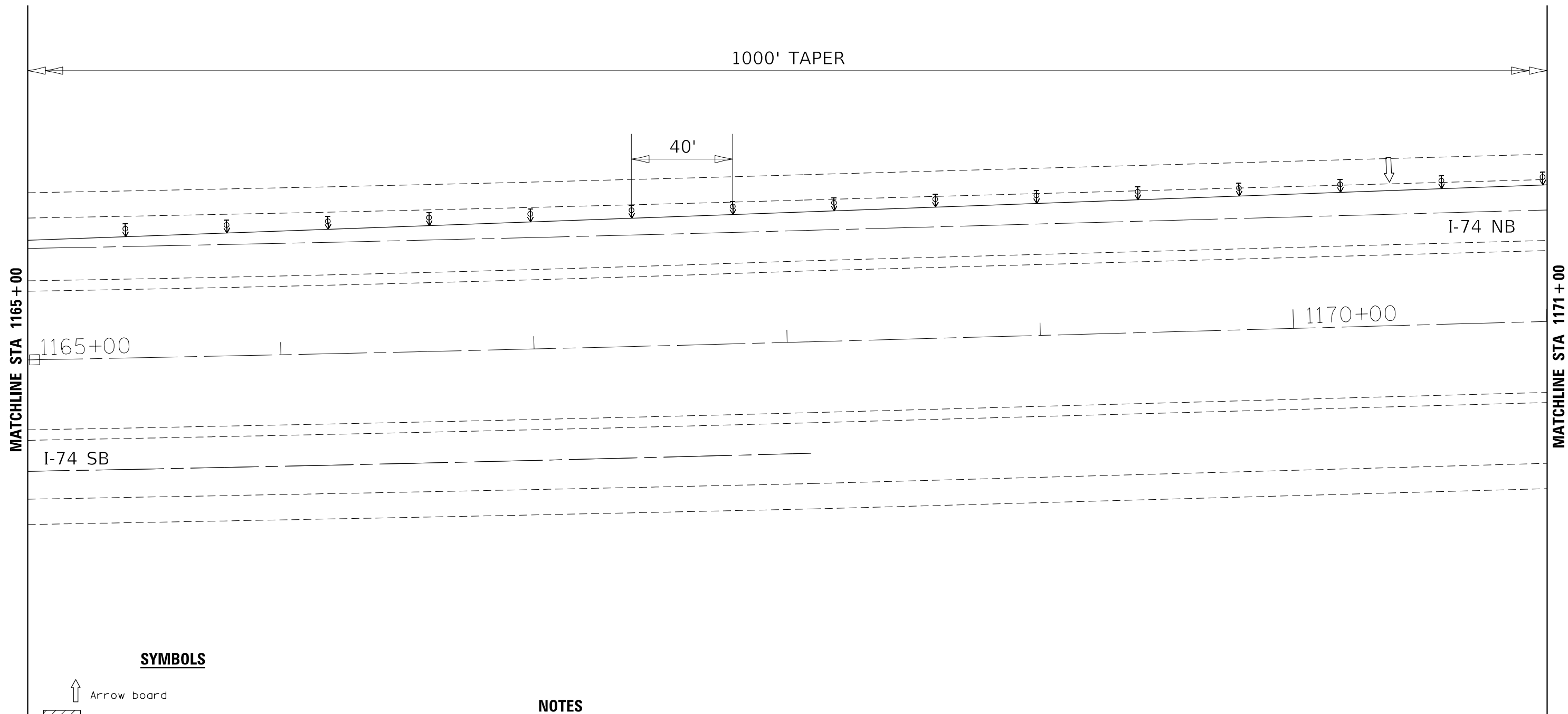
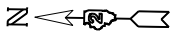

### SYMBOLS

- Arrow board
- Work area
- Sign
- Direction indicator barricade with steady burn monodirectional light
- Type II barricade or drum with steady burn monodirectional light
- Temporary concrete barrier
- Monodirectional barrier wall/guardrail marker
- Impact attenuator
- Drums with steady burning monodirectional light

### NOTES

- ① Reflectorized temporary pavement marking shall be placed throughout the taper and along-side the work area. The edge line shall be white for right lane closure and yellow for left lane closures.
- ② Vertical panels at 7.6 m (25') centers with steady burning monodirectional lights.

MODEL: Default  
 FILE: \\nas01.cba.illinois.gov\pww\DOT\Documents\11001\Projects\Operations\Bldg\_Section\Henry\037-0104\1109\CADD\02-plt-cover.dgn

USER NAME = drossdd	DESIGNED - _____	REVISED - _____
	DRAWN - _____	REVISED - _____
PLOT SCALE = 40,0000 ' / in.	CHECKED - _____	REVISED - _____
PLOT DATE = Oct-01-2018 01:55:42 PM	DATE - _____	REVISED - _____

**STATE OF ILLINOIS  
DEPARTMENT OF TRANSPORTATION**

**TTRAFFIC CONTROL PLAN – STAGE I  
FOR SN 037-0104**

SCALE: \_\_\_\_\_ SHEET \_\_\_\_ OF \_\_\_\_ SHEETS STA. \_\_\_\_\_ TO STA. \_\_\_\_\_

F.A.I. RTE.	SECTION	COUNTY	TOTAL SHEETS	SHEET NO.
74	(37-3HB-1)BP	HENRY	24	8
CONTRACT NO. 64N09				
ILLINOIS FED. AID PROJECT				









# TRAFFIC CONTROL PLAN – STAGE II FOR SN 037-0104

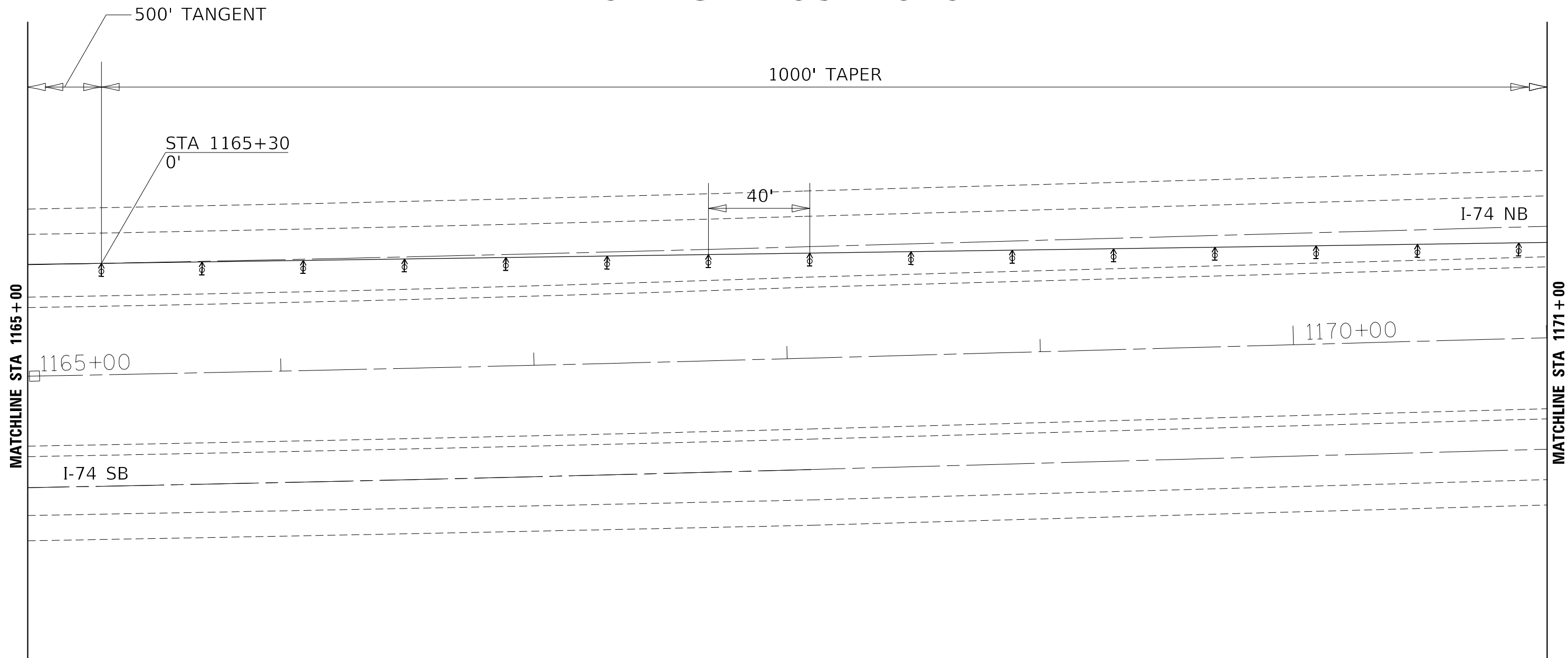

### SYMBOLS

- Arrow board
- Work area
- Sign
- Direction indicator barricade with steady burn monodirectional light
- Type II barricade or drum with steady burn monodirectional light
- Temporary concrete barrier
- Monodirectional barrier wall/guardrail marker
- Impact attenuator
- Drums with steady burning monodirectional light

### NOTES

- ① Reflectorized temporary pavement marking shall be placed throughout the taper and along-side the work area. The edge line shall be white for right lane closure and yellow for left lane closures.
- ② Vertical panels at 7.6 m (25') centers with steady burning monodirectional lights.

MODEL: Default  
 FILE: \\nas0101\BIBID\BIBID\TEC\Illinois\pwr\pwr\DOT\Documents\1101\DOT\_Offices\Director\Projects\Operations\Bldg - Section\Henry\037-0104\1109\CADD\02-plt-cover.dgn

USER NAME = drossdd	DESIGNED - _____	REVISED - _____
	DRAWN - _____	REVISED - _____
PLOT SCALE = 40,0000' / in.	CHECKED - _____	REVISED - _____
PLOT DATE = Oct-01-2018 01:56:12 PM	DATE - _____	REVISED - _____

**STATE OF ILLINOIS  
DEPARTMENT OF TRANSPORTATION**

**TTRAFFIC CONTROL PLAN – STAGE II  
FOR SN 037-0104**

SCALE: \_\_\_\_\_ SHEET \_\_\_\_ OF \_\_\_\_ SHEETS STA. \_\_\_\_\_ TO STA. \_\_\_\_\_

F.A.I. RTE.	SECTION	COUNTY	TOTAL SHEETS	SHEET NO.
74	(37-3HB-1)BP	HENRY	24	12
CONTRACT NO. 64N09				
ILLINOIS FED. AID PROJECT				

# TRAFFIC CONTROL PLAN – STAGE II FOR SN 037-0104

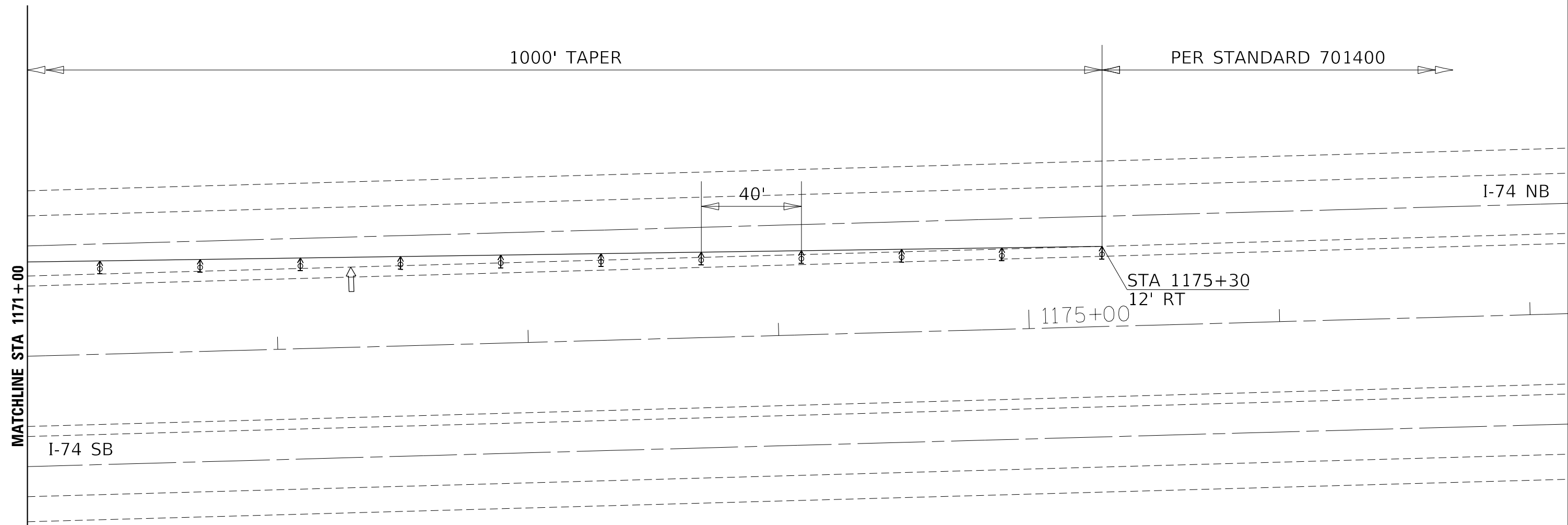
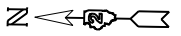

MATCHLINE STA 1171 + 00

### SYMBOLS

- Arrow board
- Work area
- Sign
- Direction indicator barricade with steady burn monodirectional light
- Type II barricade or drum with steady burn monodirectional light
- Temporary concrete barrier
- Monodirectional barrier wall/guardrail marker
- Impact attenuator
- Drums with steady burning monodirectional light

### NOTES

- ① Reflectorized temporary pavement marking shall be placed throughout the taper and along-side the work area. The edge line shall be white for right lane closure and yellow for left lane closures.
- ② Vertical panels at 7.6 m (25') centers with steady burning monodirectional lights.

MODEL: Default  
FILE: \\nas0101\BIBID\BIBID\TEC\Illinois\pov\pov\DOT\Documents\1101\DOT\_Offices\Director\2\Projects\Operations\Bibid\Stage\_Section\Henry\037-0104\64N09\CADD\02-shc-cover.dgn

USER NAME = drossdd	DESIGNED - _____	REVISED - _____
	DRAWN - _____	REVISED - _____
PLOT SCALE = 40,0000 ' / in.	CHECKED - _____	REVISED - _____
PLOT DATE = Oct-01-2018 01:56:22 PM	DATE - _____	REVISED - _____

**STATE OF ILLINOIS  
DEPARTMENT OF TRANSPORTATION**

**TTRAFFIC CONTROL PLAN – STAGE II  
FOR SN 037-0104**

SCALE: \_\_\_\_\_ SHEET \_\_\_\_ OF \_\_\_\_ SHEETS STA. \_\_\_\_\_ TO STA. \_\_\_\_\_

F.A.I. RTE.	SECTION	COUNTY	TOTAL SHEETS	SHEET NO.
74	(37-3HB-1)BP	HENRY	24	13
CONTRACT NO. 64N09				
ILLINOIS FED. AID PROJECT				



# TRAFFIC CONTROL PLAN – STAGE III FOR SN 037-0104

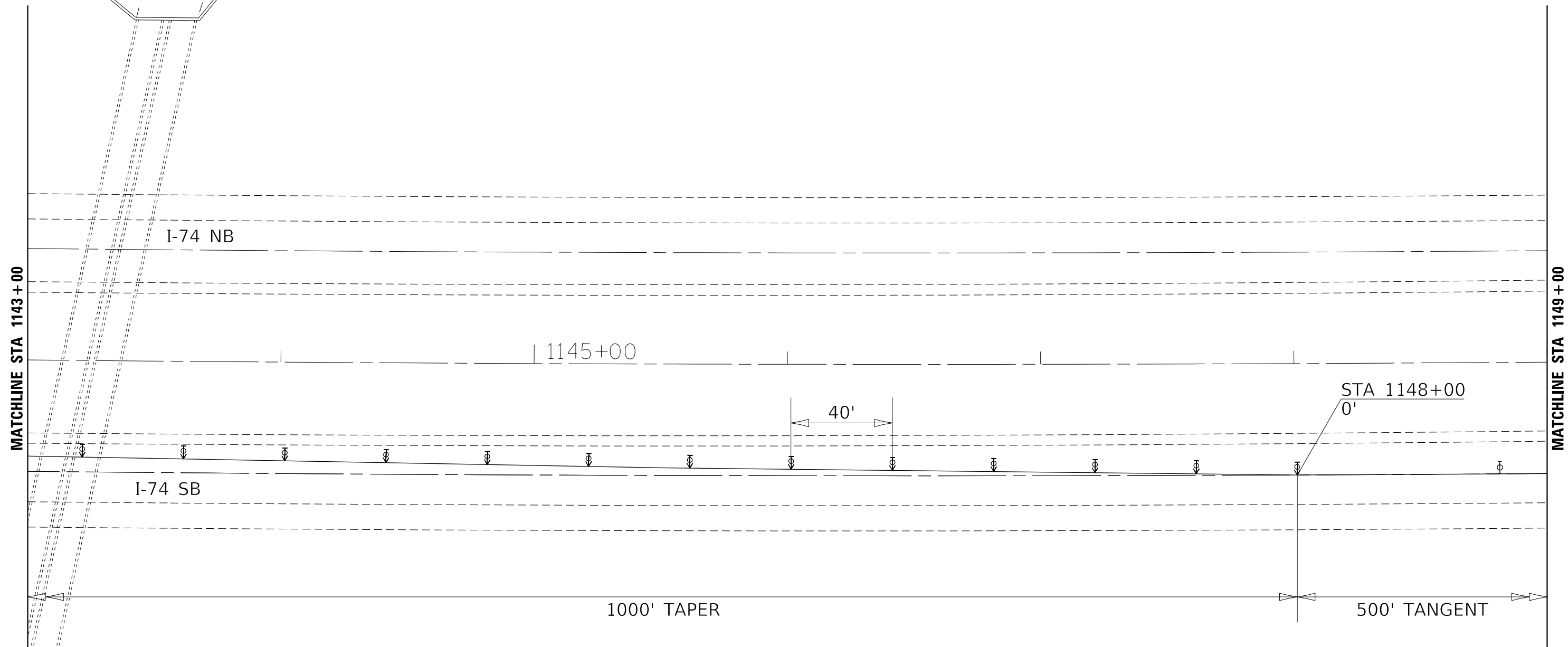

### SYMBOLS

- Arrow board
- Work area
- Sign
- Direction indicator barricade with steady burn monidirectional light
- Type II barricade or drum with steady burn monidirectional light
- Temporary concrete barrier
- Monidirectional barrier wall/guardrail marker
- Impact attenuator
- Drums with steady burning monidirectional light

### NOTES

- ① Reflectorized temporary pavement marking shall be placed throughout the taper and along-side the work area. The edge line shall be white for right lane closure and yellow for left lane closures.
- ② Vertical panels at 7.6 m (25') centers with steady burning monidirectional lights.

MODEL: Default  
 FILE: \\nas0101\B&E\BID\NTEC\Illinois\poc\p\WID\DOT\Documents\1\DOT - Offices\District 2\Projects\Operations\Bldg - Section\Henry\037-0104\64N09\CADD\02-traffic-control.dgn

USER NAME = drossdd	DESIGNED - _____	REVISED - _____
PLOT SCALE = 40.0000 ' / in.	DRAWN - _____	REVISED - _____
PLOT DATE = Oct-01-2018 01:56:36 PM	CHECKED - _____	REVISED - _____
	DATE - _____	REVISED - _____

**STATE OF ILLINOIS**  
**DEPARTMENT OF TRANSPORTATION**

<b>TTRAFFIC CONTROL PLAN – STAGE III FOR SN 037-0104</b>			
SCALE: _____	SHEET _____	OF _____ SHEETS	STA. _____ TO STA. _____

F.A.I. RTE.	SECTION	COUNTY	TOTAL SHEETS	SHEET NO.
74	(37-3HB-1)BP	HENRY	24	15
CONTRACT NO. 64N09				
ILLINOIS FED. AID PROJECT				

# TRAFFIC CONTROL PLAN – STAGE III FOR SN 037-0104

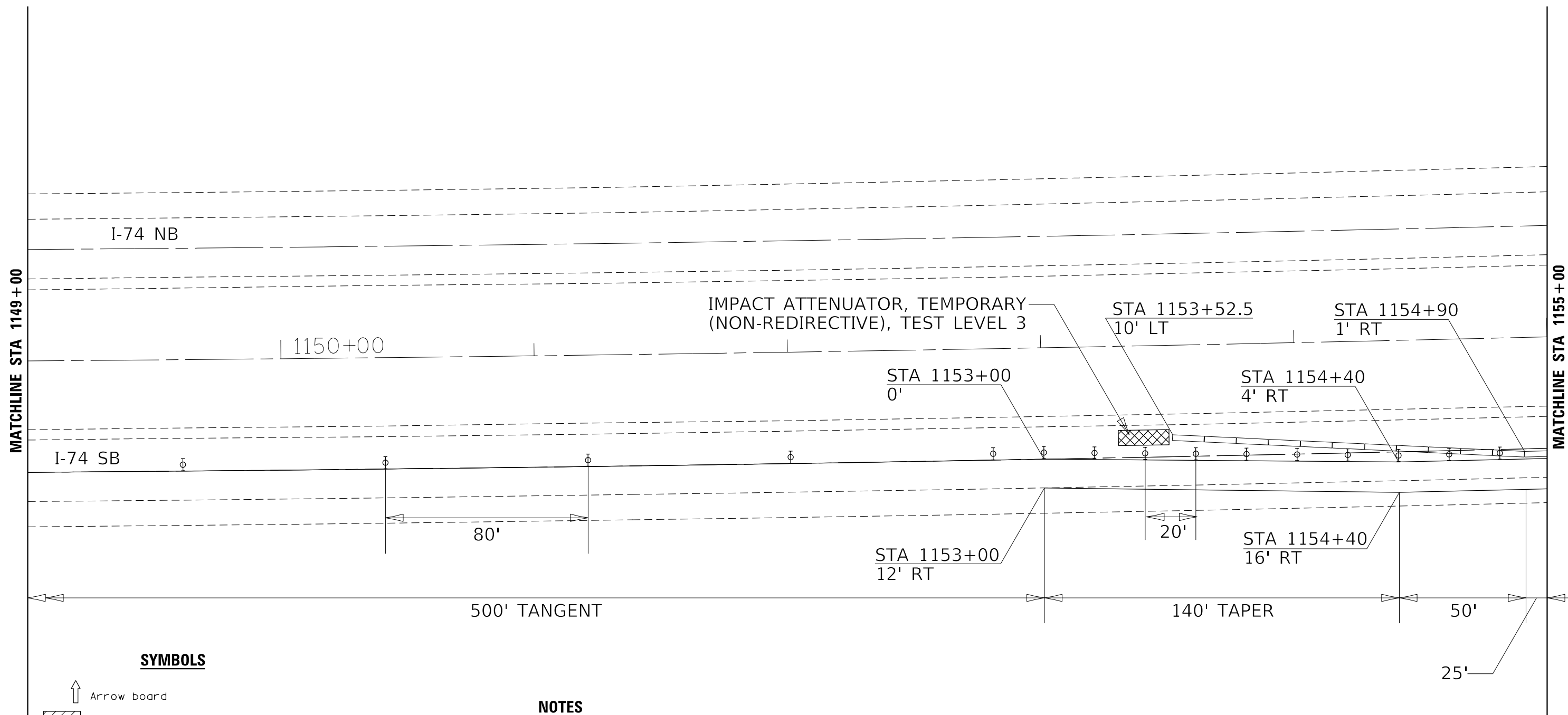
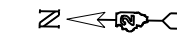

### SYMBOLS

- Arrow board
- Work area
- Sign
- Direction indicator barricade with steady burn monodirectional light
- Type II barricade or drum with steady burn monodirectional light
- Temporary concrete barrier
- Monodirectional barrier wall/guardrail marker
- Impact attenuator
- Drums with steady burning monodirectional light

### NOTES

- ① Reflectorized temporary pavement marking shall be placed throughout the taper and along-side the work area. The edge line shall be white for right lane closure and yellow for left lane closures.
- ② Vertical panels at 7.6 m (25') centers with steady burning monodirectional lights.

MODEL: Default  
FILE: \\nas101\BIBED\BIBED\ITC\Illinois\p037-0104\64N09\CADD\02-shc-cover.dgn  
PROJECTS\Operations\Bldg - Section\Henry\037-0104\64N09\CADD\02-shc-cover.dgn

USER NAME = drossdd	DESIGNED - _____	REVISED - _____
	DRAWN - _____	REVISED - _____
PLOT SCALE = 40,0000 ' / in.	CHECKED - _____	REVISED - _____
PLOT DATE = Oct-01-2018 01:56:43 PM	DATE - _____	REVISED - _____

**STATE OF ILLINOIS  
DEPARTMENT OF TRANSPORTATION**

**TTRAFFIC CONTROL PLAN – STAGE III  
FOR SN 037-0104**

SCALE: \_\_\_\_\_ SHEET \_\_\_\_\_ OF \_\_\_\_\_ SHEETS STA. \_\_\_\_\_ TO STA. \_\_\_\_\_

F.A.I. RTE.	SECTION	COUNTY	TOTAL SHEETS	SHEET NO.
74	(37-3HB-1)BP	HENRY	24	16
CONTRACT NO. 64N09				
ILLINOIS FED. AID PROJECT				



# TRAFFIC CONTROL PLAN – STAGE III FOR SN 037-0104

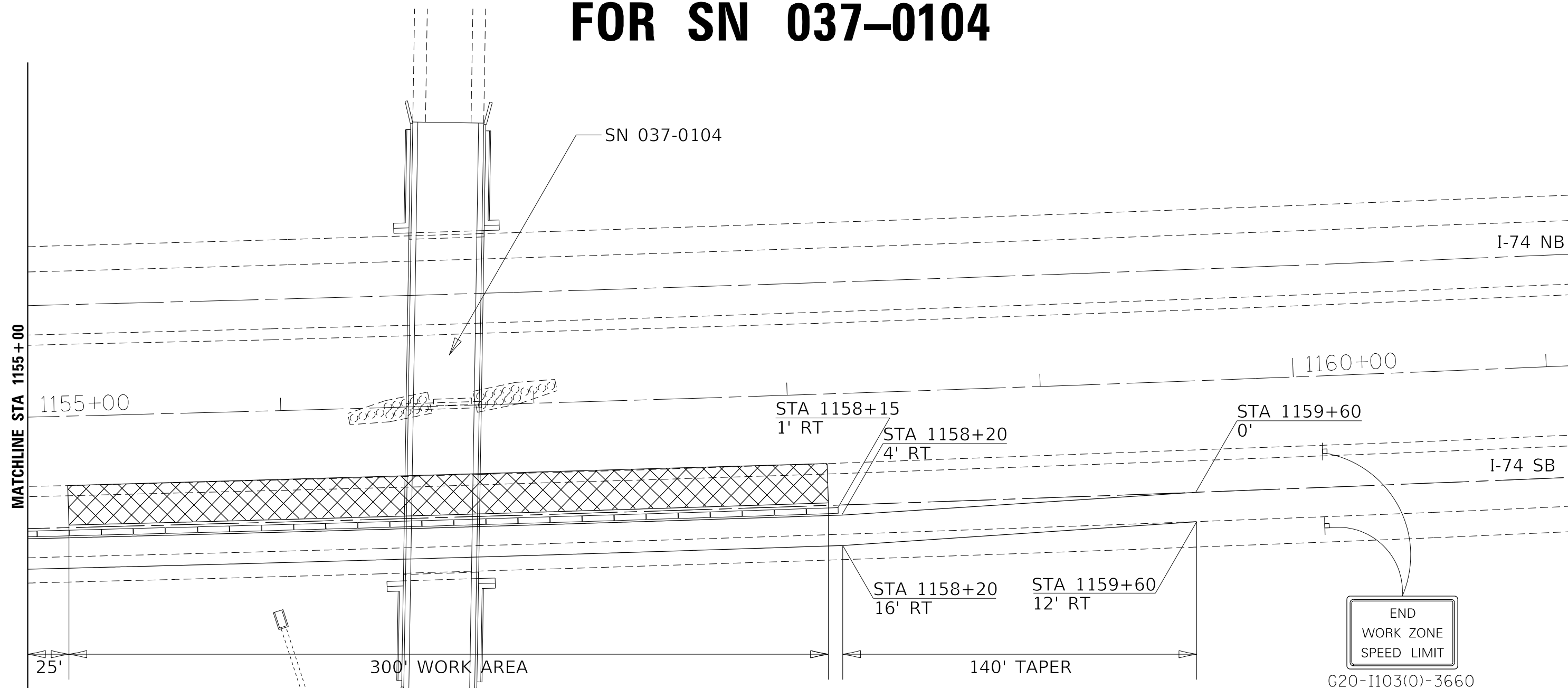
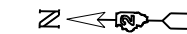

### SYMBOLS

- Arrow board
- Work area
- Sign
- Direction indicator barricade with steady burn monodirectional light
- Type II barricade or drum with steady burn monodirectional light
- Temporary concrete barrier
- Monodirectional barrier wall/guardrail marker
- Impact attenuator
- Drums with steady burning monodirectional light

### NOTES

- ① Reflectorized temporary pavement marking shall be placed throughout the taper and along-side the work area. The edge line shall be white for right lane closure and yellow for left lane closures.
- ② Vertical panels at 7.6 m (25') centers with steady burning monodirectional lights.

MODEL: Default  
 FILE: \\nas0101\BIBED\BIBED\ITC\Illinois\p037-0104\64N09\CADD\02-traffic-control.dgn  
 PROJECTS\Operations\Bldg - Section\Henry\037-0104\64N09\CADD\02-traffic-control.dgn

USER NAME = drossdd	DESIGNED - _____	REVISED - _____
PLOT SCALE = 40,0000' / in.	DRAWN - _____	REVISED - _____
PLOT DATE = Oct-01-2018 01:56:51 PM	CHECKED - _____	REVISED - _____
	DATE - _____	REVISED - _____

**STATE OF ILLINOIS  
DEPARTMENT OF TRANSPORTATION**

**TTRAFFIC CONTROL PLAN – STAGE III  
FOR SN 037-0104**

SCALE: \_\_\_\_\_ SHEET \_\_\_\_\_ OF \_\_\_\_\_ SHEETS STA. \_\_\_\_\_ TO STA. \_\_\_\_\_

F.A.I. RTE.	SECTION	COUNTY	TOTAL SHEETS	SHEET NO.
74	(37-3HB-1)BP	HENRY	24	17
CONTRACT NO. 64N09				
ILLINOIS FED. AID PROJECT				









BM #28 Railroad Spike in Power Pole  
150' Right Station 993+20 Elev 77292

STATE OF ILLINOIS  
DEPARTMENT OF PUBLIC WORKS & BUILDINGS  
DIVISION OF HIGHWAYS

ROUTE NO.	SECTION	COUNTY	TOTAL SHEETS	SHEET NO.
FAI RT 74	37-3HB-1	HENRY	27	5
FED. ROAD DIST. NO. 1		ILLINOIS	FED. AID PROJ. 1-74-2(4)21	

SHEET NO. 1  
12 SHEETS

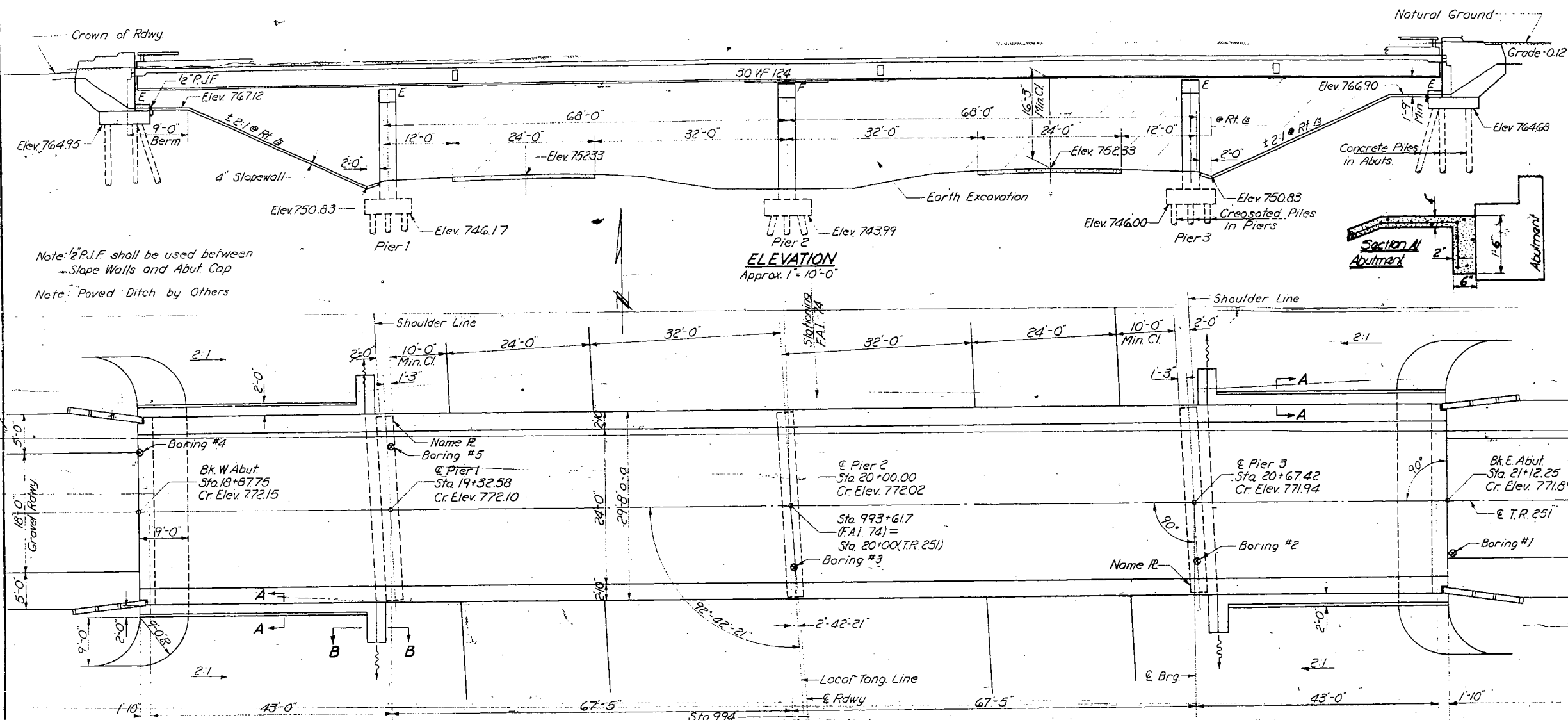

**GENERAL NOTES**  
Rivets 3/4", Open holes 1/16", unless noted.

All bolsters, rockers, bearing plates, lead plates, pintles and anchor bolts shall be fabricated and set in accordance with Article 51.15 of the Standard Specifications and are included in quantity of Structural Steel.

Anchor bolts shall be set before riveting diaphragms over supports.

Expansion guards shall be fabricated and erected in accordance with Article 51.13(d) of the Standard Specifications.

Expansion guards are included in quantity of Structural Steel.

Except as otherwise provided, all structural steel shall receive one shop coat of red lead paint and two field coats of aluminum paint. See Articles 56.1 to 56.5 inclusive of the Standard Specifications.

All paint shall be furnished and applied by the Contractor.

Permanent forms will not be permitted in forming the concrete deck.

The outside faces of the vertical legs of angles in the expansion guard shall be given two shop coats of red lead paint.

Class X concrete shall be used throughout. The concrete floor-slab shall be finished in accordance with Article 51.19 of the Standard Specifications.

Slope walls shall be reinforced with welded wire fabric 6x6 mesh, #4 wires weighing 58# per 100 Sq. Ft. The Contractor shall drive one concrete test pile of East abutment in a permanent location, and one timber test pile in the vicinity of Pier 1, before ordering the remainder of the piles.

Note: 1/2" P.J.F. shall be used between Slope Walls and Abut. Cap  
Note: Paved Ditch by Others

**TOTAL BILL OF MATERIAL**

Item	Unit	Sub	Super	Total
Class A Excavation for Structures	Cu. Yd.	230		230
Class X Concrete	Cu. Yd.	1729	189.7	362.6
Structural Steel	Lb.		165,790	165,790
Aluminum Handrail	Lin. Ft.		445	445
Reinforcement Bars	Lb.	13,990	38,980	52,970
Grouted Piles	Lin. Ft.	960		960
Test Piles-Timber	Ea.	1		1
Concrete Piles	Lin. Ft.	585		585
Test Piles Concrete	Ea.	1		1
Name Plates	Ea.	2		2
Slope Wall	Sq. Yd.	410		410
Protective Coat	Sq. Yd.		870	870

\*Includes 20 Cu. Yds. of Excavation for Toewall

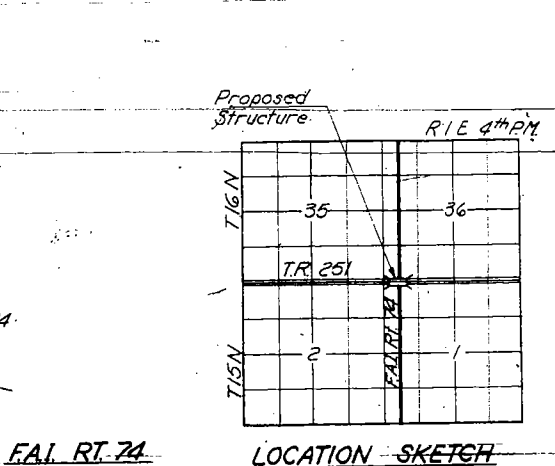
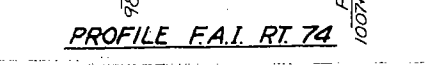
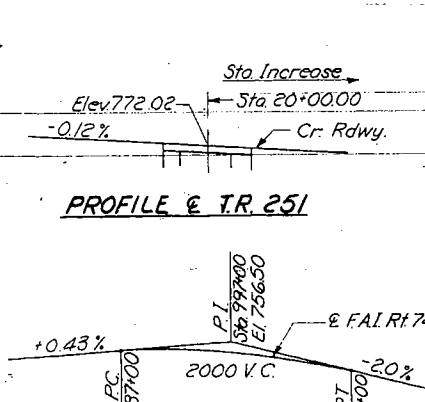
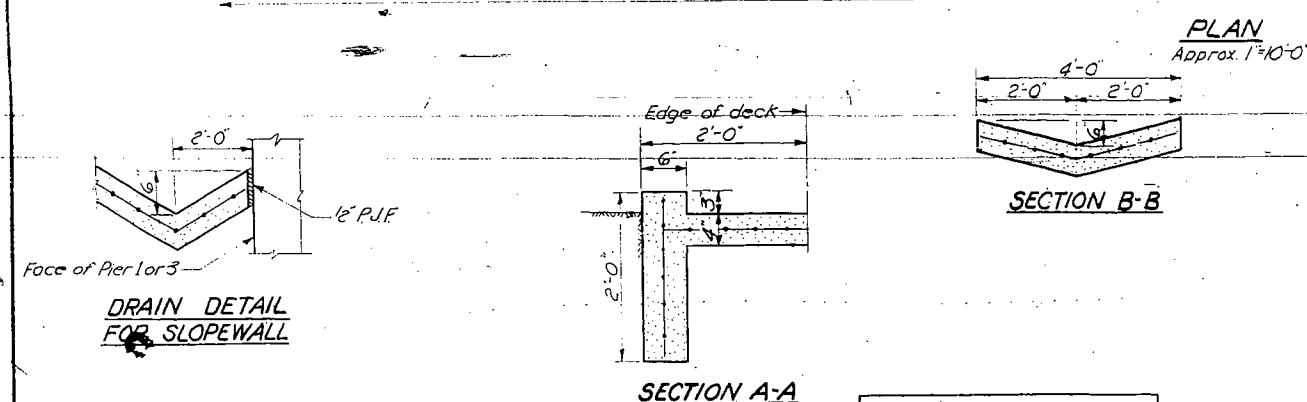

DESIGNED: E. J. Sheehan  
CHECKED: J. M. J. Wood  
DRAWN: E. S. J. L. Armstrong  
CHECKED: J. M. J.

EXAMINED: W. B. Bauman  
PASSED: E. J. Sheehan  
APPROVED: W. B. Bauman

JULY 11 1961

STATION 993+61.7  
BUILT 196 BY  
STATE OF ILLINOIS  
FAI RT. 74 SEC. 37-3HB-1  
F.A. PROJ. 1-74-2(4)21  
LOADING H15-S12

NAME PLATE LETTERING  
Locate on Pier 1 & 3  
See Standard 2113-1

**DESIGN STRESSES**  
fc = 1400 psi. Super & Sub  
vc = 75 psi. Figs.  
fs = 20,000 psi. Reinf.  
fs = 18,000 psi. Struct. A-36  
n = 10

**FAI RT. 74 CURVE DATA**  
Δ = 8°-31'-45"  
D = 0°-10'-00"  
T = 2563.81'  
L = 5117.50'  
R = 34,377.48'  
E = 95.40'  
No Super. elevation

LOADING H15-S12-44

**GENERAL PLAN & ELEVATION**  
**T.R. 251 OVER FAI RT. 74**  
PROJ. 1-74-2(4)21  
FAI RT. 74 SEC. 37-3HB-1  
HENRY COUNTY  
STA. 993+61.70

**FOR INFORMATION ONLY**

Rev. 4-2-55-A.D. Added Protective Coat, 870 Sq. Yds., changed Class X Conc. From 349.8 to 362.6 Cu. Yds.  
Changed Reinforcement Bars from #4's to #5's, and changed Metal Handrail, #4's to #5's.

STATE OF ILLINOIS  
DEPARTMENT OF PUBLIC WORKS & BUILDINGS  
DIVISION OF HIGHWAYS

PROJECT NO.	SHEET NO.	COUNTY	TOTAL SHEETS	SHEET NO.
F.A.I. 74	37-	HENRY	27	5
SHEET NO 2				
12 SHEETS				

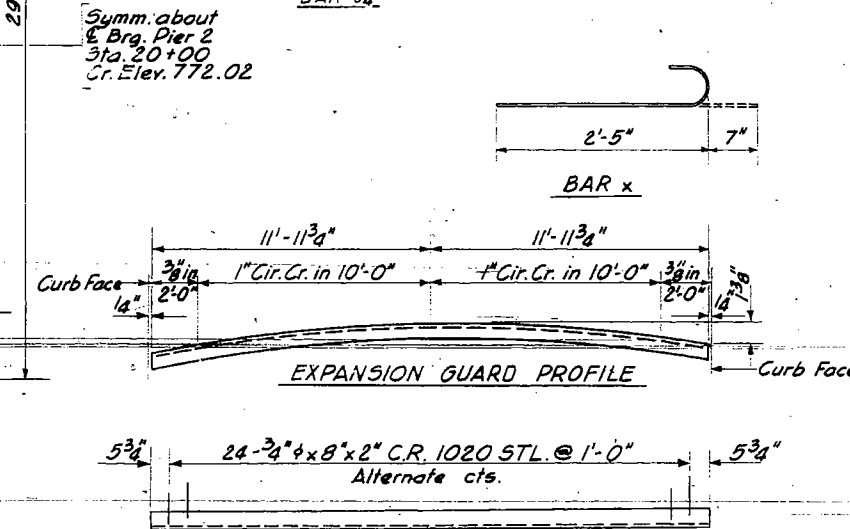
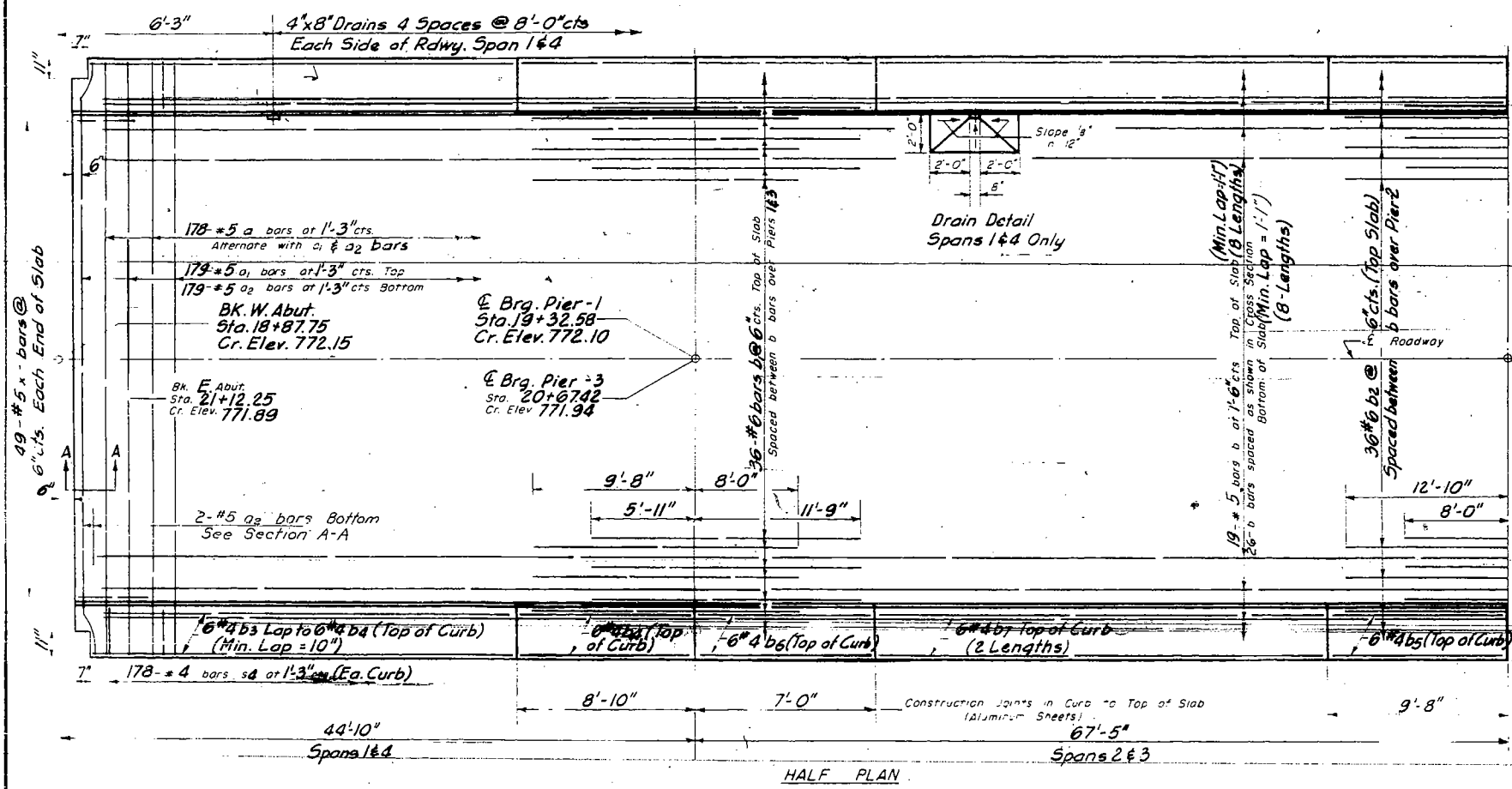
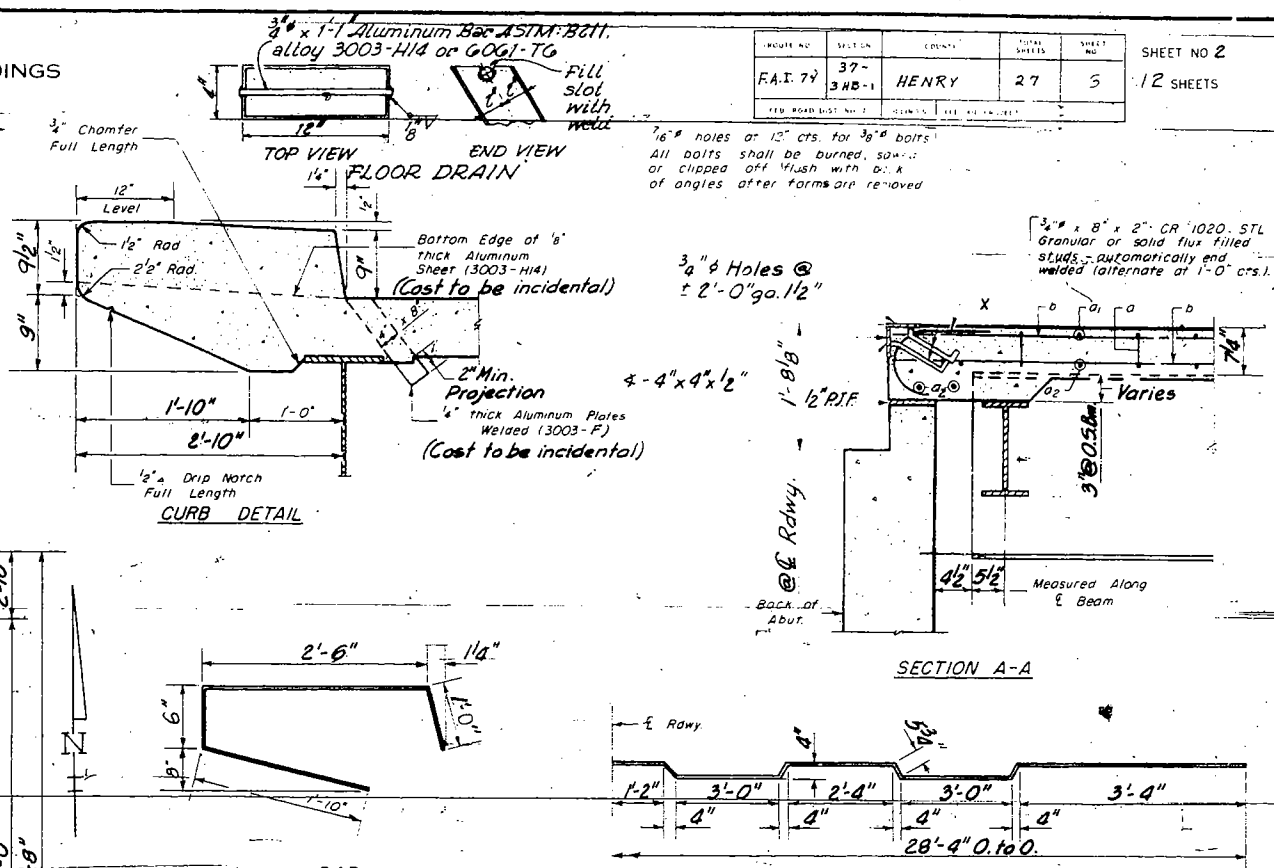
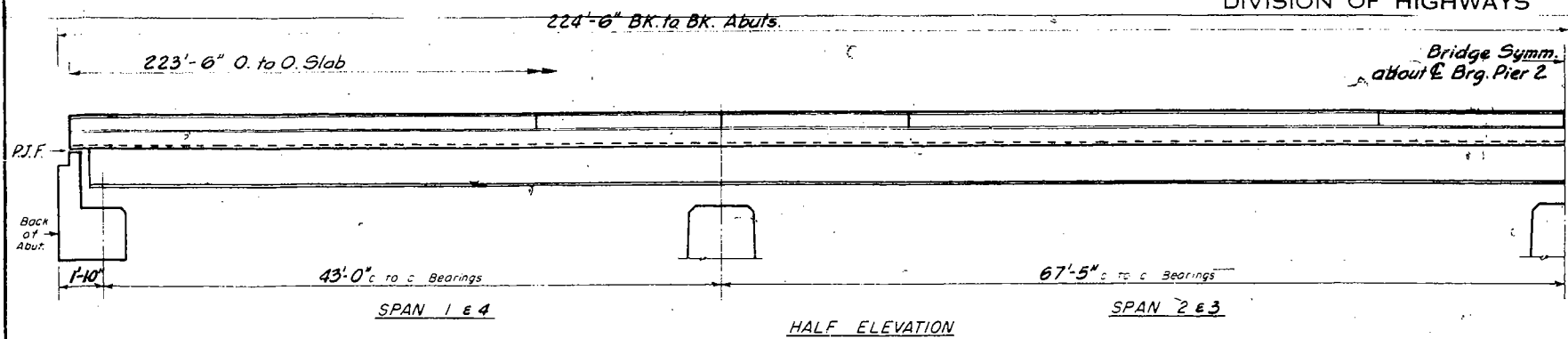

BILL OF MATERIAL

Bar	No.	Size	Length	Shape
a	178	#5	29'-6"	~
a1	179	#5	28'-6"	—
a2	183	#5	26'-0"	—
b	360	#5	29'-0"	—
b1	72	#6	17'-8"	—
b2	36	#6	20'-4"	—
b3	24	#4	28'-9"	—
b4	48	#4	8'-6"	—
b5	24	#4	9'-4"	—
b6	24	#4	6'-8"	—
b7	48	#4	25'-9"	—
s4	356	#4	5'-10"	—
x	98	#5	3'-0"	—
Class X Concrete		Cu. Yd.	169.1	
Reinforcement Bars		Lb.	33,190	
Structural Steel		Lb.	162,780	

Weight of Bolsters, Rockers, Bearing Plates, Lead Plates and Anchor Bolts included as Structural Steel. Est. Weight: 6,390 Lbs.

**METHOD OF DETERMINING FILLET HEIGHT "f"**  
After all Structural Steel has been erected, elevations of the top flanges of the beams shall be taken at the stations shown on sheet #4. These elevations subtracted from the Theoretical Rise Elevations Adjusted for Dead Load Deflection shown on sheet #4, minus floor thickness equals the fillet height above top of beams.

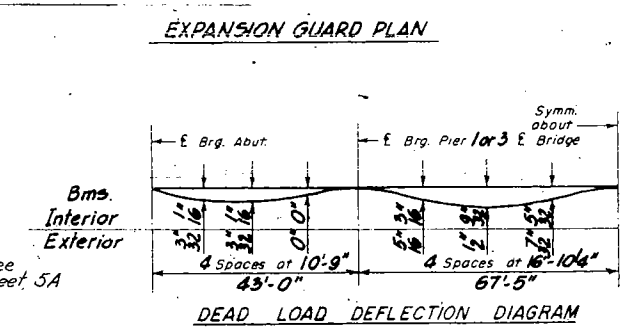
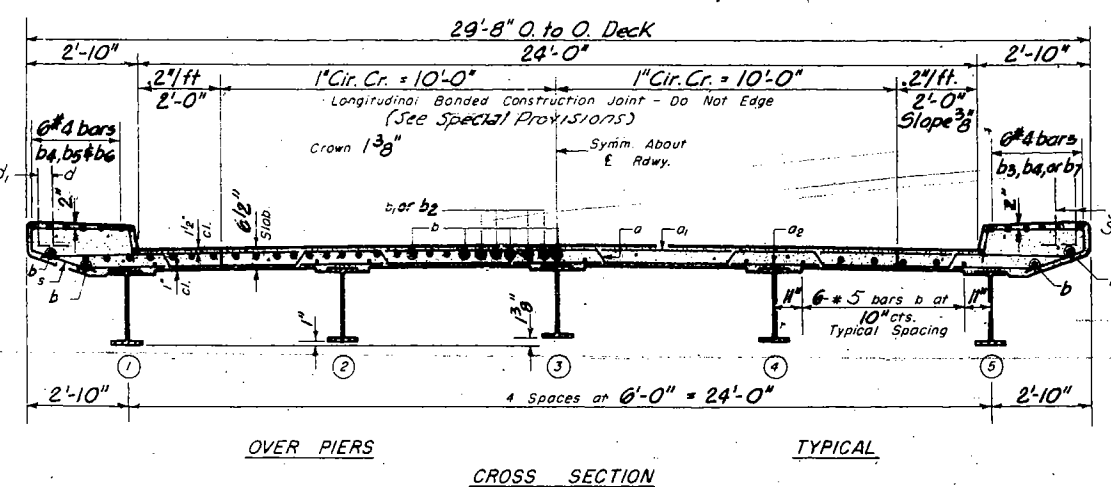

DESIGNED: *Ernie J. Szymanski*  
CHECKED: *J. M. Szymanski*  
DRAWN: *Gabor Papp*  
APPROVED: *W. A. Sausaman*

JULY 11 1961  
EXAMINED: *W. B. Baumann*  
PASSED: *E. J. Smith*  
APPROVED: *V. W. Barthelme*

64N09-0

DESIGN STRESSES  
fs = 18,000 Structural Steel  
fs = 20,000 Reinforcement  
fc = 14.00 Superstructure  
fc = 14.00 Substructure  
n = 10

**SUPERSTRUCTURE**  
**T.R. 251 OVER F.A.I. RT. 74**  
**F.A.I. RT. 74 SEC. 37-3HB-1**  
**HENRY COUNTY**  
**STA. 993+61.7**

**FOR INFORMATION ONLY**

