

SN 041-0087/0088

MİKROSİLİKA OVELAY

7/2" ORIGINAL DECK,

THRU 20 MM SCARIFY,

W/ 60 MM M.S. OVELAY

SO 6 3/4" DECK

2 3/8" 2 1/4" M.S. OVELAY

SECTION	COUNTY	NO.	SHEET
64	JEFFERSON	58	1
D-7 BRIDGE DECK REPAIR 1999-1			
AS-D-64-3(78)61			

MMO 12/18/98
 \94678\002\98\p01.dgn
 REV.
 1 7 3 4 5 6 7 8 9
 10 11 12 13 14 15 16 17 18 19 20 21 22 23 24 25 26 27 28 29 30 31 32 33 34 35 36 37 38 39 40 41 42 43 44 45 46 47 48 49 50 51 52 53 54 55 56 57 58 59 60 61 62 63 64 65 66 67 68 69 70 71 72 73 74 75 76 77 78 79 80 81 82 83 84 85 86 87 88 89 90 91 92 93 94 95 96 97 98 99 100

FOR INDEX OF SHEETS SEE SHEET NO. 2

LOCATION OF STRUCTURES

- 1 SN 041-0085 & 041-0086
RAYSE CREEK
STATION 103+223.531
- 2 SN 041-0077 & 041-0078
TR 108A / BURLINGTON NORTHERN RR
STATION 107+568.768
- 3 SN 041-0075 & 041-0076
BIG MUDDY RIVER
STATION 112+597.976
- 4 SN 041-0060
NORTH TRI-LEVEL (2ND LEVEL)
STATION 118+335.301
- 5 SN 041-0067 & 041-0068
ILLINOIS ROUTE 37
STATION 128+554.657
- 6 SN 041-0089 & 041-0090
CASEY FORK & UNION PACIFIC RR
STATION 128+937.735
- 7 SN 041-0087 & 041-0088
CASEY FORK OVERFLOW
STATION 129+527.587
- 8 SN 041-0081 & 041-0082
COUNTY HIGHWAY 17
STATION 142+861.754

STATE OF ILLINOIS
 DEPARTMENT OF TRANSPORTATION
 DIVISION OF HIGHWAYS

PLANS FOR PROPOSED
 FEDERAL AID HIGHWAY

FAI ROUTE 64 (I-64)
 SECTION D-7 BRIDGE DECK REPAIR 1999-1
 PROJECT IM - 64 - 3 (78) 61
 JEFFERSON COUNTY
 C-97-028-98

PLAN
 PROFILE HORIZ.
 PROFILE VERT.
 CROSS SECTIONS

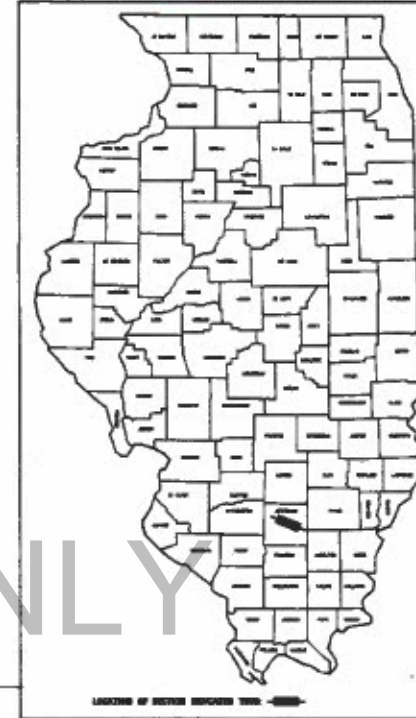

METRIC RATIOS

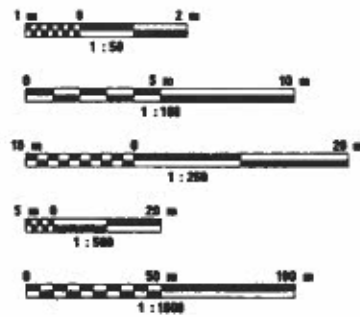

FULL SIZE PLANS HAVE BEEN PREPARED USING STANDARD ENGINEERING SCALES, REDUCED SIZED PLANS WILL NOT CONFORM TO STANDARD SCALES, IN MAKING MEASUREMENTS ON REDUCED PLANS, THE ABOVE SCALES MAY BE USED.

JULIE
 JOINT UTILITY LOCATION INFORMATION FOR EXCAVATION
 1-800-882-9123

CONTRACT NO. 94678

TOWNSHIP :



GROSS LENGTH : m km
 NET LENGTH : m km

STATE OF ILLINOIS
 DEPARTMENT OF TRANSPORTATION
 DIVISION OF HIGHWAYS

APPROVED DEC 18 19 98
James R. Seal DISTRICT ENGINEER

DATE OF PROJECT DEVELOPMENT AND IMPLEMENTATION
 January 29, 99
Bill Humber
 DISTRICT SUPERVISOR

DATE OF REVIEW
 January 29, 99
James R. Seal
 DIRECTOR, DIVISION OF HIGHWAYS

PRINTED BY THE AUTHORITY OF
 THE STATE OF ILLINOIS

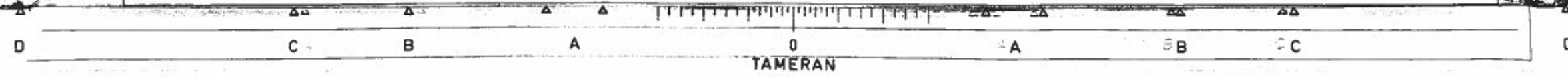

MMO 12/17/98
 \946786\00298pc.dgn
 MMO REV. 09-01-98

IND
 1 2 3 4 5 6 7 8 9
 10 11 12 13 14 15 16 17 18
 19 20 21 22 23 24 25 26 27
 28 29 30 31 32 33 34 35
 36 37 38 39 40 41 42 43 44
 45 46 47 48 49 50 51 52

MMO 12/17/98

GENERAL NOTES

THIS SECTION SHALL BE CONSTRUCTED IN ACCORDANCE WITH THE PLANS; THE "STANDARD SPECIFICATIONS FOR ROAD AND BRIDGE CONSTRUCTION" ADOPTED JANUARY 1, 1997; THE "SUPPLEMENTAL SPECIFICATIONS AND RECURRING SPECIAL PROVISIONS" ADOPTED JANUARY 1, 1999 AND THE SPECIAL PROVISIONS INCLUDED IN THE PROPOSAL.

THIS PROJECT IS LOCATED ON FIFTEEN STRUCTURES CARRYING F.A.I. ROUTE 64 OVER VARIOUS ROADWAYS AND WATERWAYS IN JEFFERSON COUNTY.

THE WORK INCLUDED IN THIS SECTION CONSISTS OF BITUMINOUS SHOULDER REMOVAL, CONSTRUCTION OF PCC BASE COURSE WIDENING, REMOVAL OF THE EXISTING BITUMINOUS WEARING SURFACE AND WATERPROOFING MEMBRANE SYSTEM, PARTIAL AND FULL DEPTH PATCHING OF THE DECKS, THE REMOVAL AND REPLACEMENT OF THE EXPANSION JOINTS ON EIGHT OF THE STRUCTURES, THE REMOVAL AND REPLACEMENT OF THE BEARING ASSEMBLIES ON SIX OF THE STRUCTURES, CONSTRUCTION OF A MICROSILICA CONCRETE OVERLAY ON ALL OF THE STRUCTURES AND ANY OTHER WORK NECESSARY TO COMPLETE THIS SECTION.

PLAN DIMENSIONS AND DETAILS RELATIVE TO THE EXISTING STRUCTURE HAVE BEEN TAKEN FROM EXISTING PLANS AND ARE SUBJECT TO NOMINAL CONSTRUCTION VARIATIONS. IT SHALL BE THE CONTRACTORS RESPONSIBILITY TO VERIFY SUCH DIMENSIONS AND DETAILS IN THE FIELD AND MAKE NECESSARY APPROVED ADJUSTMENTS PRIOR TO CONSTRUCTION OR ORDERING OF MATERIAL. SUCH VARIATIONS SHALL NOT BE CAUSE FOR ADDITIONAL COMPENSATION FOR A CHANGE IN THE SCOPE OF THE WORK; HOWEVER, THE CONTRACTOR WILL BE PAID FOR THE QUANTITY ACTUALLY FURNISHED AT THE UNIT PRICE BID FOR THE WORK.

THE QUANTITIES OF EPOXY PAVEMENT MARKING - LINE 100 MM WERE COMPUTED TO THE FOLLOWING LIMITS. WHITE EDGELINE COMPUTED FROM THE BEGINNING STATION ON THE APPROACH END TO THE ENDING STATION ON THE DEPARTURE END OF THE BASE COURSE WIDENING FOR STAGE I. YELLOW EDGELINE COMPUTED FROM THE BEGINNING STATION ON THE APPROACH END TO THE ENDING STATION ON THE DEPARTURE END OF THE BASE COURSE WIDENING FOR STAGE II. WHITE SKIP CENTERLINE COMPUTED FOR THE LENGTH OF THE BRIDGE. THESE COMPUTATIONS RESULTED IN THE FOLLOWING QUANTITIES:

5296	METERS (YELLOW)
5467	METERS (WHITE)
10763	METERS (TOTAL)

THE QUANTITY OF TEMPORARY PAVEMENT MARKING - LINE 100MM WAS COMPUTED TO ALLOW FOR THE PLACEMENT OF TWO EDGELINES AND A CENTERLINE ON THE WIDENING DURING THE DECK REPAIR OPERATIONS AND TWO EDGELINES AND A CENTERLINE ON THE PAVEMENT AFTER THE COMPLETION OF THE REPAIR WORK AND PRIOR TO THE PLACEMENT OF THE PERMANENT PAVEMENT MARKINGS.

THE LOCATIONS OF THE EXISTING DECK DRAINS TO BE PLUGGED ARE APPROXIMATE. THESE LOCATIONS WERE DERIVED FROM THE ORIGINAL BRIDGE PLANS. ANY DRAINS THAT ARE LOCATED WITHIN THREE METERS OF A SUBSTRUCTURE ELEMENT ARE TO BE PLUGGED.

FOLLOWING THE REMOVAL OF THE BITUMINOUS SURFACE AND WATERPROOFING, THE BRIDGE DECK SHALL BE SCARIFIED TO A DEPTH OF 20MM. THE BRIDGE DECK MICROSILICA CONCRETE OVERLAY SHALL BE CONSTRUCTED AT A DEPTH OF 60MM.

BASE COURSE WIDENING CONSTRUCTED FOR THIS PROJECT WILL REMAIN IN PLACE. THE WIDENING SHALL BE CONSTRUCTED AS PORTLAND CEMENT CONCRETE BASE COURSE WIDENING, 200MM. THE REMOVAL OF THE EXISTING BITUMINOUS SHOULDER SHALL BE PAID FOR SEPARATELY AS BITUMINOUS SHOULDER REMOVAL. ALL OTHER EXCAVATION AND DISPOSAL OF MATERIAL WILL BE INCLUDED IN THE BID PRICE FOR BASE COURSE WIDENING.

THE PORTLAND CEMENT CONCRETE BASE COURSE WIDENING, 200MM SHALL BE REINFORCED WITH WELDED WIRE FABRIC, 152 X 152 - MW25.8 X MW25.8, WITH A MASS OF 2.91 KG/SQ. METER. THIS WELDED WIRE FABRIC WILL NOT BE PAID FOR SEPARATELY BUT SHALL BE INCLUDED IN THE COST OF THE PCC BASE COURSE WIDENING.

BITUMINOUS SHOULDER REMOVAL SHALL CONSIST OF REMOVAL OF THE BITUMINOUS SHOULDER TO A MINIMUM DEPTH OF 200MM TO OBTAIN THE REQUIRED THICKNESS FOR THE PCC BASE COURSE WIDENING.

ALL PLAN DIMENSIONS ARE MEASURED IN MILLIMETERS UNLESS OTHERWISE NOTED.

EXISTING REINFORCEMENT BARS SHALL BE CLEANED AND USED FOR NEW CONSTRUCTION. ALL NEW REINFORCEMENT BARS SHALL BE EPOXY COATED WITH EPOXY COATED BAR SPLICERS FOR STAGE CONSTRUCTION.

EXISTING STRUCTURAL STEEL SHALL ONLY BE CLEANED AND PAINTED AS REQUIRED BY THE SPECIAL PROVISION "CLEANING AND PAINTING ADJACENT AREAS OF EXISTING STEEL STRUCTURES".

ANY REINFORCEMENT BARS THAT ARE DAMAGED DURING CONCRETE REMOVAL OPERATIONS SHALL BE REPAIRED OR REPLACED USING AN APPROVED BAR SPLICER OR ANCHORAGE SYSTEM (COST INCLUDED IN CONCRETE REMOVAL).

ALL NEW STRUCTURAL STEEL SHALL CONFORM TO AASHTO CLASSIFICATION M-270 GRADE 250. THE TOTAL ESTIMATED QUANTITY OF FURNISH AND ERECT STRUCTURAL STEEL REQUIRED FOR THIS PROJECT IS 17130 KG.

THE EXISTING STRUCTURAL STEEL COATING CONTAINS LEAD. THE CONTRACTOR SHALL TAKE APPROPRIATE PRECAUTIONS TO DEAL WITH THE PRESENCE OF LEAD ON THIS PROJECT.

REINFORCEMENT BARS SHALL CONFORM TO THE REQUIREMENTS OF AASHTO M-31M, M-42M OR M-53M, GRADE 400.

THE INORGANIC ZINC RICH PRIMER/ACRYLIC/ACRYLIC PAINT SYSTEM SHALL BE USED FOR SHOP AND FIELD PAINTING OF NEW STRUCTURAL STEEL EXCEPT WHERE OTHERWISE NOTED. THE COLOR OF THE ACRYLIC FINISH COAT SHALL BE REDDISH BROWN, MUNSELL NO. 2.5 YR, 3/4. SEE SPECIAL PROVISIONS FOR "CLEANING AND PAINTING NEW METAL STRUCTURES". EXPANSION JOINT PLATES AND ATTACHED BARS SHALL BE SHOP PAINTED WITH THE ZINC SILICATE PRIMER.

THE STATE OWNED TEMPORARY CONCRETE BARRIERS WHICH ARE TO BE USED IN THIS PROJECT ARE STORED AT THE IDOT MAINTENANCE YARD AT KNIGHTS PRAIRIE WHICH IS LOCATED APPROXIMATELY 11.3 KM WEST OF MCLEANSBORO ON ILLINOIS ROUTE 14 IN HAMILTON COUNTY. A MINIMUM OF 48 HOURS NOTICE WILL BE REQUIRED TO ARRANGE FOR PICK UP AND RETURN OF THE BARRIERS. STATE MAINTENANCE FORCES WILL NOT LOAD OR UNLOAD THE BARRIERS.

64	JEFFERSON	58	2
D-7 BRIDGE DECK REPAIR 1999-1			

INDEX OF SHEETS

SHEET NO.	TITLE
1	TITLE SHEET
2	INDEX OF SHEETS AND GENERAL NOTES
3	SUMMARY OF QUANTITIES
4	SCHEDULE OF QUANTITIES AND DECK DRAIN DETAILS
5-10	EXISTING STRUCTURE DETAILS
11	STAGE CONSTRUCTION DETAILS - LOCATION 1
12-13	EXPANSION JOINT DETAILS - LOCATION 1
14-15	BRIDGE DECK PATCHING SURVEY - LOCATION 1
16	STAGE CONSTRUCTION DETAILS - LOCATION 2
17	ELASTOMERIC BEARING DETAILS - LOCATION 2
18-21	BRIDGE DECK PATCHING SURVEY - LOCATION 2
22	STAGE CONSTRUCTION DETAILS - LOCATION 3
23-24	EXPANSION JOINT DETAILS - LOCATION 3
25-26	ELASTOMERIC BEARING DETAILS - LOCATION 3
27-28	BRIDGE DECK PATCHING SURVEY - LOCATION 3
29	STAGE CONSTRUCTION DETAILS - LOCATION 4
30	EXPANSION JOINT DETAILS - LOCATION 4
31	BRIDGE DECK PATCHING SURVEY - LOCATION 4
32	STAGE CONSTRUCTION DETAILS - LOCATION 5
33-34	EXPANSION JOINT DETAILS - LOCATION 5
35-36	BRIDGE DECK PATCHING SURVEY - LOCATION 5
37	STAGE CONSTRUCTION DETAILS - LOCATION 6
38	EXPANSION JOINT DETAILS - LOCATION 6
39-41	ELASTOMERIC BEARING DETAILS - LOCATION 6
42-45	BRIDGE DECK PATCHING SURVEY - LOCATION 6
46	STAGE CONSTRUCTION DETAILS - LOCATION 7
47-48	BRIDGE DECK PATCHING SURVEY - LOCATION 7
49-50	STAGE CONSTRUCTION DETAILS - LOCATION 8
51-52	BRIDGE DECK PATCHING SURVEY - LOCATION 8
53	NEOPRENE EXPANSION JOINT DETAILS
54	BAR SPLICER AND PREFORMED JOINT SEAL DETAILS
55	ANCHOR BOLT DETAILS FOR ELASTOMERIC BEARINGS
56	GUIDELINES FOR INTERSTATE PAVEMENT MARKINGS
57	REFLECTOR MARKER, TYPE B
58	REFLECTOR MOUNTING DETAIL

THE FOLLOWING STANDARDS ARE A PART OF THESE PLANS AND ARE INCLUDED AFTER SHEET NO. 58:

00001 -02	STANDARD SYMBOLS, ABBREVIATIONS AND PATTERNS
701101	OFF-ROAD OPERATIONS, MULTILANE, LESS THAN 4.5M (15') AWAY, FOR SPEEDS >= 45 MPH
701106	OFF-ROAD OPERATIONS, MULTILANE, MORE THAN 4.5M (15') AWAY, FOR SPEEDS >= 45 MPH
701201	LANE CLOSURE, 2L 2W, DAY ONLY, ON-ROAD TO 600MM (24") OFF-ROAD, FOR SPEEDS >= 45 MPH
701301	LANE CLOSURE, 2L 2W, SHORT TERM OPERATIONS, FOR SPEEDS >= 45 MPH
701401	LANE CLOSURE, MULTILANE, FOR SPEEDS >= 45 MPH
701411 -01	LANE CLOSURE, MULTILANE, AT ENTRANCE OR EXIT RAMP, FOR SPEEDS >= 45 MPH
701426	LANE CLOSURE, MULTILANE, INTERMITTENT OR MOVING OPERATIONS, FOR SPEEDS >= 45 MPH
701601 -02	URBAN LANE CLOSURE, MULTILANE, 1W OR 2W WITH NON-TRAVERSABLE MEDIUM
702001	TRAFFIC CONTROL DEVICES
704001	TEMPORARY CONCRETE BARRIER

REVISIONS		ILLINOIS DEPARTMENT OF TRANSPORTATION GENERAL NOTES & INDEX OF SHEETS DRAWN BY CHECKED BY DATE
NAME	DATE	

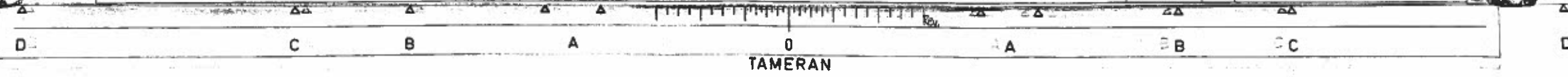

MNO 12/17/98
 1346780XG009800.dgn
 MNO REV 11-17-98
DRAIN

1 2 3 4 5 6 7 8 9
 10 11 12 13 14 15 16 17 18
 19 20 21 22 23 24 25 26 27
 28 29 30 31 32 33 34 35 36
 37 38 39 40 41 42 43 44 45
 46 47 48 49 50 51 52 53 54
 55 56 57 58 59 60 61 62 63
 64 65 66 67 68 69 70 71 72
 73 74 75 76 77 78 79 80 81
 82 83 84 85 86 87 88 89 90
 91 92 93 94 95 96 97 98 99
 100

MNO 12/17/98

SCHEDULE OF QUANTITIES

STRUCTURE NUMBER	LENGTH (€ JOINT TO € JOINT)	EXISTING STRUCTURE WIDTH	AREA	BRIDGE DECK MICROSILOCA CONCRETE OVERLAY	BRIDGE DECK SCARIFICATION	BITUMINOUS CONCRETE REMOVAL (DECK)	BRIDGE DECK GROOVING	PROTECTIVE SHIELD	ELASTOMERIC BEARING ASSEMBLY TYPE 1	ELASTOMERIC BEARING ASSEMBLY TYPE 2	JACK AND REMOVE EXISTING BEARINGS	PLUG EXISTING DECK DRAINS
	METERS	METERS	SO M	SO M	SO M	SO M	SO M	SO M	EACH	EACH	EACH	EACH
SN 041-0085	39.396	5.258	207.144	194	205	205	182					
STAGE I	39.396	6.477	255.168	239	228	228	227					
STAGE II	39.396	6.477	255.168	239	228	228	227					
TOTAL	39.396	11.735	462.312	433	433	433	409					4
SN 041-0086	39.396	5.258	207.144	194	205	205	182					
STAGE I	39.396	6.477	255.168	239	228	228	227					
STAGE II	39.396	6.477	255.168	239	228	228	227					
TOTAL	39.396	11.735	462.312	433	433	433	409					4
SN 041-0077	77.673	5.258	408.405	402	425	425	377					
STAGE I	77.673	6.477	503.088	542	519	519	519					
STAGE II	77.673	6.477	503.088	542	519	519	519					
TOTAL	77.673	11.735	911.493	944	944	944	878	371		6	6	8
SN 041-0078	77.673	5.258	408.405	402	425	425	377					
STAGE I	77.673	6.477	503.088	542	519	519	519					
STAGE II	77.673	6.477	503.088	542	519	519	519					
TOTAL	77.673	11.735	911.493	944	944	944	878	371		6	6	8
SN 041-0075	48.997	5.258	257.626	251	265	265	236					
STAGE I	48.997	6.477	317.354	309	295	295	294		3	3	6	
STAGE II	48.997	6.477	317.354	309	295	295	294		3	3	6	
TOTAL	48.997	11.735	574.980	560	560	560	530		6	6	12	4
SN 041-0076	48.997	5.258	257.626	251	265	265	236					
STAGE I	48.997	6.477	317.354	309	295	295	294		3	3	6	
STAGE II	48.997	6.477	317.354	309	295	295	294		3	3	6	
TOTAL	48.997	11.735	574.980	560	560	560	530		6	6	12	4
SN 041-0060	66.849	5.639	376.962	368	388	388	348					
STAGE I	66.849	6.706	448.289	438	418	418	418					
STAGE II	66.849	6.706	448.289	438	418	418	418					
TOTAL	66.849	12.345	825.251	806	806	806	766	466				2
SN 041-0067	40.248	5.274	212.268	206	218	218	193					
STAGE I	40.248	8.038	323.513	314	302	302	302					
STAGE II	40.248	8.038	323.513	314	302	302	302					
TOTAL	40.248	13.312	535.781	520	520	520	496	536				1
SN 041-0068	40.048	5.226	209.291	203	215	215	191					
STAGE I	40.048	9.094	364.197	353	341	341	341					
STAGE II	40.048	9.094	364.197	353	341	341	341					
TOTAL	40.048	14.320	573.487	556	556	556	532	573				1
SN 041-0089	101.212	5.528	559.500	546	576	576	516					
STAGE I	101.212	6.629	670.934	655	625	625	625					
STAGE II	101.212	6.629	670.934	655	625	625	625					
TOTAL	101.212	12.157	1230.434	1201	1201	1201	1141	180	9	3	12	4
SN 041-0090	101.212	5.528	559.500	546	576	576	516					
STAGE I	101.212	6.629	670.934	655	625	625	625					
STAGE II	101.212	6.629	670.934	655	625	625	625					
TOTAL	101.212	12.157	1230.434	1201	1201	1201	1141	180	9	3	12	4
SN 041-0087	65.240	5.258	343.032	336	356	356	316					
STAGE I	65.240	6.477	422.559	414	394	394	394					
STAGE II	65.240	6.477	422.559	414	394	394	394					
TOTAL	65.240	11.735	765.591	750	750	750	730					
SN 041-0088	65.240	5.258	343.032	336	356	356	316					
STAGE I	65.240	6.477	422.559	414	394	394	394					
STAGE II	65.240	6.477	422.559	414	394	394	394					
TOTAL	65.240	11.735	765.591	750	750	750	730					
SN 041-0081	34.944	5.258	183.736	177	187	187	166					
STAGE I	34.944	7.087	247.648	239	229	229	228					
STAGE II	34.944	7.087	247.648	239	229	229	228					
TOTAL	34.944	12.345	431.384	416	416	416	399	431				4
SN 041-0082	35.103	5.359	188.117	182	192	192	172					
STAGE I	35.103	9.676	339.657	318	318	318	317					
STAGE II	35.103	9.676	339.657	318	318	318	317					
TOTAL	35.103	15.035	527.774	510	510	510	489	528				2
TOTAL				10584	10584	10584	10053	3636	48	48	96	50

FA1	SECTION	COUNTY	SHEET NO.	TOTAL SHEETS
64		JEFFERSON	58	4
D-7 BRIDGE DECK REPAIR 1999-1				

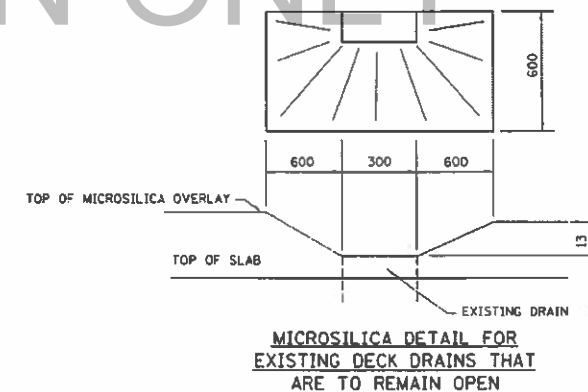
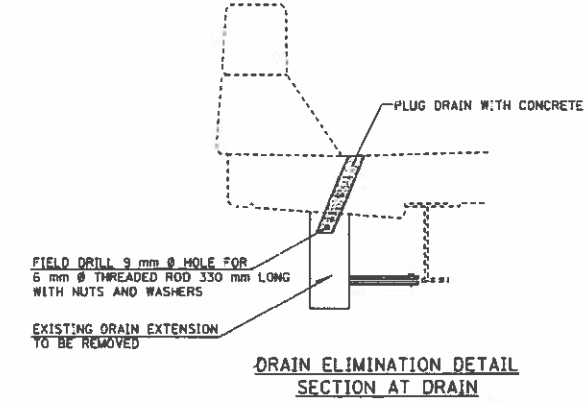

REVISIONS		ILLINOIS DEPARTMENT OF TRANSPORTATION SCHEDULE OF QUANTITIES & DECK DRAIN DETAIL DRAWN BY CHECKED BY DATE
NAME	DATE	

D C B A 0 A B C D
 TAMERAN

MMO 12/17/98
 \94678\0029800.dgn
 MMO REV. 10-29-98

1 2 3 4 5 6 7 8 9
 10 11 12 13 14 15 16 17 18 19 20
 21 22 23 24 25 26 27 28 29 30
 31 32 33 34 35 36 37 38 39 40
 41 42 43 44 45 46 47 48 49 50
 51 52 53 54 55 56 57 58 59 60
 61 62 63 64 65 66 67 68 69 70
 71 72 73 74 75 76 77 78 79 80
 81 82 83 84 85 86 87 88 89 90
 91 92 93 94 95 96 97 98 99 100

MMO 12/17/98

SECTION	COUNTY	SHEET NO.	TOTAL SHEETS
64	JEFFERSON	58	9
PROJECT NO. 10-29-98			
D-T BRIDGE DECK REPAIR 1999-1			

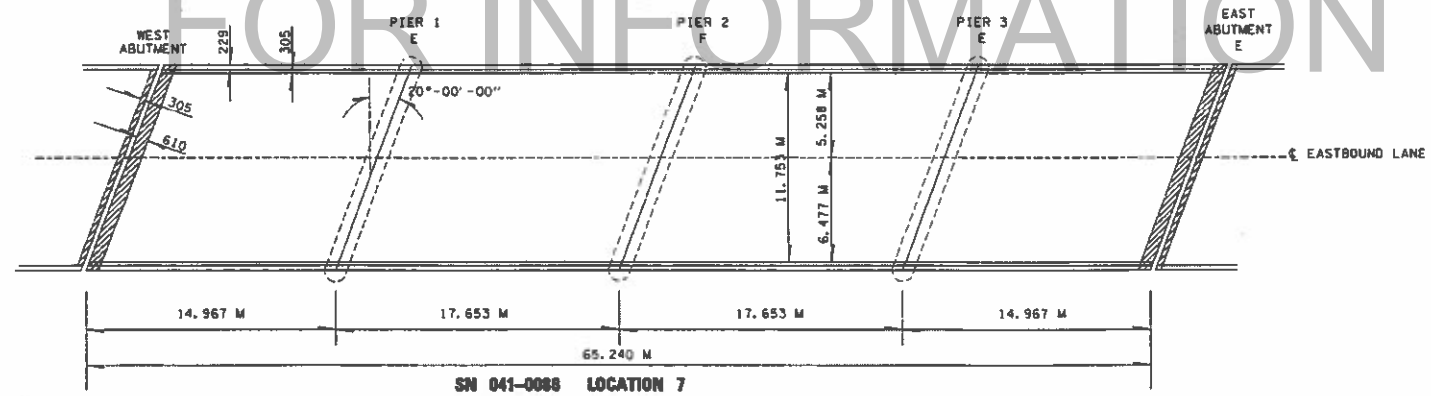
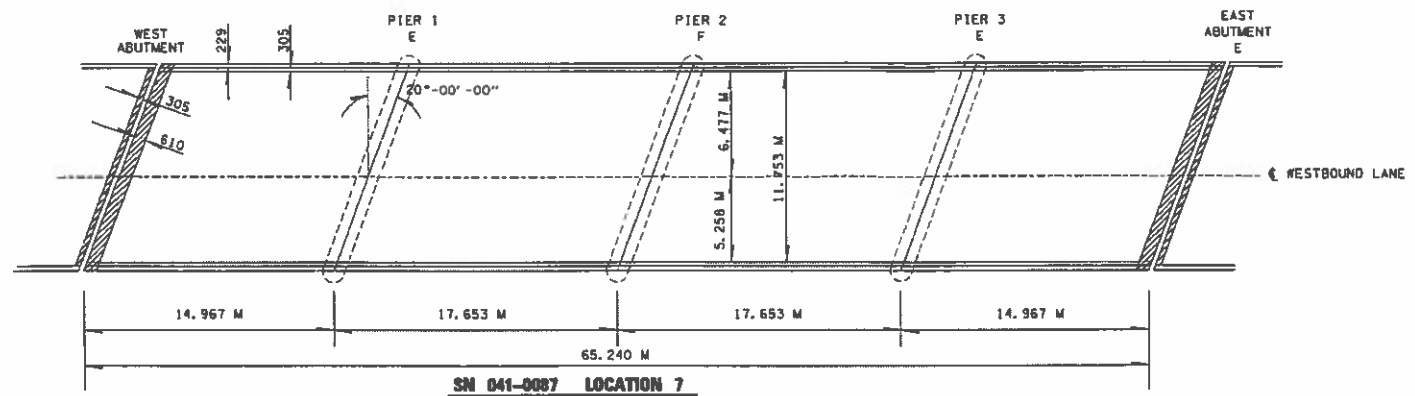

LEGEND

- EXPANSION JOINT TO BE REPLACED
- EXPANSION JOINT WITH CONCRETE PROTECTION TO REMAIN IN PLACE
- PROTECTIVE SHIELD
- EXPANSION BEARINGS TO BE REPLACED WITH NEW ELASTOMERIC BEARINGS
- PLUG EXISTING DECK DRAINS

NOTE: NEW MICROSILICA CONCRETE OVERLAY ON EACH STRUCTURE

REVISIONS	
NAME	DATE

ILLINOIS DEPARTMENT OF TRANSPORTATION
EXISTING STRUCTURE DETAILS
 SN 041-0087 & SN 041-0088
 LOCATION 7
 DRAWN BY _____
 CHECKED BY _____
 DATE _____



MNO 12/14/98
 9467861\0002980g.dgn
 MNO REV: 04-22-98
 07SC1

MNO 12/14/98
 9467861\0002980g.dgn
 MNO REV: 04-22-98
 07SC2

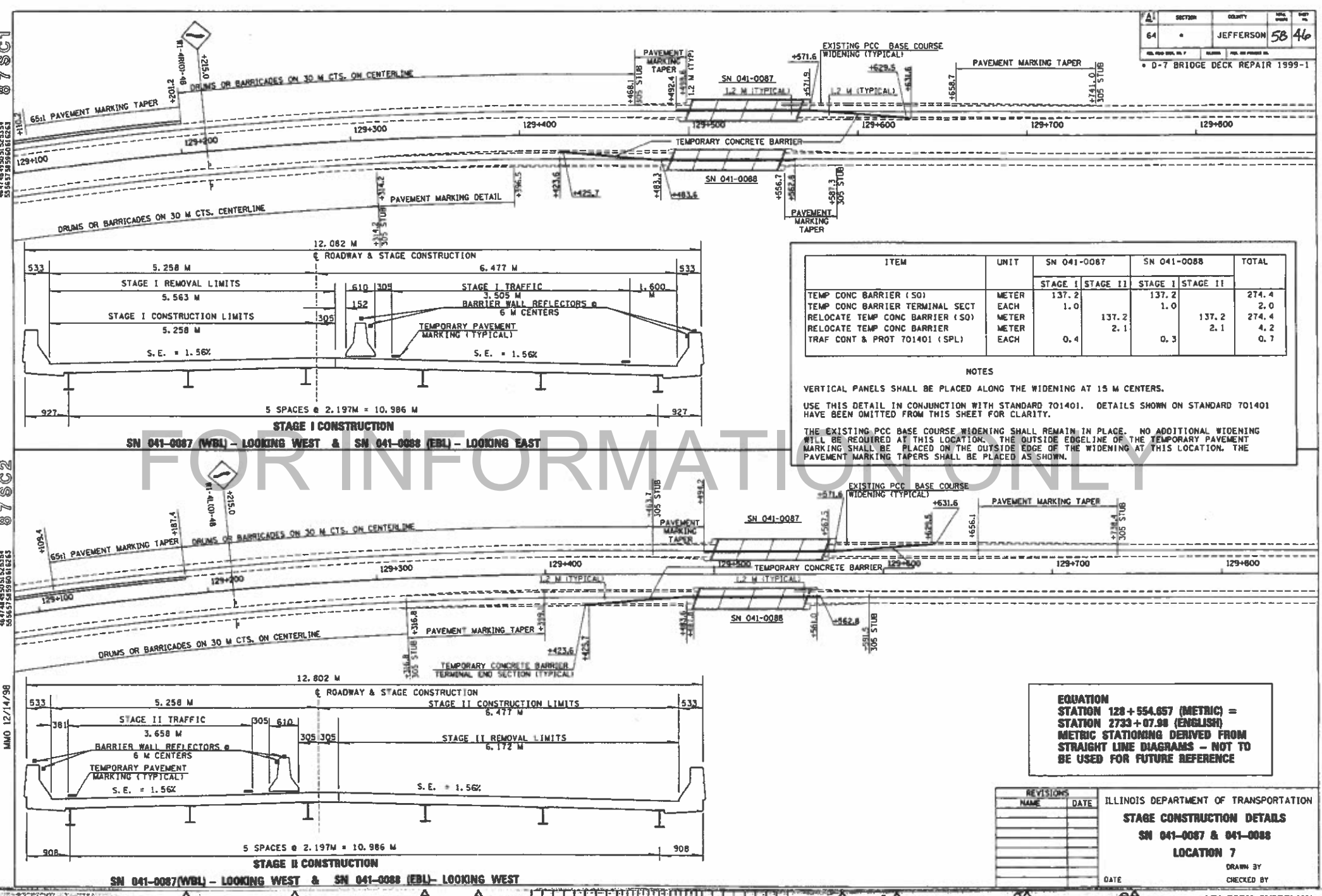

SECTION	COUNTY	SHEET NO.	TOTAL SHEETS
64	JEFFERSON	58	46

D-7 BRIDGE DECK REPAIR 1999-1

ITEM	UNIT	SN 041-0087		SN 041-0088		TOTAL
		STAGE I	STAGE II	STAGE I	STAGE II	
TEMP CONC BARRIER (SO)	METER	137.2		137.2		274.4
TEMP CONC BARRIER TERMINAL SECT	EACH	1.0		1.0		2.0
RELOCATE TEMP CONC BARRIER (SO)	METER		137.2		137.2	274.4
RELOCATE TEMP CONC BARRIER	METER		2.1		2.1	4.2
TRAF CONT & PROT 701401 (SPL)	EACH	0.4		0.3		0.7

NOTES

VERTICAL PANELS SHALL BE PLACED ALONG THE WIDENING AT 15 M CENTERS.

USE THIS DETAIL IN CONJUNCTION WITH STANDARD 701401. DETAILS SHOWN ON STANDARD 701401 HAVE BEEN OMITTED FROM THIS SHEET FOR CLARITY.

THE EXISTING PCC BASE COURSE WIDENING SHALL REMAIN IN PLACE. NO ADDITIONAL WIDENING WILL BE REQUIRED AT THIS LOCATION. THE OUTSIDE EDGELINE OF THE TEMPORARY PAVEMENT MARKING SHALL BE PLACED ON THE OUTSIDE EDGE OF THE WIDENING AT THIS LOCATION. THE PAVEMENT MARKING TAPERS SHALL BE PLACED AS SHOWN.

EQUATION
 STATION 128+554.657 (METRIC) =
 STATION 2733+07.98 (ENGLISH)
 METRIC STATIONING DERIVED FROM
 STRAIGHT LINE DIAGRAMS - NOT TO
 BE USED FOR FUTURE REFERENCE

REVISIONS		DATE	ILLINOIS DEPARTMENT OF TRANSPORTATION
NAME	DATE		
			STAGE CONSTRUCTION DETAILS
			SN 041-0087 & 041-0088
			LOCATION 7
			DRAWN BY
			CHECKED BY

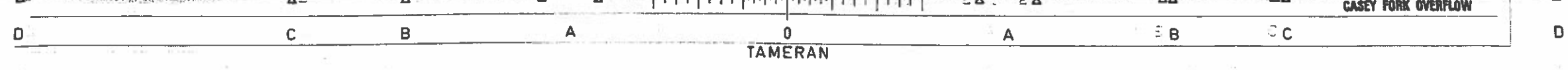

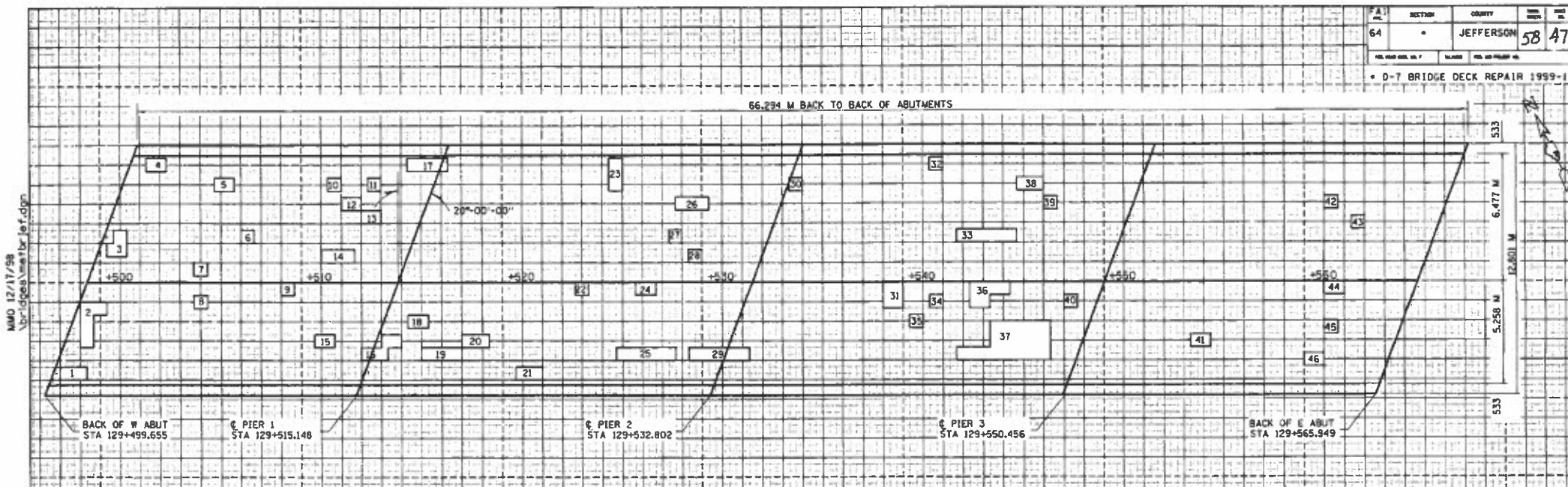

FAI	SECTION	COUNTY	PROJECT NO.
64		JEFFERSON	58 47
D-7 BRIDGE DECK REPAIR 1999-1			

MMO 12/17/98
bridges\mtr\ref.dgn

PATCH NO.	SIZE	DECK SLAB REPAIR PART DEPTH		PATCH NO.	SIZE	DECK SLAB REPAIR PART DEPTH		PATCH NO.	SIZE	DECK SLAB REPAIR PART DEPTH					
		SO M	DEPTH			SO M	DEPTH			SO M	DEPTH				
1	1.3 x 0.7		0.9	23	0.7 x 1.7		1.2	46	1.0 x 0.7		0.7				
2	1.3 x 0.7		0.9	24	1.0 x 0.7		0.7	TOTAL				45.6	0.0	2.1	0.0
3	0.7 x 0.7		1.2	25	3.0 x 0.7		2.1	PARTIAL DEPTH =				45.6			
4	0.7 x 0.7		0.5	26	1.7 x 0.7		1.2	USE				46	50 M		
5	1.0 x 0.7		0.7	27	0.7 x 0.7		0.5	FULL DEPTH, TYPE 1 =				0.0			
6	1.0 x 0.7		0.7	28	0.7 x 0.7		0.5	USE				0	50 M		
7	0.7 x 0.7		0.5	29	3.0 x 0.7		2.1	FULL DEPTH, TYPE 2 =				2.1			
8	0.7 x 0.7		0.5	30	0.7 x 0.7		0.5	USE				2	50 M		
9	0.7 x 0.7		0.5	31	1.0 x 1.3		1.3								
10	0.7 x 0.7		0.5	32	0.7 x 0.7		0.5								
11	0.7 x 0.7		0.5	33	3.0 x 0.7		2.1								
12	1.0 x 0.7		0.7	34	0.7 x 0.7		0.5								
13	1.0 x 0.7		0.7	35	0.7 x 0.7		0.5								
14	1.7 x 0.7		1.2	36	1.0 x 1.3		1.3								
15	1.0 x 0.7		0.7	37	1.7 x 0.7		1.2								
16	1.0 x 0.7		0.7	38	3.0 x 2.0		6.0								
17	1.3 x 0.7		0.9	39	1.3 x 0.7		0.9								
18	2.0 x 0.7		1.4	40	0.7 x 0.7		0.5								
19	1.0 x 0.7		0.7	41	1.0 x 0.7		0.7								
20	1.3 x 0.7		0.9	42	0.7 x 0.7		0.5								
21	1.3 x 0.7		0.9	43	0.7 x 0.7		0.5								
22	0.7 x 0.7		0.5	44	1.0 x 0.7		0.7								
				45	0.7 x 0.7		0.5								

PATCHING SURVEY
BY PENETRADAR CORP.
JUNE 9, 1998

The Engineer shall mark the actual deck repairs on the as-built plans.

FAI ROUTE 64 WBL
JEFFERSON COUNTY
SECTION 41-8B-1
CASEY FORK OVERFLOW
0.6 MILE E OF ILL 37
S.N. 041-0087

THE SIZES SHOWN
GRAPHICALLY ABOVE
ARE APPROXIMATE.
SEE THIS TABLE
FOR ACTUAL SIZES.

87

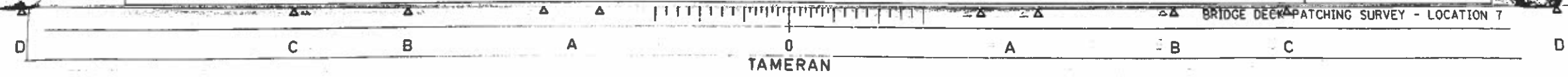

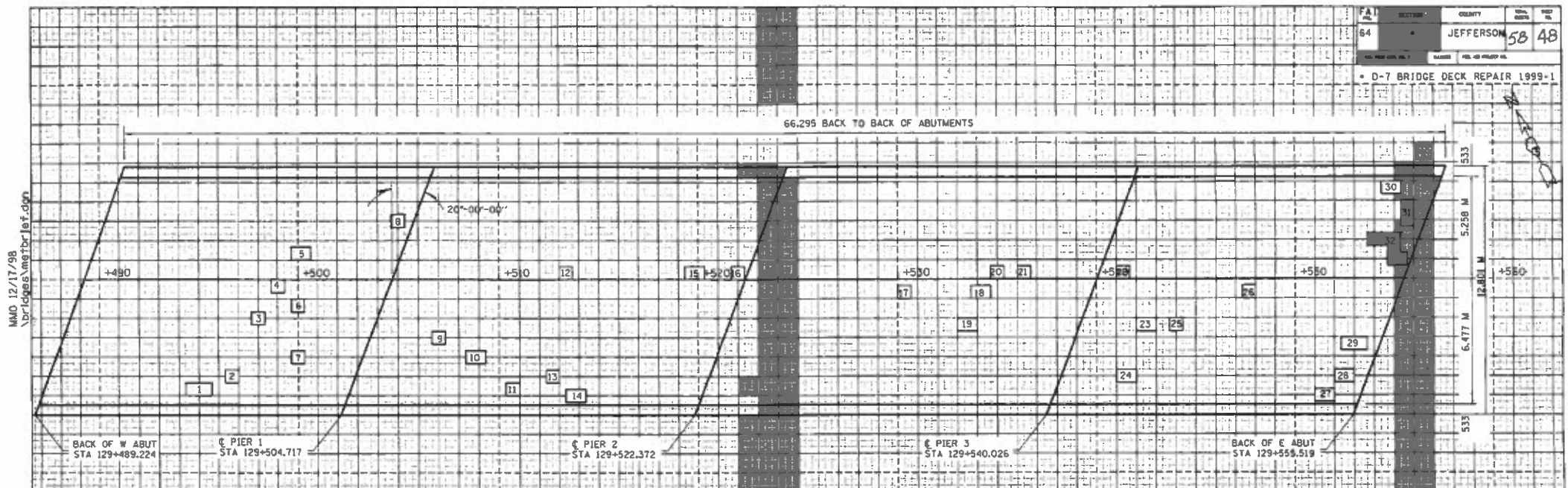

MWD 12/17/98
N:\bridges\metbr\ref.dwg

FAI	SECTION	COUNTY	NO.
64		JEFFERSON	58 48

D-7 BRIDGE DECK REPAIR 1999-1

PATCH NO.	SIZE	DECK SLAB REPAIR DEPTH			
		SO M	SO M	SO M	SO M
1	1.3 x 0.7				0.9
2	0.7 x 0.7	0.5			
3	0.7 x 0.7	0.5			
4	0.7 x 0.7	0.5			
5	1.0 x 0.7				0.7
6	0.7 x 0.7	0.5			
7	0.7 x 0.7	0.5			
8	0.7 x 0.7		0.5		
9	0.7 x 0.7	0.5			
10	1.0 x 0.7	0.7			
11	0.7 x 0.7	0.5			
12	0.7 x 0.7	0.5			
13	0.7 x 0.7	0.5			
14	1.0 x 0.7				0.7
15	1.0 x 0.7	0.7			
16	0.7 x 0.7	0.5			
17	0.7 x 0.7	0.5			
18	1.0 x 0.7	0.7			
19	1.0 x 0.7	0.7			
20	0.7 x 0.7	0.5			
21	0.7 x 0.7	0.5			
22	0.7 x 0.7	0.5			
23	1.0 x 0.7	0.7			
24	1.0 x 0.7	0.7			
25	0.7 x 0.7	0.5			
26	0.7 x 0.7		0.5		
27	1.0 x 0.7				0.7
28	1.0 x 0.7				0.7
29	1.3 x 0.7		0.9		
30	1.0 x 0.7		0.7		
31	0.7 x 1.3		0.9		
32	1.7 x 0.7		1.2		
	0.7 x 0.3		0.2		
	1.0 x 0.7		0.7		
TOTAL		16.8	0.5	3.7	0.0
PARTIAL DEPTH =		16.8			
USE		17	SO M		
FULL DEPTH, TYPE 1 =		0.5			
USE		1	SO M		
FULL DEPTH, TYPE 2 =		3.7			
USE		4	SO M		

PATCHING SURVEY
BY PENETRADOR CORP.
JUNE 9, 1998

The Engineer shall mark the actual deck repairs on the as-built plans.

FAI ROUTE 64 EBL
JEFFERSON COUNTY
SECTION 41-8B-1
CASEY FORK OVERFLOW
0.6 MILE E OF ILL 37
S.N. 041-0088

THE SIZES SHOWN
GRAPHICALLY ABOVE
ARE APPROXIMATE.
SEE THIS TABLE
FOR ACTUAL SIZES.

88

