

RT. SBI-70A

SEC. III-V-CWPGH
III-V-BWPGH
III-V-XWPGH

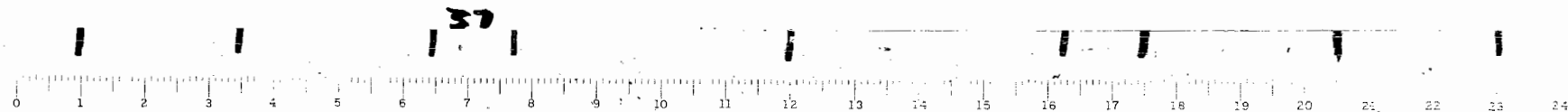

STATE OF ILLINOIS
DEPARTMENT OF PUBLIC WORKS AND BUILDINGS
DIVISION OF HIGHWAYS
**PLANS FOR PROPOSED
STATE BOND ISSUE HIGHWAY**

70-A WPGH La Salle 30
WPGH 210-A

INDEX TO SHEETS

SECTION III-VX-WPGH	
Sheet No.	Title Page
2	Standard 1702, 1671, 1636
3	1649, 1650
4	1667, 1664
5	1663, 1666
6	Details of Sidewalks of Gutter Outlets
7	Source of Borrow
8	Plan and Profile Sta. 692+00 to 710+00
9	Inclusive Cross Sections
22	Standard 1688, 1687
23	1668, B.C.R.#1

SECTION III-VB-WPGH & III-VC-WPGH	
Sheet No.	Title Page
8	Plan and Profile Sta. 692+00 to 710+00
24	Inclusive Spec. Bridge Des. Sta. 700+51.08
30	Standard 1177

SCALES

1" = 100' HORIZONTAL
1" = 10' VERTICAL

S.B.I. ROUTE 70-A SEC. III-V-X WPGH LA SALLE CO.
U.S. WORKS PROGRAM GRADE CROSSING
PROJECT WPGH 210-A

I-Beam railroad overhead bridge (A.T.&S.F.R.R.) 1 span @ 63'-5" and 2 spans @ 55'-4" at Sta. 700+51.08
a point near the NE corner of the S.E. 1/4 of Sec. 16, T. 31N., R. 5E. of the 3rd PM.

From a point near the NE Cor. of the S.E. 1/4 of the N.E. 1/4 of Sec. 16, T. 31N., R. 5E. of the 3rd PM.
To a point near the S.E. Cor. of the N.E. 1/4 of the S.E. 1/4 of Sec. 16, T. 31N., R. 5E. of the 3rd PM.

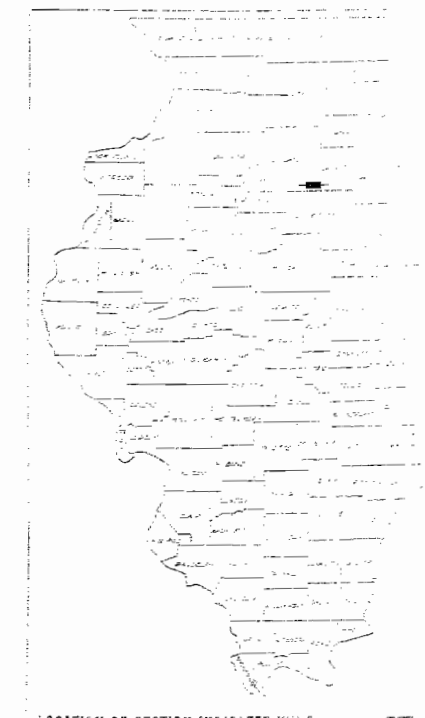

SUMMARY OF QUANTITIES

SECTION III-VB WPGH

457	Cu. Yds.	Class X Concrete.
31,220	Lbs.	Reinforcement Bars.
731	Bbls.	Cement.

SECTION III-VC WPGH

164	Cu. Yds.	Hand Rail Concrete.
1925	Cu. Yds.	Class X Concrete.
42960	Lbs.	Reinforcement Bars.
172,510	Lbs.	Structural Steel.
4	Each	Cast Iron Frames & Grates
300	Lin. Ft.	Corrugated Metal Pipe 3 inch.
1,600	Sq. Ft.	Hollow Floor or Wall Tile.
1	Each	Name Plate.
2,160	Sq. Ft.	Welded Wire Fabric.
334	Bbls.	Cement.

SECTION III-VX WPGH

1260	Cu. Yds.	Earth Excavation
69000	Cu. Yds.	Borrow
1270	Sq. Yds.	Earth Shoulders
3155	Sq. Yds.	P.C. Concrete Pavement
87	Sq. Yds.	P.C. Concrete Pavement 16 1/2" x 10 1/2" x 16 1/2"
74	Lin. Ft.	Storm Sewers 18"
2592	Lin. Ft.	Plain Concrete Gutter, Type A
20	Each	Furnishing and Erecting R.O.W. Markers
2	Each	Section Markers
282	Cu. Yds.	Class X Concrete
5086	Lbs.	Reinforcement Bars
14770	Sq. Ft.	P.C. Concrete Sidewalk 4"
130	Sq. Ft.	Welded Wire Fabric
2240	Lin. Ft.	Metal Plate Guard Rail
1558	Bbls.	Cement

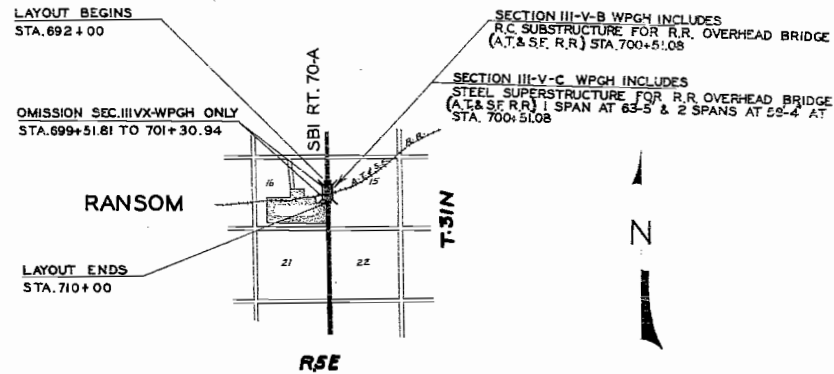

LAYOUT

Approximate Scale 1 Inch = 1 Mile
Net Length of Layout = 1800.0 Ft. = 0.3409 Miles

STATE LINE	---	RETAINING WALL	---
COUNTY LINE	---	BASE OR SURVEY LINE	---
CITY, VILLAGE OR TOWN	---	LEVEE	---
TOWNSHIP LINE	---	CULVERT	---
SECTION LINE	---	STORM SEWER	---
GRANT LINE	---	TILE DRAIN	---
SECTION CORNER	⊙	DROP INLET	---
FENCE LINE	---	TROLLEY POLE	---
UNFENCED PROPERTY	---	POWER POLE	---
RIGHT OF WAY LINE	---	TELEPHONE OR TELEGRAPH HOLE	---
GUARD RAIL	---	MARSH	---
STEAM RAILROAD	---	HEDGE	---
ELECTRIC RAILROAD	---		

October 16, 1935
J. J. Fleming
10-17
2000
J. J. Fleming
10-17, 1935
J. J. Fleming

RECOMMENDED FOR APPROVAL
DISTRICT ENGINEER, Bureau of Public Works
RECOMMENDED FOR APPROVAL
CHIEF ENGINEER, Bureau of Public Works
APPROVED
CHIEF, Bureau of Public Works

Roy J. Carter, October 16, 1935
New Road Sec. 16, T. 31N., R. 5E.

La Salle COUNTY SECTION III-VB WPGH ROUTE SBI 70-A
III-VX

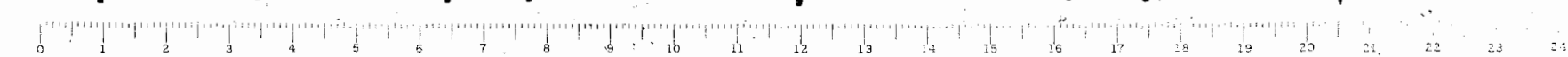

ROAD DISTRICT	SEC	COUNTY	TOTAL SHEETS	SHEET NO.
70A	111VX	La Salle	30	21
REV. ROAD DISTRICT 71 ILLINOIS FEB. 15, 1964				

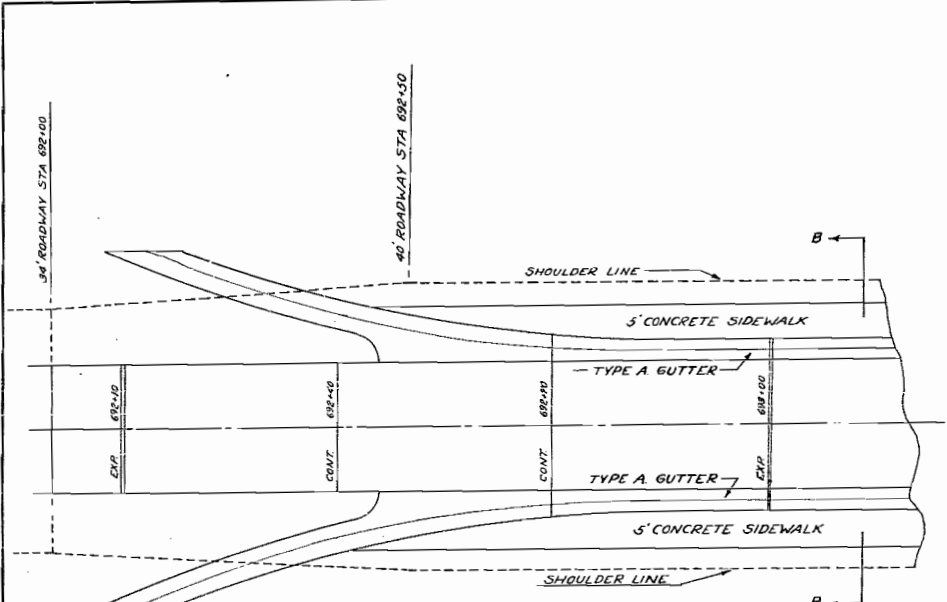

DETAIL OF SIDEWALK AND SHOULDERS AT GUTTER OUTLETS STA 692+46 TO STA 692+82

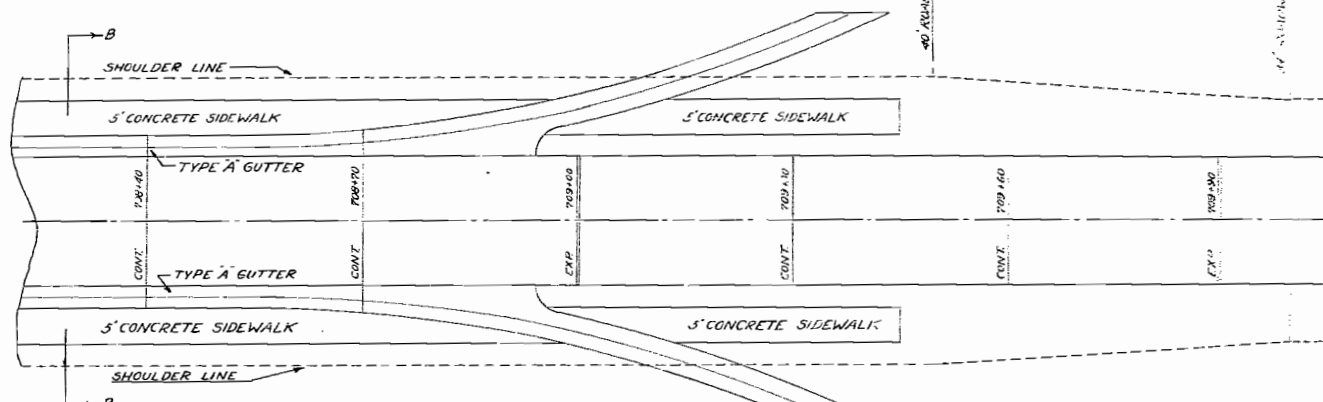

DETAIL OF SIDEWALK AND SHOULDERS AT GUTTER OUTLETS STA 708+58 TO STA 708+94

COST OF 1/2" BITUMINOUS TRANSVERSE EXPANSION TO BE INCLUDED IN THE UNIT PRICE BID PER SQ. YARD FOR R.C. CONC. PAVEMENT.

1/2" INCH PREMOULDED BITUMINOUS EXPANSION JOINT SHALL BE INSTALLED BETWEEN THE GUTTER AND SIDEWALK, AND BETWEEN THE SIDEWALK AND RIGID STRUCTURES. COST TO BE INCLUDED IN THE UNIT PRICE BID PER SQ. FT. FOR R.C. CONC. SIDEWALK.

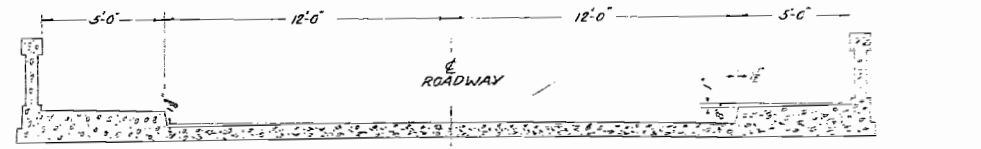

SEC. AA

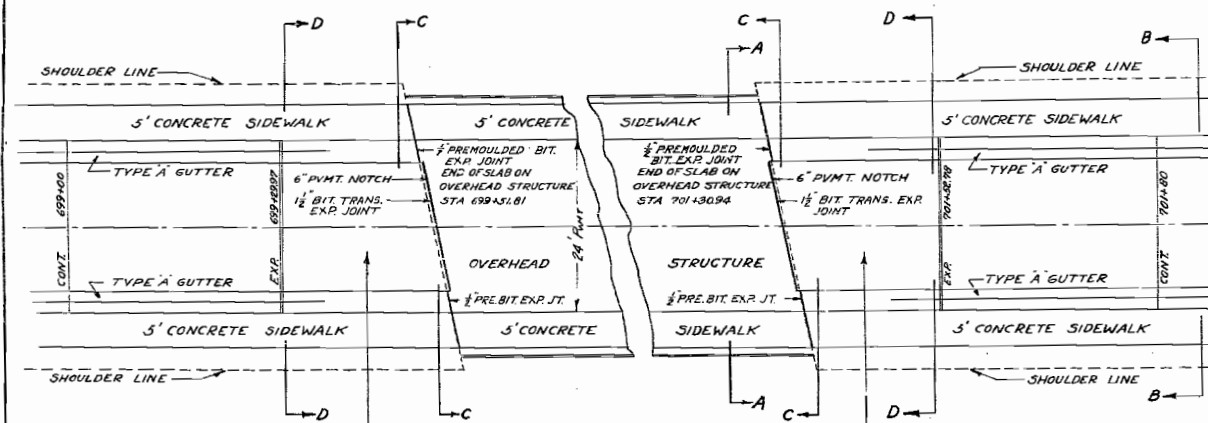

DETAIL OF SIDEWALK AND GUTTER AT OVERHEAD STRUCTURE

SINGLE REINFORCED BRIDGE APPROACH SLAB - METHOD 1 - STANDARD 1688-70 TO BE CONSTRUCTED ON EACH END OF OVERHEAD STRUCTURE. INCLUDED IN ESTIMATE FOR SEC 111VX

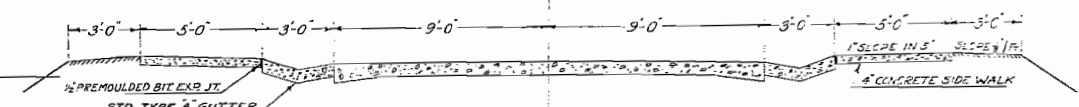

SEC. BB

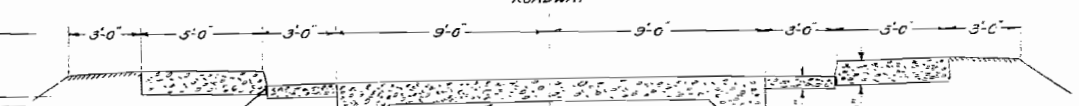

SEC. CC

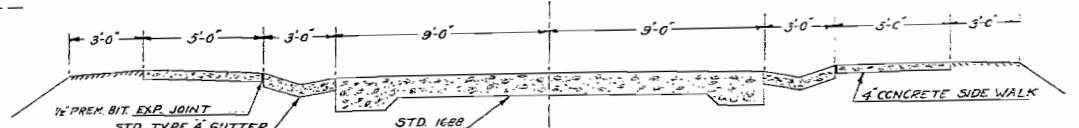

SEC. DD

THE COST OF THICKENING THE SIDEWALK AND ADJUSTING THE GUTTER TO FIT THE SIDEWALK AND GUTTER OF THE OVERHEAD STRUCTURE, AS SHOWN BY SEC. CC AND SEC. DD, SHALL BE INCLUDED IN THE UNIT PRICE BID FOR PORTLAND CEMENT CONCRETE SIDEWALK AND TYPE A GUTTER

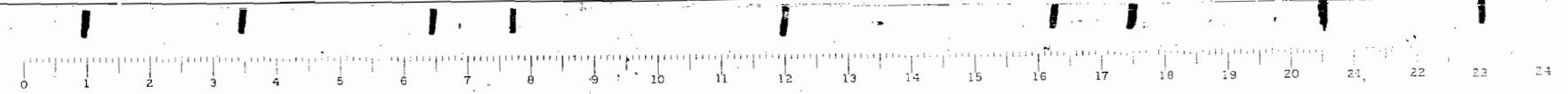

SECTION	SEC	COUNTY	TOWNSHIP	RANGE
23	III VX	La Salle	25	—
TIT. PLAC. DIST. No. 71 EUNING FEB. 15, 1904 2374				

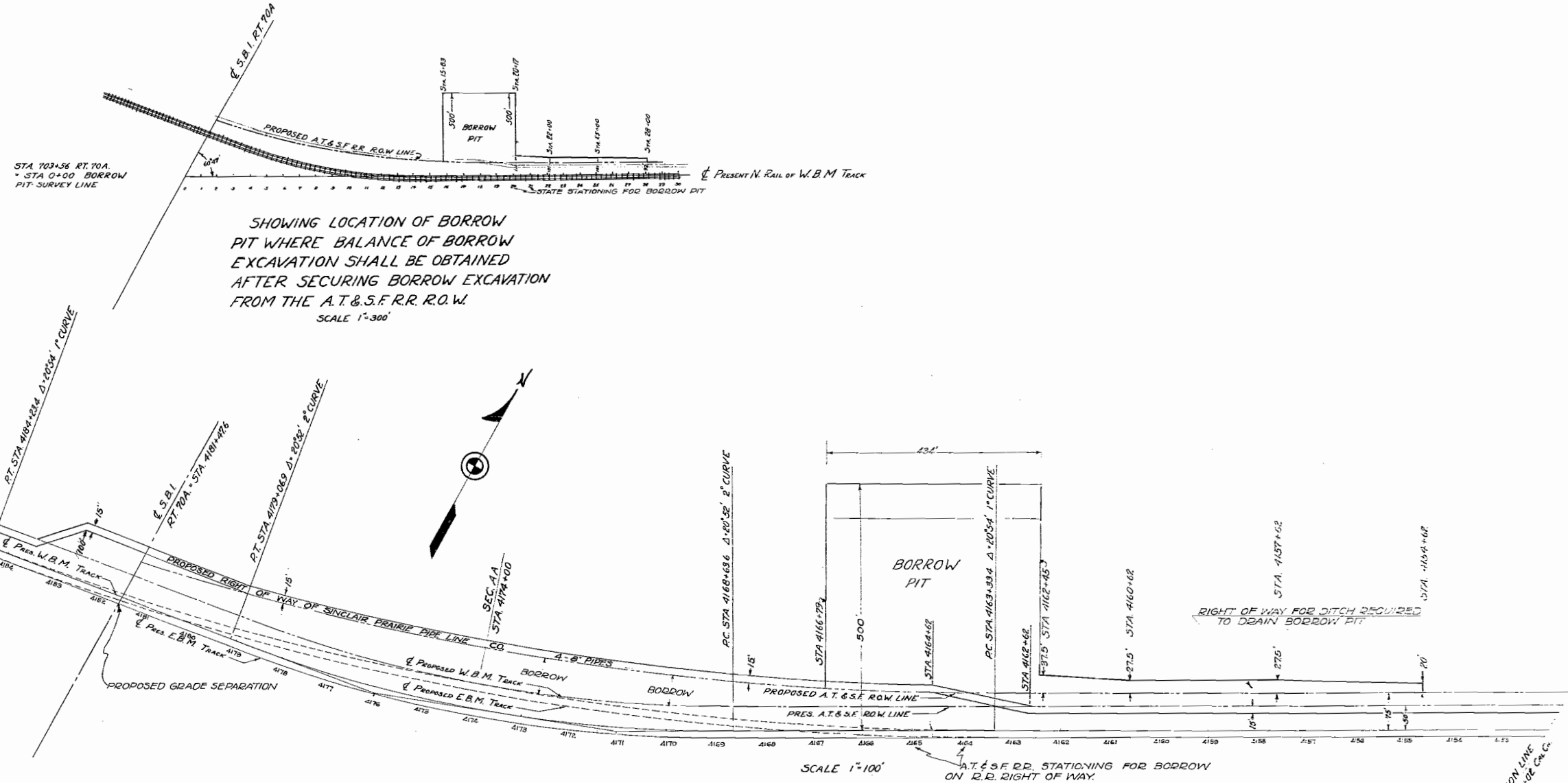

STA 703+38 RT 70A
STA 0+00 BORROW PIT SURVEY LINE

A.T.&S.F.R.R. B.M. 10 CUT RT. H.W. OF CULVERT
B.M. 79C STA 4181+48 ELEV. 195.49
NOTE: THIS B.M. IS THE SAME POINT AS STATE OF ILLINOIS B.M. 57 STA 700+30 RT ELEV. 702.17

SOURCE OF BORROW EXCAVATION
RT. 70A SEC. III VX
LA SALLE CO.

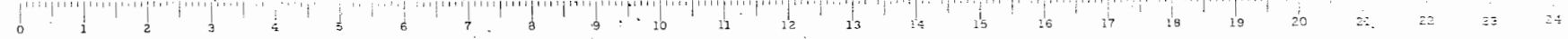

STATION	SEC.	COUNTY	TOTAL
702	15	LA SALLE	30
STA. 692+00	TO STA. 710+00		
PL. ROAD DIST. BY T. WALLING	PL. BY T. WALLING		

STA. 692+00 IS A POINT ON THE PRESENT PAVEMENT OF ROUTE 70-A 3750.5 FT. NORTH OF THE N. W. COR. OF SEC. 22 T31N R5E OF THE 3RD R.M.

ALL EXISTING STRUCTURES WITHIN THE RIGHT OF WAY EXCEPT AS NOTED TO BE REMOVED BY THE CONTRACTOR WITHOUT ADDITIONAL COMPENSATION

ADDITIONAL COMPENSATION FOR OVERHAUL NOT ALLOWED FOR QUANTITIES SHOWN ON PLANS

ALL METALLIC AIR CHAMBER EXPANSION JOINTS TO BE INSTALLED THROUGH PAVEMENT AND GUTTER AT 90 FOOT INTERVALS EXCEPT AS SHOWN ON PLANS

SEALED METALLIC CONTRACTION JOINTS TO BE INSTALLED THROUGH PAVEMENT AND GUTTER AT 30 FOOT INTERVALS BETWEEN EXPANSION JOINTS EXCEPT AS SHOWN ON PLANS

CONSTRUCT METAL PLATE GUARD RAIL STANDARD 1681 AS FOLLOWS

STATION TO STATION	LENGTH
695+50 LT. 699+47 LT.	397 FT.
695+50 RT. 699+56 RT.	406 "
701+27 LT. 708+50 LT.	723 "
701+36 RT. 708+50 RT.	714 "
TOTAL	2240 FT.

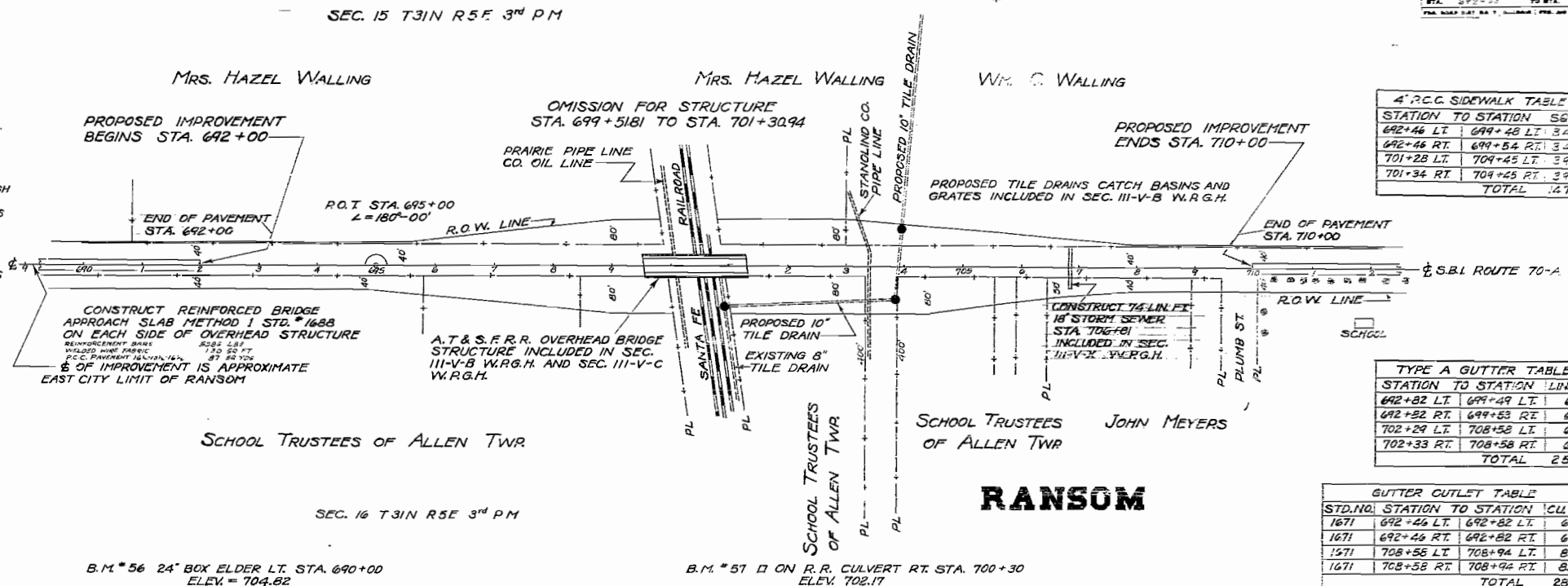

4" R.C.C. SIDEWALK TABLE

STATION TO STATION	SG. FT.
692+46 LT. 699+48 LT.	3420
692+46 RT. 699+54 RT.	3435
701+28 LT. 709+45 LT.	3965
701+34 RT. 709+45 RT.	3935
TOTAL	14770

TYPE A GUTTER TABLE

STATION TO STATION	LN. FT.
692+82 LT. 699+49 LT.	667
692+82 RT. 699+53 RT.	671
702+29 LT. 708+58 LT.	629
702+33 RT. 708+58 RT.	625
TOTAL	2592

GUTTER OUTLET TABLE

STD. NO.	STATION TO STATION	CU. YDS.
1671	692+46 LT. 692+82 LT.	6.1
1671	692+46 RT. 692+82 RT.	6.1
1571	708+58 LT. 708+94 LT.	8.0
1671	708+58 RT. 708+94 RT.	8.0
TOTAL		28.2

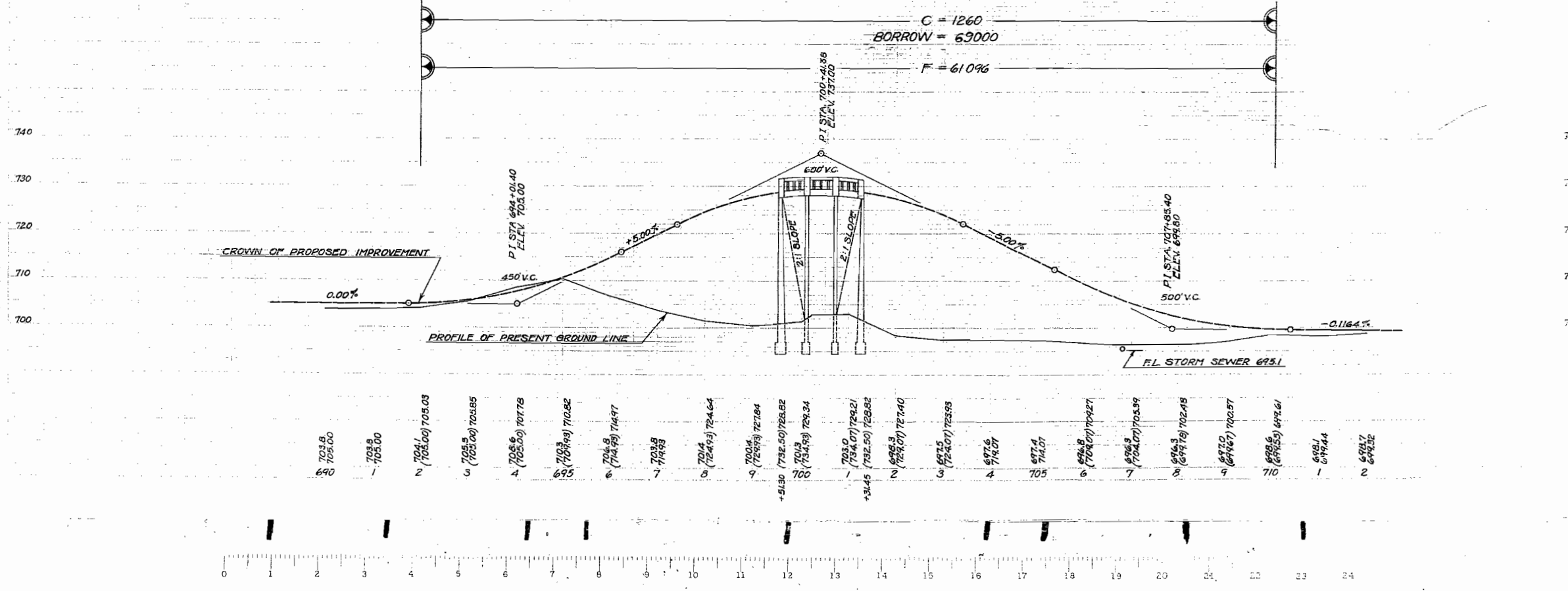

H.L. Kaufman 2-9-32

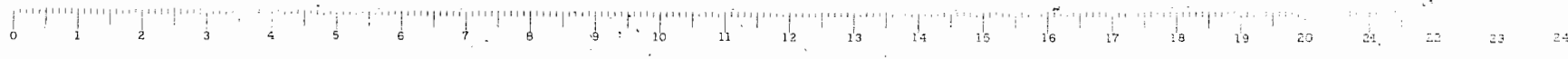

PT. 70A SEC. 11VX LA SALLE CO

SECTION	COUNTY	TWP.	RANGE
70A	LA SALLE	11V	X
STA. 692+00	TO STA. 692+00		
FOR ROAD CUT BY F. 1835 (F. 1835)			

698 701
 697 703
 696 706
 695 710
 694 708
 693 705
 692 704

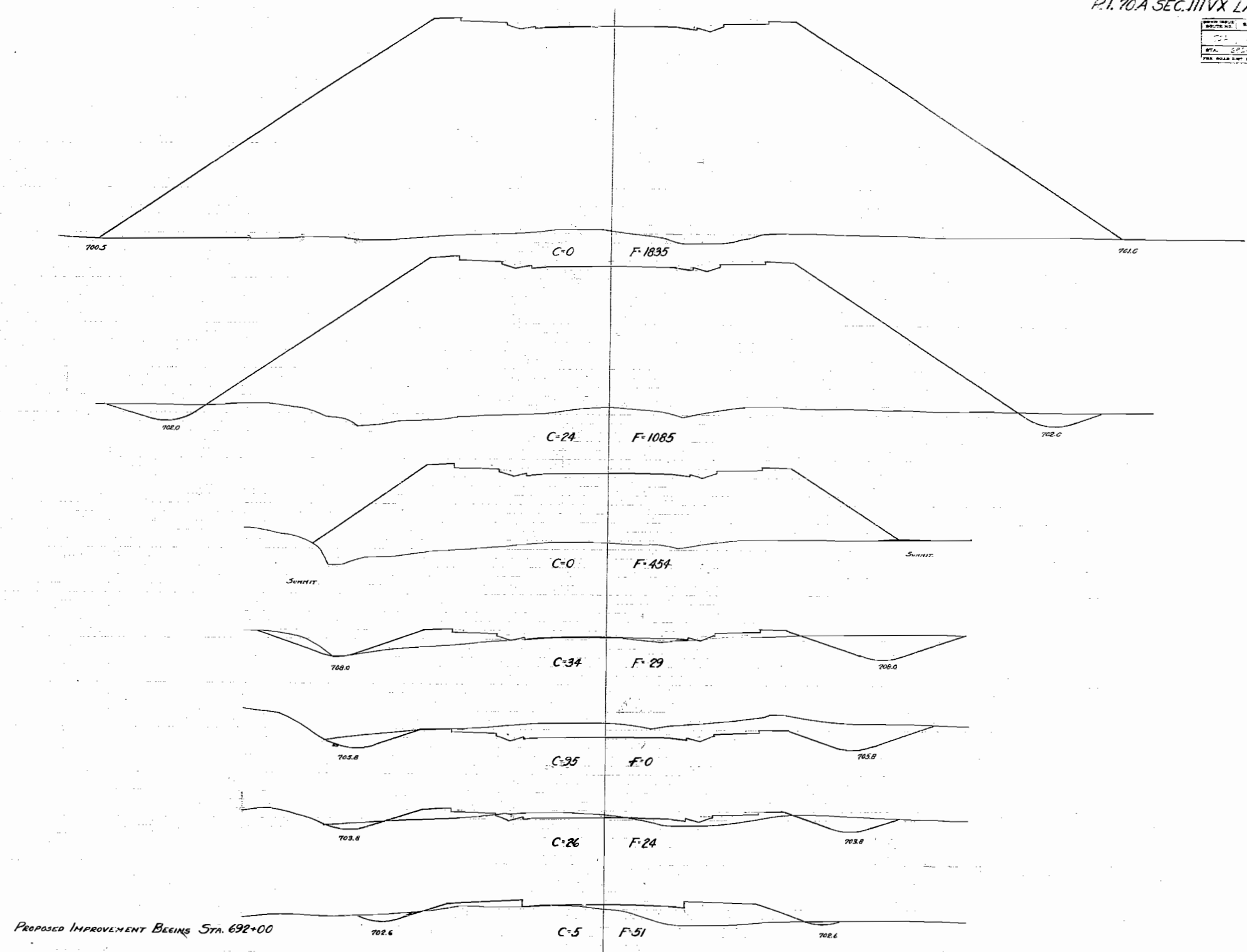

PROPOSED IMPROVEMENT BEGINS STA. 692+00

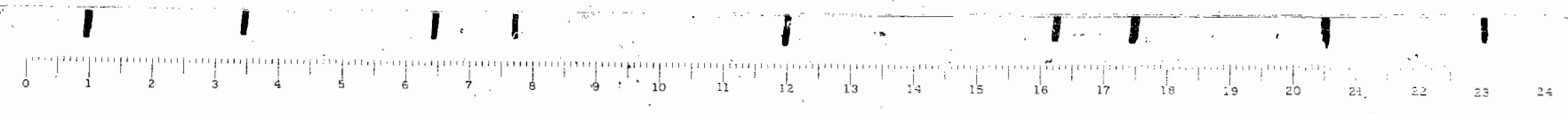

RT. 70A SEC IIIVX LA SALLE CO.

SECTION	SEC.	COUNTY	AREA	DATE
70A	11	La Salle	20	12
STA.	699+00	TO STA.	700+00	
FOR ROAD DIST. BY T. J. ALLEN FOR THE ENGINEER				

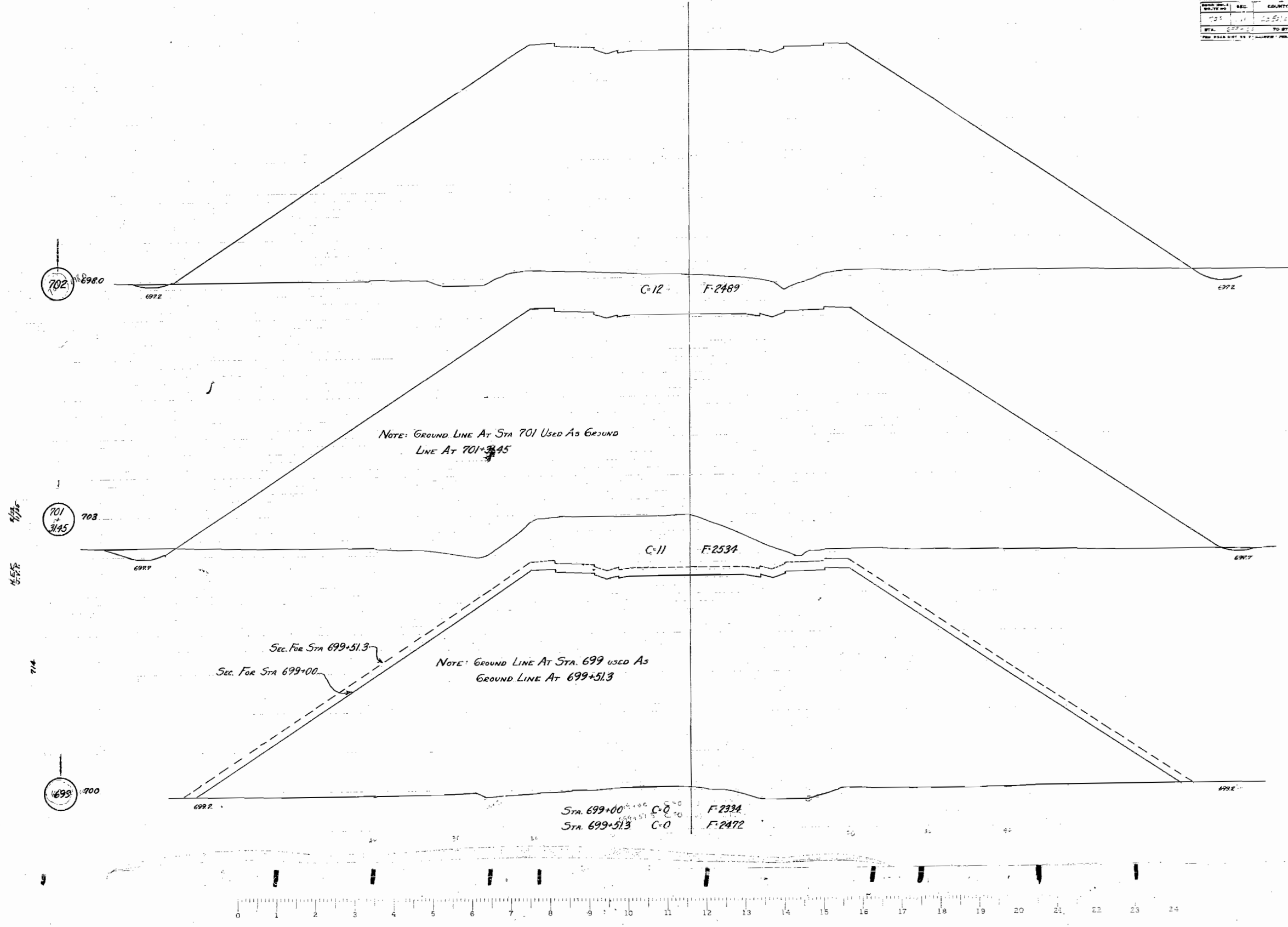

RT. 70A SEC. 11VX LASALLE CO.

DATE	BY	SCALE	NO.
11-15-58	BS	1"	1
BY A. J. ...	TO STA.

705 697

704 697

703 698
61

703 697

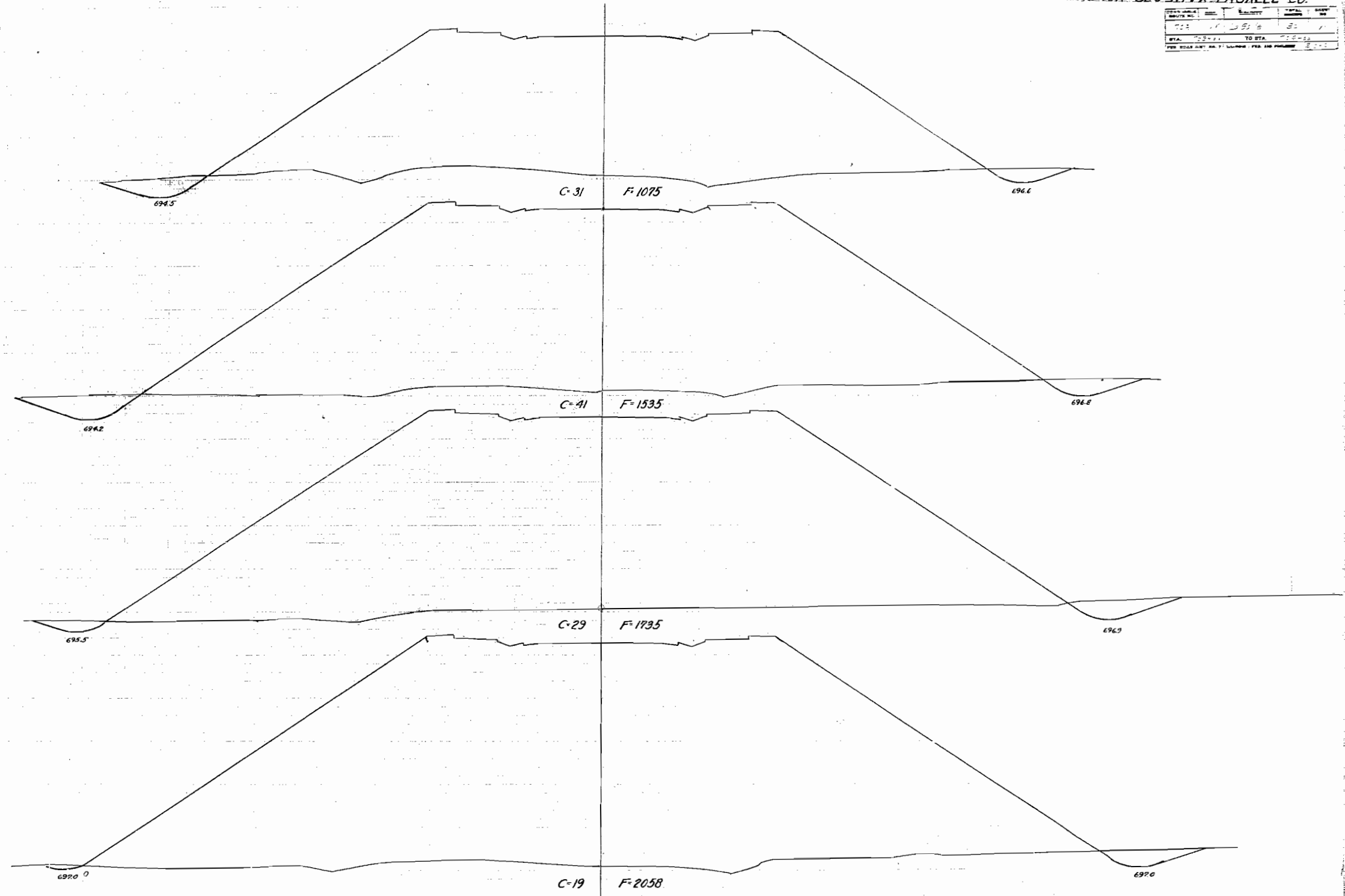

417.5
45.5

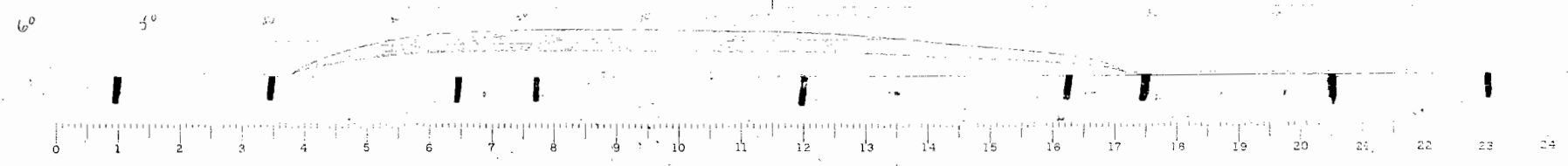

RT. 70A. SEC IIIVX LA SALLE CO.

DATE	BY	COUNTY	SHEET
11/21/57	J. H. ...	LA SALLE	24
FOR ROAD DIST. ENCL. TO ...			

PROPOSED IMPROVEMENT ENDS STA. 710+00

710 698

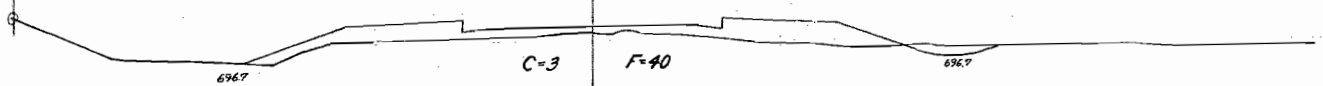

709 + 79 698

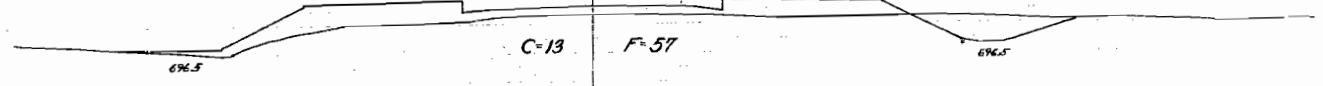

709 698

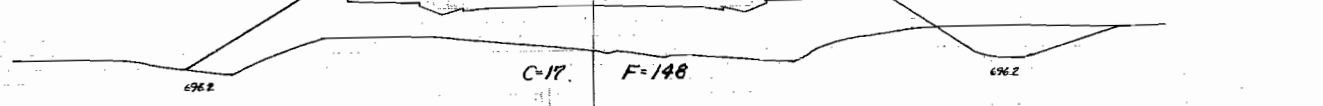

708 696

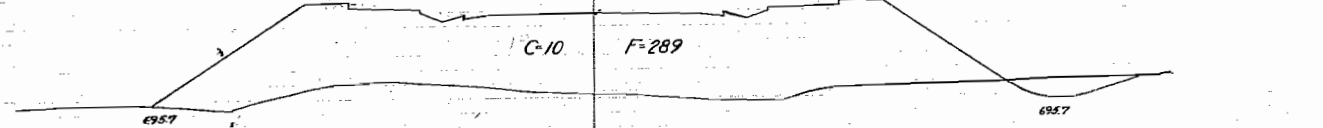

707 696

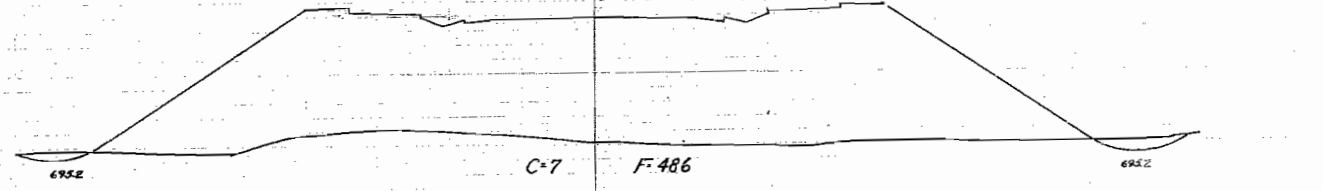

706 + 81 696

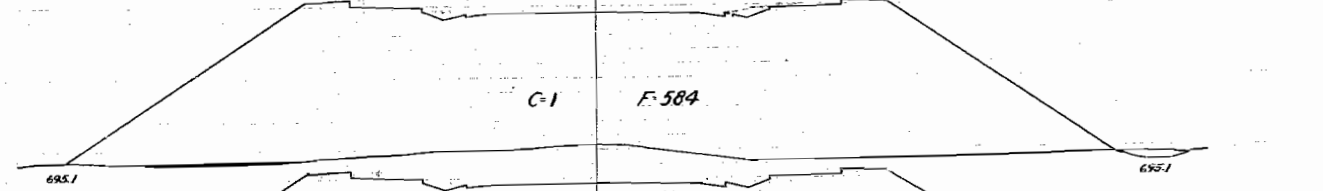

706 696

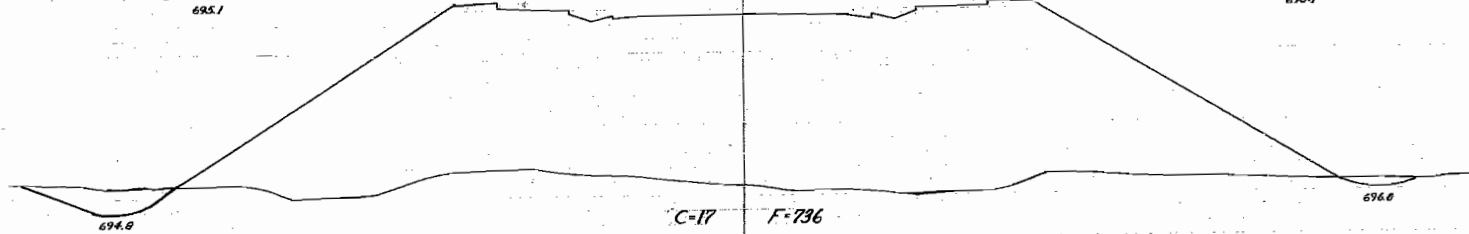

BORROW PIT

RT. 70A SEC. 11VX LA SALLE CO

HORIZONTAL 1" = 20'
SCALE: VERTICAL 1" = 5'

DATE	BY	CHECKED	DATE
12-5-58	J. S. J.		
BY LA SALLE DIST. ENGR. TO R.T.A.			
PER R.T.A. DIST. NO. 71 (L.S. DIST. ENGR. PLAN NO. 2-5-2)			

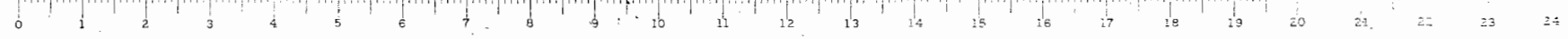
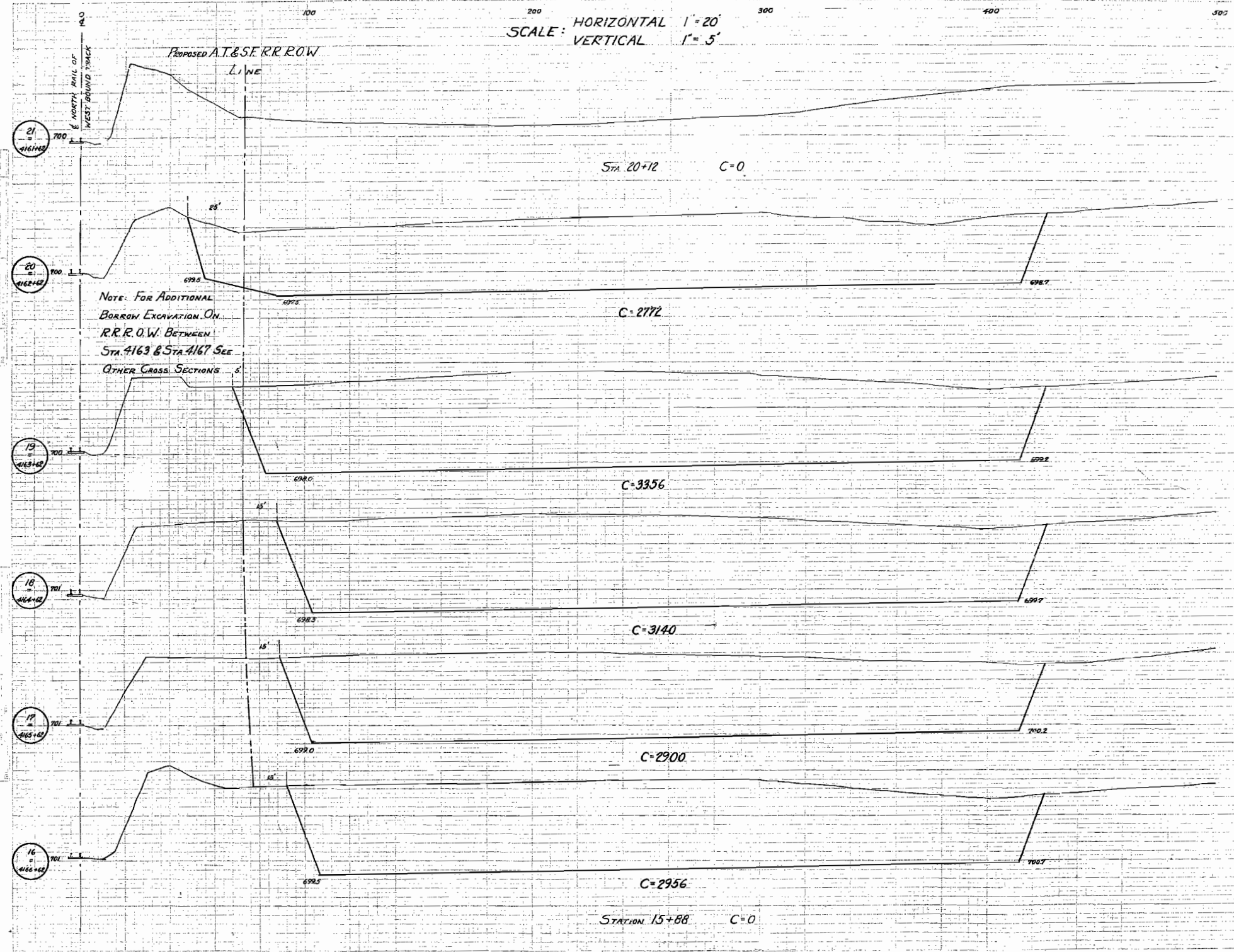

BORROW PIT RT 76A SEC 111VX LA SALLE CO

DATE	BY	COUNTY	SCALE
10/20/62	J. E. ...	La Salle	1" = 3'
STATION	TO STA.		
1163+62	1165+62	Borrow Pit	

SCALE 1"=3'
PROPOSED AT&S F.R.R. ROW
LINE

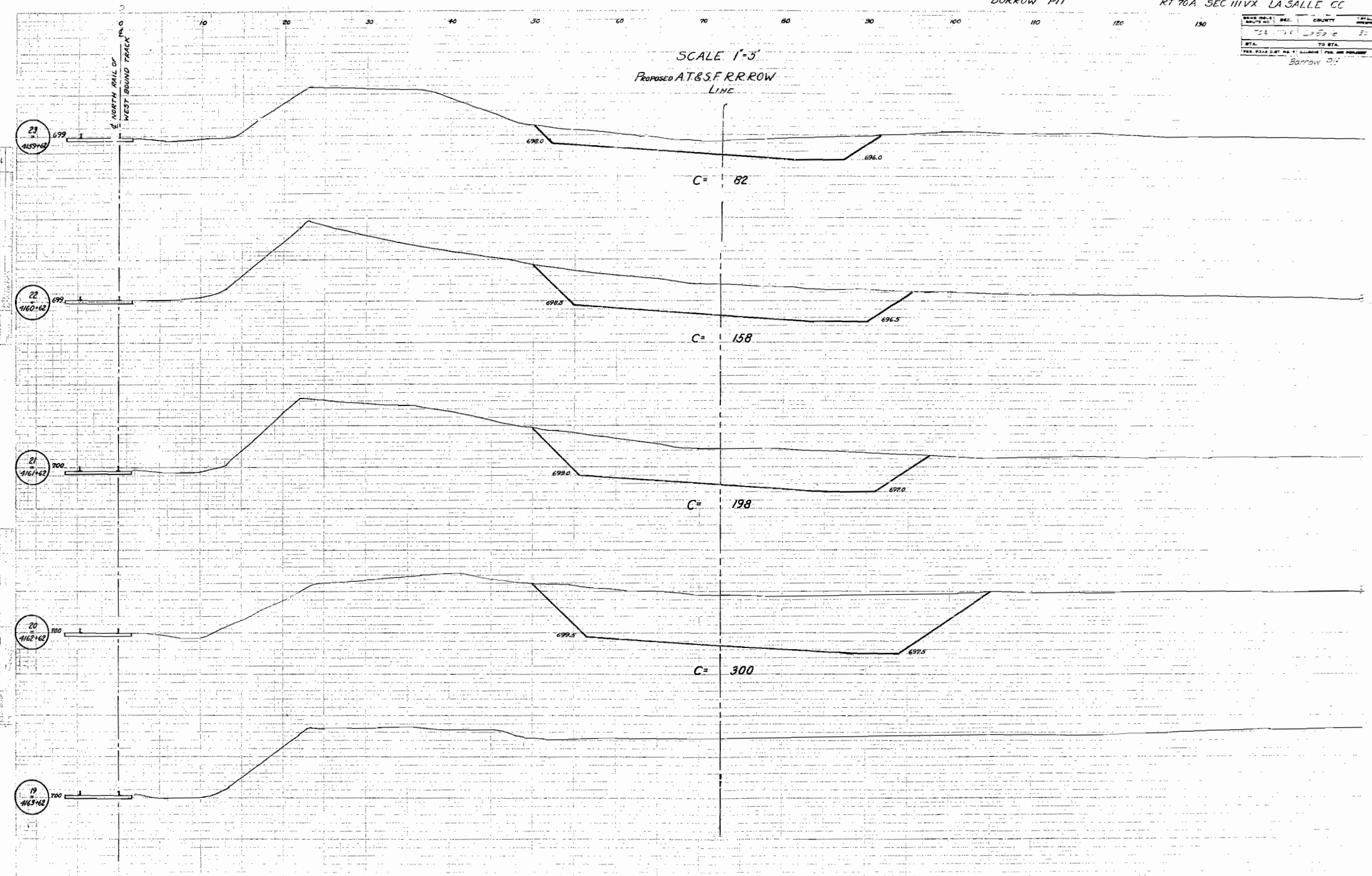

23
1163+62

22
1160+62

21
1161+62

20
1162+62

19
1163+62

C= 82

C= 158

C= 198

C= 300

Final
Survey
Mark
11/6/62

5/1/62
5/1/62



BORROW PIT

RT. 70A SEC III VX LA SALLE CO

DATE	BY	REVISION	BY
11/23/62	WJ	1	WJ
11/23/62	WJ	2	WJ

Borrow Pit

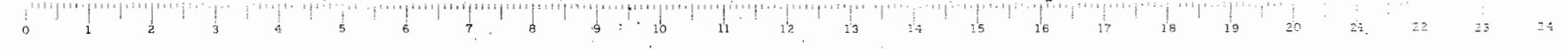
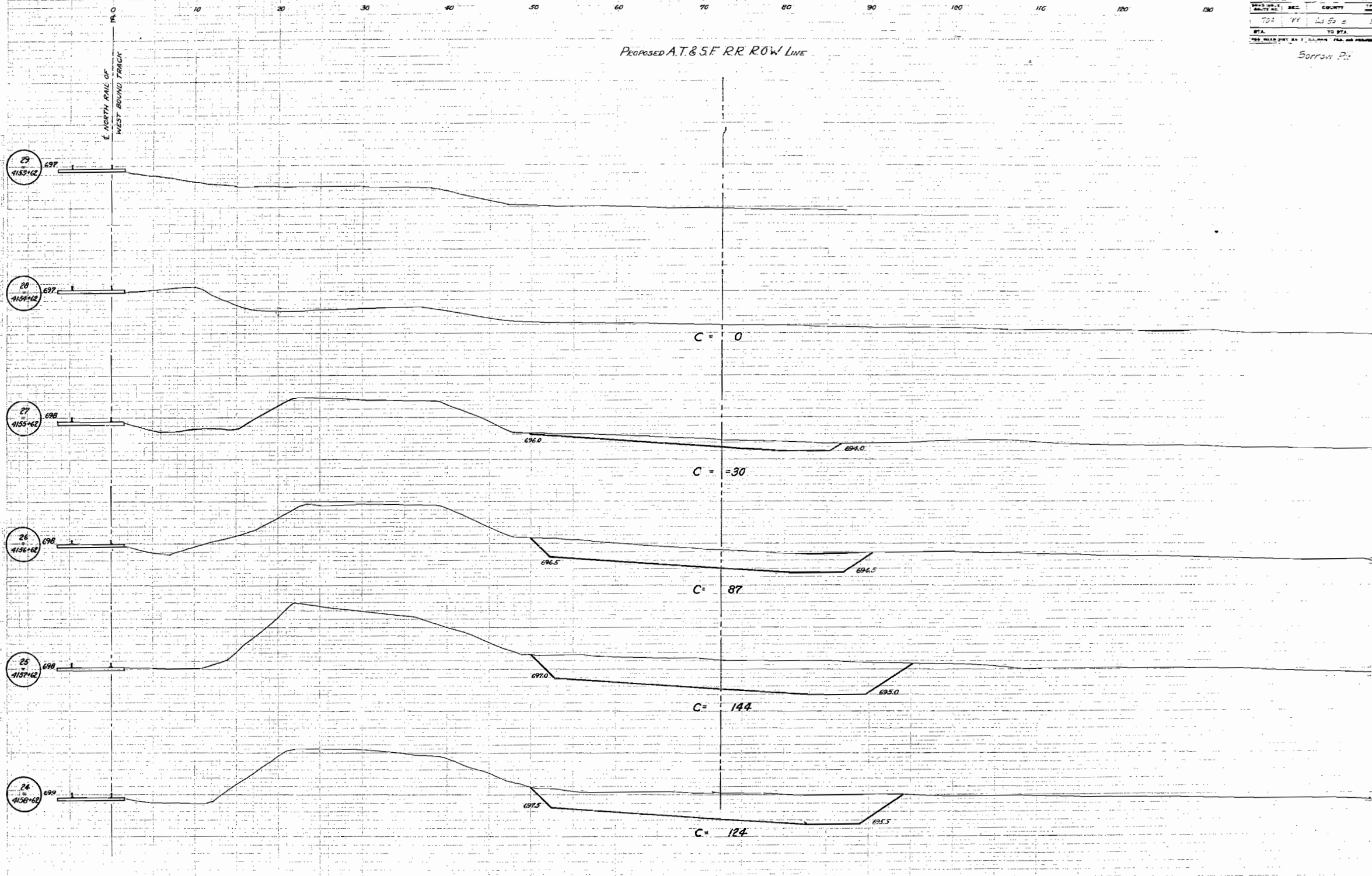

BORROW EXCAVATION AVAILABLE FROM A.T.&S.F. R.R. ROW RT 70A SEC 111VX LA SALLE CO.

NOTE: THESE CROSS SECTIONS PLOTTED TO A.T.&S.F. R.R. DATUM

PROJECT NO.	SEC.	COUNTY	TOTAL	REMARKS
711	VX	LA SALLE CO.	30	14
DATE: TO B.A.				
FOR ROAD DIST. NO. 7. L.L. PER. AN. PER. AN. PER. AN.				

5/1/24

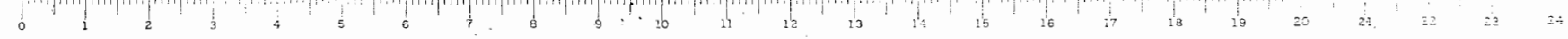
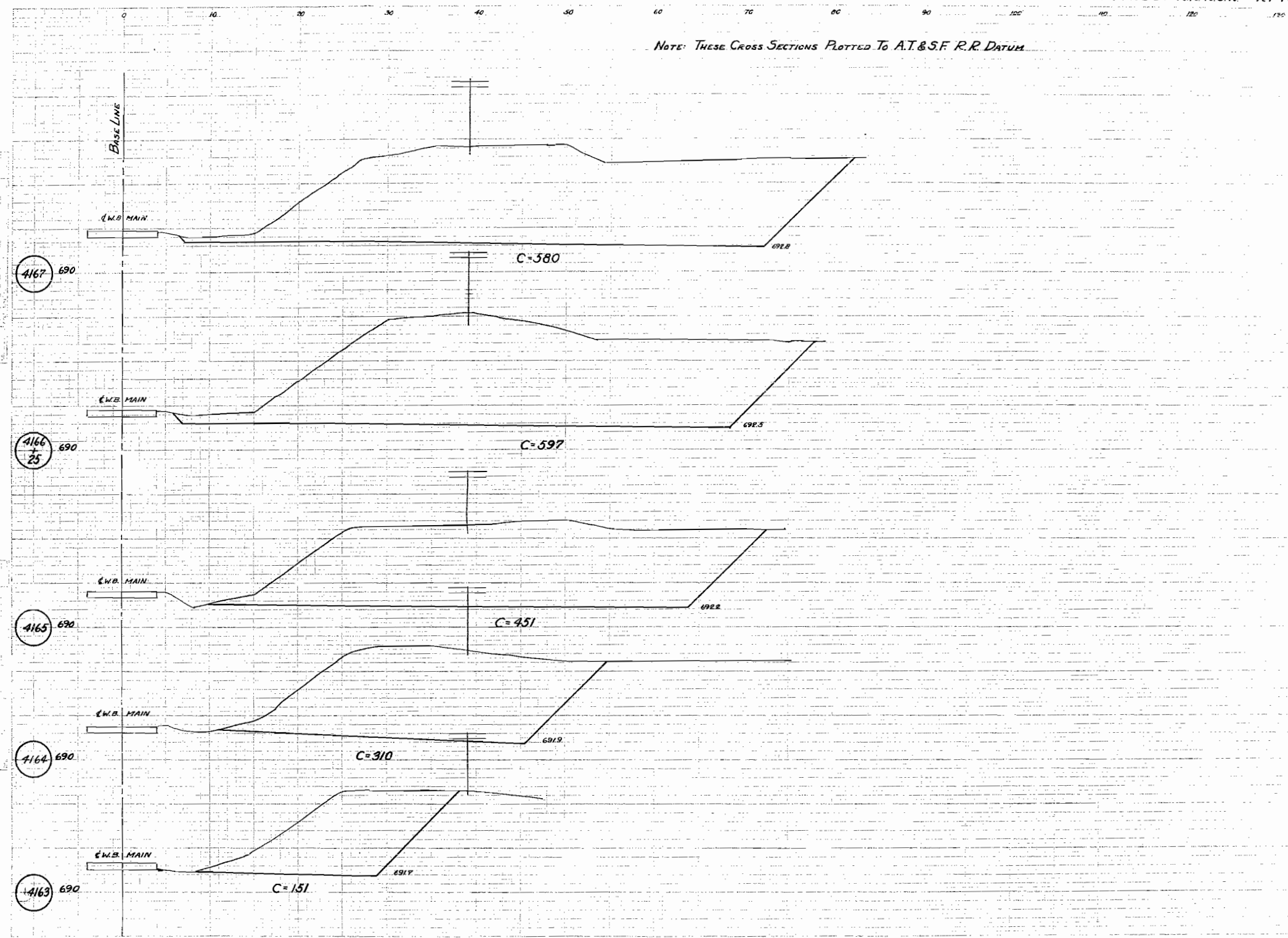

BORROW EXCAVATION AVAILABLE FROM A.T.&S.F. R.R. R.O.W. RT. 70A SEC 11VX LA SALLE CO

NOTE: THESE CROSS SECTIONS PLOTTED TO A.T.&S.F. R.R. DATUM.

DATE	BY	NO.	REVISION
12/1/54	W.S.	1	

THE ENGINEER HAS FILED THIS PLAN WITH THE BOARD OF SUPERVISORS OF LA SALLE COUNTY, ILLINOIS, FOR RECORD.

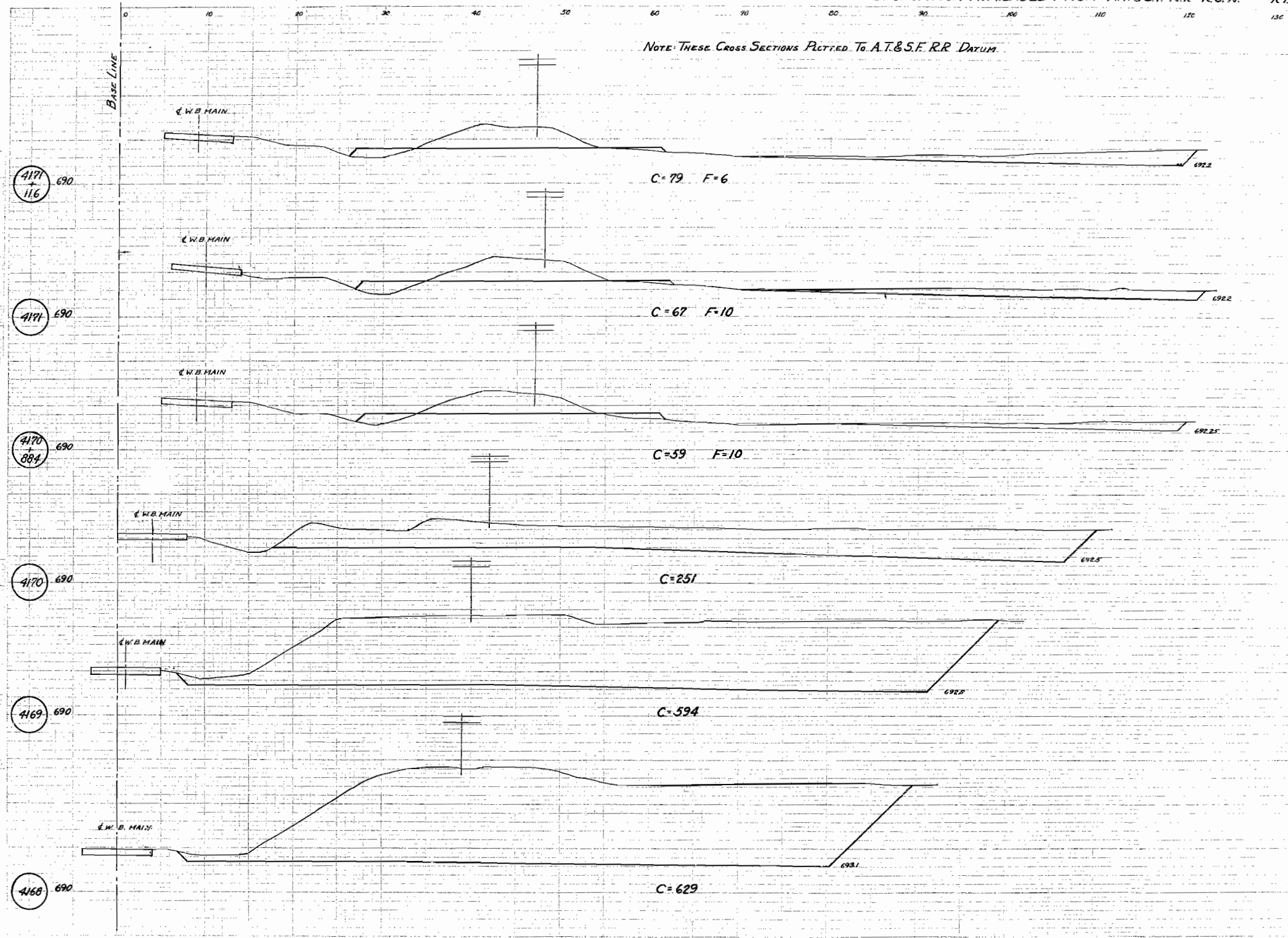

BORROW EXCAVATION AVAILABLE FROM A.T.&S.F. R.R. R.O.W. RT 70A SEC III VX LA SALLE CO.

DATE	BY	COUNTY	TOTAL	PER
7-14	LA SALLE	20	1	
STA.	TO STA.			
SEE ROAD DIST. ON ST. MAPS FOR LOCATION OF BORROW PITS				
Borrow				

NOTE: THESE CROSS SECTIONS PLOTTED TO A.T.&S.F. R.R. DATUM

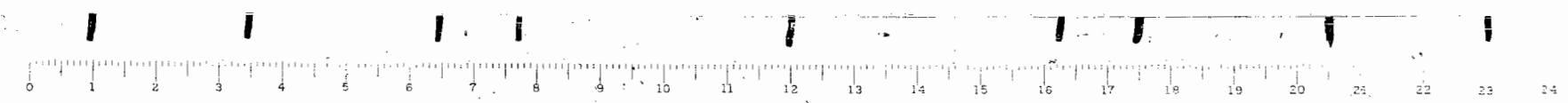
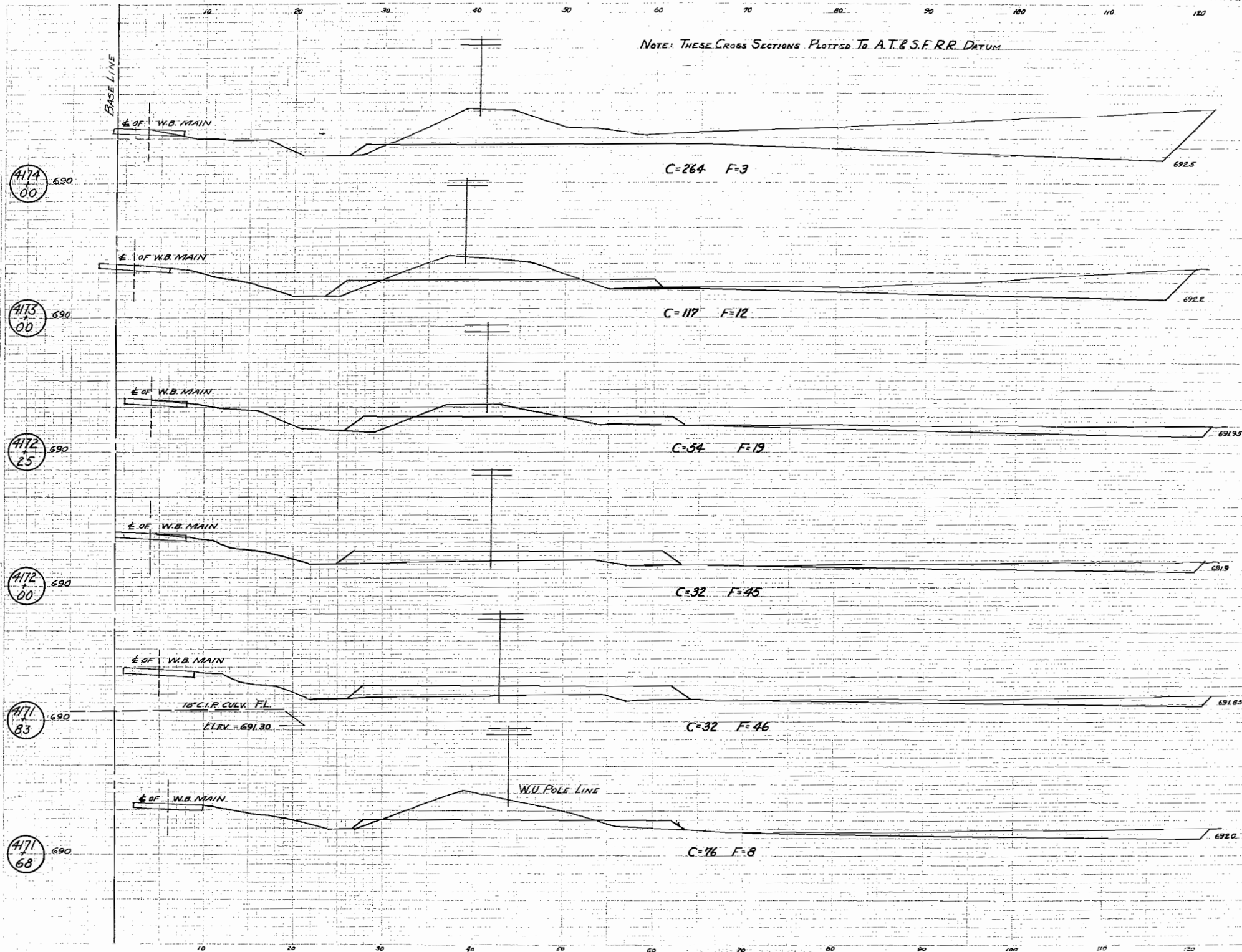

BORROW EXCAVATION AVAILABLE FROM A.T.S.F. R.R. R.O.W. RT 70A SEC. 11VX LA SALLE CO.

NOTE: THESE CROSS SECTIONS PLOTTED TO A.T. & S.F. R.R. DATUM.

SECTION	SEC.	COUNTY	TOTAL
LA SALLE	11VX	La Salle	50 20
STA.		TO STA.	
PER ROAD DIST. AS SHOWN		PER STA. NUMBER	2 1/2

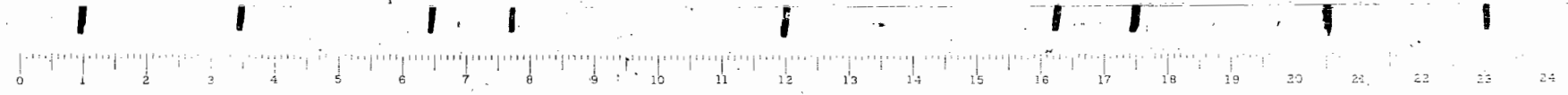
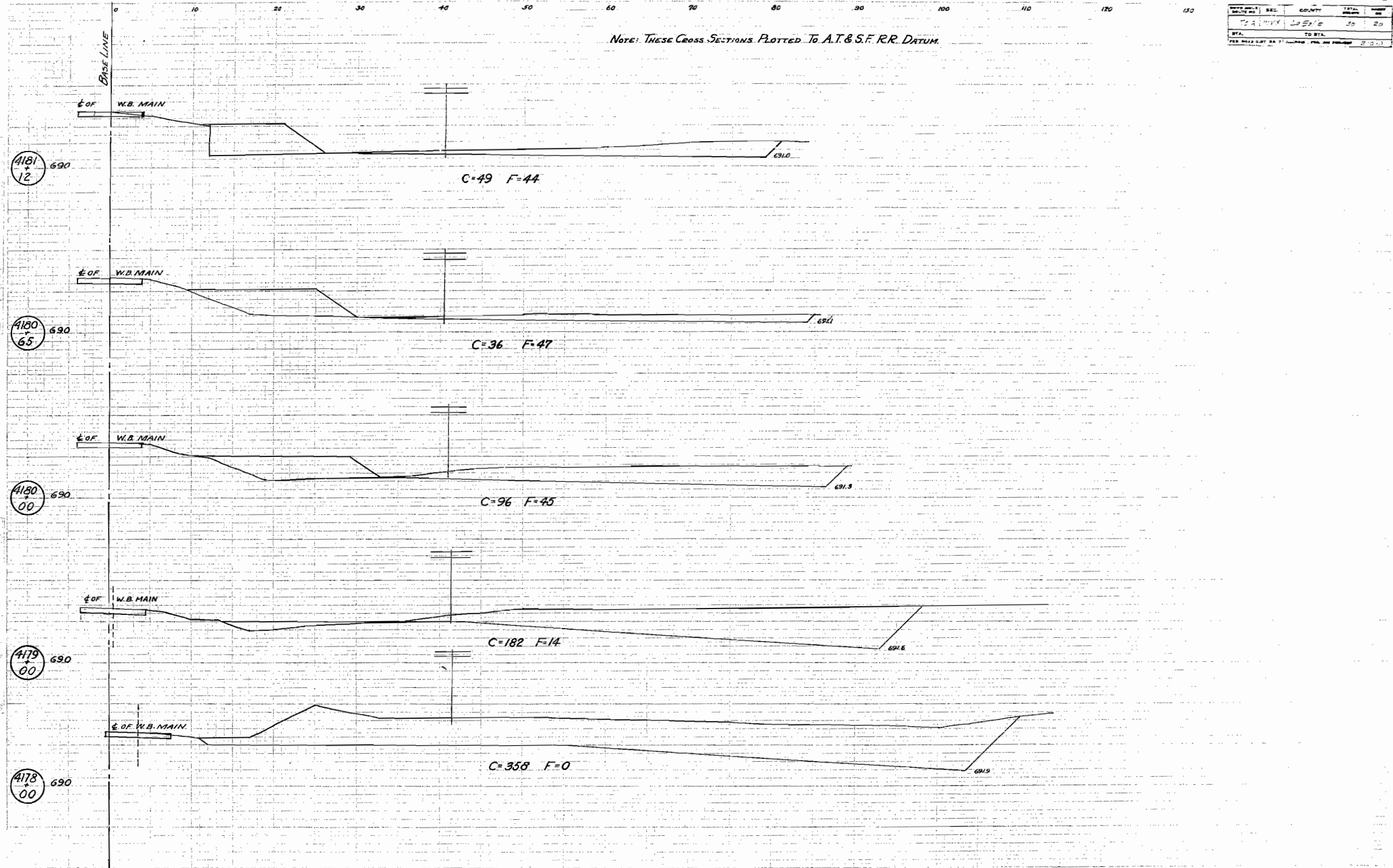

BORROW EXCAVATION AVAILABLE FROM AT&S.F.R.R. R.O.W.

RT 70A SEC III V X LA SALLE CO.

NOTE: THESE CROSS SECTIONS PLOTTED TO AT&S.F.R.R. DATUM.

PROJECT NO.	SEC.	COUNTY	DATE	BY
702	III V X	La Salle	50	21
BY:	TO STA.			
FOR ROAD DIST. TO T. CORNER FOR AD. PRISM 822				

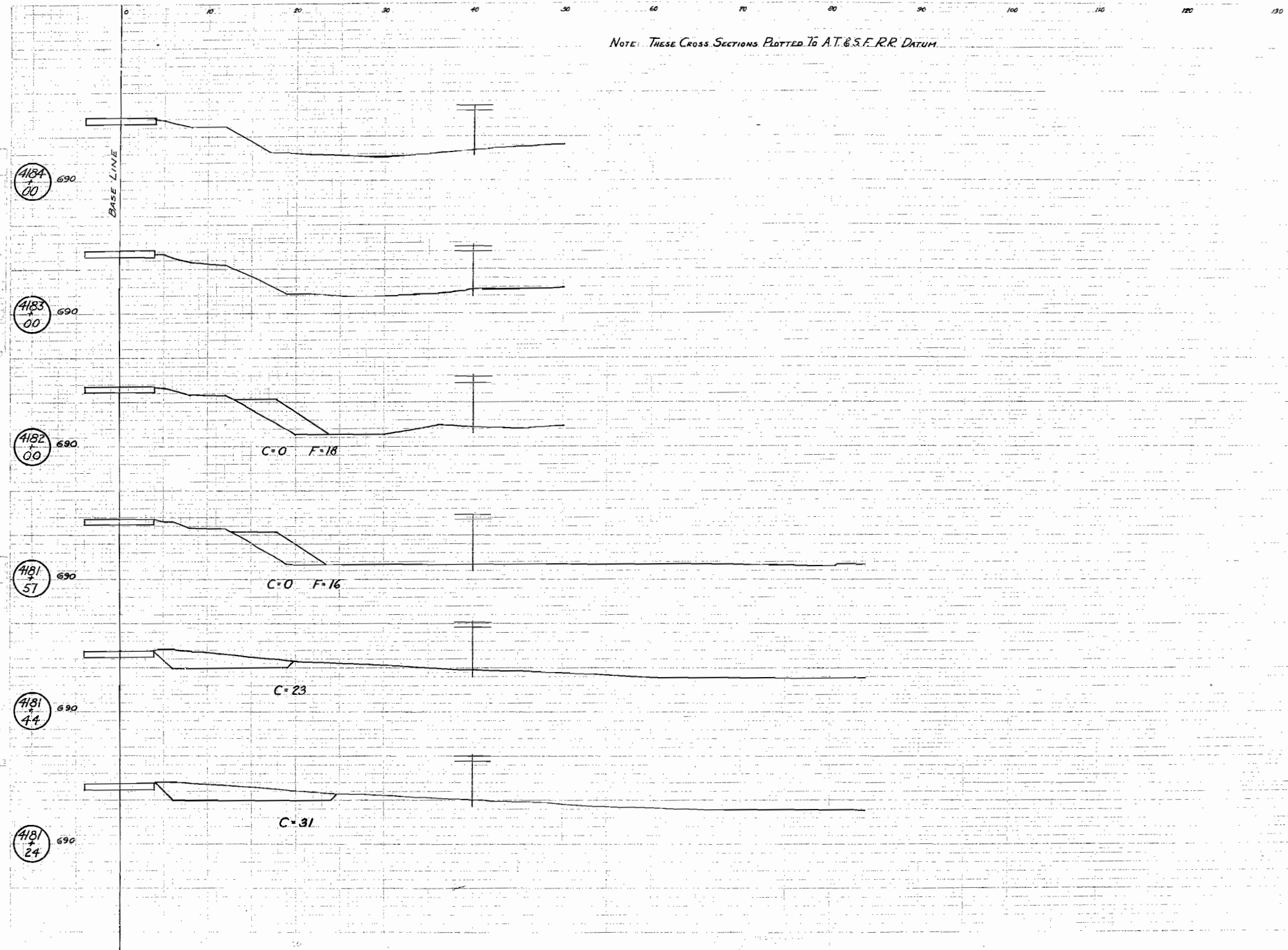

0 1 2 3 4 5 6 7 8 9 10 11 12 13 14 15 16 17 18 19 20 21 22 23 24

No Existing Structure
 B.M. #57 on R.R. C&N Rt. Sta 700+30
 Elev 702.17

STATE OF ILLINOIS
 DEPARTMENT OF PUBLIC WORKS & BUILDINGS
 DIVISION OF HIGHWAYS

PROJECT NO.	SEC.	COUNTY	TOTAL SHEETS	SHEET NO.
70-A	114	La Salle	80	24
SHEET NO. 1 OF 6 SHEETS				

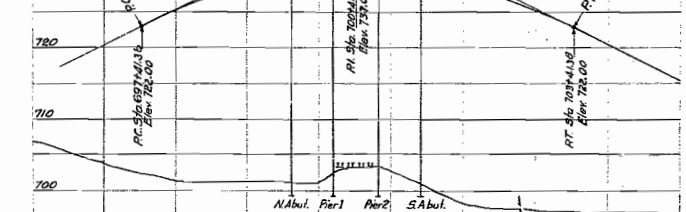
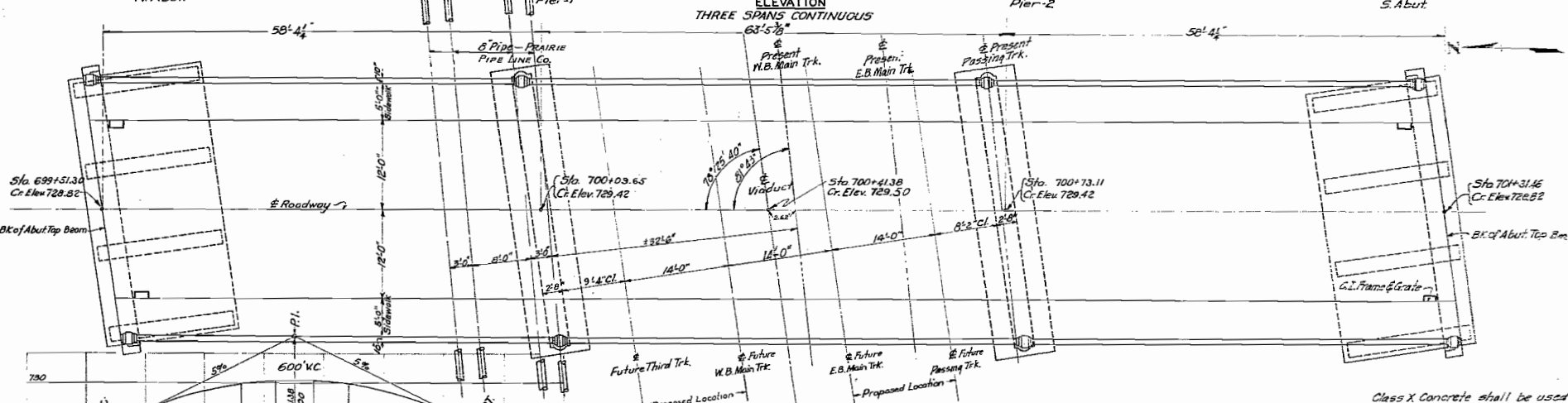
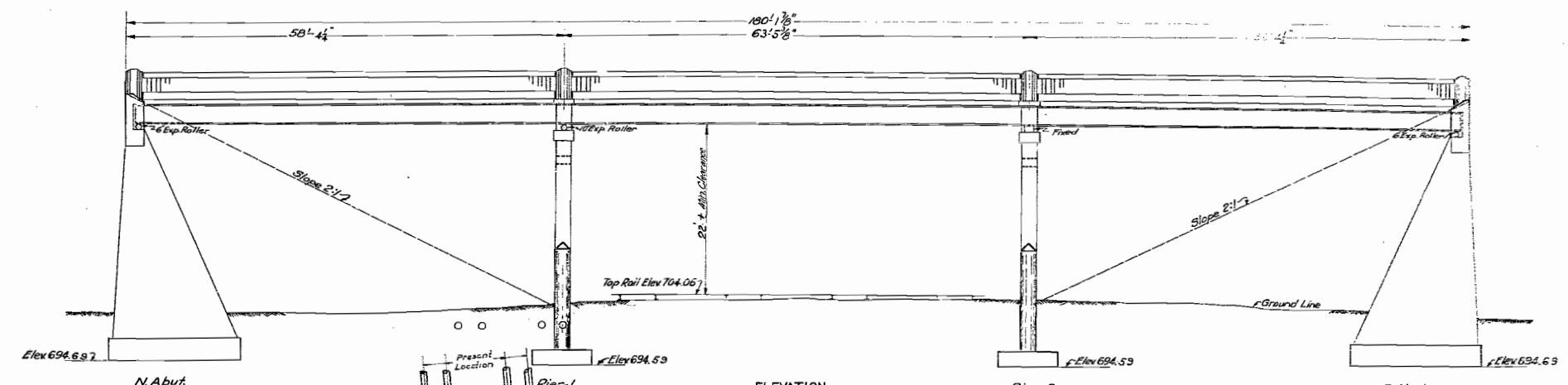

TOTAL BILL OF MATERIAL

ITEM	SUPERSTRUCTURE	PIERS	ABUTMENTS	SECTION - B	SECTION - C	TOTAL (SECS - C)
Handrail Concrete	Cu Yds	16.4			16.4	16.4
Class X Concrete	Cu Yds	184.5	165.1	299.9	457.0	192.5
Reinforcing Steel	Lbs.	42960	13330	17890	31220	22960
Structural Steel	Lbs.	162,010		1090		163,100
Cast Iron Frame & Grate	Each	4			4	4
8" Corrugated Metal Pipe	Lin Ft	300			300	300
Name Plate	Each	1			1	1
5" Hollow Wall Or Floor Tile	Sq Ft	1600			1600	1600
Wire Mesh	Sq Ft	2160			2160	2160

* 299.9 = 291.9 + 8.0 (Parapet Wall)

Class X Concrete shall be used throughout.
 Reinforcing Steel shall be wired securely in place before concrete is poured.

STANDARD COMPUTED *H. H. Hestruick*
 CHECKED *A. C. Brown*
 DRAWN *H. S. Stump, Vanvill*
 CHECKED *R. B. B.*
 SPECIAL ASSEMBLED
 CHECKED

EXAMINED *J. J. B...*
 PASSED *H. H. Hestruick*
 APPROVED *Carl...*

GENERAL ELEVATION
 A.T. & S.F. OVERHEAD AT RANSOM
 S.B.I. ROUTE TO A SEC. 11-Y-B-C
 LA SALLE COUNTY
 STATION 700+51.08

Rev. 10-9-1935 - 164
 Ck4

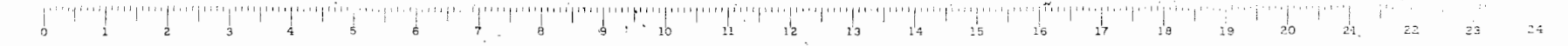

STATE OF ILLINOIS
DEPARTMENT OF PUBLIC WORKS & BUILDINGS
DIVISION OF HIGHWAYS

PROJECT NO.	SEC.	COUNTY	TOTAL SHEETS	SHEET NO.
70-A	11-V-C	La Salle	30	26
SHEETS				

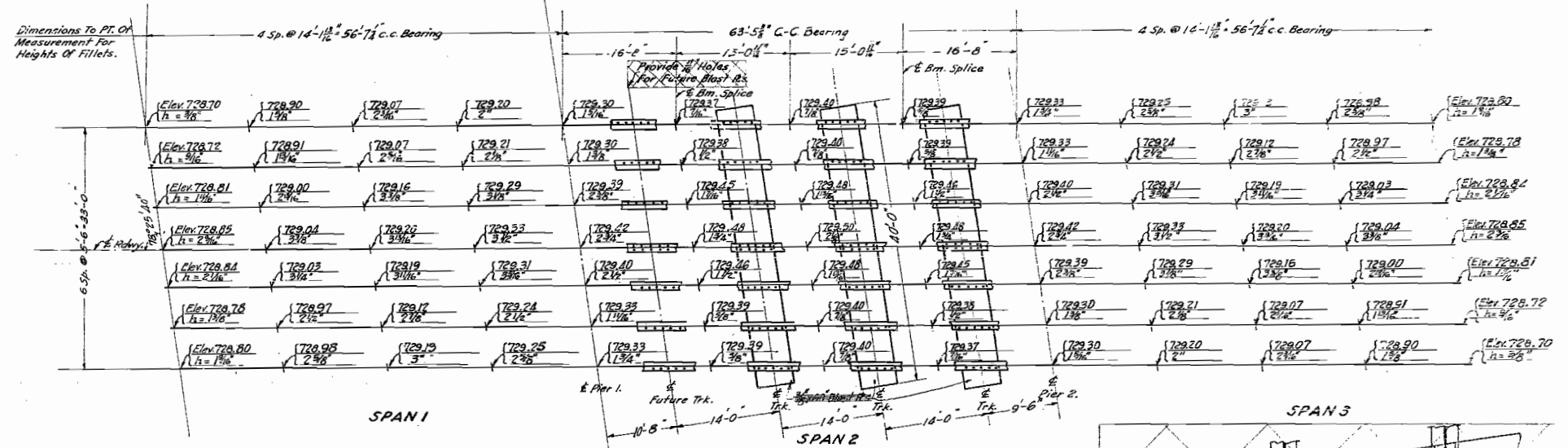

PLAN
Showing Elevation of Top of Floor Slab, Heights of Fillets and Location of Blast Plates. Height of Fillet Dimension Includes Amount for Deflection Due to Dead Load; Crown of Roadway and Vertical Curve.
Elev. Elevation at top of 1" top slab after deflection has taken place.
h = height of concrete fillet between top flange of beam and the under side of floor slab. Where plate are encountered on the top flange "h" should be reduced by the amount equal to thickness of plates.

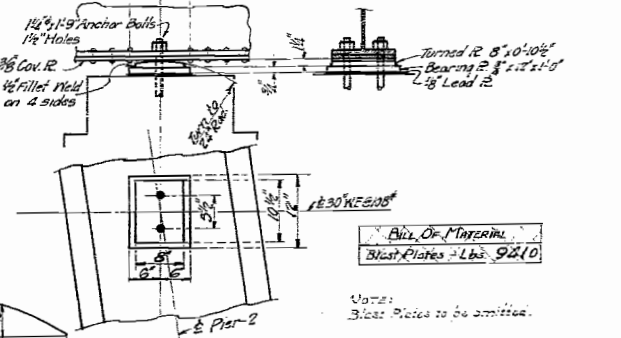
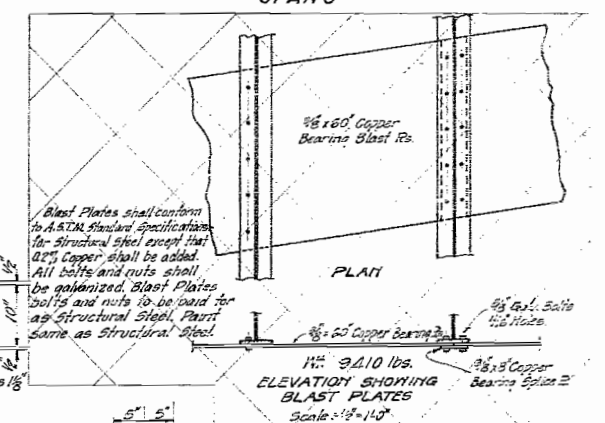
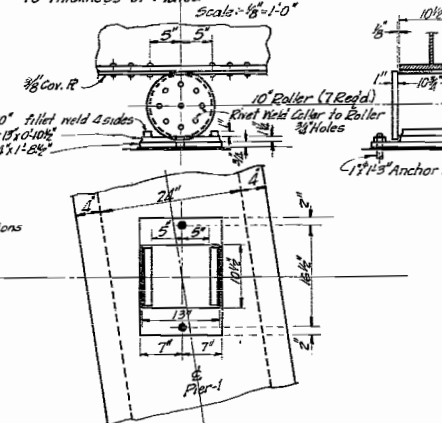
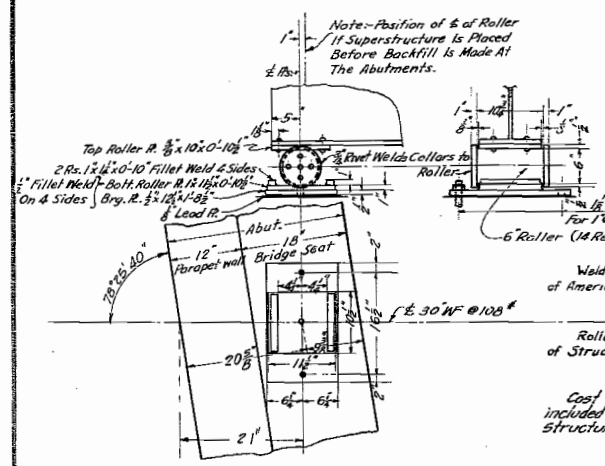

COMPILED	<i>H. Strick</i>	EXAMINED	7-16-35
CHECKED	<i>R. E. Brown</i>	DRAWN	<i>F. R. M.</i>
CHECKED	<i>R. E. B.</i>	PASSES	<i>H. Strick</i>
SPECIAL	ASSEMBLED	APPROVED	<i>H. Strick</i>
	CHECKED		

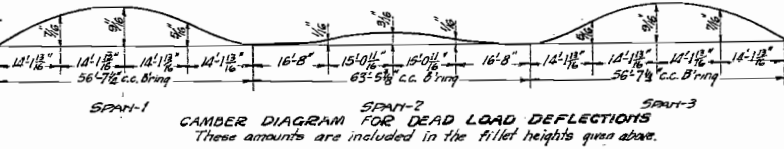

BILL OF MATERIAL
Blast Plates - Lbs. 9210

Notes:
Blast Plates to be omitted.
DETAILS
A.T. & S.F. OVERHEAD AT RANSOM
S.B. ROUTE-70A SEC. 11-V-C
LA SALLE COUNTY
STATION-700+51.08

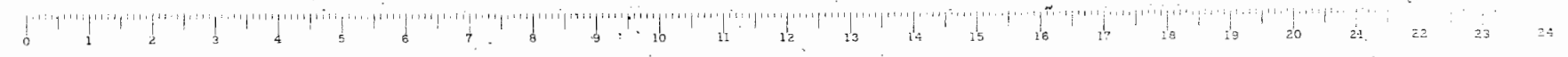

STATE OF ILLINOIS
DEPARTMENT OF PUBLIC WORKS & BUILDINGS
DIVISION OF HIGHWAYS

SECTION	COUNTY	TOTAL SHEETS	SHEET NO.	SHEET NO. OF SHEETS
70-A	La Salle	25	2	6 SHEETS

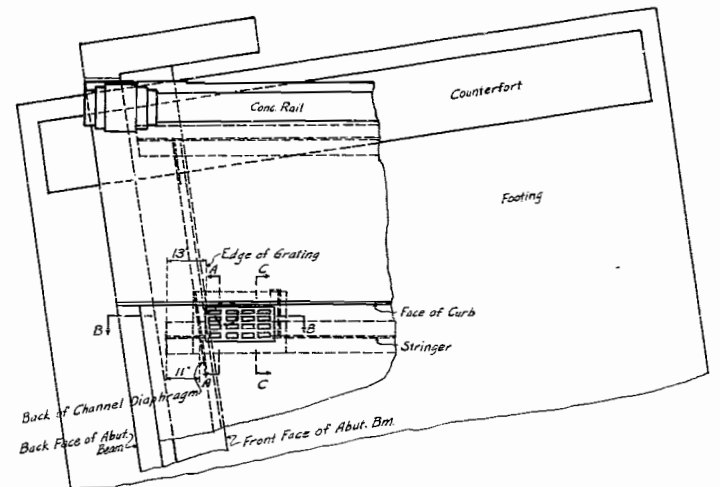

PLAN SHOWING INLET AT N.E. & S.W. CORNER OF BRIDGE

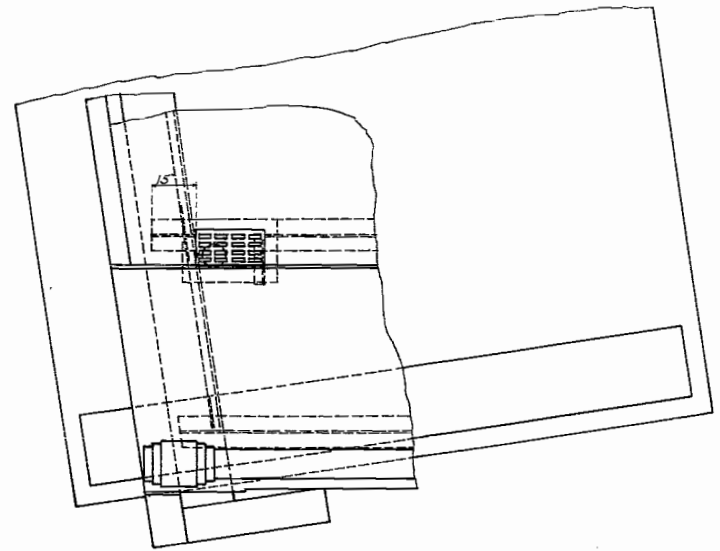

PLAN SHOWING INLET AT N.W. & S.E. CORNER OF BRIDGE

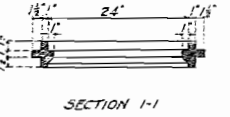
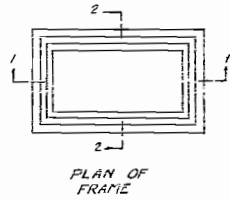
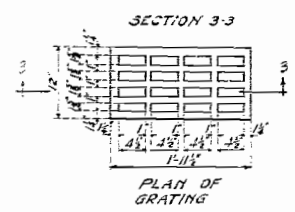
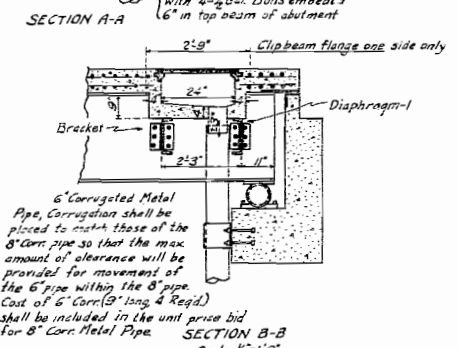
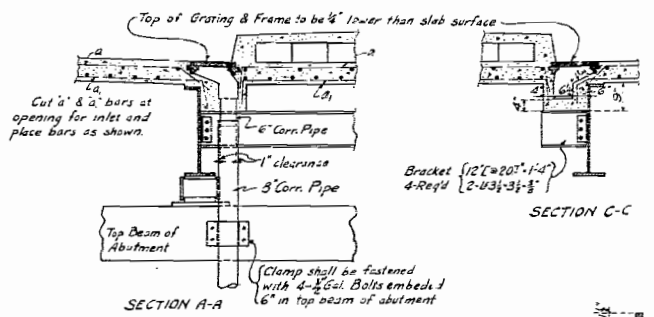

DETAILS OF C.I. FRAME AND GRATINGS FOR DRAINAGE INLET
2-Frames & 4-Grating Reg'd
Scale 1"=1'-0"

MATERIAL FOR DRAINAGE

Cast Iron Frames	No. Req'd	4
Cast Iron Gratings	No. Req'd	4
8" Corr. Metal Pipe	Lin. Ft.	300

All corrugated metal pipe shall be 16 gage and conform with specifications covering Corrugated Metal Culvert Pipe.

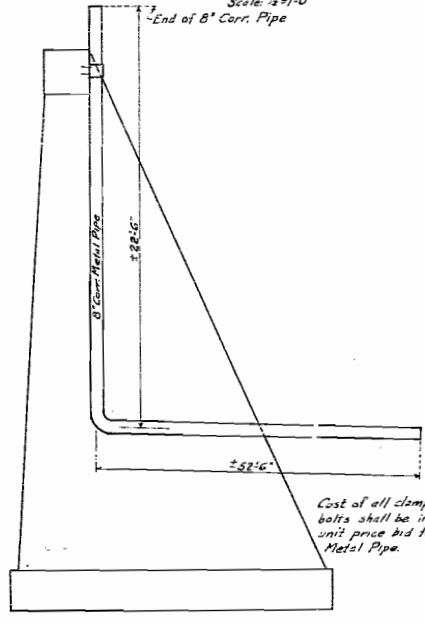

LAYOUT SHOWING DRAIN PIPE
Scale 1/2"=1'-0"

COMPUTED	<i>H. L. Beck</i>	EXAMINED	7-16-35
CHECKED	<i>R. C. Brown</i>	<i>H. J. Smith</i>	BRIDGE ENGINEER
DRAWN	<i>H. L. Beck</i>	PASSED	<i>H. J. Smith</i>
CHECKED	<i>R. C. B.</i>	APPROVED	<i>Earl Seligson</i>
SPECIAL ASSEMBLED			
CHECKED			

DETAILS
AT & S.F. OVERHEAD AT RANSOM
S.B.I. ROUTE - 70A SEC. 11-V-C
LA SALLE COUNTY
STATION - 700-5108

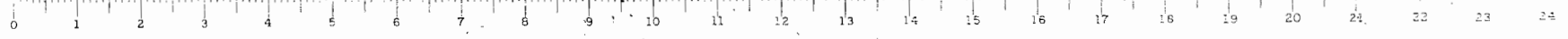

B. M. #57 on R.R. Culv. Rt. Sta. 700+30
Elev. 702.17

STATE OF ILLINOIS
DEPARTMENT OF PUBLIC WORKS & BUILDINGS
DIVISION OF HIGHWAYS

SECTION	SEC	COUNTY	TOTAL SHEETS	SHEET NO.	SHEET NO.
70-A	VI-VII	La Salle	35	28	6 SHEETS

Contractor for Section C shall pour concrete in parapet wall between these lines down to Elev. 724.24
2" superstructure structural steel is all in place. A good bearing must be secured between the expansion plate which is bolted to beams and the 12"x24" in the parapet wall.

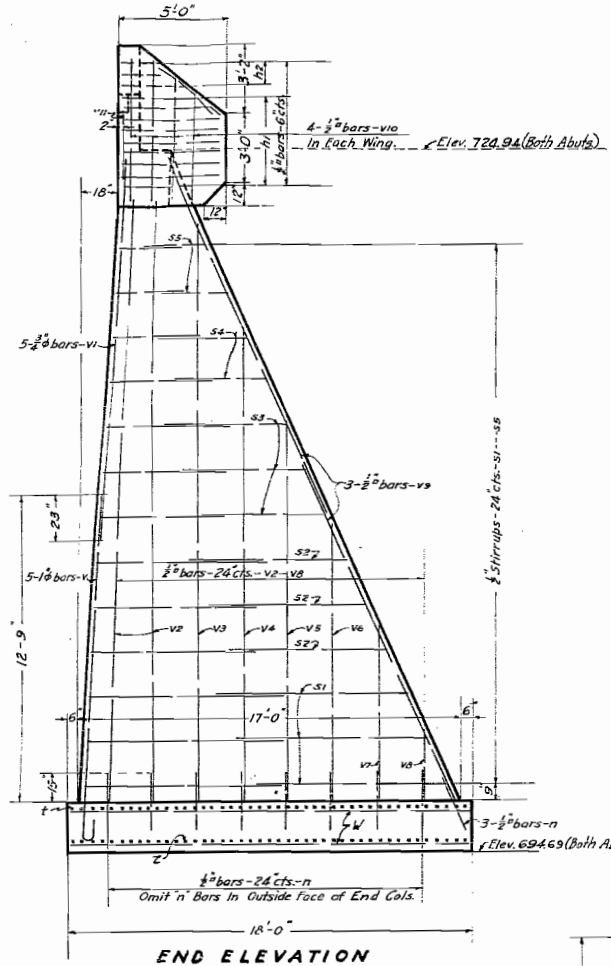

END ELEVATION

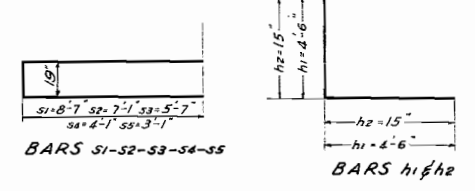

COMPUTED	<i>H. C. Lauch</i>	EXAMINED	<i>[Signature]</i>
CHECKED	<i>[Signature]</i>	PASSED	<i>[Signature]</i>
DRAWN	<i>[Signature]</i>	APPROVED	<i>[Signature]</i>
CHECKED	<i>[Signature]</i>		
SPECIAL ASSEMBLED			
CHECKED			

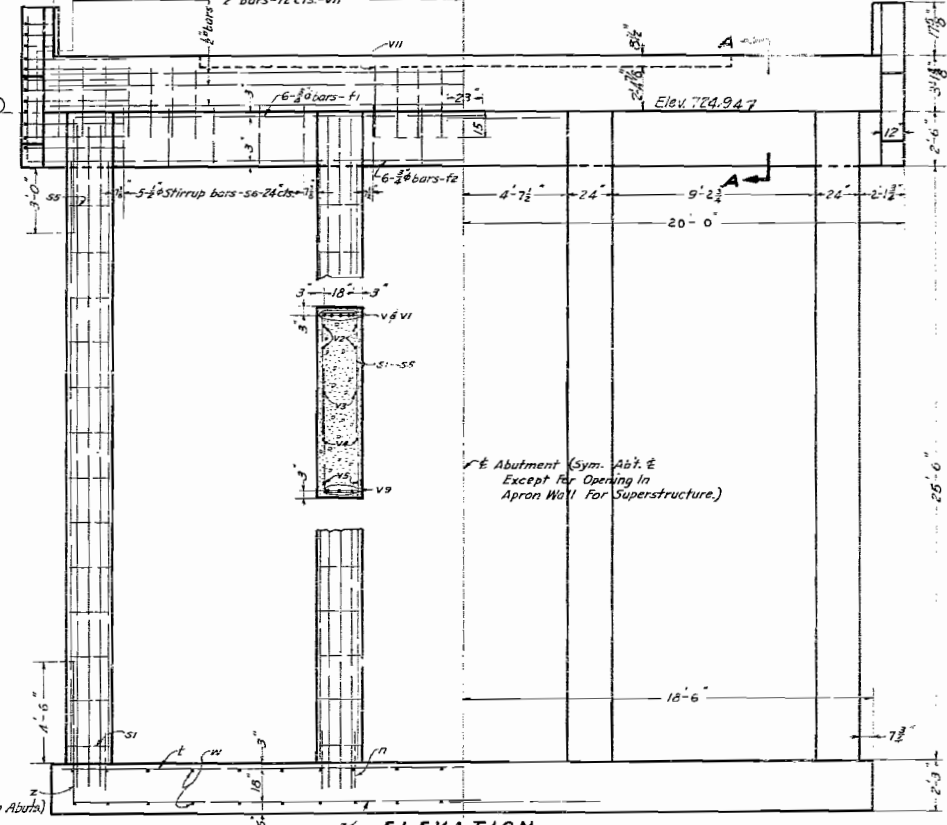

ELEVATION

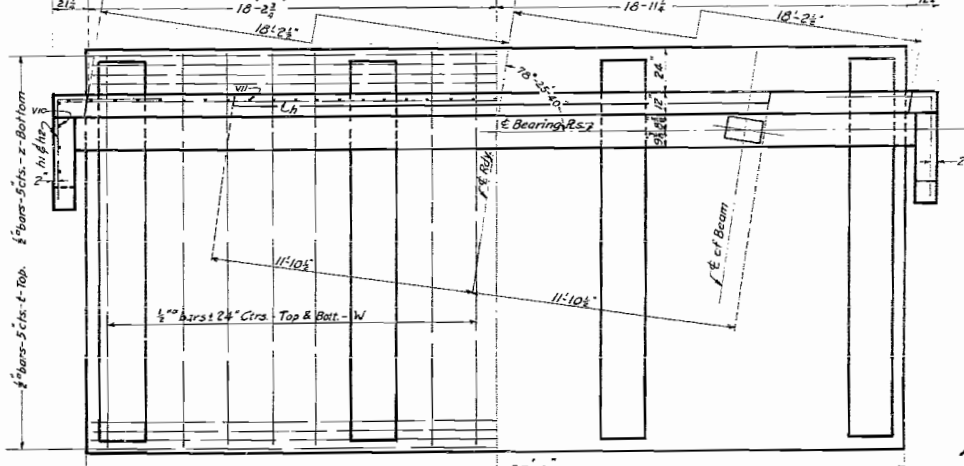

PLAN
Scale: 1/8"=1'-0"

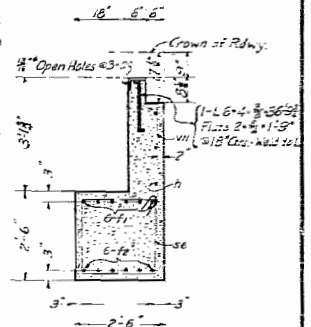

SECTION A-A
Scale: 1/8"=1'-0"

BILL OF MATERIAL-TWO ABUTS.

Bar No.	Size	Length
172	2"	26'-6"
66	2"	36'-0"
80	2"	17'-6"
40	1 1/2"	15'-9"
40	2"	17'-0"
32	2"	26'-0"
16	2"	25'-0"
16	2"	20'-9"
16	2"	16'-6"
16	2"	12'-0"
16	2"	6'-0"
16	2"	3'-6"
28	2"	17'-0"
16	2"	6'-0"
78	2"	3'-6"
120	2"	2'-6"
28	2"	18'-9"
28	2"	15'-9"
48	2"	12'-9"
32	2"	9'-9"
32	2"	7'-9"
30	2"	9'-9"
24	2"	23'-8"
12	2"	38'-6"
12	2"	19'-0"
36	2"	9'-0"
12	2"	2'-6"

Class X Concrete - Cu. Yds. 291.4
Reinf. Steel - Lbs. 17830
Struct. Steel - Lbs. 1020
Class X Conc. (Parapet Wall) - Cu. Yds. 8.0

ABUTMENTS
A.T. E.S.R. OVERHEAD AT RANSOM
S.B.I. ROUTE-70A SEC. III-V B
LA SALLE COUNTY
STATION-700+51.08

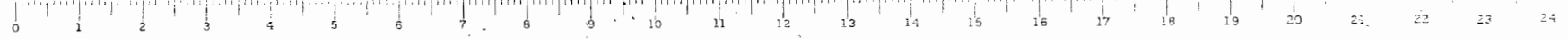

B.M. # 37 on R.R. Culv. Pt. Sta. 700+30
Elev. 702.17

STATE OF ILLINOIS
DEPARTMENT OF PUBLIC WORKS & BUILDINGS
DIVISION OF HIGHWAYS

WORKS ORDER NO.	SEC.	COUNTY	DATE	SHEET NO.	SHEET NO. OF SHEETS
70-A	11-Y-3	La Salle	30	27	6 SHEETS
REC. ROAD DIST. NO. 7 EMBROS FEB. 4, 1937 PROJECT NO. 120127A					

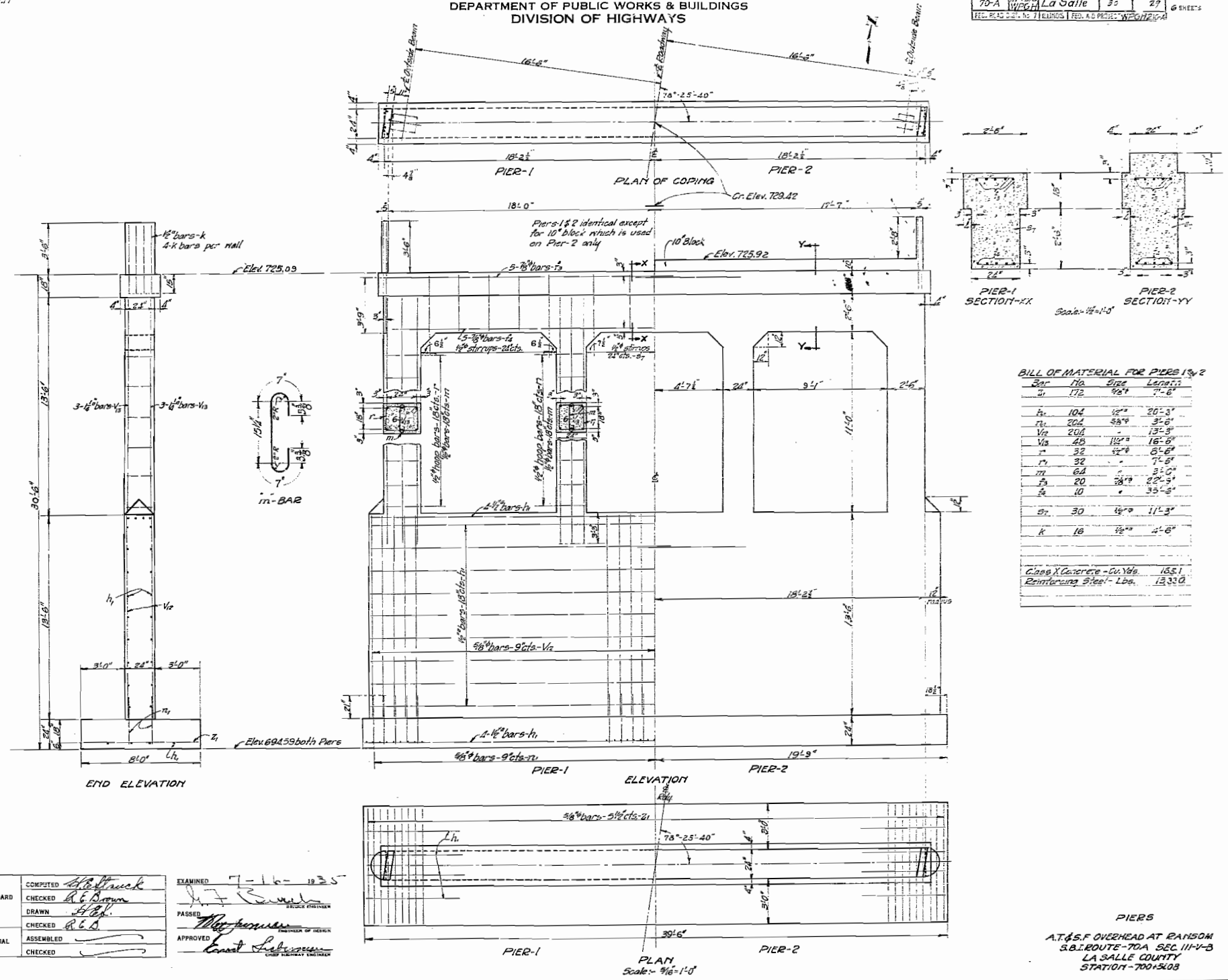

BILL OF MATERIAL FOR PIERS 1 & 2

Bar	No.	Size	Length
a	172	3/8"	7'-6"
b	104	1/2"	20'-3"
c	204	3/8"	3'-0"
d	204	3/8"	13'-5"
e	48	1/2"	16'-0"
f	32	3/4"	6'-6"
g	32	3/4"	7'-6"
h	64	3/4"	3'-0"
i	20	3/8"	22'-3"
j	10	3/8"	35'-2"
k	30	1/2"	11'-3"
l	16	1/2"	4'-6"

Concrete - Cu. Yds. 165.1
Reinforcing Steel - Lbs. 13,320

STANDARD	COMPUTED	<i>H. B. Beck</i>	EXAMINED	<i>J. L. K...</i>
	CHECKED	<i>R. E. Brown</i>	PASSED	<i>W. J. ...</i>
	DRAWN	<i>R. E. B.</i>	APPROVED	<i>Ernest ...</i>
SPECIAL	ASSEMBLED	<i>R. E. B.</i>		
	CHECKED	<i>R. E. B.</i>		

