

F.A.J. RTE.	SECTION	COUNTY	TOTAL SHEETS	SHEET NO.
1583	0505 RS-5	COOK	29	6
STA. 5+00	TO STA. 26+04			
FED. ROAD DIST. NO. 1	ILLINOIS	FED. AID PROJECT		

CONTRACT NO. 60B90

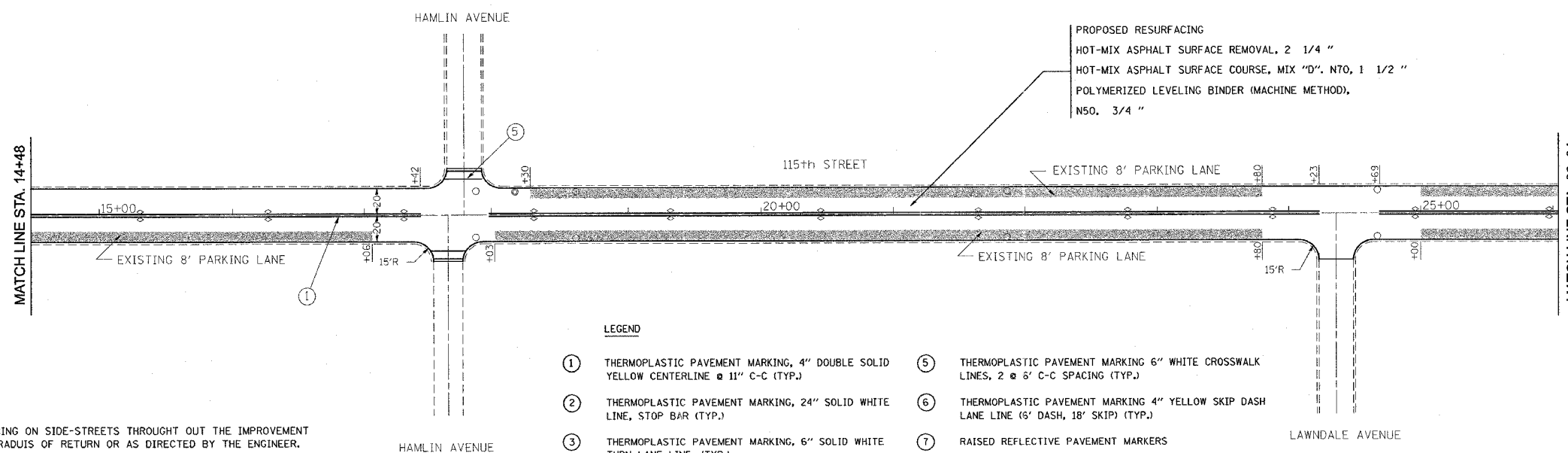
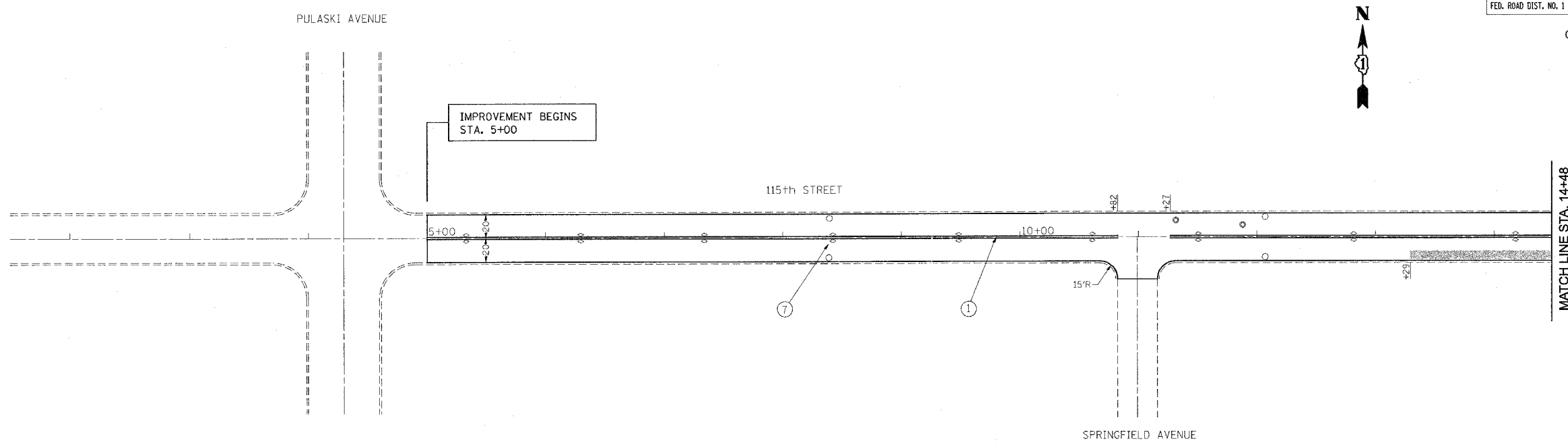

**LEGEND**

- |  |   |
|--|---|
| ① THERMOPLASTIC PAVEMENT MARKING, 4" DOUBLE SOLID YELLOW CENTERLINE @ 11" C-C (TYP.)   | ⑤ THERMOPLASTIC PAVEMENT MARKING 6" WHITE CROSSWALK LINES, 2 @ 6' C-C SPACING (TYP.)      |
| ② THERMOPLASTIC PAVEMENT MARKING, 24" SOLID WHITE LINE, STOP BAR (TYP.)                | ⑥ THERMOPLASTIC PAVEMENT MARKING 4" YELLOW SKIP DASH LANE LINE (6' DASH, 18' SKIP) (TYP.) |
| ③ THERMOPLASTIC PAVEMENT MARKING, 6" SOLID WHITE TURN LANE LINE, (TYP.)                | ⑦ RAISED REFLECTIVE PAVEMENT MARKERS  |
| ④ THERMOPLASTIC PAVEMENT MARKING 6" WHITE SKIP DASH LINES (2' DASH, 6' SPACING) (TYP.) |   |

**NOTES:** LIMIT OF RESURFACING ON SIDE-STREETS THROUGHOUT THE IMPROVEMENT SHALL BE TO THE RADII OF RETURN OR AS DIRECTED BY THE ENGINEER.

ALL FINAL PAVEMENT MARKINGS SHALL BE THERMOPLASTIC (OF THE EXTRUDED TYPE) AND SHOULD BE PLACED IN ACCORDANCE WITH "DISTRICT ONE TYPICAL PAVEMENT MARKING DETAILS." (TC-11), AND CITY OF CHICAGO TYPICAL PAVEMENT MARKINGS, (TC-24).

ALL RAISED REFLECTIVE PAVEMENT MARKERS SHALL BE IN ACCORDANCE WITH THE DISTRICT ONE "TYPICAL APPLICATIONS RAISED REFLECTIVE PAVEMENT MARKER DETAIL." (TC-11).

REVISIONS	
NAME	DATE

ILLINOIS DEPARTMENT OF TRANSPORTATION  
**115th STREET**  
 PULASKI RD. TO WESTERN AVE.  
 ROADWAY & PAVEMENT  
 MARKING PLAN

SCALE: VERT. 1" = 50'  
 HORIZ. DATE 11/6/2006

DRAWN BY: HMO  
 CHECKED BY: