

| | | | | |
|-----------------------|---------------|------------------|--------------|-----------|
| F.A.U. RTE. | SECTION | COUNTY | TOTAL SHEETS | SHEET NO. |
| 1853 | 0505 RS-5 | COOK | 29 | 8 |
| STA. 56+05 | TO STA. 86+05 | | | |
| FED. ROAD DIST. NO. 1 | ILLINOIS | FED. AID PROJECT | | |

CONTRACT NO. 60B90

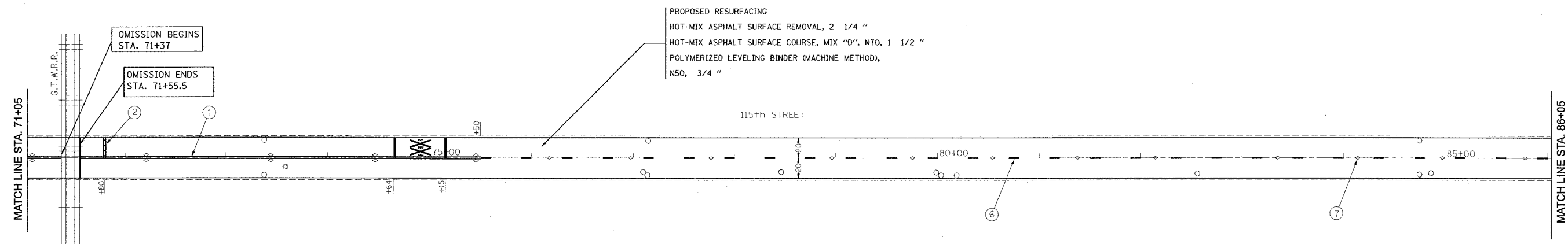
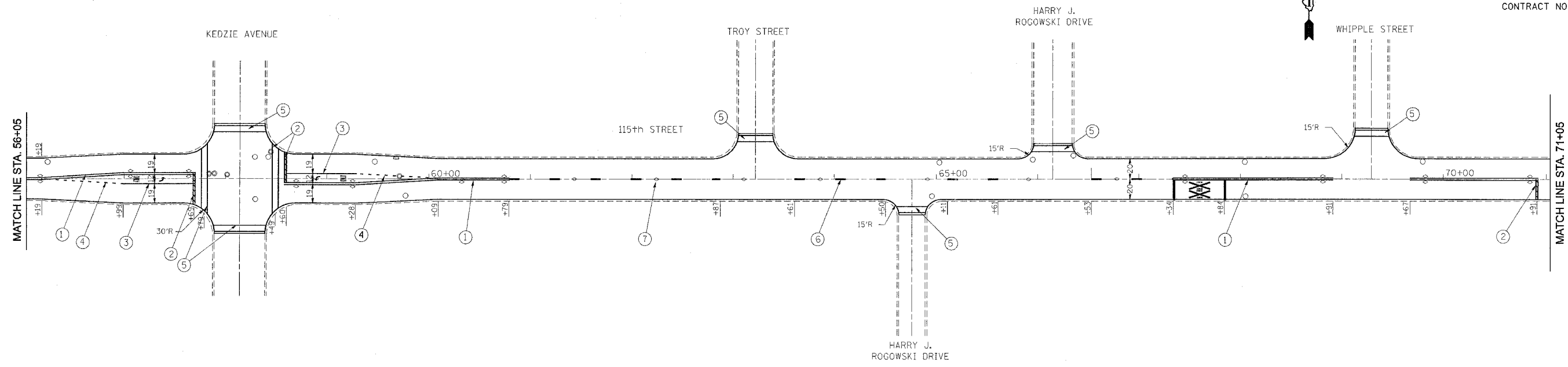

NOTES:

LIMIT OF RESURFACING ON SIDE-STREETS THROUGHOUT THE IMPROVEMENT SHALL BE TO THE RADIUS OF RETURN OR AS DIRECTED BY THE ENGINEER.

ALL FINAL PAVEMENT MARKINGS SHALL BE THERMOPLASTIC (OF THE EXTRUDED TYPE) AND SHOULD BE PLACED IN ACCORDANCE WITH "DISTRICT ONE TYPICAL PAVEMENT MARKING DETAILS." (TC-11), AND CITY OF CHICAGO TYPICAL PAVEMENT MARKINGS, (TC-24).

ALL RAISED REFLECTIVE PAVEMENT MARKERS SHALL BE IN ACCORDANCE WITH THE DISTRICT ONE "TYPICAL APPLICATIONS RAISED REFLECTIVE PAVEMENT MARKER DETAIL." (TC-11).

LEGEND

- ① THERMOPLASTIC PAVEMENT MARKING, 4" DOUBLE SOLID YELLOW CENTERLINE @ 11" C-C (TYP.)
- ② THERMOPLASTIC PAVEMENT MARKING, 24" SOLID WHITE LINE, STOP BAR (TYP.)
- ③ THERMOPLASTIC PAVEMENT MARKING, 6" SOLID WHITE TURN LANE LINE (TYP.)
- ④ THERMOPLASTIC PAVEMENT MARKING 6" WHITE SKIP DASH LINES (2' DASH, 6' SPACING) (TYP.)
- ⑤ THERMOPLASTIC PAVEMENT MARKING 6" WHITE CROSSWALK LINES, 2 @ 6' C-C SPACING (TYP.)
- ⑥ THERMOPLASTIC PAVEMENT MARKING 4" YELLOW SKIP LANE LINE (6' DASH, 18' SKIP) (TYP.)
- ⑦ RAISED REFLECTIVE PAVEMENT MARKERS

| REVISIONS | |
|-----------|------|
| NAME | DATE |
| | |
| | |
| | |
| | |
| | |
| | |
| | |
| | |

ILLINOIS DEPARTMENT OF TRANSPORTATION

115th STREET
PULASKIRD. TO WESTERN AVE.
ROADWAY & PAVEMENT
MARKING PLAN

SCALE: VERT. 1" = 50'
HORIZ. 1" = 50'

DATE 11/6/2006

DRAWN BY: HMO
CHECKED BY: