

ROUTE	SECTION	COUNTY	TOTAL SHEETS	SHEET NUMBER
VARIOUS	2006-035 LS	VARIOUS	27	18

CONTRACT 60B91

**SCHEDULE OF LANDSCAPE ITEMS**

DESCRIPTION	QTY/UNIT
<b>WEED CONTROL, NON-SELECTIVE AND NON-RESIDUAL</b>	1 GALLON
<b>WEED CONTROL, PRE-EMERGENT HERBICIDE</b>	0.125 GALLON
<b>COARSE SAND PLACEMENT 2</b>	300 SQ. YD.
<b>PERENNIAL PLANTS, GALLON POT</b>	9.35 UNITS
<i>ANDROPOGON GERARDII</i>	0.60 UNITS
<i>ANDROPOGON SCOPARIUS</i>	0.75 UNITS
<i>ASCLEPIAS TUBEROSA</i>	0.50 UNITS
<i>ASTER NOVAE-ANGLIAE 'ALMA POTSCHKE'</i>	0.50 UNITS
<i>BAPTISIA AUSTRALIS</i>	0.66 UNITS
<i>ECHINACEA PURPUREA 'MAGNUS'</i>	2.00 UNITS
<i>RUDBECKIA FULGIDA 'GOLDSTURM'</i>	4.00 UNITS
<i>SILPHIUM TEREBINTHINACEUM</i>	0.34 UNITS
<b>INTERSEEDING, CLASS 4A</b>	2 ACRES
<b>INTERSEEDING, CLASS 5A (MODIFIED)</b>	2 ACRES

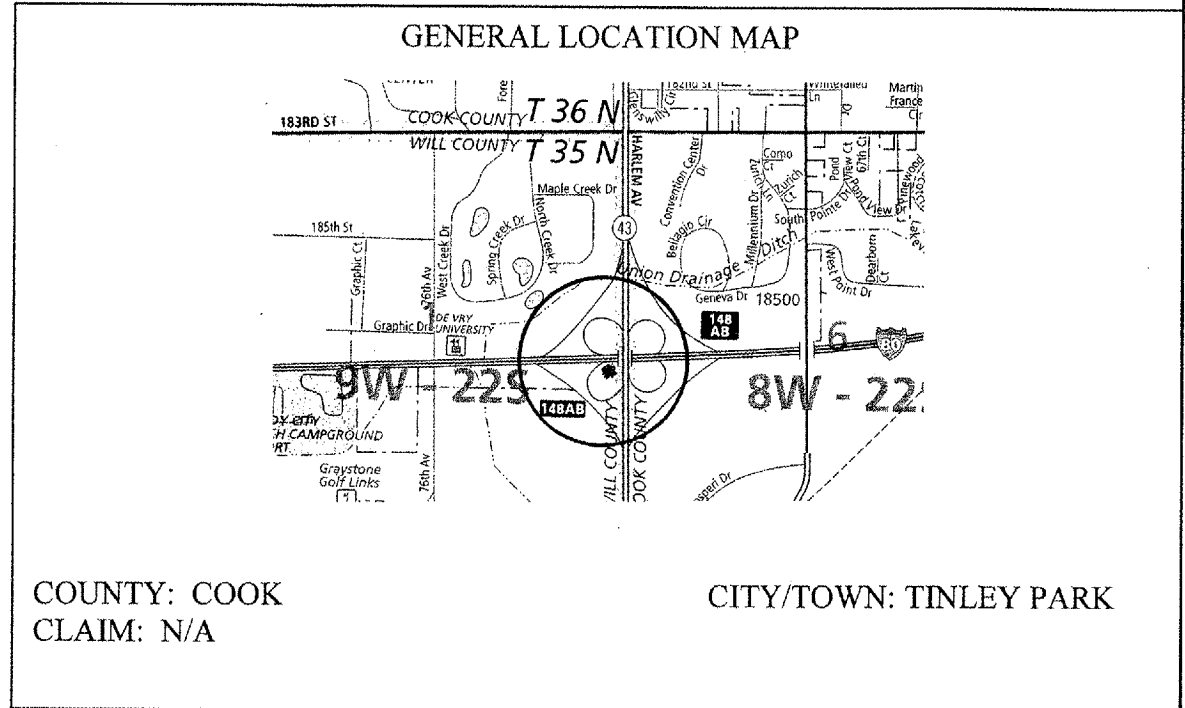

**NOTIFY STEVE LIPKIE 72 HOURS PRIOR TO PLANTING AT (847) 705-4171 FOR LAYOUT. SEE NEXT PAGE FOR PLANT BED DESIGN.**

ILLINOIS DEPARTMENT OF TRANSPORTATION

LANDSCAPE REPAIR LOCATION AND LAYOUT PLAN