

F.A.P. RTE.	SECTION	COUNTY	TOTAL SHEETS	SHEET NO.
342	530 CRC-PP	COOK	15	8
STA.		TO STA.		
FED. ROAD DIST. NO.		ILLINOIS FED. AID PROJECT		

STAGING NOTES

- SB STAGE I CLOSE EB LAKE-COOK RD TO SB IL 53 EXT ENTRANCE RAMP & CLOSE RIGHT LANE OF WB LAKE-COOK RD TO SB IL 53 EXT RAMP (SEE NOTE 1 ON SHEET 10) BEFORE SB PATCH #1 IN ORDER TO PERFORM SB PATCHES (#1 THRU #9). DETOUR SIGNS * SHALL BE SET UP AHEAD OF HICKS ROAD & RAND RD TO FOLLOW IL 53. (5 CALENDAR DAYS MAX., SIGNS SHALL BE APPROVED BY THE ENGINEER). THE COST OF TEMP DETOUR SIGNAGE (12 SIGNS) IS INCLUDED IN THE COST OF "TRAFFIC CONTROL & PROTECTION (EXPRESSWAY)."
- SB STAGE II CLOSE SB IL 53 EXT LANES #2 & #3 AS SHOWN ON THE STAGING PLAN & PERFORM SB PATCHES (#10 THRU #23) (SEE DETAILS SHEET 10)
- NB STAGE I CLOSE NB IL 53 EXT LANES #1 & #2 PER STATE STANDARDS 701400 & 701446 IN ORDER TO PATCH NB LANES (2, 3, 4, 5, 6, 8 & 12 THRU 34) AND CLOSE LANE 1 PER STANDARDS 701400 & 701401 TO PERFORM NB PATCHES (35, 38, 40, 41, 42, 44, 46).
- NB STAGE II CLOSE LANE 1 PER STANDARDS 701400 & 401401 WITH CENTER LANE CLOSURE DETAIL (TC 25) TO PERFORM NB PATCHES (37, 39, 43, 45, 47). SEE DETAILS SHEET 9 & 10. KEEP IL 53 EXTENSION NB TO LAKE-COOK ROAD EB RAMP OPEN.

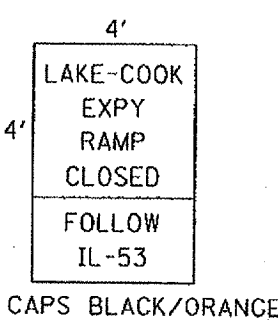
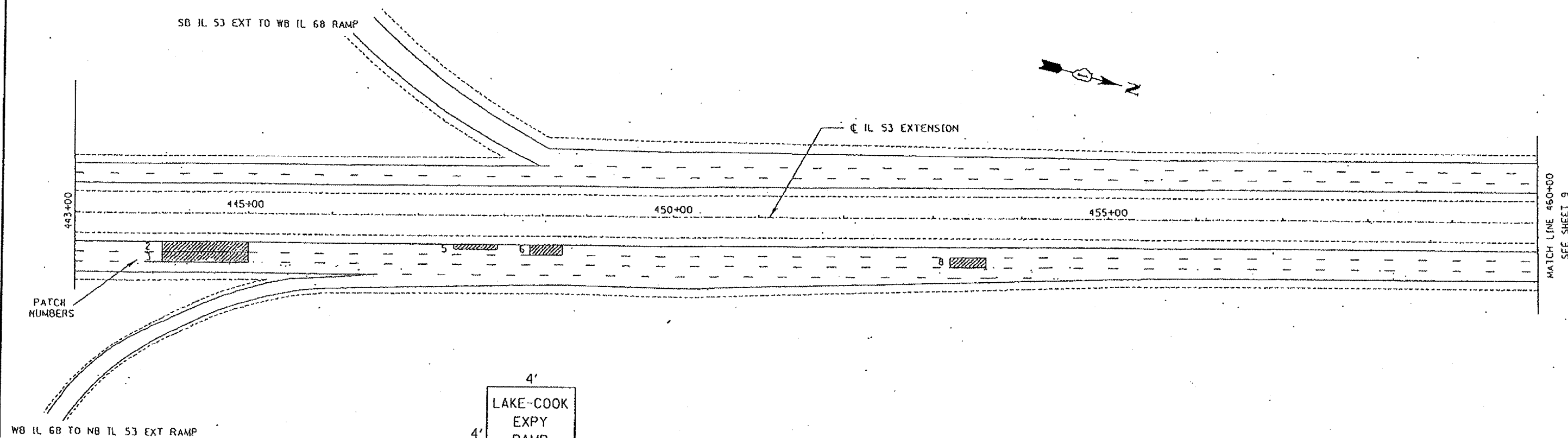

- *DETOUR SIGNAGE
- 1) SB HICKS RD @ LAKE-COOK RD, SIGN TO GO STRAIGHT
 - 2) SB RAND RD @ LAKE-COOK RD, SIGN TO GO STRAIGHT
 - 3) EB LAKE-COOK RD @ RAND RD & @ HICKS RD, SIGNS TO TURN RIGHT

REVISIONS	
NAME	DATE

ILLINOIS DEPARTMENT OF TRANSPORTATION

SCALE: VERT. _____ HORIZ. _____ DATE _____

DRAWN BY _____ CHECKED BY _____

PLOT DATE: 12/12/2006
 FILE NAME: C:\p062962\1000\1000.dwg
 PLOT SCALE: 1/8" = 1'-0"
 PLOT NAME: 1000.dwg