

TWP. #	SECTION	COUNTY	TOTAL SHEETS	SHEET NO.
330	(102 & 102X) LS	COOK	14	10
STA. 0+00	TO STA. 16+00			
FED. ROAD DIST. NO. 1	ILLINOIS	FED. AID PROJECT		

D-91-227-05

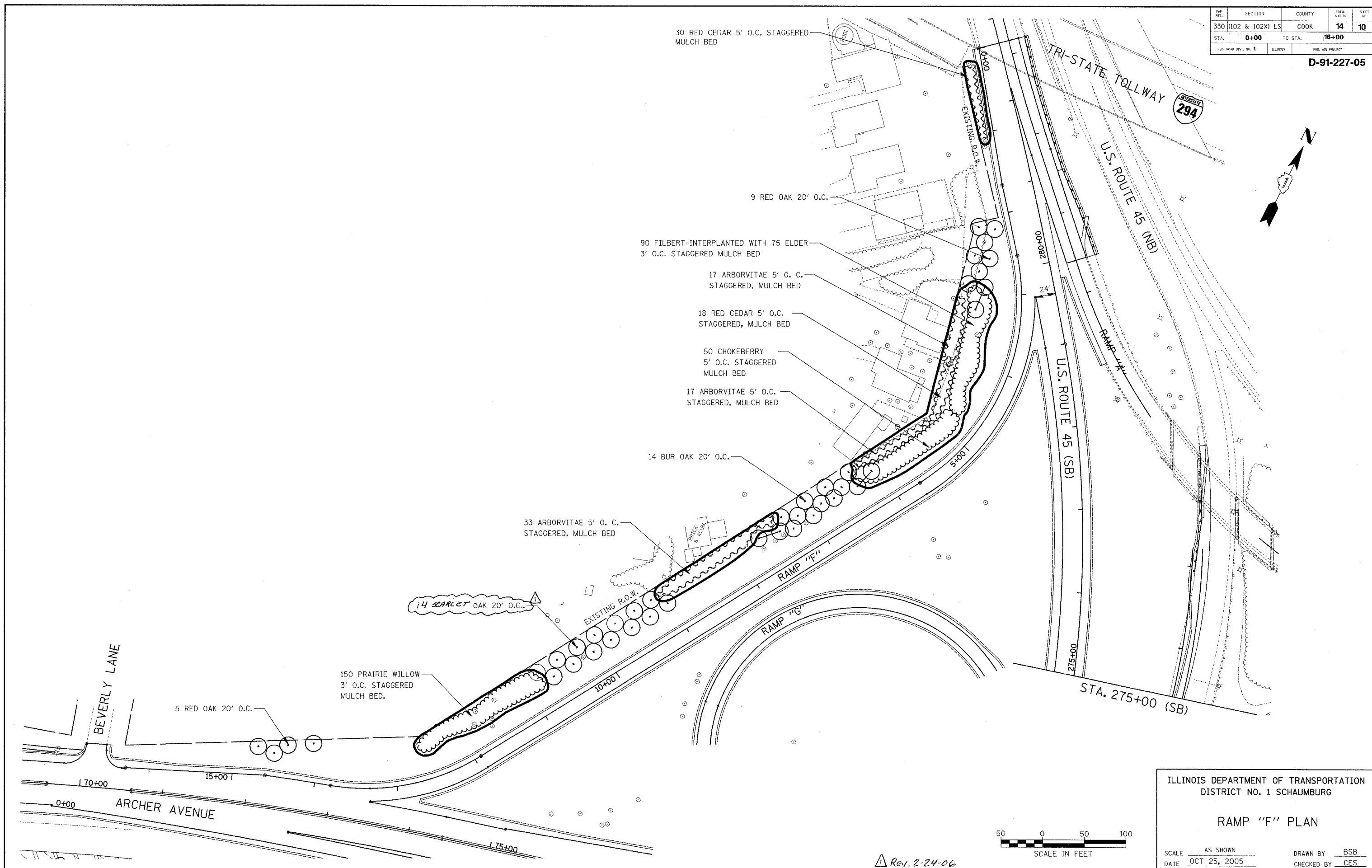
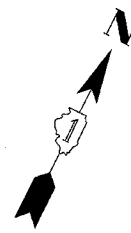

ILLINOIS DEPARTMENT OF TRANSPORTATION  
DISTRICT NO. 1 SCHAUMBURG

**RAMP "F" PLAN**

SCALE AS SHOWN  
DATE OCT 25, 2005

DRAWN BY BSB  
CHECKED BY CES

Rev. 2-24-06