

62969

FAP RTE.	SECTION	COUNTY	TOTAL SHEETS	SHEET NO.
330	(102 & 102X) LS	COOK	14	1

STATE OF ILLINOIS  
DEPARTMENT OF TRANSPORTATION  
DIVISION OF HIGHWAYS

**PLANS FOR PROPOSED HIGHWAY**  
**F.A.P. 330 U.S. ROUTE 12/20/45 (LAGRANGE ROAD)**  
**IL. ROUTE 171 (ARCHER AVENUE) TO NORTH OF**  
**CAL SAG CHANNEL AND ORLAND TOWNSHIP IN**  
**UNINCORPORATED COOK COUNTY**  
**SECTION: (102 & 102X) LS**  
**LANDSCAPING /FOREST MANAGEMENT**  
**COOK COUNTY**  
**C-91-227-05**

**INDEX OF SHEETS**

- 1 TITLE SHEET  
LOCATION MAPS  
INDEX OF SHEETS  
HIGHWAY STANDARDS
- 2 SUMMARY OF QUANTITIES
- 3 SCHEDULE OF LANDSCAPE ITEMS  
GENERAL NOTES
- 4 CALENDAR OF LANDSCAPE  
CONSTRUCTION AND  
ESTABLISHMENT WORK
- 5-9 LANDSCAPING PLANS  
U.S. 12/20/45 (LA GRANGE ROAD)
- 10 RAMP F LANDSCAPE PLAN
- 11 TREE MITIGATION PLAN  
SCHEDULE OF QUANTITIES  
(TREE MITIGATION SITE ONLY)
- 12 FPDCC DEVELOPMENT PLAN  
TREE GROUPING KEY A
- 13-14 TREE GROUPING KEYS B - E

**LIST OF IDOT HIGHWAY STANDARDS**

- 701001-01
- 702001-06
- 701101-01
- 701006-02
- 701106-01
- 701311-02
- 701426-01

IMPROVEMENT IS LOCATED  
IN THE VILLAGE OF WILLOW  
SPRINGS AND UNINCORPORATED  
COOK COUNTY

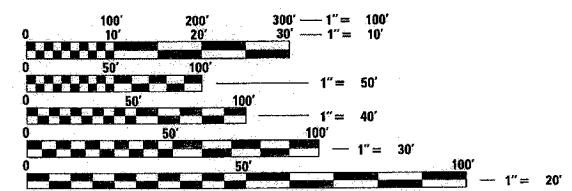

FULL SIZE PLANS HAVE BEEN PREPARED USING STANDARD  
ENGINEERING SCALES. REDUCED SIZED PLANS WILL NOT  
CONFORM TO STANDARD SCALES. IN MAKING MEASUREMENTS  
ON REDUCED PLANS, THE ABOVE SCALES MAY BE USED.

J.U.L.I.E.  
JOINT UTILITY LOCATION INFORMATION FOR EXCAVATION  
1-800-892-0123

**CONTRACT NO. 62969**

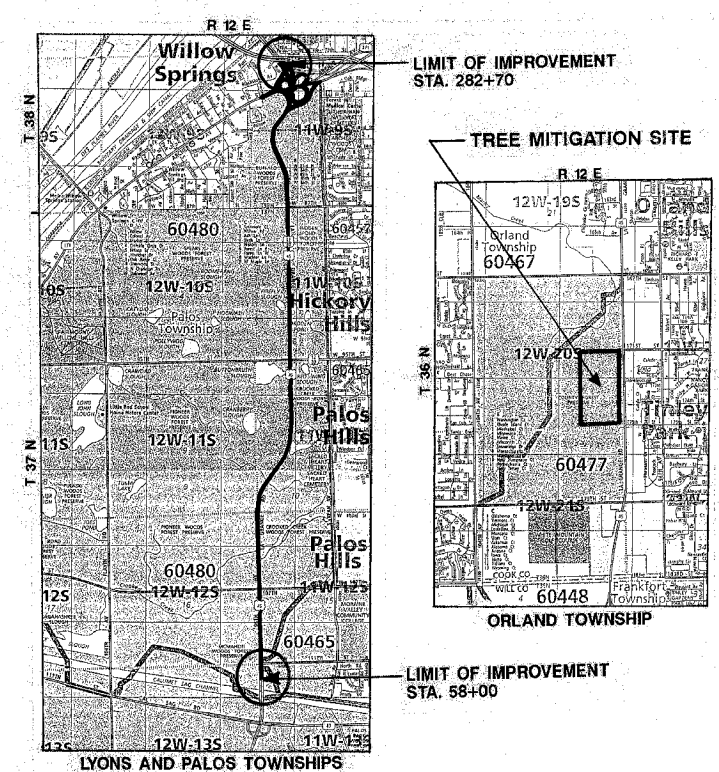
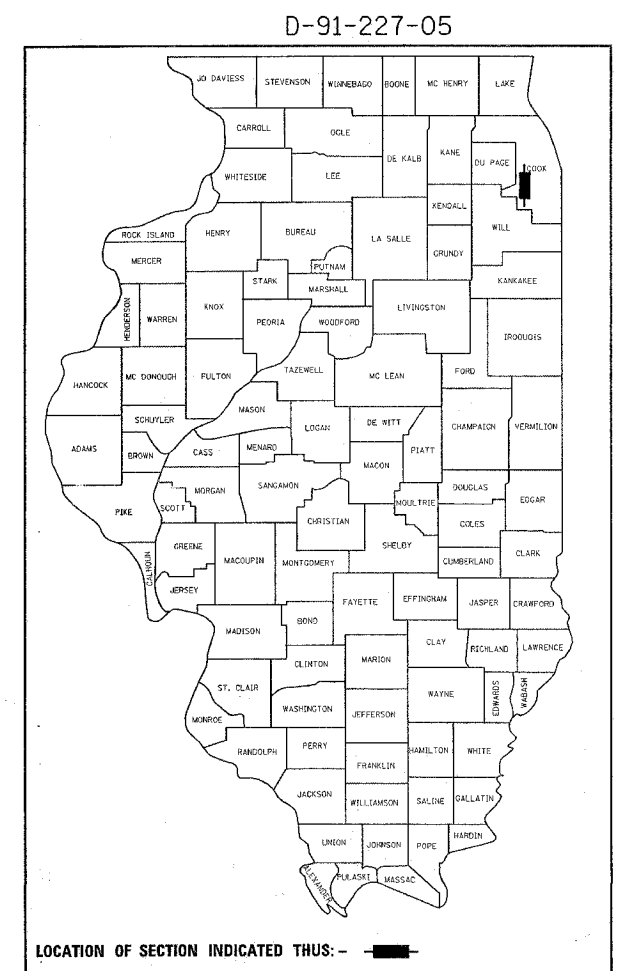

LOCATION MAPS  
SCALE: 1"=1300'  
GROSS LENGTH OF PROJECT: 4.25 MILES  
NET LENGTH OF PROJECT: 4.25 MILES

STATE OF ILLINOIS  
DEPARTMENT OF TRANSPORTATION  
DIVISION OF HIGHWAYS

SUBMITTED OCT. 26 20 05

Diane M. O'Keefe / cd  
DEPUTY DIRECTOR OF HIGHWAYS, REGION ENGINEER

December 9, 20 05  
Mike Hine / cd  
ENGINEER OF DESIGN AND ENVIRONMENT

December 9, 20 05  
Eric Harrah / cd  
DEPUTY DIRECTOR OF HIGHWAYS, CHIEF ENGINEER

**PRINTED BY THE AUTHORITY  
OF THE STATE OF ILLINOIS**

DISTRICT ONE - BUREAU OF MAINTENANCE  
MAINTENANCE LANDSCAPE DESIGNER: R. WANNER / S. LIPKIE (847) 705-4171

F.A. RTE.	SECTION	COUNTY	TOTAL SHEETS	SHEET NO.
330	(102 & 102 X)	COOK	14	2
FED. ROAD DIST. NO. 1		ILLINOIS	HIGHWAY PROJECT	

62969

SUMMARY OF QUANTITIES			TOTAL QUANTITIES	CONSTRUCTION TYPE CODE				
CODE NO	ITEM	UNIT		URBAN 100% STATE Y003				
20101350	TREE PRUNING (OVER 10 INCH DIAMETER)	EACH	5	5				
25000400	NITROGEN FERTILIZER NUTRIENT	POUND	155	155				
25000750	MOWING	ACRE	24	24				
25200200	SUPPLEMENTAL WATERING	UNIT	120	120				
67000400	ENGINEER'S FIELD OFFICE, TYPE A	CAL MO	9	9				
67100100	MOBILIZATION	L SUM	1	1				
A2002516	TREE, CARPINUS CAROLINIANA (AMERICAN HORNBEAM), 2" CALIPER, BALLED AND BURLAPPED	EACH	3	3				
A2006600	TREE, QUERCUS COCCINEA (SCARLET OAK), 1-3/4" CALIPER, BALLED AND BURLAPPED	EACH	14	14				
A2006712	TREE, QUERCUS MACROCARPA (BUR OAK), 1-1/2" CALIPER, BALLED AND BURLAPPED	EACH	14	14				
A2007114	TREE, QUERCUS RUBRA (RED OAK), 1-3/4" CALIPER, BALLED AND BURLAPPED	EACH	14	14				
A2C007G3	TREE, AMELANCHIER CANADENSIS (SHADBLOW SERVICEBERRY), CONTAINER GROWN, 3-GALLON	EACH	140	140				
A2C025G3	TREE, CERCIS CANADENSIS (REDBUD), CONTAINER GROWN, 3-GALLON	EACH	80	80				
A2C033G3	TREE, QUERCUS COCCINEA (SCARLET OAK), CONTAINER GROWN, 3-GALLON	EACH	40	40				
A2C034G3	TREE, QUERCUS IMBRICARIA (SHINGLE OAK), CONTAINER GROWN, 3-GALLON	EACH	80	80				
A2C049G3	TREE, QUERCUS ALBA (WHITE OAK), CONTAINER GROWN, 3-GALLON	EACH	245	245				
A2C056G3	TREE, QUERCUS MACROCARPA (BURR OAK), CONTAINER GROWN, 3-GALLON	EACH	310	310				
A2C061G3	TREE, QUERCUS RUBRA (RED OAK), CONTAINER GROWN, 3-GALLON	EACH	165	165				
B2000562	TREE, AMELANCHIER CANADENSIS (SHADBLOW SERVICEBERRY), 4' HEIGHT, SHRUB FORM, BALLED AND BURLAPPED	EACH	50	50				
B2001164	TREE, CERCIS CANADENSIS (EASTERN REDBUD) 5' HEIGHT, CLUMP FORM, BALLED AND BURLAPPED	EACH	8	8				
C2000524	SHRUB, ARONIA MELANOCARPA (BLACK CHOKE BERRY), 2' HEIGHT, BALLED AND BURLAPPED	EACH	50	50				
C2001124	SHRUB, CEPHALANTHUS OCCIDENTALIS (BUTTON BUSH), 2' HEIGHT, BALLED AND BURLAPPED	EACH	10	10				

SUMMARY OF QUANTITIES			TOTAL QUANTITIES	CONSTRUCTION TYPE CODE				
CODE NO	ITEM	UNIT		URBAN 100% STATE Y003				
C2002024	SHRUB, CORYLUS AMERICANA (AMERICAN FILBERT), 2' HEIGHT, BALLED AND BURLAPPED	EACH	490	490				
C2003348	SHRUB, HAMAMELIS VIRGINIANA (COMMON WITCHHAZEL), 4' HEIGHT, BALLED AND BURLAPPED	EACH	50	50				
C2C06024	SHRUB, RHUS TYPHINA (STAGHORN SUMAC), 2' HEIGHT, CONTAINER	EACH	20	20				
C2C09418	SHRUB, SALIX HUMILIS (PRAIRIE WILLOW), 18" HEIGHT, CONTAINER	EACH	150	150				
C2C09624	SHRUB, SAMBUCUS CANADENSIS (AMERICAN ELDER), 2' HEIGHT, CONTAINER	EACH	75	75				
D2001560	EVERGREEN, JUNIPERUS VIRGINIANA (EASTERN RED CEDAR), 5' HEIGHT, BALLED AND BURLAPPED	EACH	48	48				
D2003848	EVERGREEN, THUJA OCCIDENTALIS TECHN (TECHNY ARBORVITAE), 4' HEIGHT, BALLED AND BURLAPPED	EACH	67	67				
X0322856	WEED CONTROL, NON-SELECTIVE AND NON-RESIDUAL	GALLON	2.5	2.5				
X0322859	WEED CONTROL, PRE-EMERGENT GRANULAR HERBICIDE	POUND	160	160				
Z0013798	CONSTRUCTION LAYOUT	L SUM	1	1				

REVISIONS	
NAME	DATE

ILLINOIS DEPARTMENT OF TRANSPORTATION  
SUMMARY OF QUANTITIES  
U.S. RTE. 12/24/45  
(LA GRANGE ROAD)

10/26/2006  
14/26/2006  
14/26/2006

### SCHEDULE OF LANDSCAPE ITEMS

ITEM	UNIT	TOTAL	SHEET NUMBER							
			5	6	7	8	9	10	11	
<b>SHADE TREES</b>										
Carpinus caroliniana (American Hornbeam), 2" Caliper, Balled & Burlapped	EACH	3		3						
Celtis occidentalis (Hackberry), Container Grown, 3-Gallon	EACH	70								70
Juglans nigra (Black Walnut), Container Grown, 3-Gallon	EACH	70								70
Carya ovata (Shagbark Hickory) <sup>△</sup> Container Grown, 3-Gallon	EACH	80								80
Quercus alba (White Oak), Container Grown, 3-Gallon	EACH	245				25	50			170
Quercus coccinea (Scarlet Oak), 1-3/4" Caliper, Balled & Burlapped	EACH	14							14	
Quercus coccinea (Scarlet Oak), Container Grown, 3-Gallon	EACH	40								40
Quercus imbricaria (Shingle Oak), Container Grown, 3-Gallon	EACH	80					20			60
Quercus macrocarpa (Bur Oak), 1-1/2" Caliper, Balled & Burlapped	EACH	14							14	
Quercus macrocarpa (Bur Oak), Container Grown, 3-Gallon	EACH	310								310
Quercus rubra (Red Oak), 1-3/4" Caliper, Balled & Burlapped	EACH	14							14	
Quercus rubra (Red Oak), Container Grown, 3-Gallon <sup>△</sup>	EACH	165				25	50			90
<b>INTERMEDIATE TREES</b>										
Amelanchier canadensis (Shadblow Serviceberry), 4' Height, Shrub Form, B & B	EACH	50						50		
Amelanchier canadensis (Shadblow Serviceberry), Container Grown, 3-Gallon	EACH	140				50				90
Cercis canadensis (Eastern Redbud), 5' Height, Clump Form, Balled & Burlapped	EACH	8	8							
<b>SHRUBS</b>										
Aronia melanocarpa (Black Chokeberry), 2' Height, Balled & Burlapped	EACH	50							50	
Cephalanthus occidentalis (Buttonbush), 2' Height, Balled & Burlapped	EACH	10		10						
Corylus americana (American Filbert), 2' Height, Balled & Burlapped	EACH	490	200			200			90	
Hamamelis virginiana (Common Witchhazel), 2' Height, Balled & Burlapped	EACH	50					50			
Rhus typhina (Staghorn Sumac), 2' Height, Container	EACH	20		20						
Salix humilis (Prairie Willow), 18" Height, Container	EACH	150							150	
Sambucus canadensis (American Elder), 2' Height, Container	EACH	75							75	
<b>EVERGREENS</b>										
Juniperus virginiana (Eastern Red Cedar), 5' Height, Balled & Burlapped	EACH	48							48	
Thuja occidentalis Techny (Techny Arborvitae), 4' Height, Balled & Burlapped	EACH	67							67	
<b>OTHER</b>										

#### GENERAL NOTES

BEFORE STARTING ANY EXCAVATION, THE CONTRACTOR SHALL CALL "J.U.L.I.E." AT (800) 892-0123 FOR FIELD LOCATIONS OF BURIED ELECTRIC, TELEPHONE AND GAS UTILITIES. (48 HOUR NOTIFICATION IS REQUIRED).

VILLAGE WATER, SEWER MAINS AND OTHER UTILITIES MAY BE LOCATED IN THE LANDSCAPE AREA. THE ACTUAL LOCATION OF PROPOSED LANDSCAPING WILL BE ADJUSTED IN THE FIELD TO AVOID UTILITIES. THE VILLAGE OF WILLOW SPRINGS AND THE FOREST PRESERVE DISTRICT OF COOK COUNTY ARE NOT PART OF "J.U.L.I.E." THE CONTRACTOR SHALL CONTACT THE RESPECTIVE VILLAGES TO LOCATE THEIR UTILITIES.

THE CONTRACTOR WILL NOT BE ALLOWED TO PROCEED WITH ANY PLANTING WORK UNTIL ALL UTILITY OWNERS FIELD LOCATE THEIR FACILITIES WHICH MAY INTERFERE WITH LANDSCAPING OPERATIONS.

THE CONTRACTOR WILL NOT BE ALLOWED TO SET UP A YARD OR FIELD OFFICE ON STATE PROPERTY OR FOREST PRESERVE HOLDINGS WITHOUT WRITTEN PERMISSION FROM THE DEPARTMENT OR THE FOREST PRESERVE DISTRICT OF COOK COUNTY.

IT SHALL BE THE CONTRACTOR'S RESPONSIBILITY TO VERIFY ALL DIMENSIONS AND CONDITIONS EXISTING IN THE FIELD PRIOR TO CONSTRUCTION AND ORDERING OF MATERIALS.

THE CONTRACTOR SHALL CONTACT THE DISTRICT ONE TRAFFIC CONTROL SUPERVISOR AT (847) 705-4155 A MINIMUM OF 72 HOURS IN ADVANCE OF BEGINNING WORK.

UNDERBRUSH OR DEBRIS AT PLANTING LOCATIONS SHALL BE REMOVED AND DISPOSED OF IN ACCORDANCE WITH SECTION 201 OF THE STANDARD SPECIFICATIONS. THIS WORK WILL NOT BE PAID FOR SEPARATELY, BUT THE COSTS SHALL BE CONSIDERED AS INCLUDED IN THE CONTRACT UNIT PRICES FOR THE CONSTRUCTION ITEMS INVOLVED, AND NO ADDITIONAL COMPENSATION WILL BE ALLOWED.

THE CONTRACTOR SHALL PROTECT ALL EXISTING PLANT MATERIAL FROM DAMAGE FOR WHICH THE CONTRACT DOES NOT PROVIDE REMOVAL. THE PROTECTION OF EXISTING PLANT MATERIAL AND THE REPAIR OR REPLACEMENT OF EXISTING PLANT MATERIAL DAMAGED BY THE CONTRACTOR SHALL BE DONE IN ACCORDANCE WITH THE REQUIREMENTS OF SECTION 201 OF THE STANDARD SPECIFICATIONS UNLESS OTHERWISE NOTED.

THE CONTRACTOR SHALL ORDER ALL CONTAINER TREES IMMEDIATELY FOLLOWING EXECUTION OF THE CONTRACT TO ASSURE AVAILABILITY OF THE PLANT MATERIAL FOR SPRING PLANTING.

THE RESIDENT ENGINEER IN COORDINATION WITH THE DISTRICT LANDSCAPE ARCHITECT WILL STAKE ALL TREE PLANTINGS AT THE TREE MITIGATION SITE. UNLESS OTHERWISE NOTIFIED, THE CONTRACTOR SHALL PROVIDE AN ADEQUATE NUMBER OF LATHES SEVERAL WEEKS PRIOR TO THE SCHEDULED TREE PLANTING.

WHERE MULCH BEDS ARE SPECIFIED, ALL EXISTING GRASS, WEEDS, AND DEBRIS ARE TO BE REMOVED AND THE BEDS TILLED TO A DEPTH OF 6 INCHES PRIOR TO PLACING PROPOSED PLANTS. FOLLOWING PLANTING, BEDS SHALL BE MULCHED TO A DEPTH OF 4 INCHES. THIS WORK WILL BE CONSIDERED INCLUDED IN THE CONTRACT UNIT PRICE FOR THE PLANTING ITEMS.

THE MINIMUM HEIGHT OF CONTAINER TREES SHALL BE 4 FOOT. OTHER CONTAINER SIZES LARGER THAN 3 GALLON WILL BE ACCEPTABLE FOR CONTAINER GROWN TREES.

REVISIONS	
NAME	DATE

ILLINOIS DEPARTMENT OF TRANSPORTATION

### SCHEDULE OF LANDSCAPE ITEMS

#### GENERAL NOTES

SCALE: VERT. \_\_\_\_\_  
 HORIZ. \_\_\_\_\_

DATE \_\_\_\_\_ DRAWN BY \_\_\_\_\_  
 CHECKED BY \_\_\_\_\_

△ Rev. 4-11-06  
 △ Rev. 2-24-06

Rev.

## CALENDAR OF CONSTRUCTION AND ESTABLISHMENT WORK

Phase I	YEAR	WORK DATES		CONSTRUCTION WORK	ESTABLISHMENT WORK
		FROM	TO		
Phase I	2007	Prior to Planting			1.) Layout of planting areas. 2.) Weed spray of non-selective, non-residual herbicide in designated planting areas.
		Thawed Soil	April 30	Install evergreens.	
		Thawed Soil	May 15	Finish installation of all woody plants. <b>All woody plants must be installed by May 15.</b>	Apply Pre-Emergent Granular Herbicide and Nitrogen Fertilizer Nutrients to all woody plants prior to placing mulch.
		May 1	May 15	Period of establishment plant care required for woody plants.*	
		May 15	May 31	Period of establishment plant care required for woody plants.*	

Phase III	YEAR	WORK DATES		CONSTRUCTION WORK	ESTABLISHMENT WORK
		FROM	TO		
Phase III	2008	Thawed Soil	May 15	Installation of all required replacement woody plants, and all required clean up of woody plants shall be completed by May 15.	1.) Apply Pre-Emergent Granular Herbicide to all replacement woody plants prior to placing mulch. 2.) Supplemental Watering of woody plants if required by Engineer.
		May 15	May 31		1.) Mow turf areas to a height of 3 inches within the project limits as directed by the Engineer. 2.) Supplemental Watering of woody plants if required by Engineer.

Phase II	YEAR	WORK DATES		CONSTRUCTION WORK	ESTABLISHMENT WORK
		FROM	TO		
Phase II	2007	June 1		Certification to the Bureau of Maintenance that all woody plants have been installed and are in a live healthy condition and eligible for a September 2007 period of establishment inspection.	
		June 1	June 15	Period of establishment plant care required for woody plants.*	
		June 15	June 30	Period of establishment plant care required for woody plants.*	
		July 1	July 15	Period of establishment plant care required for woody plants.*	
		July 15	July 31	Period of establishment plant care required for woody plants.*	
		Aug. 1	Aug. 15	Period of establishment plant care required for woody plants.*	
		Aug. 15	Aug. 31	Period of establishment plant care required for woody plants.*	
		Sept. 1	Sept. 15	Period of establishment plant care required for woody plants.*	
		Sept. 15	Sept. 30	Period of establishment plant care required for woody plants.*	
		Oct. 1	Oct. 15	Additional watering for woody plants if required by the Engineer.	
		Oct. 15	Oct. 31	Additional watering for woody plants if required by the Engineer.	
		Nov. 1	Nov. 15	Additional watering for woody plants if required by the Engineer.	
		Nov. 15	Nov. 30	Additional watering for woody plants if required by the Engineer.	
		Dec. 1	Dec. 15	Additional watering for woody plants if required by the Engineer.	
Dec. 15	Dec. 31	Additional watering for woody plants if required by the Engineer.			

\* Weeding, watering and other work which is necessary to maintain health and satisfactory appearance of the planting is included in the cost of the contract.

REVISIONS	
NAME	DATE

ILLINOIS DEPARTMENT OF TRANSPORTATION

### CALENDAR OF CONSTRUCTION AND ESTABLISHMENT WORK

SCALE: VERT.  
HORIZ.  
DATE: OCTOBER 25, 2006

DRAWN BY  
CHECKED BY

POP. RITE.	SECTION	COUNTY	TOTAL SHEETS	SHEET NO.
	330 (102 & 102X) LS	COOK	14	5
STA.	115+00	TO STA.	140+00	
FED. ROAD DIST. NO.	1	BLINETS	FED. AID PROJECT	

D-91-227-05

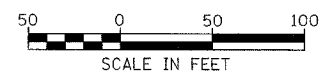
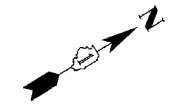
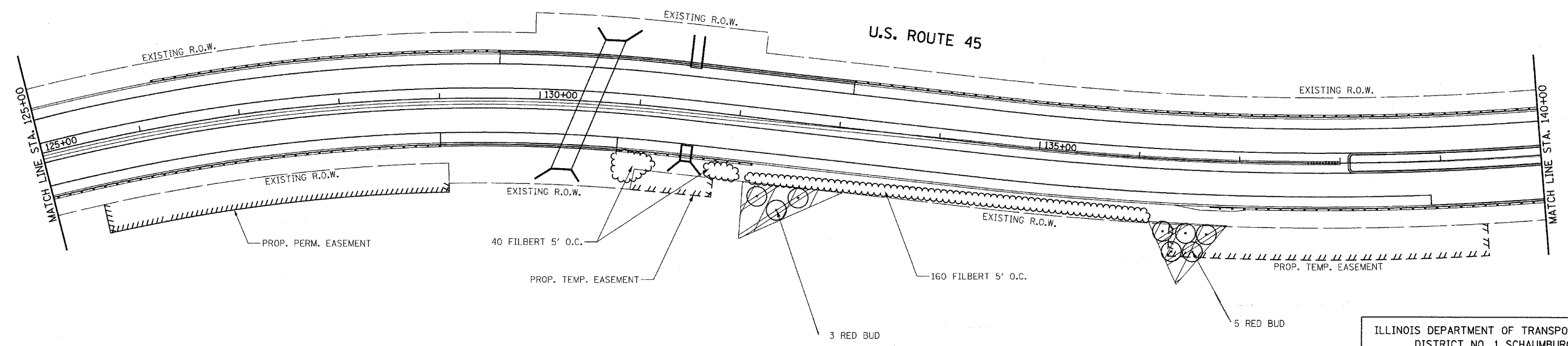
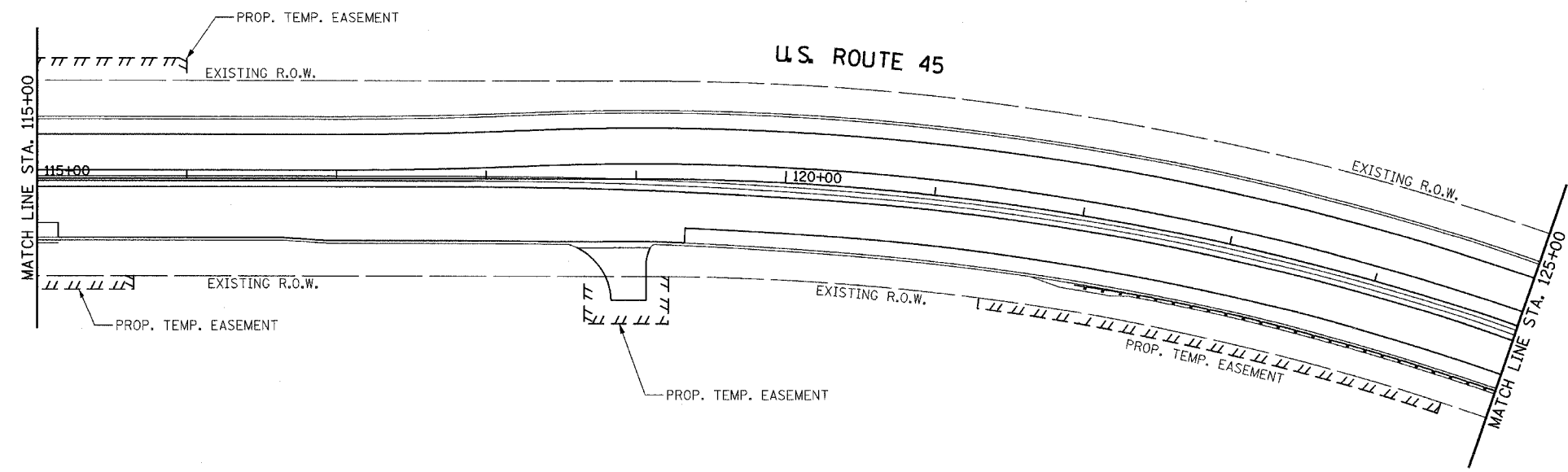
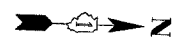

ILLINOIS DEPARTMENT OF TRANSPORTATION  
DISTRICT NO. 1 SCHAUMBURG

LANDSCAPING PLAN  
U.S. ROUTE 45

SCALE AS SHOWN  
DATE OCT 25, 2005

DRAWN BY BSB  
CHECKED BY CES

F&P PTE.	SECTION	COUNTY	TOTAL SHEETS	SHEET NO.
330 (102 & 102X) LS		COOK	14	6
STA. 140+00	TO STA. 165+00			
FED. ROAD DIST. NO. 1	ILLINOIS	FED. AID PROJECT		

D-91-227-05

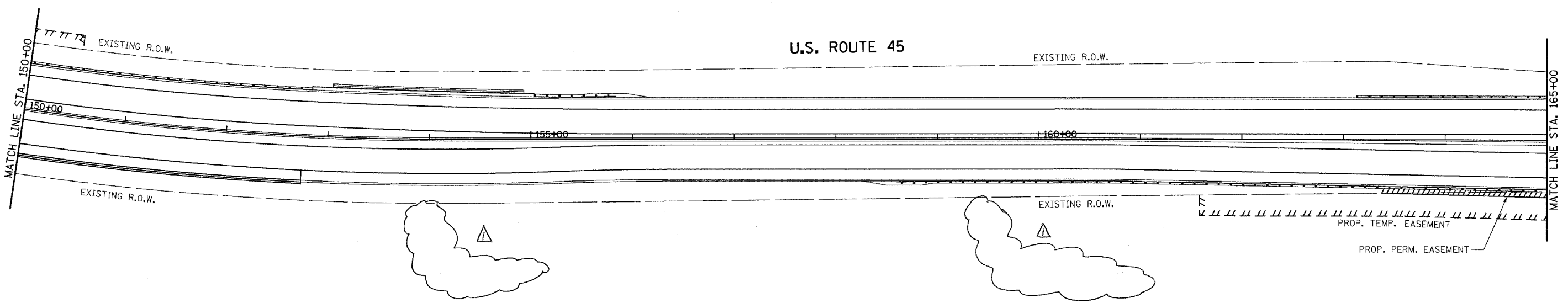
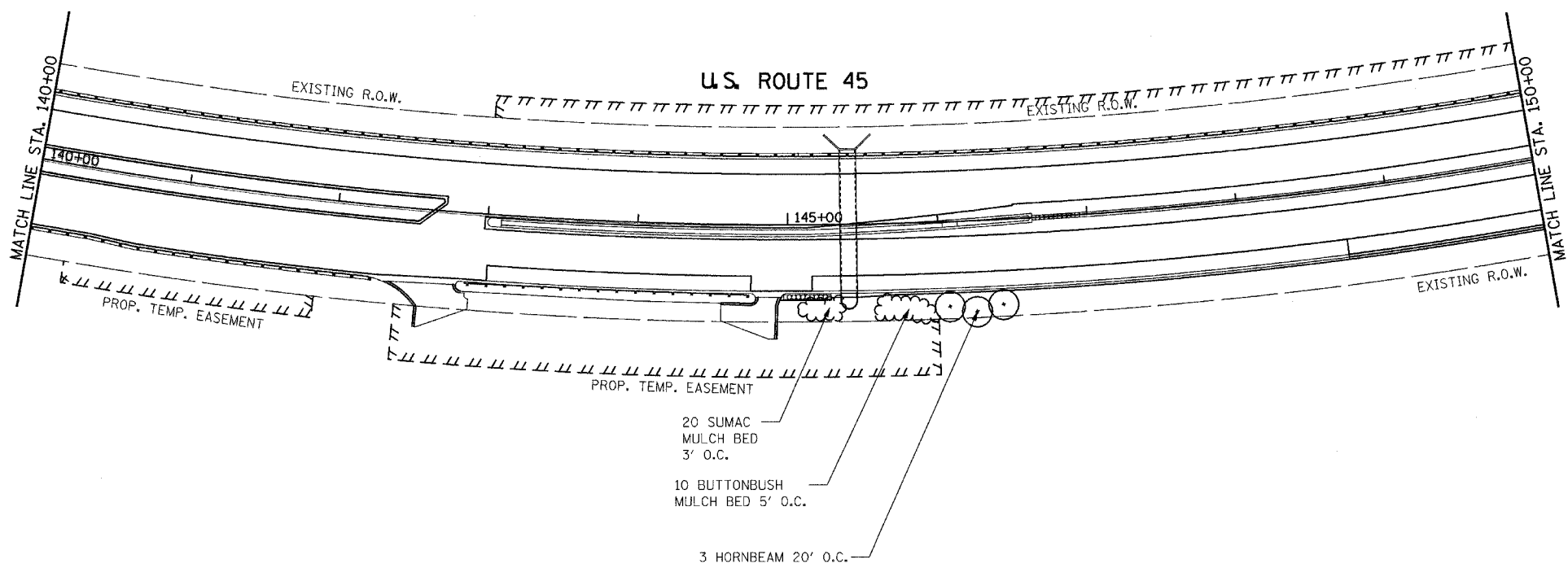

ILLINOIS DEPARTMENT OF TRANSPORTATION  
DISTRICT NO. 1 SCHAUMBURG

LANDSCAPING PLAN  
U.S. ROUTE 45

SCALE AS SHOWN  
DATE OCT 25, 2005  
DRAWN BY BSB  
CHECKED BY CES

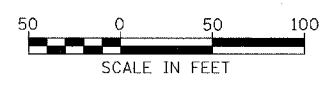

Rev. 2-24-06

FED. AID DIST. NO. 1	SECTION 330 (102 & 102X) LS	COUNTY COOK	TOTAL SHEETS 14	SHEET NO. 7
STA. 165+00		TO STA. 195+00		
FED. AID PROJECT				

D-91-227-05

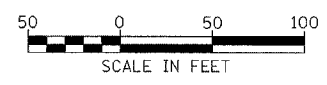
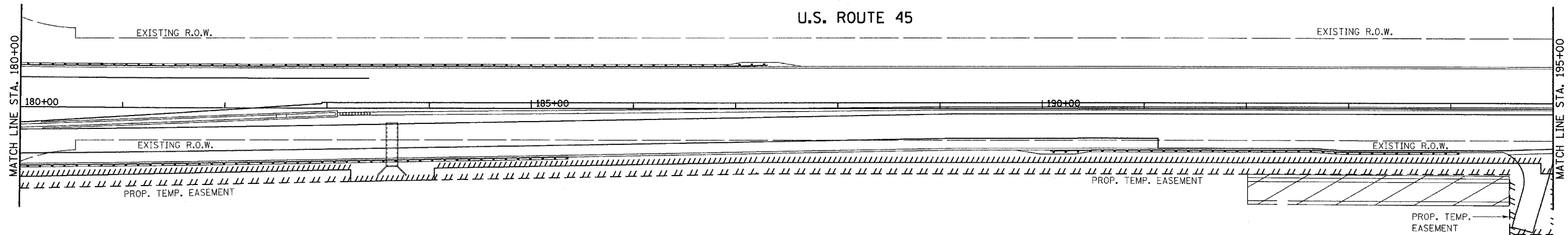
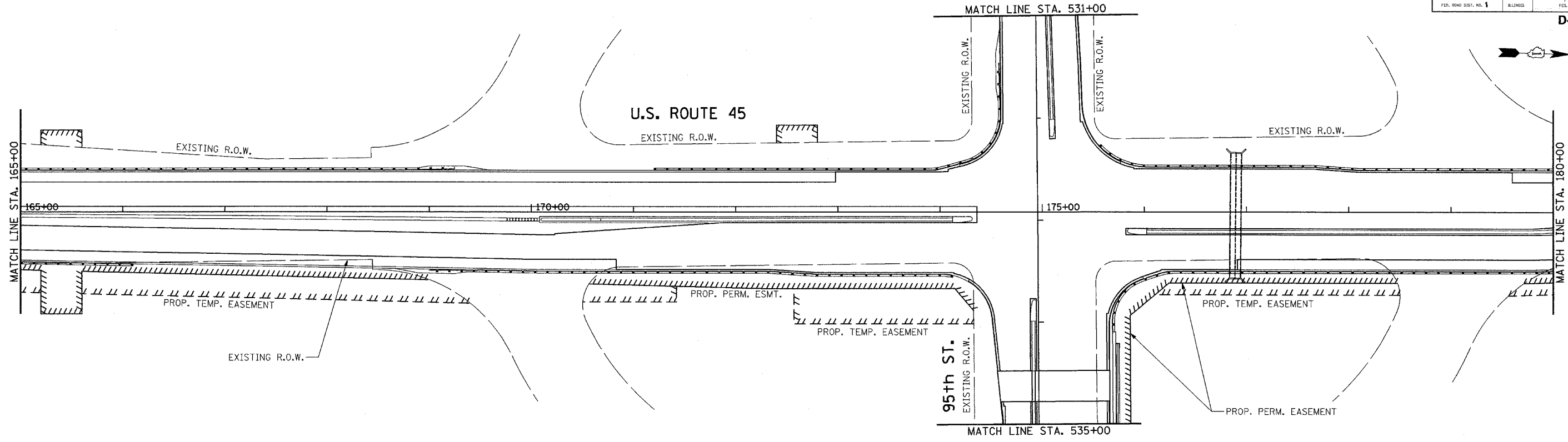

ILLINOIS DEPARTMENT OF TRANSPORTATION  
 DISTRICT NO. 1 SCHAUMBURG  
 LANDSCAPING PLAN  
 U.S. ROUTE 45  
 SCALE AS SHOWN  
 DATE OCT 25, 2005  
 DRAWN BY BSB  
 CHECKED BY CES

F&P NO.	SECTION	COUNTY	TOTAL SHEETS	SHEET NO.
330	102 & 102X1 LS	COOK	14	8
STA. 195+00		TO STA. 210+00		
FED. ROAD DIST. NO. 1		ILLINOIS		FED. AID PROJECT

D-91-227-05

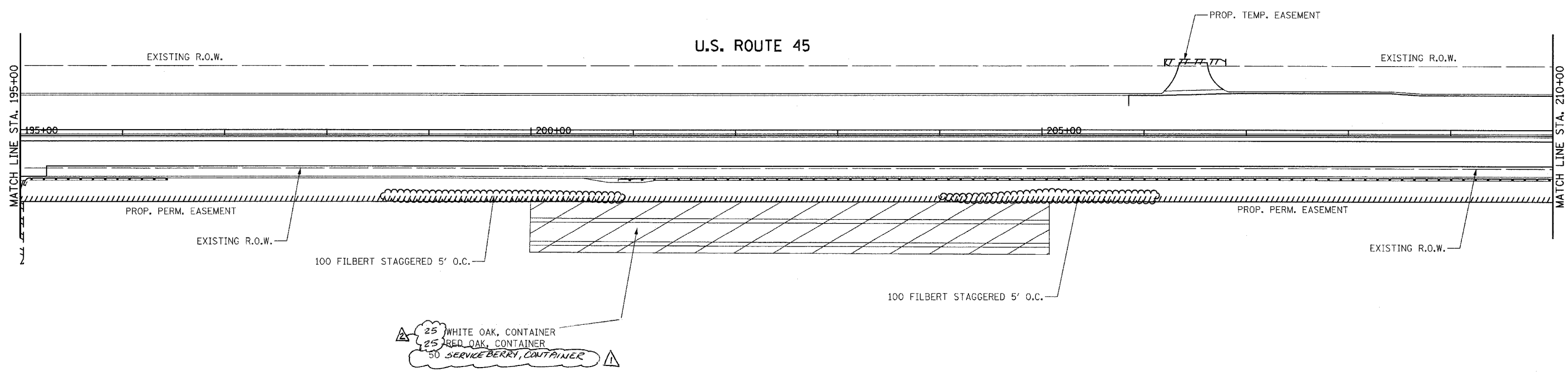
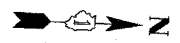

▲ 25 WHITE OAK, CONTAINER  
 ▲ 25 RED OAK, CONTAINER  
 ▲ 50 SERVICE BERRY, CONTAINER

▲ Rev. 4-11-06  
 ▲ Rev. 2-24-06

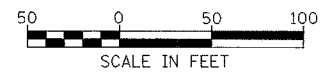

ILLINOIS DEPARTMENT OF TRANSPORTATION  
 DISTRICT NO. 1 SCHAUMBURG  
 LANDSCAPING PLAN  
 U.S. ROUTE 45  
 SCALE AS SHOWN  
 DATE OCT 25, 2005  
 DRAWN BY BSB  
 CHECKED BY CES



F&P REF.	SECTION	COUNTY	TOTAL SHEETS	SHEET NO.
330	(102 & 102X) LS	COOK	14	9
STA.	210+00	TO STA.	223+00	
FED. ROAD DIST. NO. 1	BLINDS	FED. AID PROJECT		

**D-91-227-05**

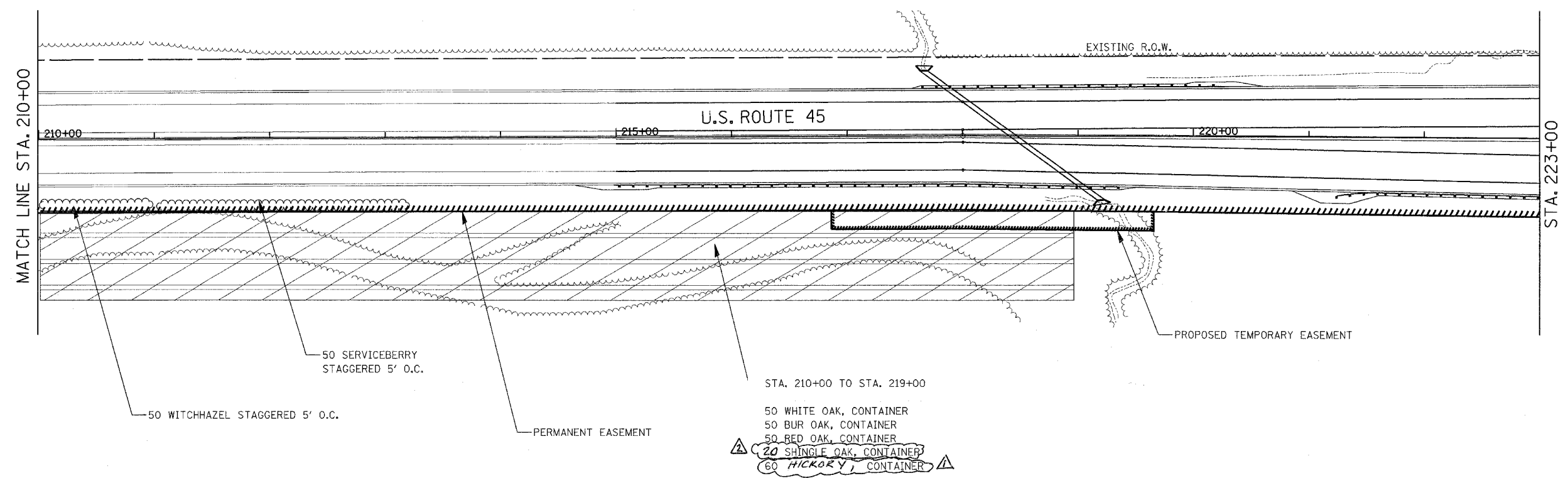
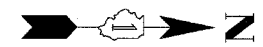

ILLINOIS DEPARTMENT OF TRANSPORTATION  
DISTRICT NO. 1 SCHAUMBURG

**LANDSCAPING PLAN**  
**U.S. ROUTE 45**

SCALE AS SHOWN DRAWN BY BSB  
DATE OCT 25, 2005 CHECKED BY CES

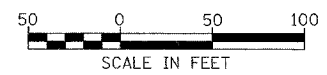

△ Rev. 4-11-06  
△ Rev. 2-24-06

TWP. #	SECTION	COUNTY	TOTAL SHEETS	SHEET NO.
330	(102 & 102X) LS	COOK	14	10
STA. 0+00	TO STA. 16+00			
FED. ROAD DIST. NO. 1	ILLINOIS	FED. AID PROJECT		

D-91-227-05

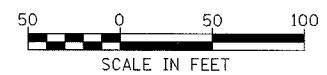
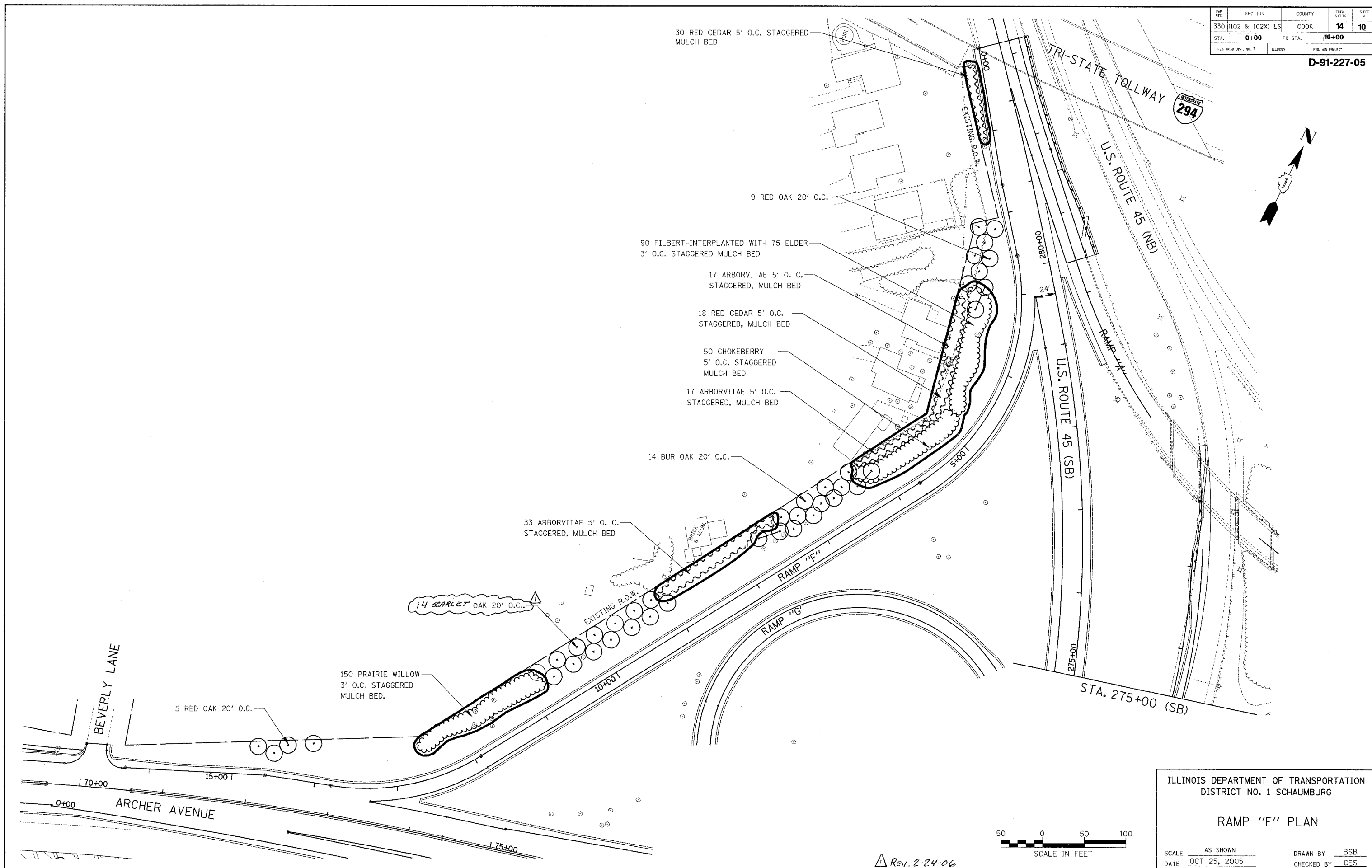
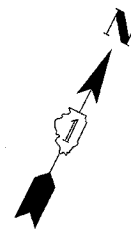

Rev. 2-24-06

ILLINOIS DEPARTMENT OF TRANSPORTATION  
DISTRICT NO. 1 SCHAUMBURG

RAMP "F" PLAN

SCALE AS SHOWN  
DATE OCT 25, 2005  
DRAWN BY BSB  
CHECKED BY CES

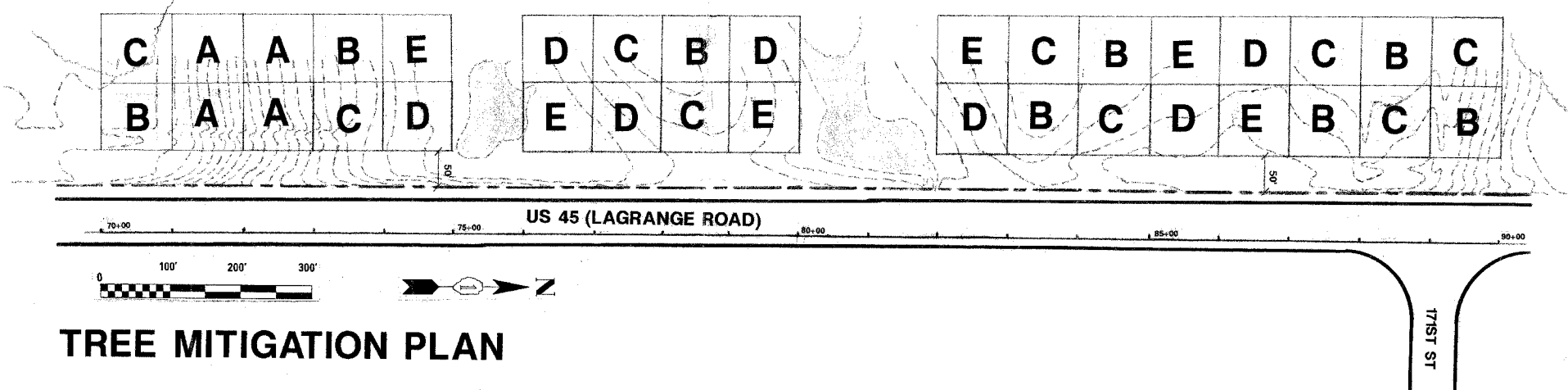

## TREE MITIGATION PLAN

NOTE: SEE SHEETS 12-14 FOR TREE GROUPING KEYS

SCHEDULE OF LANDSCAPE ITEMS (TREE MITIGATION SITE ONLY)						
ITEM	HABITAT	GROUP	QUANTITY OF GROUPS	QUANTITY PER GROUP	UNIT	TOTAL
Celtis occidentalis (Hackberry), CONTAINER GROWN, 3 GALLON	LOWLAND MESIC	D	7	10	EACH	70
Juglans nigra (Black Walnut), CONTAINER GROWN, 3 GALLON	LOWLAND MESIC	D	7	10	EACH	70
<i>Corya ovata</i> (Shagbark Hickory) <sup>△</sup> , CONTAINER GROWN, 3 GAL	UPLAND MESIC	B	8	10	EACH	80
Quercus alba (White Oak), CONTAINER GROWN, 3 GALLON	UPLAND MESIC	B	8	10	EACH	80
	UPLAND MESIC	C	9	10		90
Quercus imbricaria (Shingle Oak), CONTAINER GROWN, 3 GALLON	LOWLAND WET	E	6	10	EACH	60
<i>Quercus coccolinea</i> (Scarlet Oak) <sup>△</sup> , CONTAINER GROWN, 3 GALLON	UPLAND DRY	A	4	10	EACH	40
Quercus macrocarpa (Bur Oak), CONTAINER GROWN, 3 GALLON	UPLAND DRY	A	4	10	EACH	40
	UPLAND MESIC	B	8	10		80
	LOWLAND MESIC	D	7	10		70
	LOWLAND WET	E	6	20		120
Quercus rubra (Red Oak), CONTAINER GROWN, 3 GALLON	UPLAND MESIC	C	9	10	EACH	90
<i>Amelanchier canadensis</i> (Shadow Serviceberry) Container Grown, 3-gallon <sup>△</sup>	UPLAND MESIC	C	9	10	EACH	90
<b>TOTAL</b>					<b>EACH</b>	<b>980</b>

ILLINOIS DEPARTMENT OF TRANSPORTATION

### TREE MITIGATION PLAN

#### SCHEDULE OF QUANTITIES (TREE MITIGATION SITE)

SCALE: VERT. \_\_\_\_\_  
 HORIZ. \_\_\_\_\_

DRAWN BY \_\_\_\_\_  
 CHECKED BY \_\_\_\_\_

REVISIONS	
NAME	DATE

△ Rev. 2-24-06

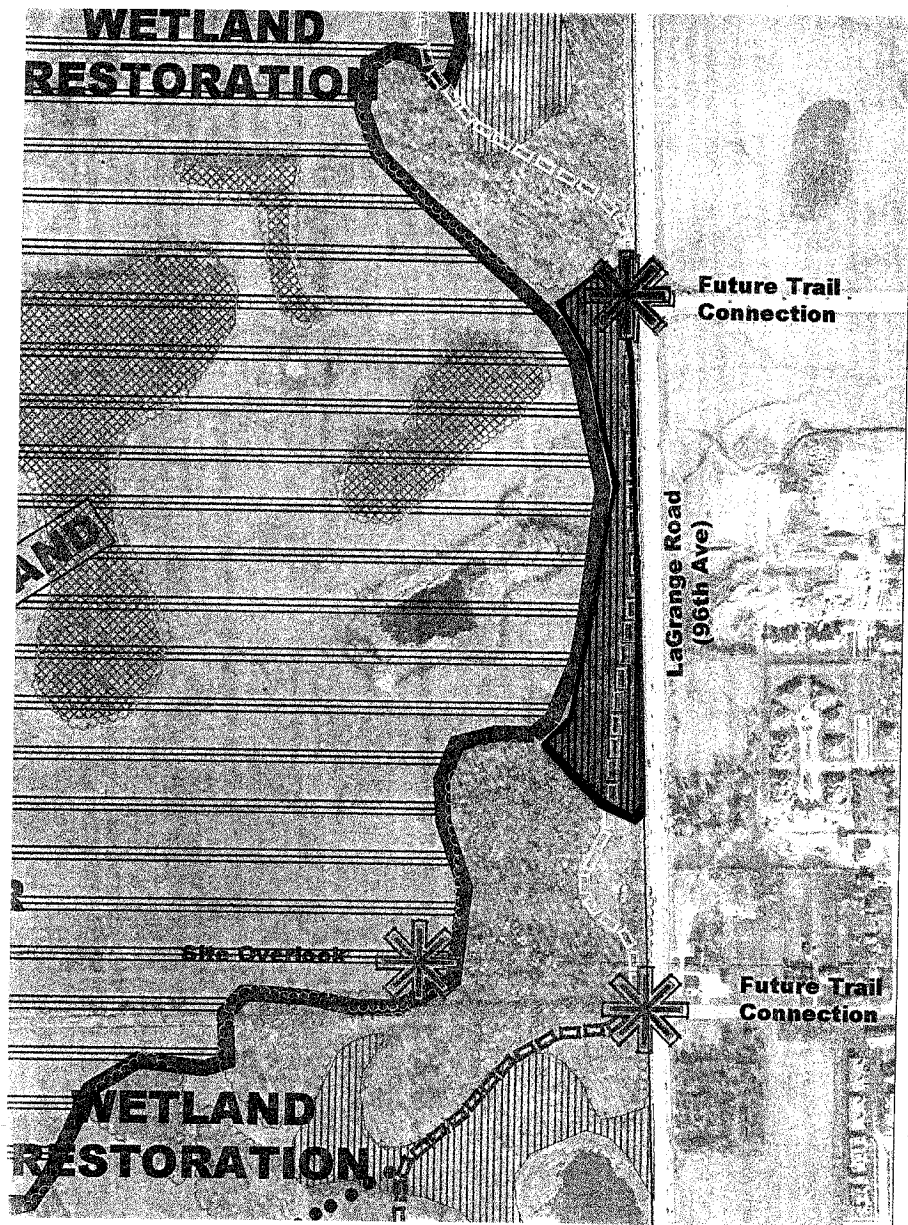

**FOREST PRESERVE DISTRICT OF COOK COUNTY**

**ORLAND TRACT DEVELOPMENT PLAN**

 GENERAL AREA OF REFORESTATION

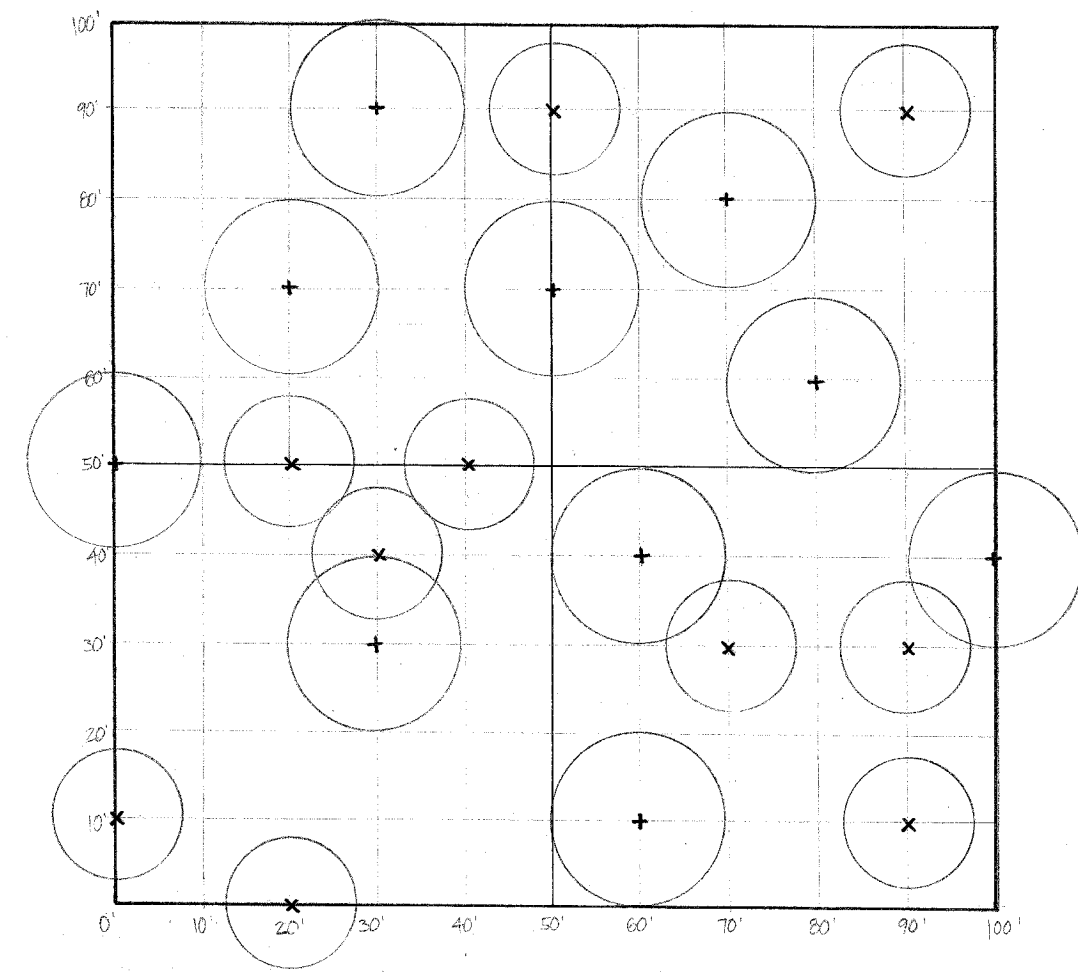

**A – UPLAND DRY**

BUR <sup>SCARLET OAK</sup> 

+ *Quercus macrocarpa* (Bur Oak)  10 Each

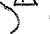
x *Quercus coccinea* (Scarlet Oak)  10 Each

Total 20 Each

 Rev. 2-24-06

REVISIONS	
NAME	DATE

ILLINOIS DEPARTMENT OF TRANSPORTATION

**FPDCC DEVELOPMENT PLAN**

**TREE GROUPING KEY A**

SCALE: VERT. \_\_\_\_\_  
 HORIZ. \_\_\_\_\_

DATE \_\_\_\_\_ DRAWN BY \_\_\_\_\_  
 CHECKED BY \_\_\_\_\_

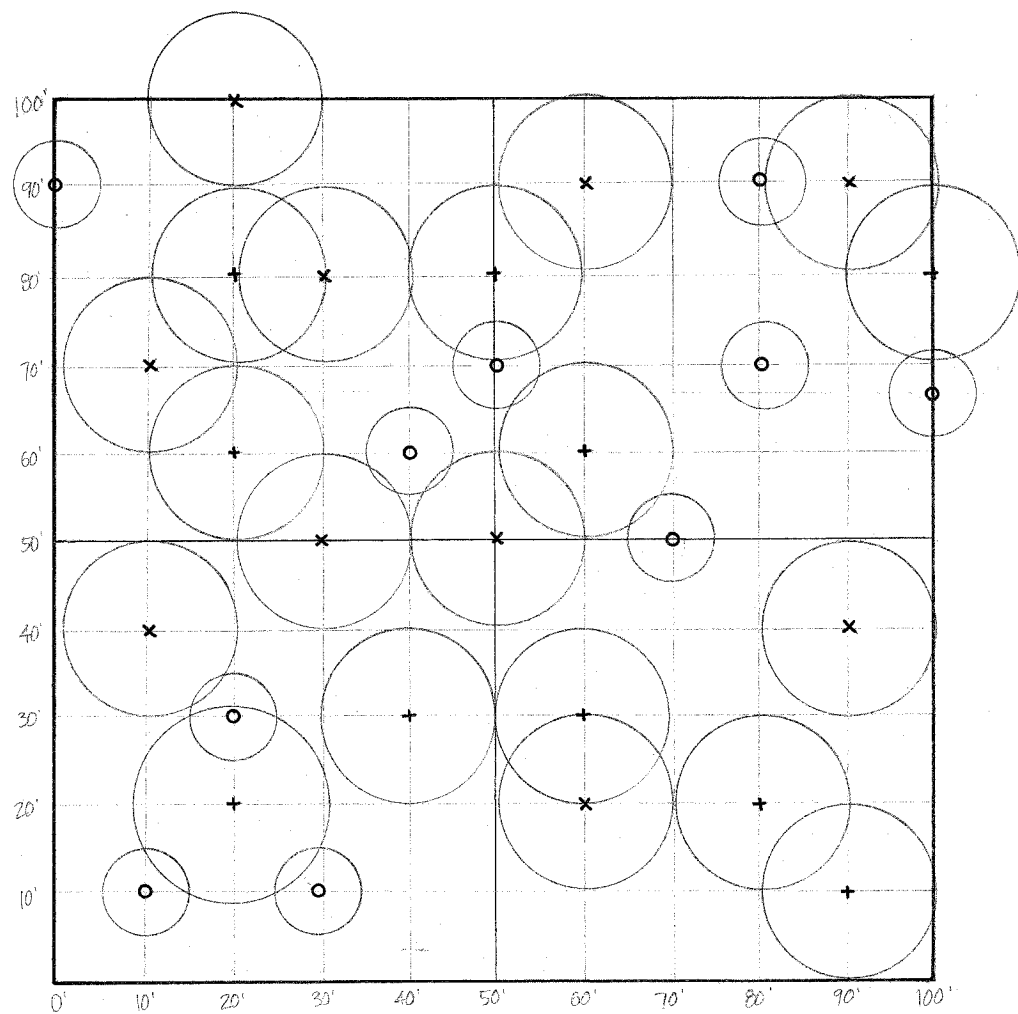

**B – UPLAND MESIC**  
**WHITE/BUR OAK**

- x *Quercus alba* (White Oak) 10 Each
  - + *Quercus macrocarpa* (Bur Oak) 10 Each
  - o *Carya ovata* (Shagbark Hickory) 10 Each
- Total 30 Each

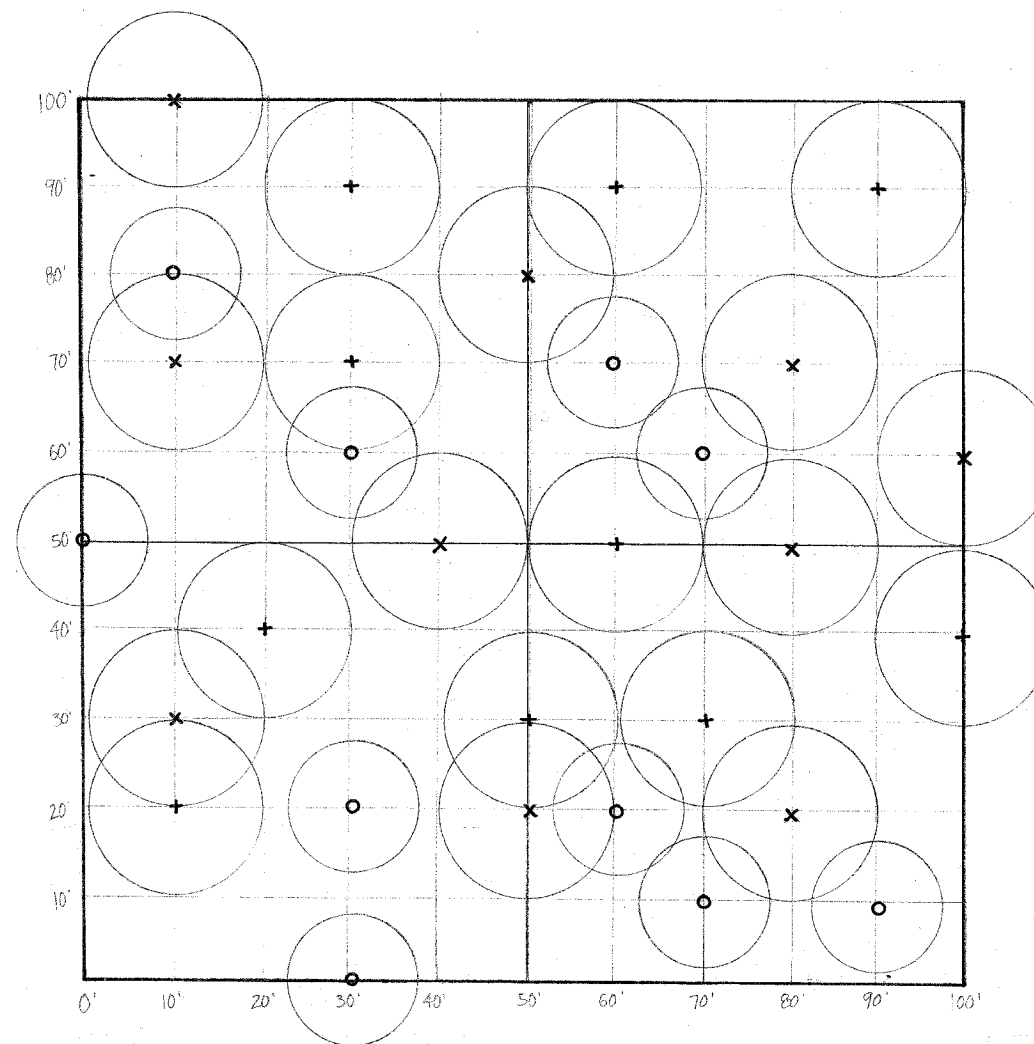

**C – UPLAND MESIC**  
**RED/WHITE OAK**

- + *Quercus rubra* (Red Oak) 10 Each
  - x *Quercus alba* (White Oak) 10 Each
  - o *Amelanchier Canadensis* (Shadblow / Servicedberry) 10 Each
- Total 30 Each

REVISIONS	
NAME	DATE

ILLINOIS DEPARTMENT OF TRANSPORTATION

**TREE GROUPING**  
**KEYS B & C**

SCALE: VERT.  
 HORIZ.  
 DATE

DRAWN BY  
 CHECKED BY

Rev. 2-24-06

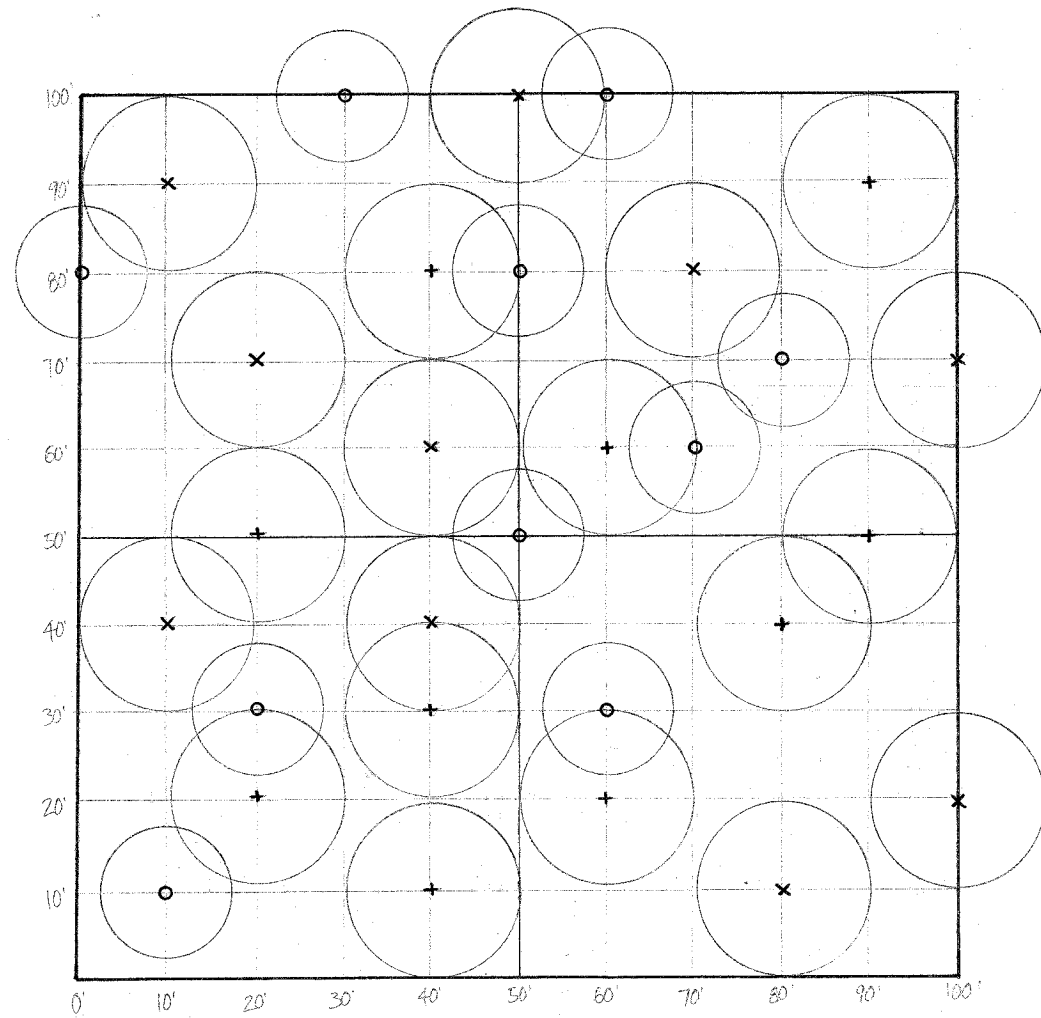

**D - LOWLAND MESIC  
WALNUT-HACKBERRY-BUR OAK**

- x *Juglans nigra* (Black Walnut) 10 Each
  - o *Celtis occidentalis* (Common Hackberry) 10 Each
  - + *Quercus macrocarpa* (Bur Oak) 10 Each
- Total 30 Each

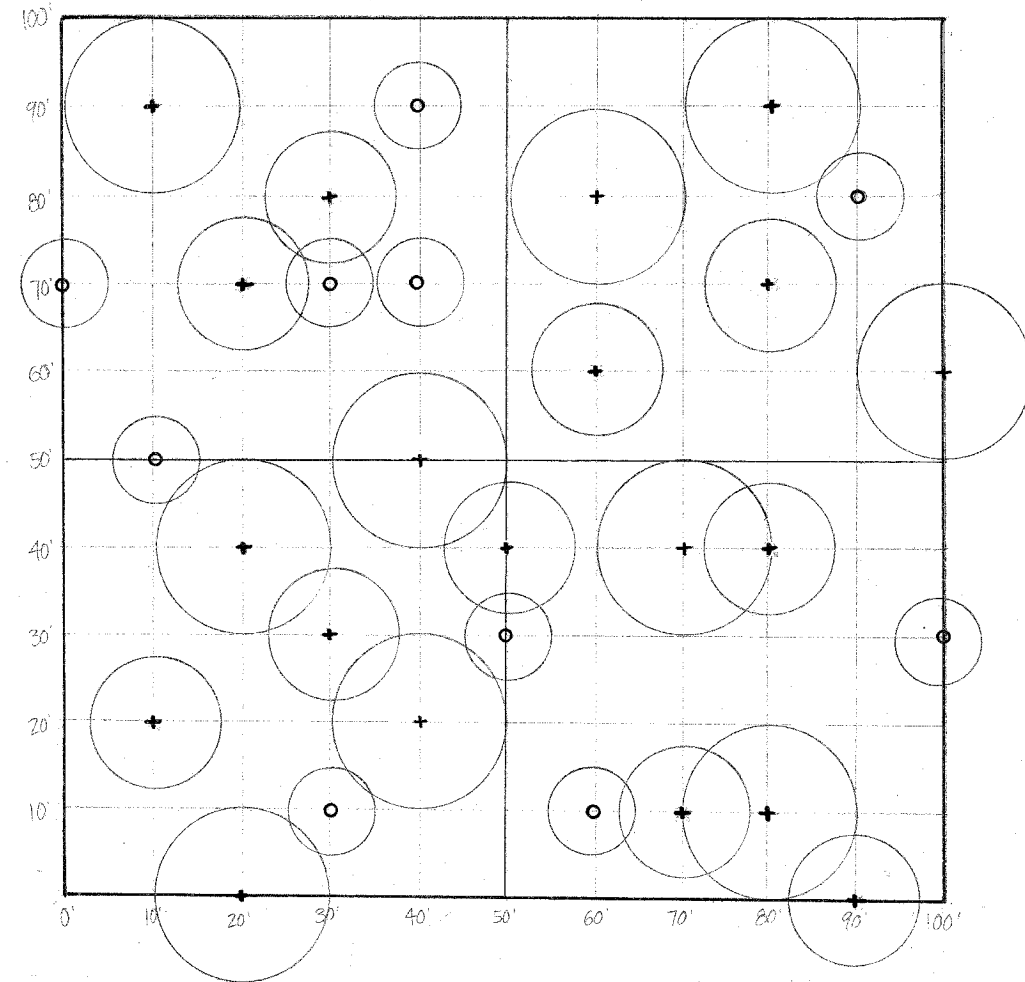

**E - LOWLAND WET  
BUR/SHINGLE OAK**

- + *Quercus macrocarpa* (Bur Oak) 20 Each
  - o *Quercus imbricaria* (Shingle Oak) 10 Each
- Total 30 Each

REVISIONS	
NAME	DATE

ILLINOIS DEPARTMENT OF TRANSPORTATION

**TREE GROUPING  
KEYS D & E**

SCALE: VERT.  
HORIZ.  
DATE

DRAWN BY  
CHECKED BY