

| F.A.P. RTE. | SECTION | COUNTY | TOTAL SHEETS | SHEET NO. |
|------------------|-----------------|------------------|--------------|-----------|
| 840 | 139 BR-1 & BR-2 | KANKAKEE | 69 | 1 |
| ILLINOIS PROJECT | | | | |
| Section 139 BR-1 | | Section 139 BR-2 | 70 Sheets | |
| P-93-032-02 | | P-93-031-02 | | |
| D-93-052-05 | | D-93-022-05 | | |

INDEX OF SHEETS - BR-1

| SHEET NO. | DESCRIPTION |
|-----------|--------------------------------|
| 1. | COMBINED COVER SHEET |
| 1A. | SIGNATURE BLOCK SHEET |
| 2. - 3. | COMBINED SUMMARY OF QUANTITIES |
| 4. - 49. | SECTION 139 BR-1 SHEETS |
| 50. - 69. | SECTION 139 BR-2 SHEETS |

STATE OF ILLINOIS
DEPARTMENT OF TRANSPORTATION
DIVISION OF HIGHWAYS
PLANS FOR PROPOSED
FEDERAL AID HIGHWAY
FAP ROUTE 840 (US 45 / 52)
SECTION 139 BR-1 & BR-2
PROJECT BHF-F-0840 (055)
KANKAKEE COUNTY
C - 93 - 020 - 05

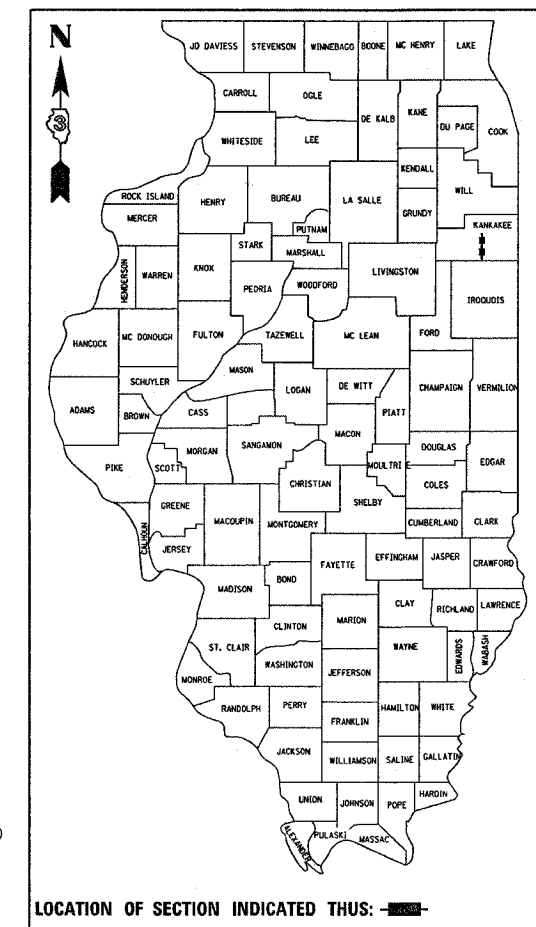

FUNCTION CLASSIFICATION - RURAL MINOR ARTERIAL
POSTED SPEED = 55 MPH
2008 ADT = 6400
P.V. = 90.4% S.U. = 5.2% M.U. = 4.4%

STATE OF ILLINOIS
DEPARTMENT OF TRANSPORTATION
DIVISION OF HIGHWAYS

SUBMITTED _____ 20____
Debra O'Keefe
 DEPUTY DIRECTOR OF HIGHWAYS, REGION ENGINEER
 December 8, 2006
Eric E. Hahn
 ENGINEER OF DESIGN AND ENVIRONMENT
 December 8, 2006
Milton R. Sears, P.E.
 DIRECTOR OF HIGHWAYS, CHIEF ENGINEER

PRINTED BY THE AUTHORITY
 OF THE STATE OF ILLINOIS

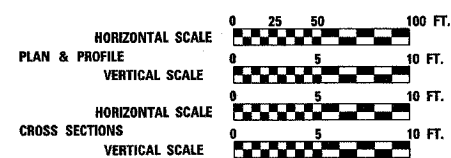

FULL SIZE PLANS HAVE BEEN PREPARED USING STANDARD ENGINEERING SCALES, REDUCED SIZED PLANS WILL NOT CONFORM TO STANDARD SCALES, IN MAKING MEASUREMENTS ON REDUCED PLANS, THE ABOVE SCALES MAY BE USED.

MICROFILMED _____
 REEL NUMBER _____
 AWARDED _____
 RESIDENT ENGINEER _____
 AS BUILT CHANGES WERE MADE _____
 ON THE FOLLOWING SHEETS _____

JULIE 1-800-892-0123

DISTRICT 3 NO. (815) 434-6131

PROJECT ENGINEER: JOE KANNEL
UNIT CHIEF: PAT BRABOY
TOWNSHIP: OTTO

CONTRACT NO. 66543

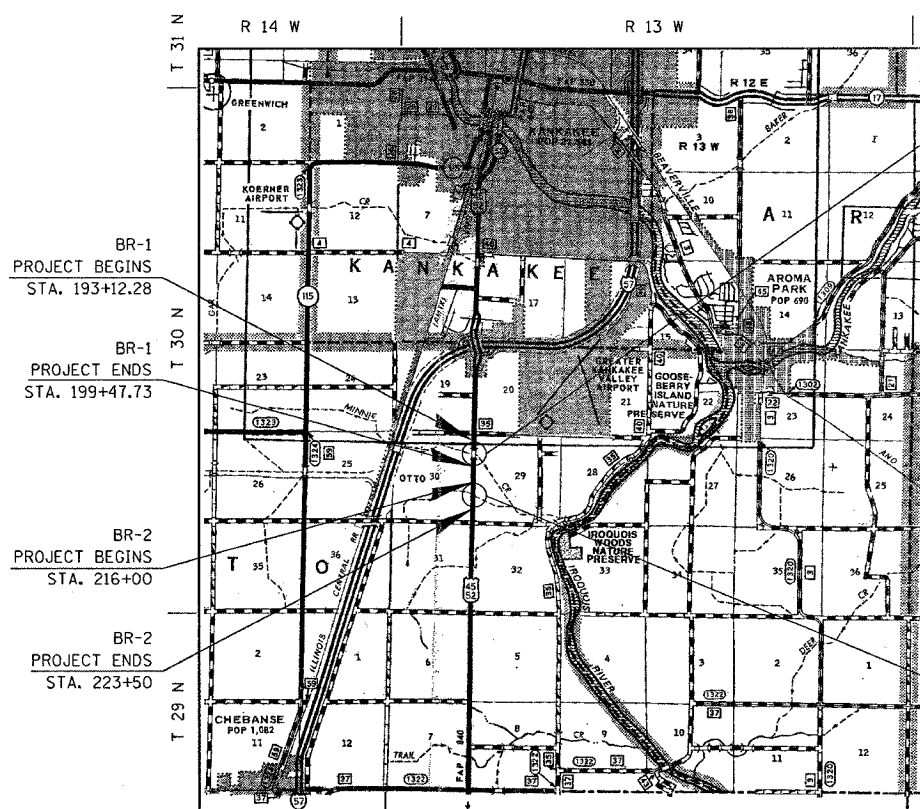

BR-1
 CONSISTS OF REMOVING THE EXISTING STRUCTURE'S SUPERSTRUCTURE AND BACKWALL (SN 046-0070) AT STA. 196+30 AND REPLACE WITH PRECAST PRESTRESSED CONCRETE DECK BEAM (17" DEPTH) AND PORTLAND CEMENT CONCRETE WEARING SURFACE 5" AND RELATED ROADWAY WORK.

BR-2
 REPLACE BRIDGE 046-0098 WITH DOUBLE BOX CULVERT STA. 219.25

LOCATION MAP
NOT TO SCALE

TOTAL GROSS LENGTH = 2343.13 FT. = 0.442 MI.
TOTAL NET LENGTH = 2343.13 FT. = 0.442 MI.