

F.A.P. RTE.	SECTION	COUNTY	TOTAL SHEETS	SHEET NO.
840	139 BR-2	KANKAKEE	69	50

P-93-031-02
D-93-022-05

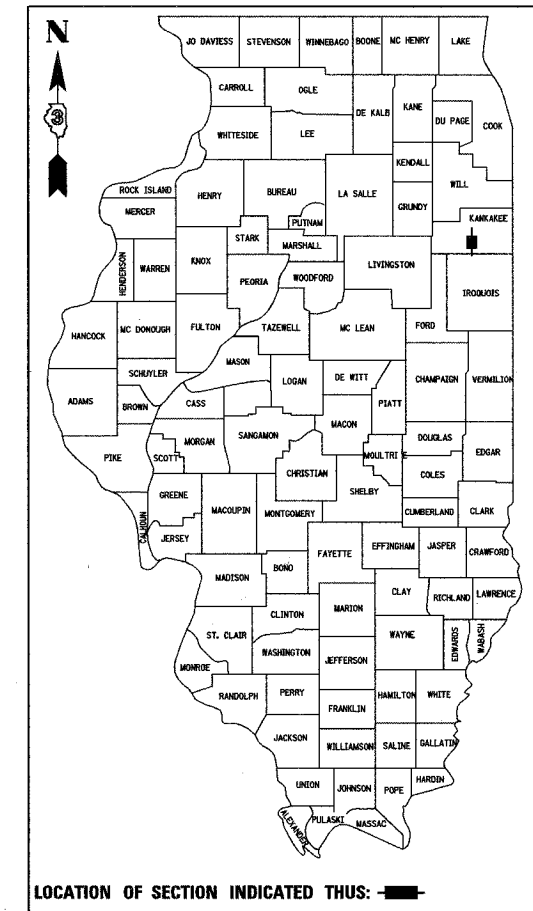

STATE OF ILLINOIS

DEPARTMENT OF TRANSPORTATION

DIVISION OF HIGHWAYS

PLANS FOR PROPOSED FEDERAL AID HIGHWAY

FAP ROUTE 840 (US 45/52)

SECTION 139 BR-2

PROJECT

KANKAKEE COUNTY

INDEX OF SHEETS

1. COVER SHEET
2. GENERAL NOTES & STD. LIST
3. SUMMARY OF QUANTITIES
4. TYPICAL SECTIONS
5. SCHEDULE OF QUANTITIES
- 6.-8. PLAN & PROFILE SHEETS
9. DETOUR PLAN
10. MISCELLANEOUS DETAILS
11. EROSION & SEDIMENT CONTROL
12. RIGHT-OF-WAY PLAN
13. GENERAL PLAN & ELEVATION, DOUBLE 7x7 BOX CULVERT
14. DOUBLE 7'x7' BOX CULVERT END SECTION & WINGWALLS
15. SOIL BORINGS
16. EXISTING STRUCTURE PLANS
- 17.-20. CROSS SECTIONS

HIGHWAY STANDARDS
SEE SHEET 2

C - 93 - 020 - 05

**STRUCTURE REPLACEMENT AT UNNAMED TRIBUTARY OF MINNIE CREEK
1.6 MILES SOUTH OF I-57**

R. 12 E., 3rd P.M.

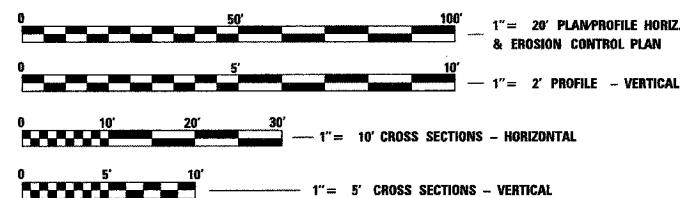

FULL SIZE PLANS HAVE BEEN PREPARED USING STANDARD ENGINEERING SCALES, REDUCED SIZED PLANS WILL NOT CONFORM TO STANDARD SCALES, IN MAKING MEASUREMENTS ON REDUCED PLANS, THE ABOVE SCALES MAY BE USED.

MICROFILMED _____
REEL NUMBER _____
AWARDED _____
RESIDENT ENGINEER _____
AS BUILT CHANGES WERE MADE
ON THE FOLLOWING SHEETS _____

JULIE 1-800-892-0123

DISTRICT 3 NO. (815) 434-6131

PROJECT ENGINEER: DAN DRAPER
UNIT CHIEF: PAT BRABOY
TOWNSHIP: OTTO

CONTRACT NO. 66543

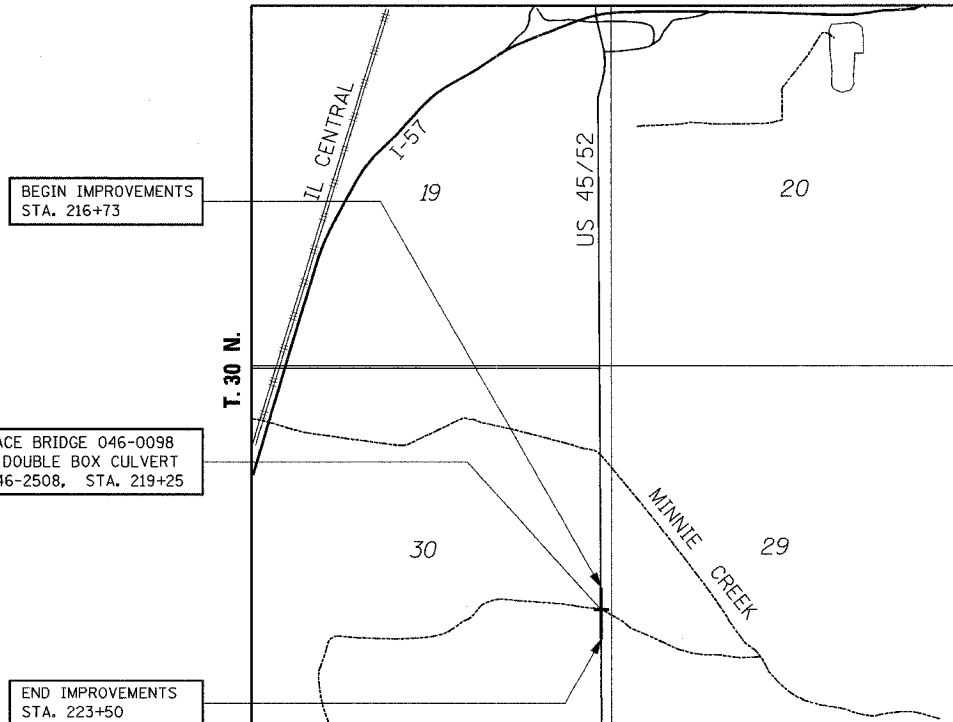

LOCATION MAP
NOT TO SCALE

GROSS LENGTH = 677 FT. = 0.128 MI.
NET LENGTH = 677 FT. = 0.128 MI.

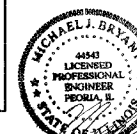

MICHAEL J. BRYANT, P.E., S.E. DATE 3/28/06
IL. LICENSED PROFESSIONAL ENGINEER
ILLINOIS NO. 44543 EXPIRES NOVEMBER 30, 2007

FUNCTION CLASSIFICATION	RURAL MINOR ARTERIAL
DESIGN SPEED	55 MPH
POSTED SPEED	55 MPH
ADT	6400 (2008); 7700 (2018)
P.V.	90.4%
S.U.	5.2%
M.U.	4.4%

STATE OF ILLINOIS
DEPARTMENT OF TRANSPORTATION
DIVISION OF HIGHWAYS

SUBMITTED _____ 20 _____
DEPUTY DIRECTOR OF HIGHWAYS, REGION ENGINEER

SUBMITTED _____ 20 _____
ENGINEER OF DESIGN AND ENVIRONMENT

DIRECTOR OF HIGHWAYS, CHIEF ENGINEER

PRINTED BY THE AUTHORITY
OF THE STATE OF ILLINOIS