

F.A.P. RTE.	SECTION	COUNTY	TOTAL SHEETS	SHEET NO.
607	(124)TS-1	LASALLE	3	1

STATE OF ILLINOIS  
DEPARTMENT OF TRANSPORTATION  
DIVISION OF HIGHWAYS

**PROPOSED  
HIGHWAY PLANS**

FAP ROUTE 607 (US 52)  
SECTION (124)TS-1

LASALLE COUNTY

C - 93 - 014 - 07

INSTALL 2 YELLOW ADVANCE FLASHERS ON  
US RTE 52 AT THE INTERSECTION OF HOXSEY ROAD (CH 2)

INDEX OF SHEETS

- 1 COVER SHEET
- 2 GENERAL NOTES AND SUMMARY OF QUANTITIES
- 3 FLASHER PLANS

STANDARDS

- 000001-04 STANDARD SYMBOLS, ABBREVIATIONS AND PATTERNS
- 701001-01 OFF-ROAD OPERATIONS 2L, 2W, MORE THAN 4.5 m (15') AWAY
- 701006-02 OFF-ROAD OPERATIONS 2L, 2W, 4.5 m (15') TO 600 mm (24") FROM PAVEMENT EDGE
- 701201-02 LANE CLOSURE, 2L, 2W, DAY ONLY, FOR SPEEDS ≥ 45 MPH
- 701301-02 LANE CLOSURE, 2L, 2W, SHORT TIME OPERATIONS
- 702001-06 TRAFFIC CONTROL DEVICES
- 814001-01 HANDHOLES
- 880001 SPAN WIRE MOUNTED SIGNALS AND FLASHING BEACON INSTALLATION



FUNCTIONAL CLASSIFICATION  
RURAL - OTHER PRINCIPAL ARTERIAL  
FAP 607 (US ROUTE 52)  
2005 ADT = 2100  
P.V. = 79.3% M.U. = 4.8% S.U. = 7.1%

PROJECT LOCATION

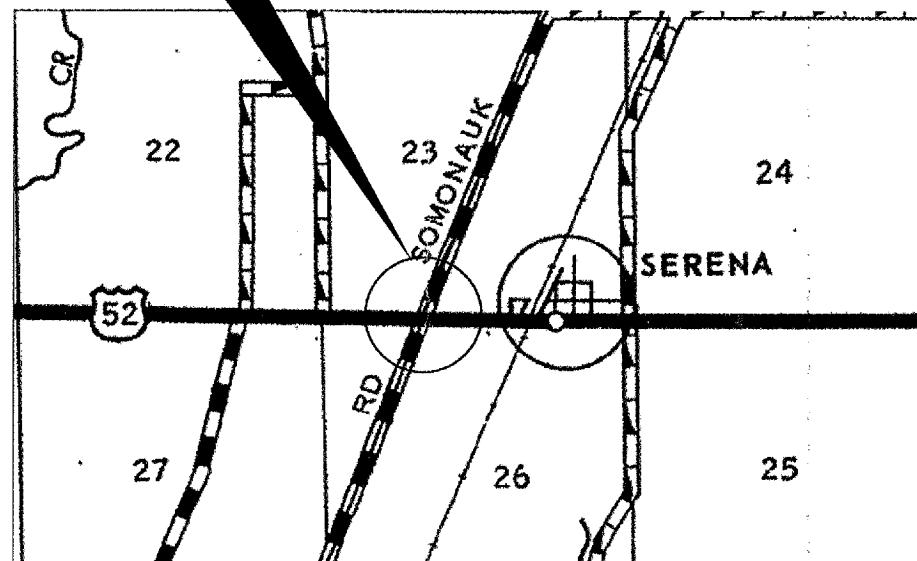

LOCATION MAP

NOT TO SCALE  
SPOT IMPROVEMENT

MICROFILMED \_\_\_\_\_  
REEL NUMBER \_\_\_\_\_  
AWARDED \_\_\_\_\_  
RESIDENT ENGINEER \_\_\_\_\_  
AS BUILT CHANGES WERE MADE  
ON THE FOLLOWING SHEETS \_\_\_\_\_

J.U.L.I.E.  
JOINT UTILITY LOCATION INFORMATION FOR EXCAVATION  
1-800-892-0123

DISTRICT 3 NO. (815) 434-6131

PROJECT ENGINEER: TOM HUFNAGEL  
UNIT CHIEF: DAN DEVINE

CONTRACT NO. 66693

STATE OF ILLINOIS  
DEPARTMENT OF TRANSPORTATION  
DIVISION OF HIGHWAYS

SUBMITTED *October 26, 1999*  
*Don O'Keefe, P.E.*  
DEPUTY DIRECTOR OF HIGHWAYS, REGION ENGINEER

*December 8, 2006*  
*Eric E. Horn, P.E.*  
ENGINEER OF DESIGN AND ENVIRONMENT

*December 8, 2006*  
*Milton R. Sees, P.E.*  
DIRECTOR OF HIGHWAYS, CHIEF ENGINEER

PRINTED BY THE AUTHORITY  
OF THE STATE OF ILLINOIS

F.A.P. RTE.	SECTION	COUNTY	TOTAL SHEETS	SHEET NO.
607	(124)TS-1	LASALLE	3	2
STA.		TO STA.		
FED. ROAD DIST. NO.	ILLINOIS	FED. AID PROJECT		

**GENERAL NOTES**

1. THE CONTRACTOR SHALL VERIFY THE EXACT LOCATION OF ALL UNDERGROUND UTILITIES PRIOR TO BEGINNING CONSTRUCTION. (J.U.L.I.E. 800-892-0123, LASALLE COUNTY, SERENA TOWNSHIP)
2. A 1/4" DIAMETER CONTINUOUS NYLON ROPE SHALL BE FURNISHED AND LEFT IN PLACE IN ALL CONDUITS BETWEEN HANDHOLES AND FLASHER CONTROLLER, AS INCIDENTAL TO THE RESPECTIVE CABLE PAY ITEMS.
3. THE CONTRACTOR SHALL CONTACT ILLINOIS POWER (800-755-5000) PRIOR TO BEGINNING WORK FOR THE UTILITY COMPANY REQUIREMENTS.

**SUMMARY OF QUANTITIES**

CONSTRUCTION CODE TYPE: Y031-1F			
CODE NO.	ITEM	UNIT	RURAL 100% STATE TOTAL QUANTITY
67100100	MOBILIZATION	L SUM	1
70100450	TRAFFIC CONTROL AND PROTECTION, STANDARD 701201	L SUM	1
81012500	CONDUIT IN TRENCH, 1 1/2 " DIA., PVC	FOOT	970
81018500	CONDUIT PUSHED, 2" DIA., GALVANIZED STEEL	FOOT	225
81100500	CONDUIT ATTACHED TO STRUCTURE, 1 1/2" DIA., GALVANIZED STEEL	FOOT	32
81400700	HANDHOLE, PORTLAND CEMENT CONCRETE	EACH	5
81900200	TRENCH AND BACKFILL FOR ELECTRICAL WORK	FOOT	1240
85000500	MAINTENANCE OF EXISTING FLASHING BEACON INSTALLATION	EACH	1
85800100	FLASHER CONTROLLER	EACH	1
87301215	ELECTRIC CABLE IN CONDUIT, SIGNAL NO. 14 2C	FOOT	1260
88040030	SIGNAL HEAD, POLYCARBONATE, LED, 1-FACE, 1-SECTION, POST MOUNTED	EACH	2
X8950065	REMOVE EXISTING FLASHER CONTROLLER	EACH	1

STATE OF ILLINOIS  
DEPARTMENT OF TRANSPORTATION  
DISTRICT THREE

PREPARED BY: Bruce A. Hoken  
DISTRICT OPERATIONS ENGINEER

DATE: 10-26-06

EXAMINED BY: R. Powell  
DISTRICT STUDIES & PLANS ENGINEER

Harli Jones  
DISTRICT CONSTRUCTION ENGINEER

Matt Jenks  
DISTRICT MATERIALS ENGINEER

REVISIONS	
NAME	DATE

ILLINOIS DEPARTMENT OF TRANSPORTATION  
**GENERAL NOTES  
AND  
SUMMARY OF QUANTITIES**

SCALE: VERT. \_\_\_\_\_  
          HORIZ. \_\_\_\_\_  
DATE \_\_\_\_\_

DRAWN BY \_\_\_\_\_  
CHECKED BY \_\_\_\_\_

F.A.P. RTE.	SECTION	COUNTY	TOTAL SHEETS	SHEET NO.
607	(124)TS-1	LASALLE	3	3
STA.		TO STA.		
FED. ROAD DIST. NO.		ILLINOIS FED. AID PROJECT		



**CABLE PLAN**

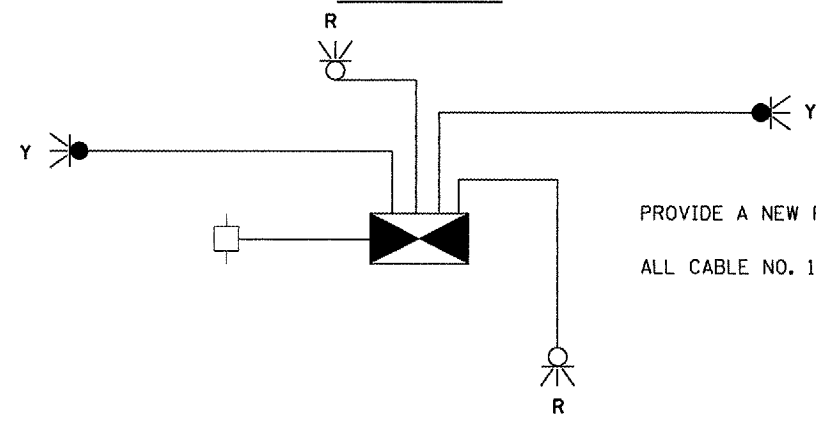

PROVIDE A NEW FLASHER CONTROLLER CABINET.  
ALL CABLE NO. 14 2/C UNLESS NOTED ELSEWHERE.

INSTALL PROP. 12" LED YELLOW FLASHER AND 1/2" GALV. STEEL CONDUIT (12') ATTACHED TO STRUCTURE ON EXIST. SIGN POST. ADAPTORS INCIDENTAL TO CONDUIT.

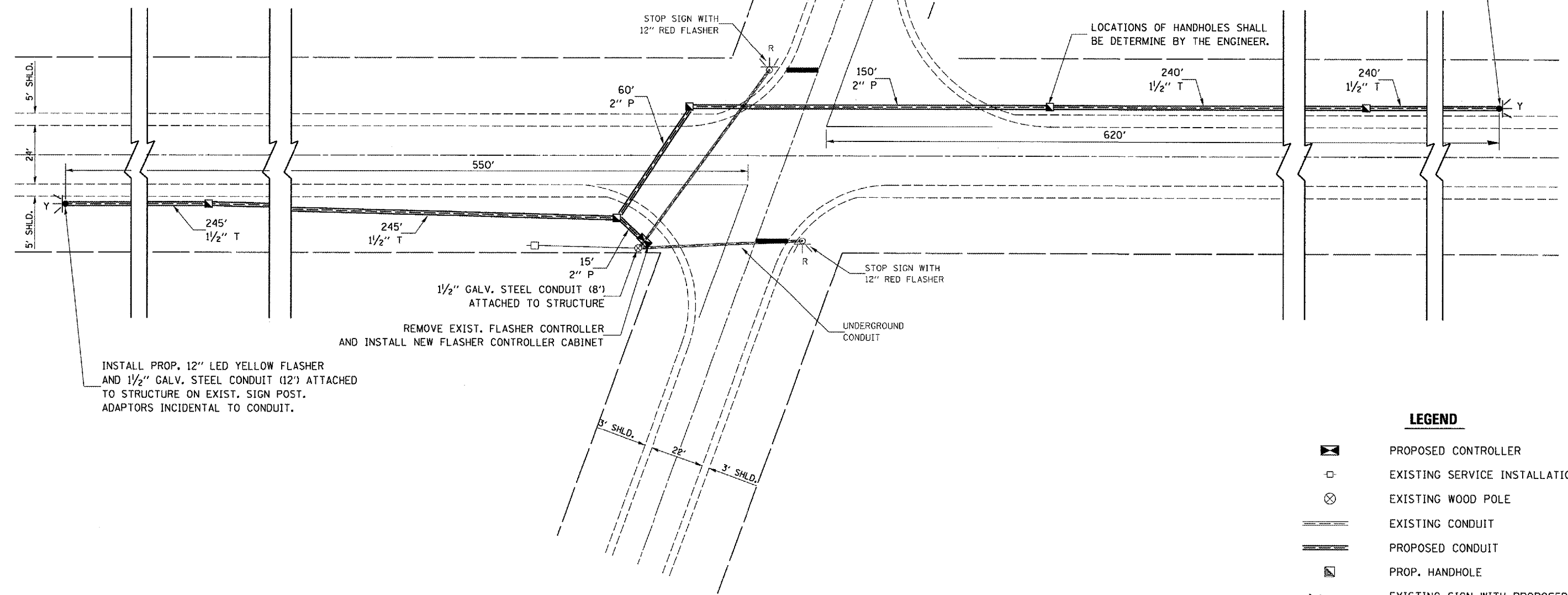

INSTALL PROP. 12" LED YELLOW FLASHER AND 1/2" GALV. STEEL CONDUIT (12') ATTACHED TO STRUCTURE ON EXIST. SIGN POST. ADAPTORS INCIDENTAL TO CONDUIT.

REMOVE EXIST. FLASHER CONTROLLER AND INSTALL NEW FLASHER CONTROLLER CABINET

1/2" GALV. STEEL CONDUIT (8') ATTACHED TO STRUCTURE

UNDERGROUND CONDUIT

**LEGEND**

- PROPOSED CONTROLLER
- EXISTING SERVICE INSTALLATION
- EXISTING WOOD POLE
- EXISTING CONDUIT
- PROPOSED CONDUIT
- PROP. HANDHOLE
- EXISTING SIGN WITH PROPOSED 12" LED YELLOW FLASHER
- EXISTING SIGN WITH EXISTING 12" LED RED FLASHER

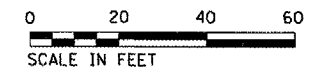

10/26/2006 8:59:05 AM c:\p0\ecrs\6607407\01\stheers.dgn