

F.A.P. RTE.	SECTION	COUNTY	TOTAL SHEETS	SHEET NO.
315	(34-6,55-1)	HANCOCK/MCDONOUGH	433	70
STA. 1445+00		TO STA. 52+00		
FED. ROAD DIST. NO.		ILLINOIS FED. AID PROJECT		
STATE CONTRACT NO. 68206				

MAINTENANCE OF TRAFFIC STAGE 1

SEQUENCE OF CONSTRUCTION

- BUILD TR 257 TEMPORARY WIDENING ON LT SIDE BY USING TEMPORARY PIPE & GRANULAR EMBANKMENT (SEE CROSS-SECTIONS)
- INSTALL TEMPORARY PIPE WITH 6' MINIMUM IN DOWNSTREAM END OF BOX CULVERT - BACKFILL W/ GRANULAR EMBANKMENT.
- TRANSFER TRAFFIC TO TEMP WIDENING, REMOVE PORTION OF EX BOX CULVERT, CONSTRUCT PORTION OF PR PIPE CULVERT, BACKFILL TO EX EDGE OF TR 257.
- TRANSFER TRAFFIC BACK TO TR 257, REMOVE TEMPORARY PIPE, REMAINDER OF EX BOX CULVERT, COMPLETE CONSTRUCTION OF PR PIPE CULVERT, COMPLETE CONSTRUCTION OF TR 257 WITH GRANULAR EMBANKMENT
- BUILD TR 28
- BUILD SERVICE DR #1
- BUILD A TEMPORARY CONNECTION TO MAINTAIN ACCESS TO RELOCATED TR 28
- BUILD FUTURE WESTBOUND IL 336 FROM STA 1445+00 TO STA 52+00
- BUILD FUTURE EASTBOUND IL 336 FROM STA 1445+00 TO STA 10+00
- BUILD FUTURE EASTBOUND IL 336 FROM STA 37+00 TO STA 52+00
- BUILD TEMPORARY IL 61 DETOUR
- GRADE EASTBOUND IL 336 FROM STA 10+00 TO STA 37+00 (SEE TYPICAL SECTION AT BOTTOM OF SHEET)

TRAFFIC PLACEMENT

- MAINTAIN WESTBOUND & EASTBOUND TRAFFIC ON EXISTING US 136
- MAINTAIN TRAFFIC ON TR 257 WITH TEMPORARY WIDENING.
- STAGE CONSTRUCT PROPOSED CULVERT AND TR 257
- TR 28 TRAFFIC TO USE EXISTING TR 28 UNTIL RELOCATED TR 28 AND TEMPORARY CONNECTION IS BUILT
- PLACE TRAFFIC ON RELOCATED TR 28 AND ON THE TEMPORARY CONNECTION TO MAINTAIN ACCESS

TRAFFIC CONTROL STANDARDS

701001 701006 701011 701326

PAYMENT

TRAFFIC CONTROL AND PROTECTION, STANDARD 701326

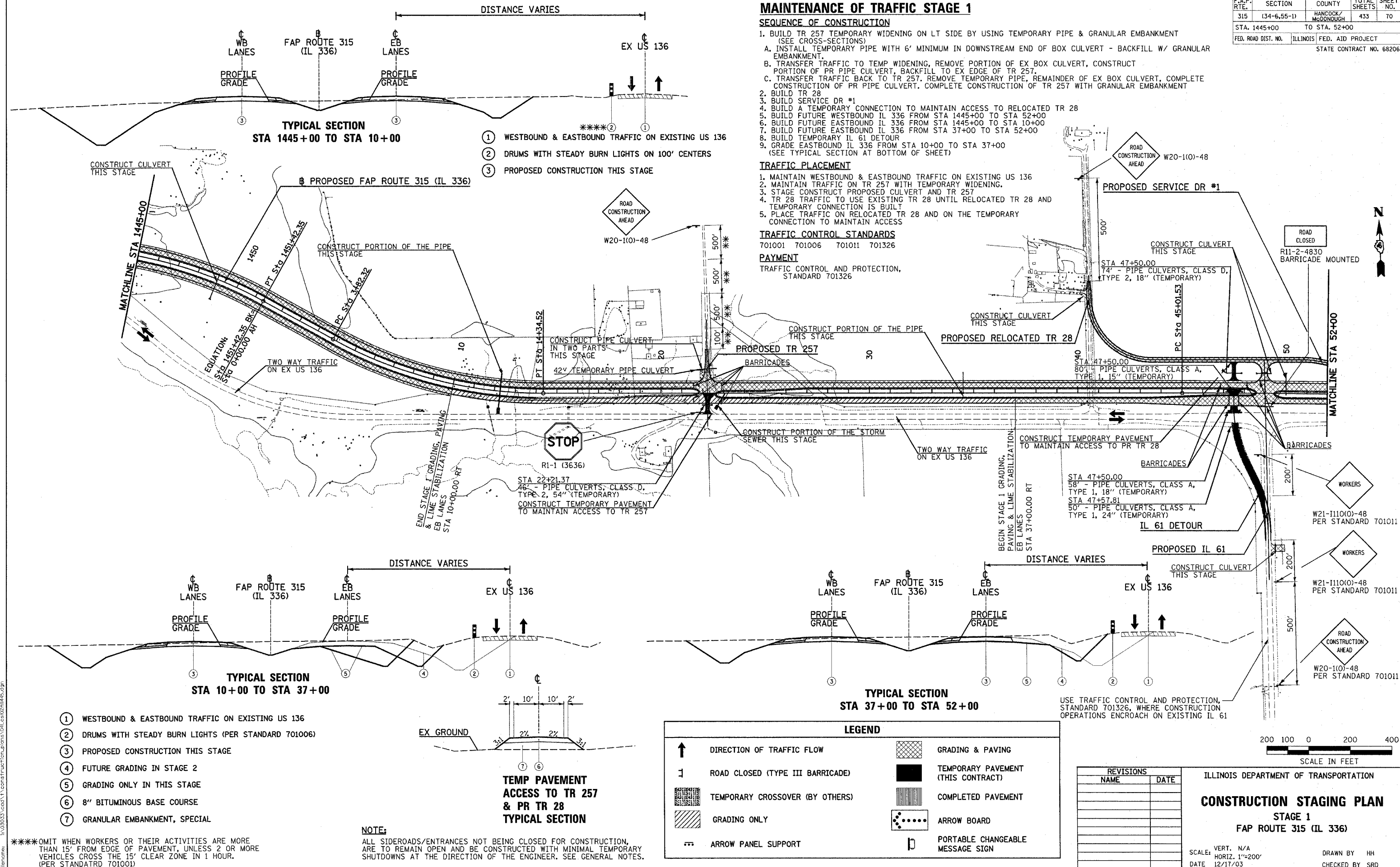

**TYPICAL SECTION
STA 1445+00 TO STA 10+00**

**TYPICAL SECTION
STA 10+00 TO STA 37+00**

**TYPICAL SECTION
STA 37+00 TO STA 52+00**

- WESTBOUND & EASTBOUND TRAFFIC ON EXISTING US 136
- DRUMS WITH STEADY BURN LIGHTS ON 100' CENTERS
- PROPOSED CONSTRUCTION THIS STAGE

- WESTBOUND & EASTBOUND TRAFFIC ON EXISTING US 136
- DRUMS WITH STEADY BURN LIGHTS (PER STANDARD 701006)
- PROPOSED CONSTRUCTION THIS STAGE
- FUTURE GRADING IN STAGE 2
- GRADING ONLY IN THIS STAGE
- 8" BITUMINOUS BASE COURSE
- GRANULAR EMBANKMENT, SPECIAL

**TEMP PAVEMENT
ACCESS TO TR 257
& PR TR 28
TYPICAL SECTION**

NOTE:
ALL SIDEROADS/ENTRANCES NOT BEING CLOSED FOR CONSTRUCTION, ARE TO REMAIN OPEN AND BE CONSTRUCTED WITH MINIMAL TEMPORARY SHUTDOWNS AT THE DIRECTION OF THE ENGINEER. SEE GENERAL NOTES.

LEGEND	
↑	DIRECTION OF TRAFFIC FLOW
⌄	ROAD CLOSED (TYPE III BARRICADE)
▨	TEMPORARY CROSSOVER (BY OTHERS)
▧	GRADING ONLY
→	ARROW PANEL SUPPORT
▩	GRADING & PAVING
■	TEMPORARY PAVEMENT (THIS CONTRACT)
▨	COMPLETED PAVEMENT
⋯	ARROW BOARD
⌄	PORTABLE CHANGEABLE MESSAGE SIGN

REVISIONS	
NAME	DATE

ILLINOIS DEPARTMENT OF TRANSPORTATION

CONSTRUCTION STAGING PLAN

STAGE 1

FAP ROUTE 315 (IL 336)

SCALE: VERT. N/A
HORIZ. 1"=200'
DATE 12/17/03

DRAWN BY HH
CHECKED BY SRD

Plot Date: 7/18/2006
Plot Time: 3:25:38 PM
Plotted By: brcmndt
Pen Table: 1000000
Filename: \\s03033\c001\1\construction\p03033\04\c002\m045.dgn