

F.A.P. RTE.	SECTION	COUNTY	TOTAL SHEETS	SHEET NO.
315	(34-6,55-1)	HANCOCK/MCDONOUGH	433	76
STA. 112+00		TO STA. 128+00		
FED. ROAD DIST. NO.	ILLINOIS	FED. AID PROJECT		
STATE CONTRACT NO. 68206				

NOTE:
COORDINATION IS REQUIRED FOR TRAFFIC CONTROL WHERE CONTRACTS MEET.
(SEE SPECIAL PROVISIONS)

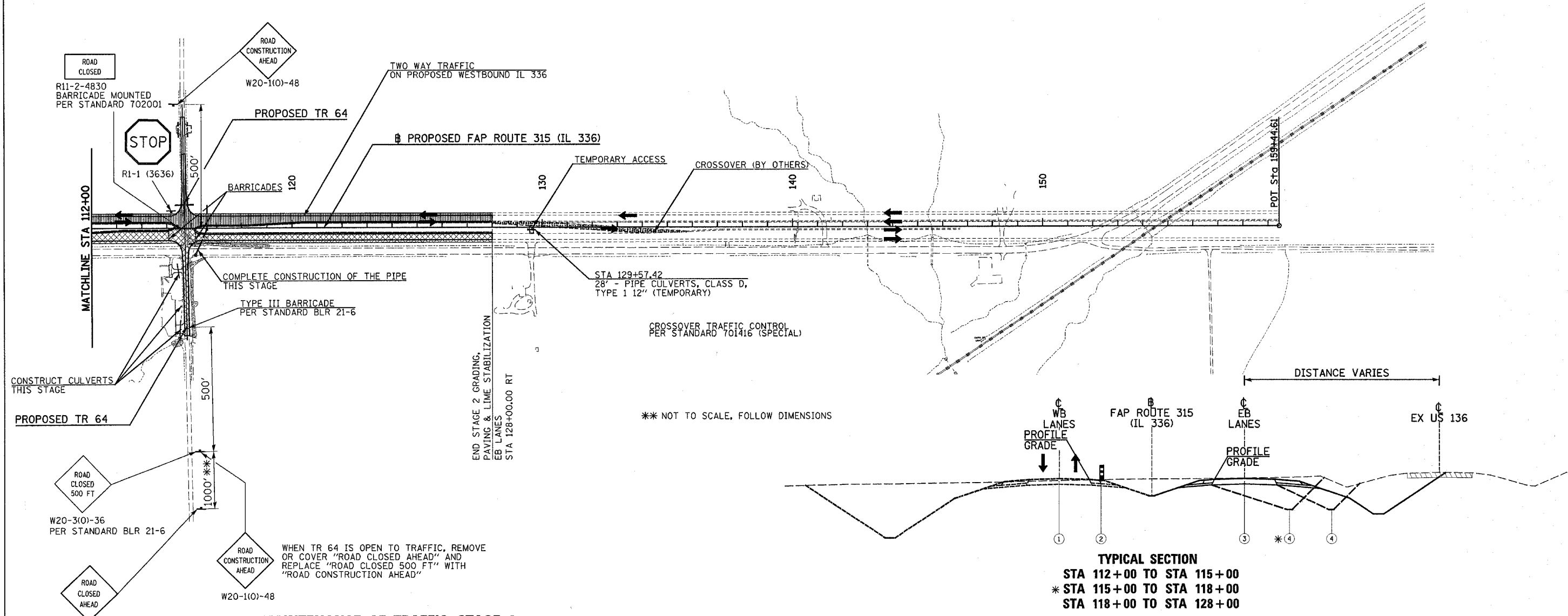

*** NOT TO SCALE, FOLLOW DIMENSIONS

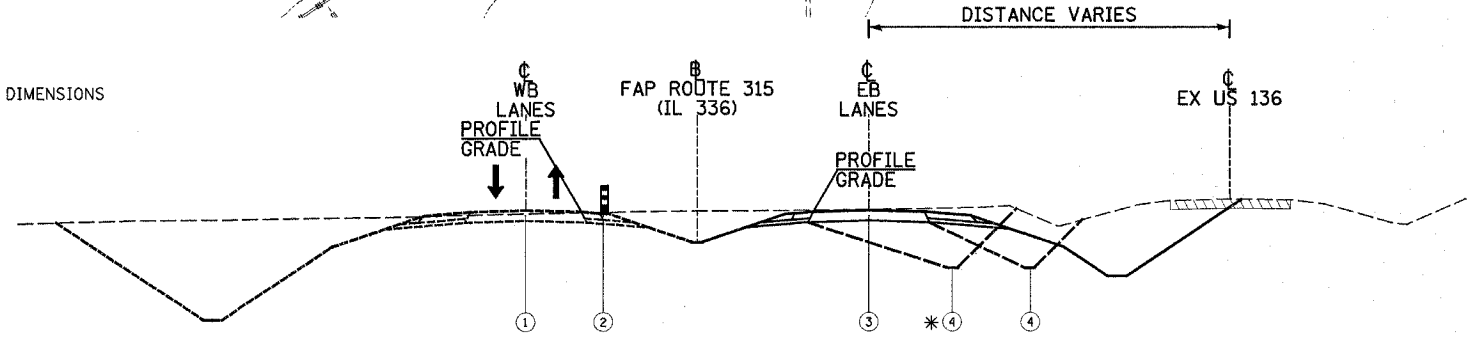

- ① WESTBOUND & EASTBOUND TRAFFIC ON PROPOSED WESTBOUND IL 336 LANES
- ② DRUMS WITH STEADY BURN LIGHTS (PER STANDARD 701006)
- ③ PROPOSED CONSTRUCTION THIS STAGE
- ④ FROM STAGE 1

LEGEND	
↑	DIRECTION OF TRAFFIC FLOW
⊥	ROAD CLOSED (TYPE III BARRICADE)
▨	TEMPORARY CROSSOVER (BY OTHERS)
▧	GRADING ONLY
⬆	ARROW PANEL SUPPORT
▩	GRADING & PAVING
■	TEMPORARY PAVEMENT (THIS CONTRACT)
▨	COMPLETED PAVEMENT
⬆	ARROW BOARD
⬆	PORTABLE CHANGEABLE MESSAGE SIGN

MAINTENANCE OF TRAFFIC STAGE 2

- SEQUENCE OF CONSTRUCTION**
- PAVE EASTBOUND LANES AND COMPLETE GRADING ON EASTBOUND LANES FROM STA 112+00 TO STA 128+00
 - BUILD TR 64 SOUTH OF IL 336

- TRAFFIC PLACEMENT**
- WESTBOUND & EASTBOUND TRAFFIC ON PROPOSED WESTBOUND IL 336 LANES
 - OPEN TR 64 NORTH OF IL 336 TO TRAFFIC
 - CLOSE TR 64 SOUTH OF IL 336 TO TRAFFIC PER STANDARD BLR 21-6 RELOCATE TRAFFIC TO TR 273 (800N) AND THEN TO IL 61

TRAFFIC CONTROL STANDARDS
701006 701011 701416 (SPECIAL) BLR 21-6

TRAFFIC CONTROL PAYMENT
TRAFFIC CONTROL FOR MAINLINE & CROSSOVER TO BE PAID FOR AS TRAFFIC CONTROL AND PROTECTION, STANDARD 701416 (SPECIAL)
TRAFFIC CONTROL FOR TR 64 SHALL BE PAID FOR AS TRAFFIC CONTROL BLR 21-6

REVISIONS		ILLINOIS DEPARTMENT OF TRANSPORTATION
NAME	DATE	
		CONSTRUCTION STAGING PLAN STAGE 2 FAP ROUTE 315 (IL 336)

SCALE: VERT. N/A
HORIZ. 1"=200'
DATE: 12/17/03

DRAWN BY: HH
CHECKED BY: SRD

Plot Date: 7/28/2006
 Plot Time: 3:25:40 PM
 Plot By: [Name]
 Plot To: [Name]
 File Name: I:\03033\cadd\1\constr\tr 64\stage 2\stage 2.dgn