

F.A.P. RTE.	SECTION	COUNTY	TOTAL SHEETS	SHEET NO.
315	(34-6,55-1)	HANCOCK/McDONOUGH	433	103
STA. 391+00		TO STA. 400+00		
FED. ROAD DIST. NO.	ILLINOIS	FED. AID PROJECT	STATE CONTRACT NO. 68206	

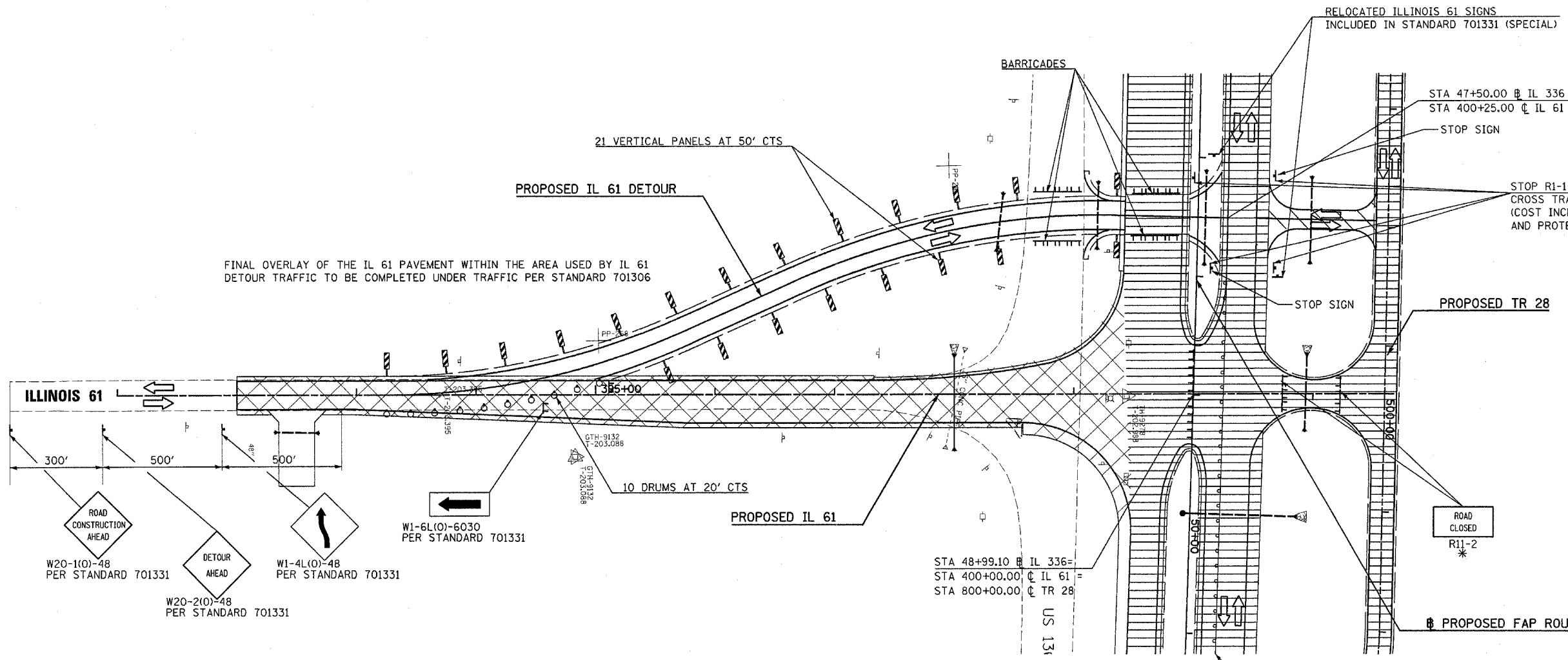

LEGEND	
	DIRECTION OF TRAFFIC FLOW
	ROAD CLOSED (TYPE III BARRICADE)
	WORK AREA
	FINISHED PVMT
	TEMPORARY PAVEMENT (OPEN TO TRAFFIC)
	VERTICAL PANEL AT 50' CENTERS
	DRUM WITH MONODIRECTIONAL STEADY LIGHT AT 20' CENTERS

TRAFFIC CONTROL FOR THE IL 61 DETOUR SHALL BE PER THIS DETAIL AND THE APPLICABLE PORTIONS OF STD 701331. TRAFFIC CONTROL TO BE PAID FOR PER EACH AS TRAFFIC CONTROL AND PROTECTION, STANDARD 701331 (SPECIAL)

REVISIONS	
NAME	DATE

ILLINOIS DEPARTMENT OF TRANSPORTATION

CONSTRUCTION STAGING PLAN

STAGE 2

ILLINOIS 61 DETOUR

SCALE: VERT. N/A
HORIZ. 1"=50'

DATE 5/9/05

DRAWN BY BDS
CHECKED BY SRO

Plot Date: 7/18/2006
 Plot Time: 3:26:50 PM
 Plotted By: bscmnd
 File Name: I:\03033\cdm\construction\plan\plone\074.es200918detour.dgn