

F.A.P. RTE.	SECTION	COUNTY	TOTAL SHEETS	SHEET NO.
315	(34-6,55-1)	HANCOCK/MCDONOUGH	433	169
STA. 41+00		TO STA. 57+00		
FED. ROAD DIST. NO.		ILLINOIS FED. AID PROJECT		
STATE CONTRACT NO. 68206				

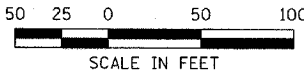
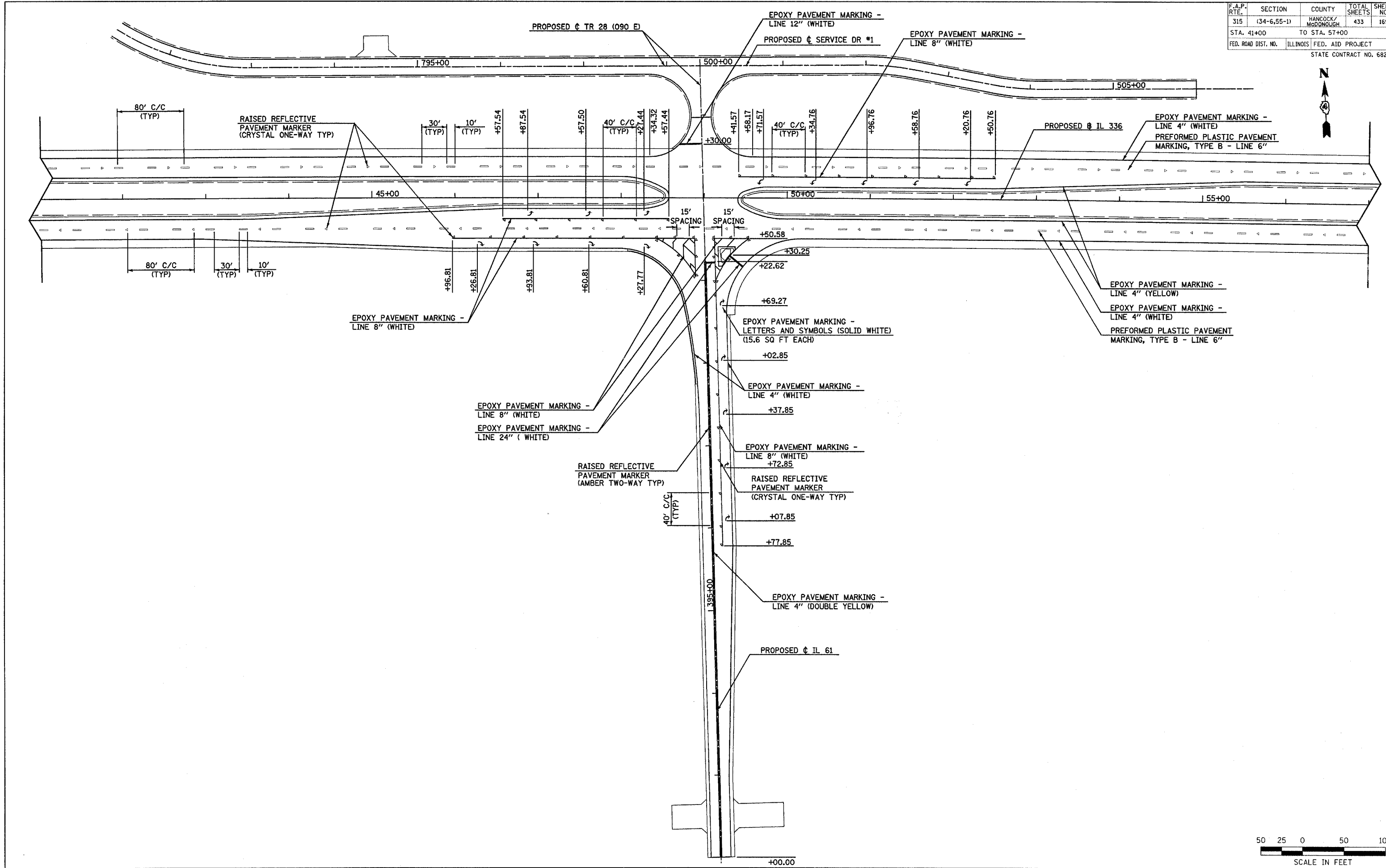

PAVEMENT MARKING - FAP ROUTE 315 (IL 336) STA 41+00 TO STA 57+00