

FAP ROUTE	SECTION	COUNTY	TOTAL SHEETS	SHEET NO.
693	(119B-3)	TAZEWELL	31	1
FED. ROAD DIST. NO.	ILLINOIS	FED. AID PROJECT		

CONTRACT NO. 68415
 CATALOG NO. 032903-00D
 D-94-016-05

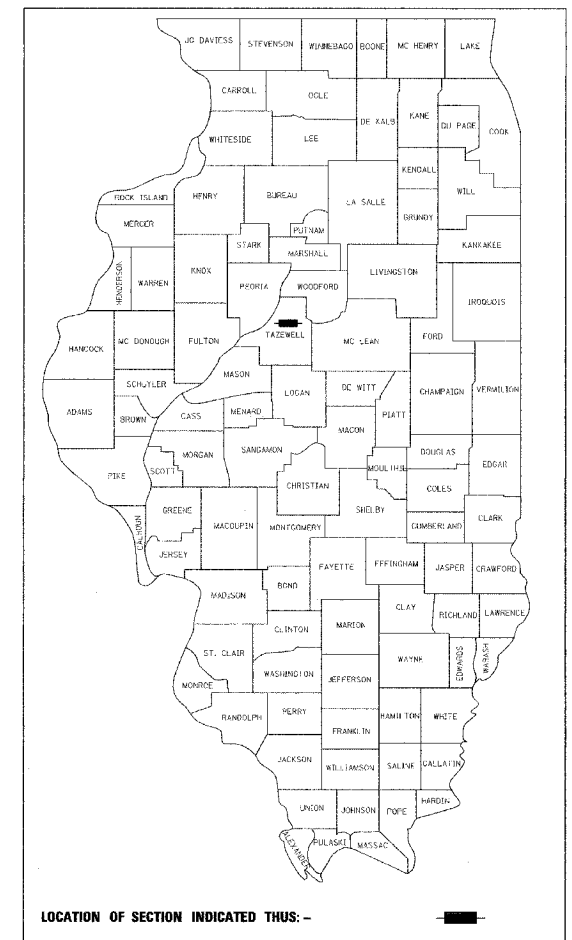

STATE OF ILLINOIS
 DEPARTMENT OF TRANSPORTATION
 DIVISION OF HIGHWAYS

**PROPOSED
 HIGHWAY PLANS**

FAP ROUTE 693 (IL RTE 9)
 SECTION (119B-3)I
 PROJECT NO. F-0693(057)
 TAZEWELL COUNTY
 DECK BEAM REPLACEMENT
 C-94-100-04

SCALES
 PLAN = 1"=30'
 PROFILE HORIZ. = 1"=30'
 PROFILE VERT. = 1"=5'
 CROSS SECTIONS = 1"=10' HORIZ.
 1"=5' VERT.

INDEX OF SHEETS

- 1 COVER SHEET
- 2 GENERAL NOTES
- 3 SUMMARY OF QUANTITIES
- 4 TYPICAL SECTIONS
- 5 GENERAL SITE PLAN
- 6 RESURFACING DETAIL (BRIDGE APPROACH TAPER/BUTT JOINT)
- 7-8 STAGE CONSTRUCTION PLANS
- 9 WIDE LOAD SIGN LOCATION
- 10-23 BRIDGE PLANS
- 24-31 SCOUR MITIGATION PLANS

STANDARDS

- 420401-05
- 630001-07
- 630301-04
- 631031-04
- 631032-03
- 635006-02
- 635011-01
- 701306-01
- 701321-08
- 701326-02
- 702001-06
- 704001-03
- 780001-01
- 781001-02

COMMITMENTS

NONE

DESCRIPTION OF WORK

THE PROPOSED IMPROVEMENTS CONSIST OF SCOUR MITIGATION, REMOVAL OF THE EXISTING BRIDGE SUPERSTRUCTURE AND REPLACING WITH PRECAST, PRESTRESSED CONCRETE DECK BEAMS, BITUMINOUS CONCRETE WEARING SURFACE AND OTHER APPURTENANT ITEMS OF WORK. THE CONTRACTOR SHALL BE RESPONSIBLE FOR FURNISHING ALL LABOR, EQUIPMENT AND MATERIALS NECESSARY TO SATISFACTORILY CONSTRUCT THE PROJECT IN ACCORDANCE WITH THE PLANS, SPECIFICATIONS AND PROVISIONS STATED HEREIN.

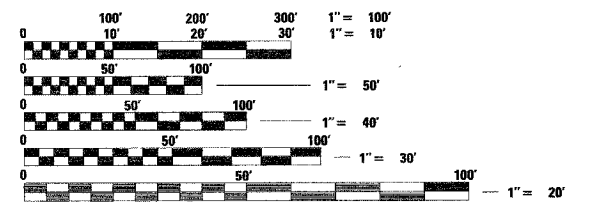

FULL SIZE PLANS HAVE BEEN PREPARED USING STANDARD ENGINEERING SCALES, REDUCED SIZED PLANS WILL NOT CONFORM TO STANDARD SCALES, IN MAKING MEASUREMENTS ON REDUCED PLANS, THE ABOVE SCALES MAY BE USED.

J.U.L.I.E.
 JOINT UTILITY LOCATION INFORMATION FOR EXCAVATION
 1-800-892-0123

CONTRACT NO. 68415

LENGTH OF PROJECT
 GROSS LENGTH: 136 FT = 0.03 MILES
 NET LENGTH: 136 FT = 0.03 MILES

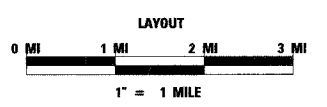
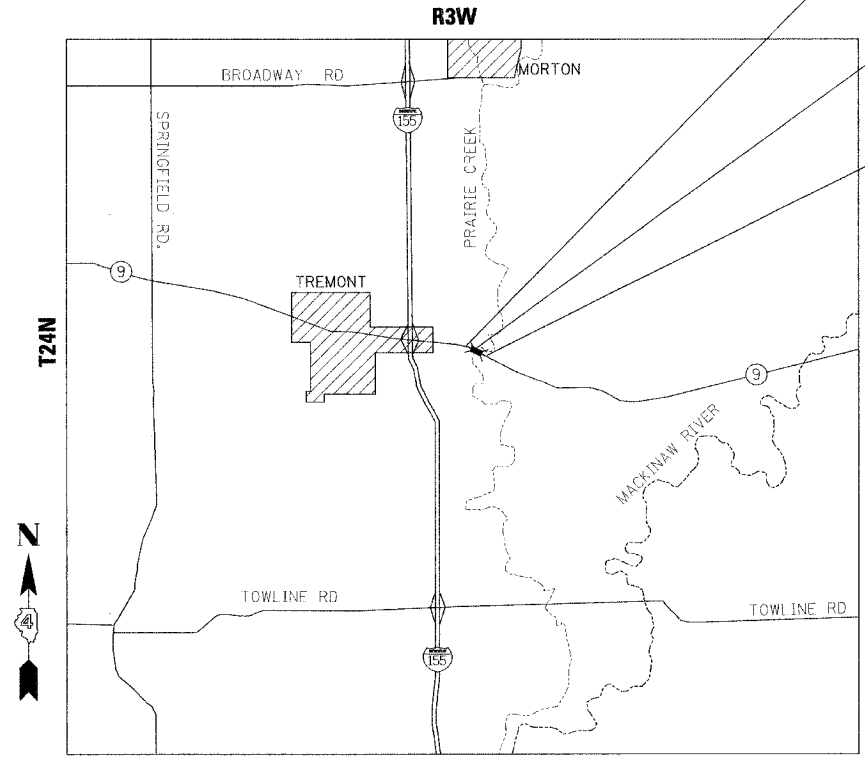

PROJECT BEGIN
 STA. 504 + 51.87
 LATITUDE 40°31'26" N
 LONGITUDE 89°27'49" W

BRIDGE OVER PRAIRIE CREEK
 STA. 504 + 88.50 TO STA. 505 + 51.50
 S.N. 090-0061

PROJECT END
 STA. 505 + 87.50
 LATITUDE 40°31'25" N
 LONGITUDE 89°27'48" W

2004 ADT = 3600
 2024 ADT = 4500

QA/QC BITUMINOUS SUPERPAVE PROJECT

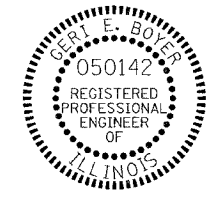

PRINTED BY THE AUTHORITY
 OF THE STATE OF ILLINOIS

GERI E. BOYER, P.E.
 LICENSE NO. 062-050142
 DATE 04/23/06
 EXPIRES 11-30-2007

PREPARED BY:
 TWM
 THOUVENOT, WADE & MOERCHEN, INC.

PLOT DATE: *DATE-TIME*

PROJECT ENGINEER: JAMES MILLER
 SQUAD CONTACT: (309) 671-3451