

STATE OF ILLINOIS  
DEPARTMENT OF TRANSPORTATION

ROUTE NO.	SECTION	COUNTY	SHEETS	SHEET NO.	SHEET NO. 2 14 SHEETS
F.A.P. 693	(119B-31)	TAZEWELL	31	11	
FED. ROAD DIST. NO. 7		ILLINOIS	FED. AID PROJECT-		

Contract # 68415

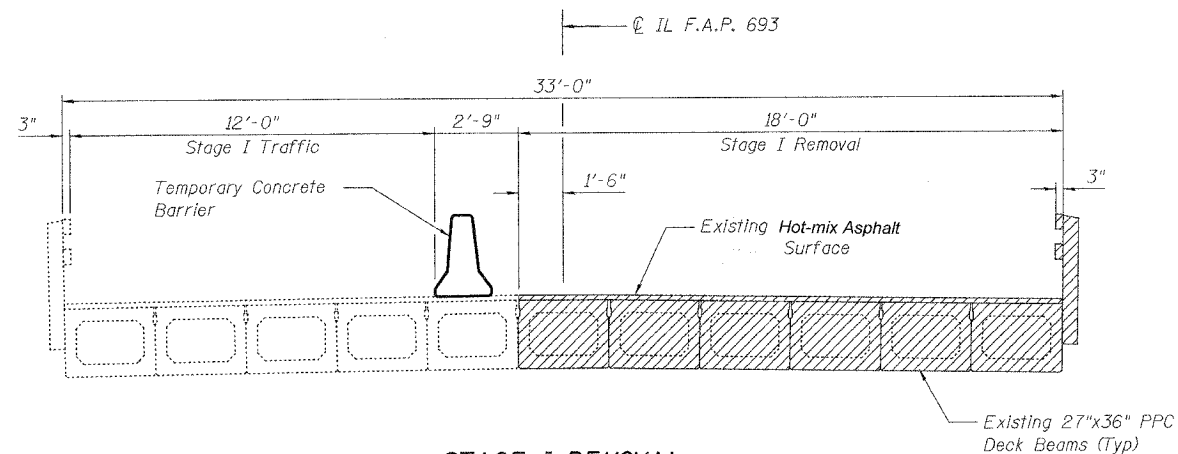

**STAGE I REMOVAL**  
(LOOKING UPSTATION)

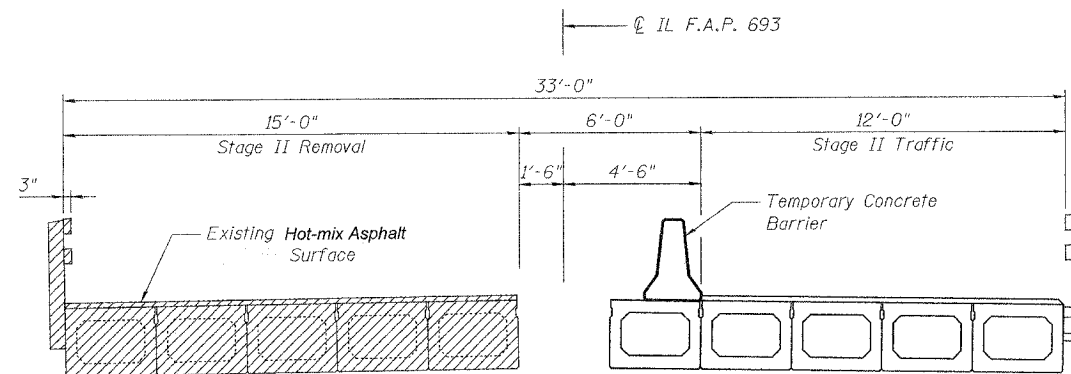

**STAGE II REMOVAL**  
(LOOKING UPSTATION)

Indicates Removal of Existing Superstructures

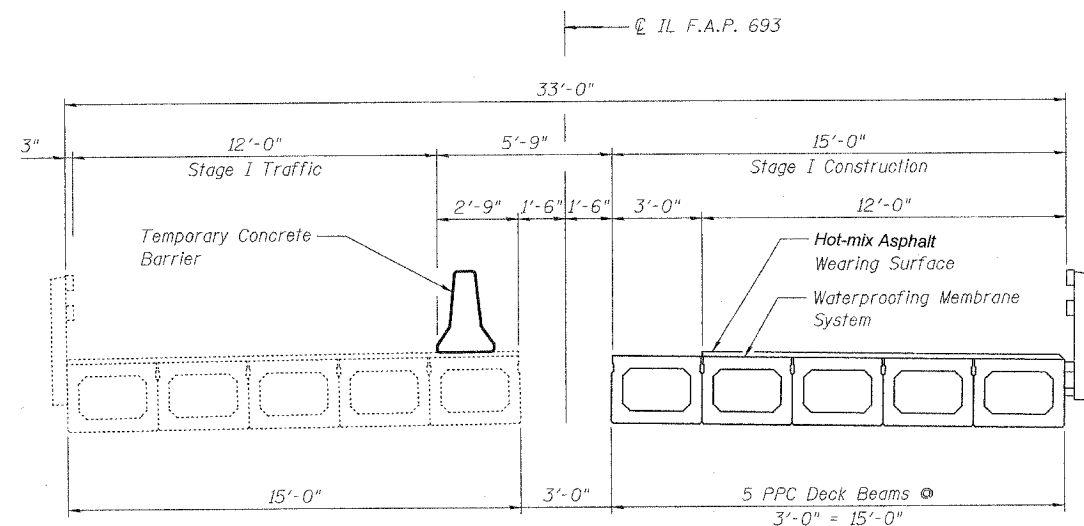

**STAGE I CONSTRUCTION**  
(LOOKING UPSTATION)

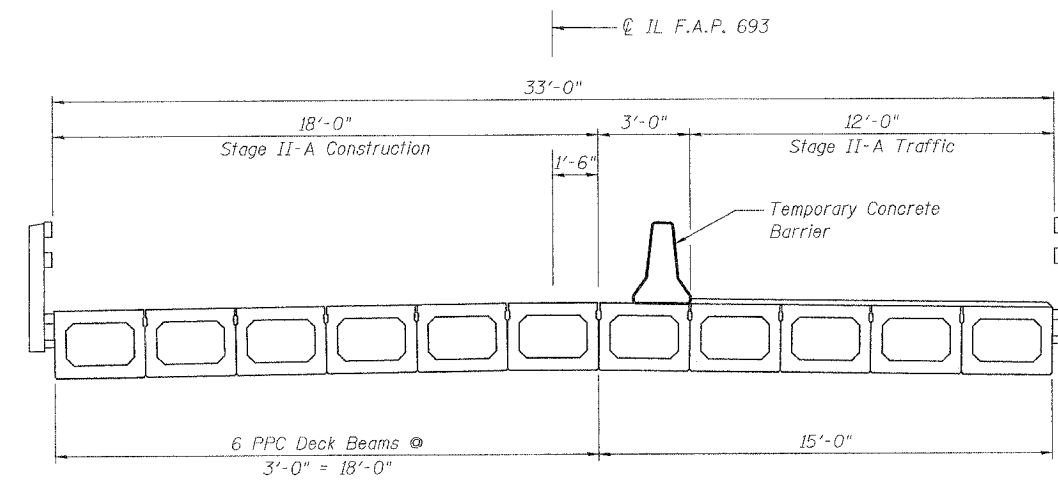

**STAGE II-A CONSTRUCTION**  
(LOOKING UPSTATION)

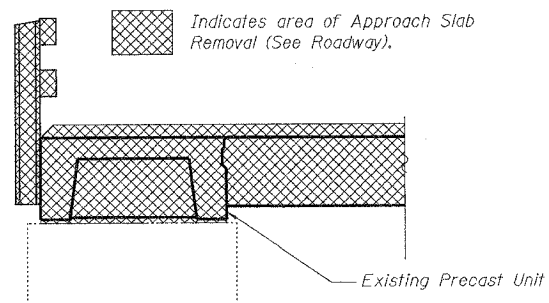

**TYPICAL APPROACH REMOVAL SECTION**

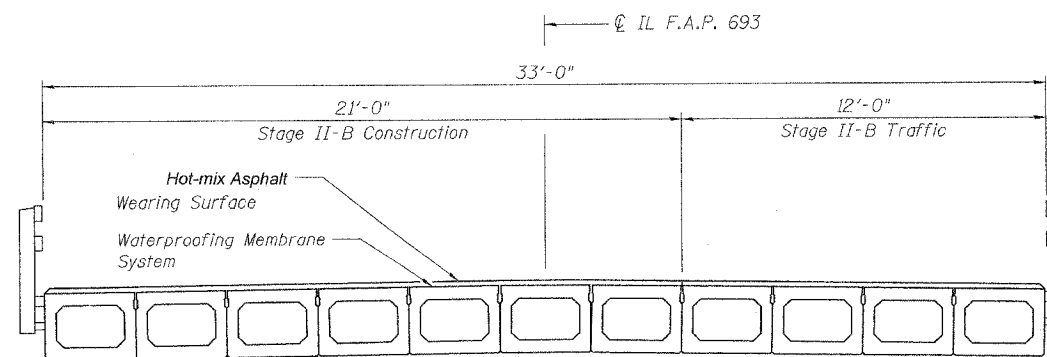

**STAGE II-B CONSTRUCTION**  
(LOOKING UPSTATION)

Notes:  
For details of Temporary Concrete Barrier and limits of Waterproofing Membrane System, see Sheet 3 of 14.

**STAGE CONSTRUCTION**  
**ILLINOIS ROUTE 9 OVER**  
**PRAIRIE CREEK**  
**F.A.P. ROUTE 693 SECTION (119B-31)**  
**TAZEWELL COUNTY**  
**SN 090-0061**

DESIGNED BWP	<b>THOUVENOT, WADE &amp; MOERCHEN, INC.</b> ENGINEERS • SURVEYORS • PLANNERS  CORPORATE OFFICE 4940 OLD COLLINSVILLE RD. SPRINGFIELD, ILLINOIS 62226 TEL. (618) 624-4488 FAX (618) 624-6688 E-MAIL: COWI@TWM-INC.COM
CHECKED ALN	
DRAWN BWP	
CHECKED KPC	