

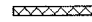

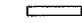

| | | | | |
|---------------------|---------------------------|-----------|--------------|-----------|
| F.A.U. RTE. | SECTION | COUNTY | TOTAL SHEETS | SHEET NO. |
| 9177 | 44-1BR | ST. CLAIR | 29 | 12 |
| STA. | TO STA. | | | |
| FED. ROAD DIST. NO. | ILLINOIS FED. AID PROJECT | | | |

LEGEND

-  IMPACT ATTENUATOR
-  TEMPORARY CONCRETE BARRIER
-  DIRECTION INDICATOR BARRICADE WITH STEADY BURNING LIGHT
-  BARRELS OR BARRICADES WITH STEADY BURNING LIGHT
-  TYPE III BARRICADE
-  ARROW BOARD

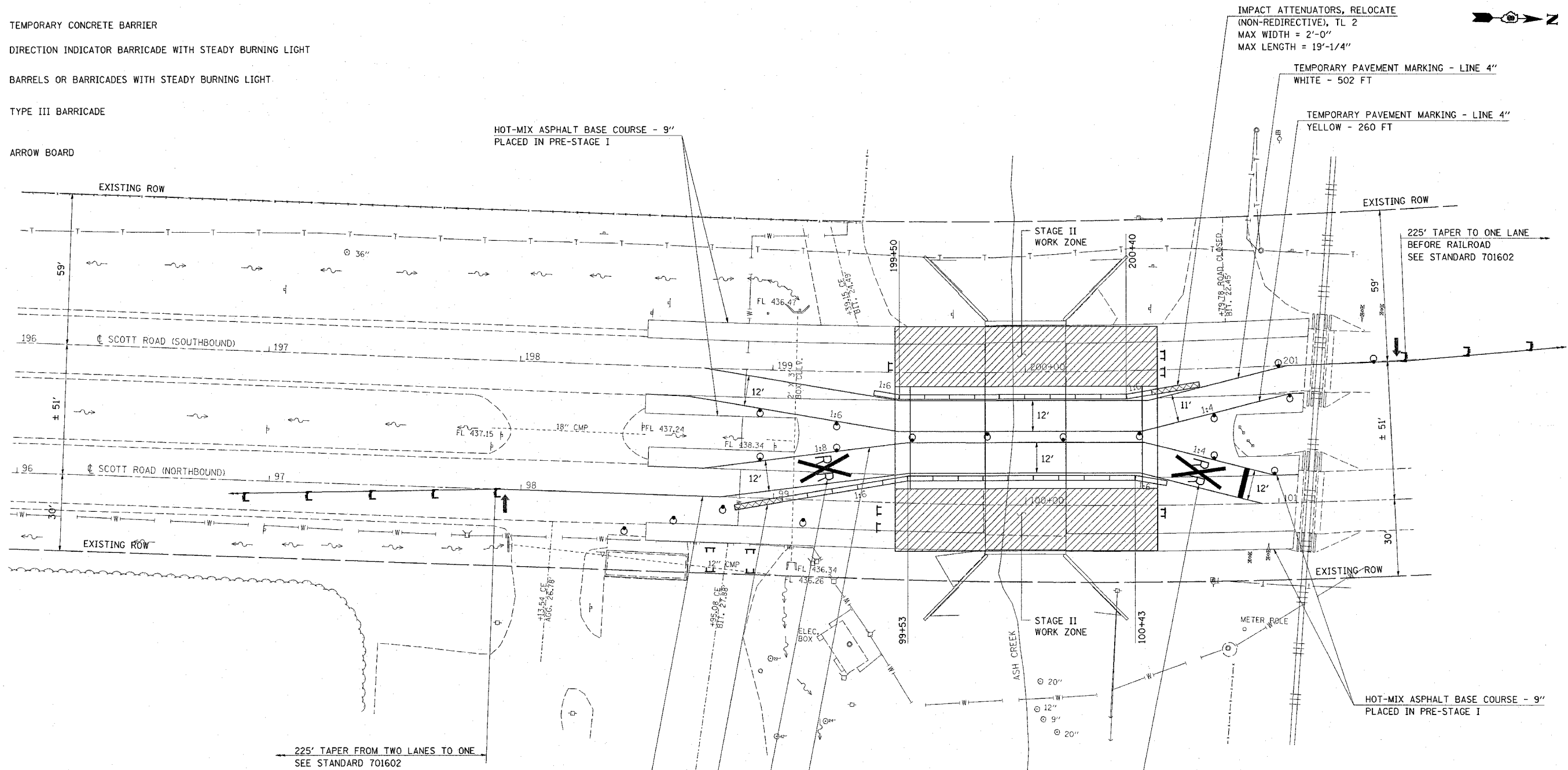

SEQUENCE OF CONSTRUCTION - STAGE II:

- REMOVE 12.5 FT AND RELOCATE 262.5 FT OF TEMPORARY CONCRETE BARRIER.
- REMOVE 1 EACH IMPACT ATTENUATORS, TEMPORARY, (FULLY-REDIRECTIVE, NARROW) PLACED IN STAGE I AND RELOCATE 2 EACH IMPACT ATTENUATORS, (NON-REDIRECTIVE).
- SEE STANDARD 701321 FOR TEMPORARY CONCRETE BARRIER DETAILS AND SEE STANDARD 701602 FOR TAPER AND SIGN DETAILS NOT SHOWN ON PLANS.

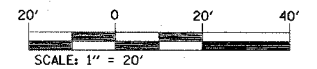

| REVISIONS | |
|-----------|------|
| NAME | DATE |
| | |
| | |
| | |
| | |
| | |
| | |
| | |
| | |
| | |
| | |

ILLINOIS DEPARTMENT OF TRANSPORTATION
STAGE II CONSTRUCTION
FAU ROUTE 9177
SECTION 44-1BR
ST. CLAIR COUNTY

PLOT DATE = 10/18/2006
 FILE NAME = c:\pva\pva\aed2402\plan\stg2\02a.dgn
 PLOT SCALE = 20.0000 1/1 IN.
 USER NAME = overb.j