

SECTION	COUNTY	TOTAL SHEETS	SHEET NO.
94-F3000-05-BT	COOK	102	42
STA. TO STA.			
IDOT PROJECT NO. TE-D001(610)			
CENTENNIAL TRAIL			

CONTRACT NO. 63859

CURVE CL-95
 PI STA = 11+652.081
 N = 560,856.126
 EB = 335,203.267
 $\Delta = 1^\circ 23' 02''$ (LT)
 R = 500.000 m
 T = 6.039 m
 L = 12.076 m
 E = 0.036 m

CURVE CL-97
 PI STA = 11+790.551
 N = 560,931.410
 E = 335,319.391
 $\Delta = 3^\circ 18' 49''$ (LT)
 R = 750.000 m
 T = 21.694 m
 L = 43.376 m
 E = 0.314 m

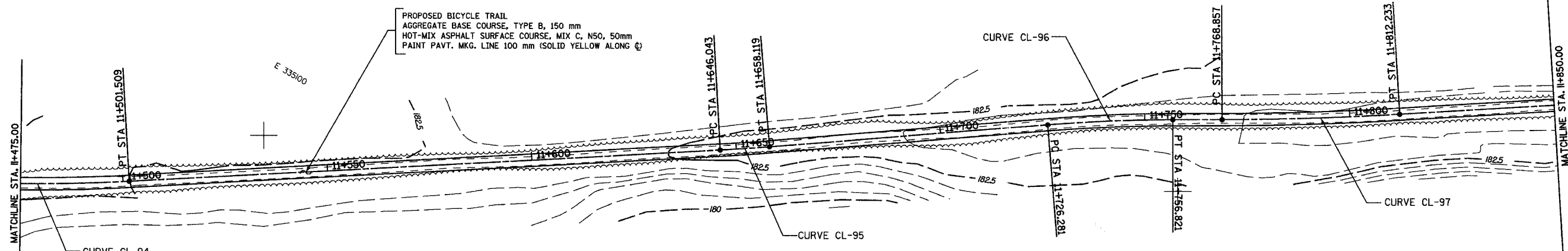

CURVE CL-96
 PI STA = 11+741.558
 N = 560,906.810
 E = 335,277.004
 $\Delta = 4^\circ 22' 28''$ (RT)
 R = 400.000 m
 T = 15.277 m
 L = 30.540 m
 E = 0.292 m

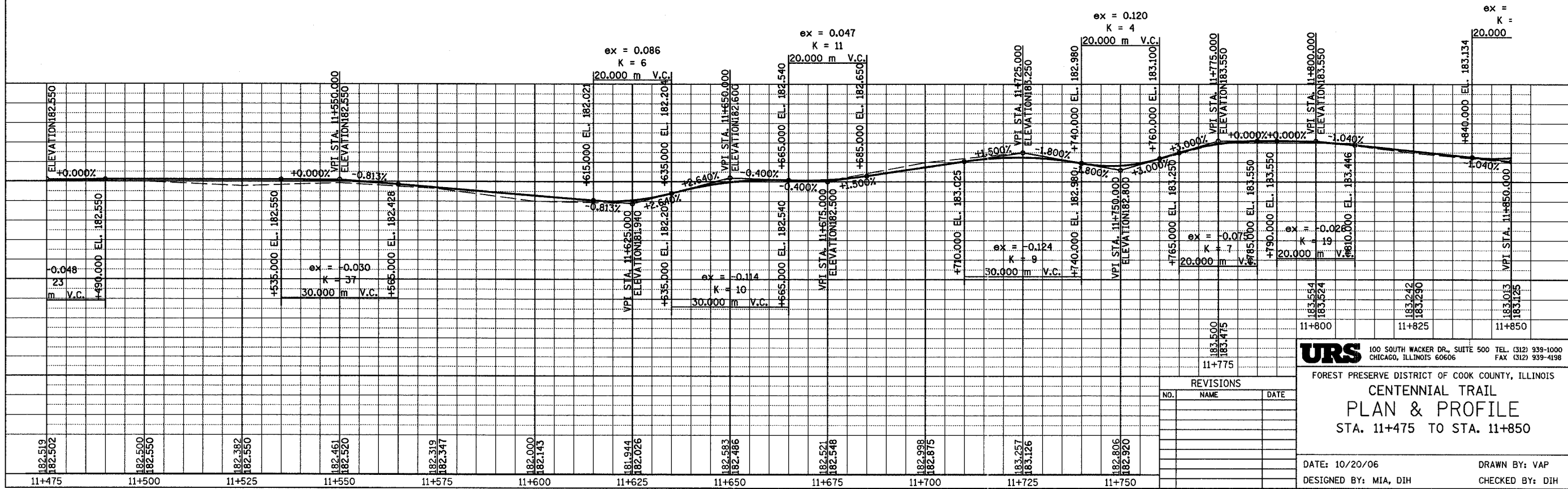

URS 100 SOUTH WACKER DR., SUITE 500 TEL. (312) 939-1000
 CHICAGO, ILLINOIS 60606 FAX (312) 939-4198

FOREST PRESERVE DISTRICT OF COOK COUNTY, ILLINOIS
CENTENNIAL TRAIL
PLAN & PROFILE
 STA. 11+475 TO STA. 11+850

DATE: 10/20/06 DRAWN BY: VAP
 DESIGNED BY: MIA, DIH CHECKED BY: DIH

REVISIONS		
NO.	NAME	DATE