

F.A.P. RTE.	SECTION	COUNTY	TOTAL SHEETS	SHEET NO.
1517	03-00247-00-BR	KANE	121	8
STA.	102+50	TO STA.	112+50	
FED. ROAD DIST. NO. 1	ILLINOIS	HIGHWAY PROJECT		
CONTRACT #: 83867				



PROPOSED CONCRETE PAVEMENT
(QUANTITY ON PLANS)

LINE	LENGTH	BEARING	BEGIN STA.	END STA.
L1	500.00'	S89°04'04" W	100+00	105+00
L2	401.59'	S89°04'04" W	105+00	109+01.59
L3	406.52'	N89°33'59" E	109+01.59	113+08.10
L4	722.16'	N88°52'54" E	113+08.10	120+30.26
L5	454.41'	S89°34'41" E	120+30.26	124+84.68
L6	53.89'	N89°37'36" E	124+84.68	125+38.57
L7	283.23'	N63°42'21" E	125+38.57	128+22.30
L8	271.84'	N89°24'05" E	128+22.30	130+94.14

TIE POINT	NORTHING	EASTING
501	1859009.30	989661.46
502	1859078.63	989658.81
503	1859046.53	989551.21
504	1859109.58	990031.13
505	1858989.42	990063.94
506	1859019.06	989568.68

SITE BENCHMARKS

BM 1:
CUT SQUARE ON NORTHWEST WINGWALL OF
WEST BRIDGE: SN 045-6009
ELEVATION = 639.93

BM 2:
CUT SQUARE ON SOUTHEAST WINGWALL OF
EAST BRIDGE: SN 045-6008
ELEVATION = 639.88

SMITH ENGINEERING CONSULTANTS, INC.
CIVIL/STRUCTURAL ENGINEERS AND SURVEYORS
4500 FRENCH PARKWAY, SUITE 201
MATTENLY, ILLINOIS 60050
PH: 815-385-1776 FAX: 815-385-1761
www.smithengineering.com E-MAIL: see@smithengineering.com
MATTENLY HUNTLEY YORKVILLE
ILLINOIS PROFESSIONAL DESIGN FIRM # 184-000108

ILLINOIS DEPARTMENT OF TRANSPORTATION

CITY OF AURORA
ILLINOIS AVENUE OVER THE FOX RIVER
ALIGNMENT AND TIES
STA 102+50 TO STA 112+50

SCALE: 1" = 20'
DATE 07-28-2006

DRAWN BY MPL
CHECKED BY JLP

REVISIONS		
NO.	NAME	DATE
7.		
6.		
5.		
4.		
3.		
2.		
1.		

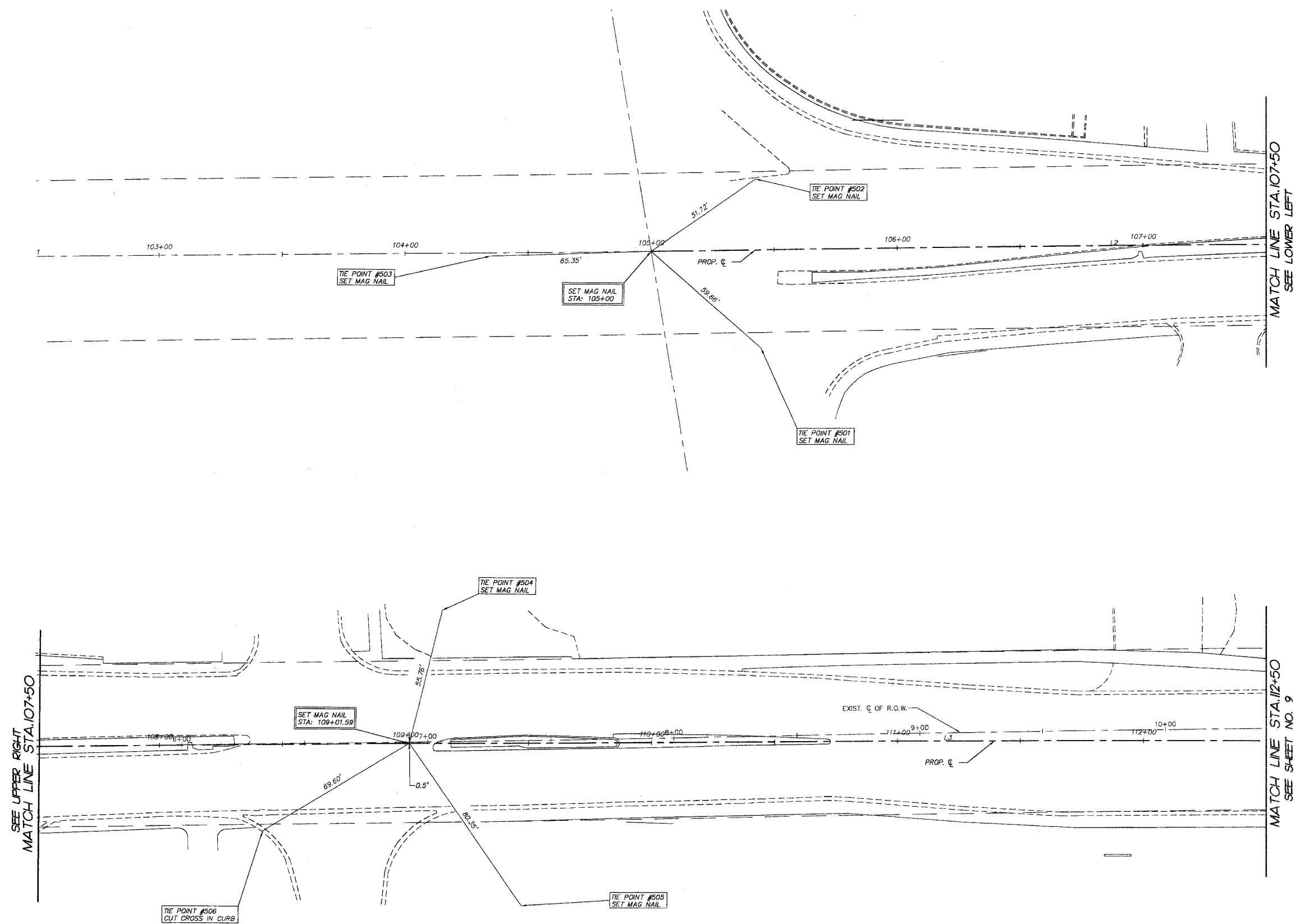

PLOT FILE: STANDARD
NAME: C:\P
COMP. FILE: C:\00181-528.dwg