

F.A.P. RTE.	SECTION	COUNTY	TOTAL SHEETS	SHEET NO.
1517	03-00247-00-BR	KANE	121	22
STA.	TO STA.			
FED. ROAD DIST. NO. 1	ILLINOIS		HIGHWAY PROJECT	
CONTRACT # 83867				

ROAD CLOSURE GENERAL NOTES

1. THE CONTRACTOR WILL BE ALLOWED TO CLOSE ILLINOIS AVENUE FOR TWO (2) SEPARATE DURATIONS AS DETAILED IN THE SPECIFICATIONS. EACH DURATION SHALL BE A MAXIMUM OF FIVE (5) CONTINUOUS WORKING DAYS. CLOSURES WILL NOT BE ALLOWED DURING HOLIDAYS OR WEEKENDS. ALL DETOUR SIGNS SHALL BE REMOVED WHEN DETOUR IS NOT IN PLACE.
2. THE DETOUR ROUTE SHALL BE POSTED PRIOR TO CLOSING THE ROAD.
3. ALL TRAFFIC CONTROL WORK ASSOCIATED WITH BOTH THE ROAD CLOSURES, SIGNING, AND BARRICADING, SHALL BE INCLUDED IN THE PAY ITEM FOR 'TRAFFIC CONTROL AND PROTECTION FOR TEMPORARY DETOUR'.
4. THE CONTRACTOR SHALL GIVE THE ENGINEER, CITY AND IDOT A 72 HOUR NOTICE PRIOR TO PLACING THE ADVANCE NOTICE SIGNS.
5. ADVANCE NOTICE SIGNS "17" SHALL BE PLACED TWO WEEKS PRIOR TO CLOSING THE ROADWAY.
6. CHANGEABLE MESSAGE SIGNS SHALL BE PLACED ON THE NORTH AND SOUTH LEGS OF IL ROUTE 31, NORTH AND SOUTH LEGS OF IL ROUTE 25, AND THE EAST AND WEST LEGS OF ILLINOIS AVENUE ONE WEEK IN ADVANCE OF ROAD CLOSURES.

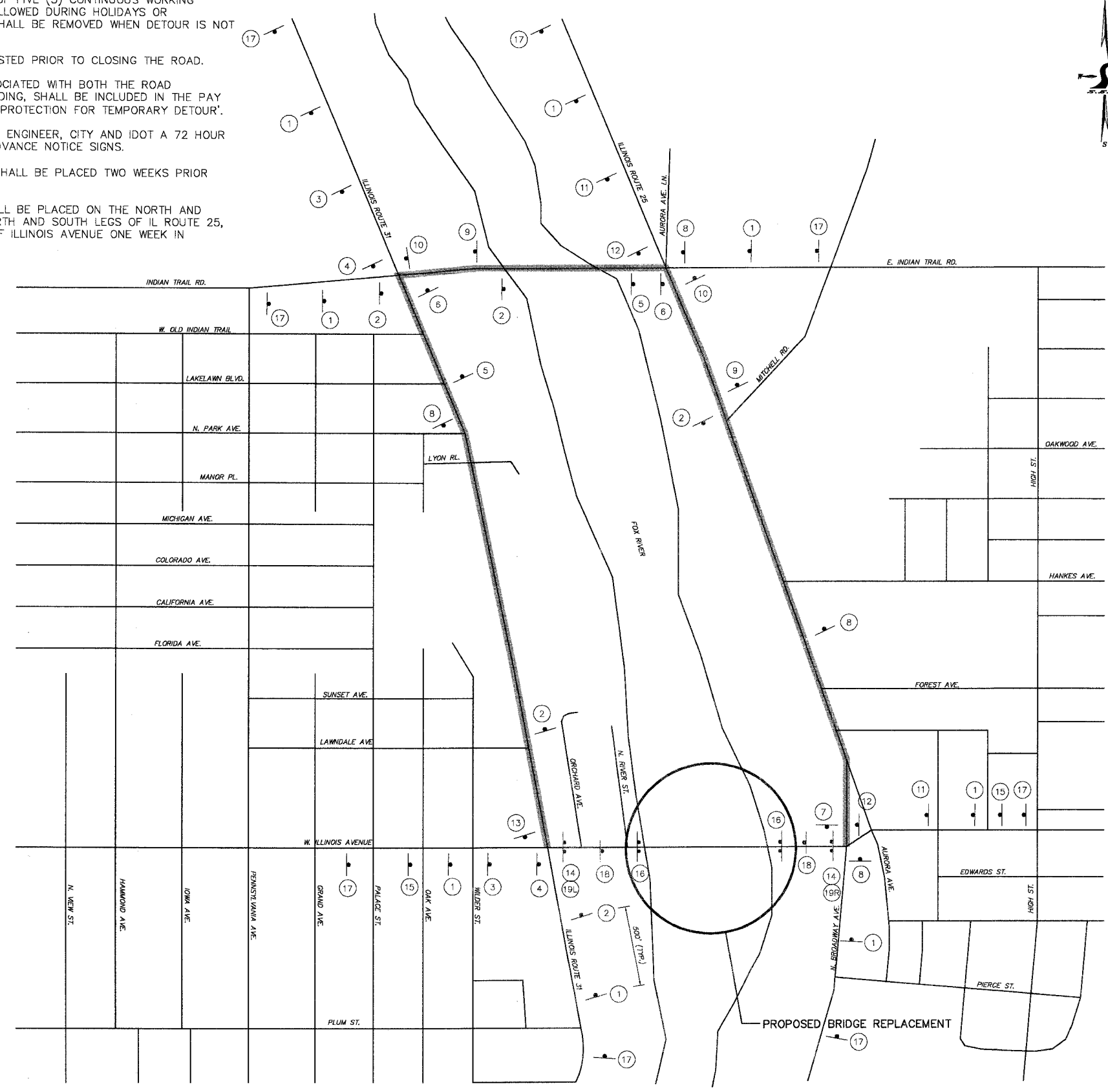

SIGN LEGEND

1		10	
2		11	
3		12	
4		13	
5		14	
6		15	
7		16	
8		17	
9		18	
		19L	
		19R	

LEGEND

PROPOSED DETOUR ROUTE

NOTE: SIGN SPACING SHALL BE 500' TYPICAL UNLESS OTHERWISE DIRECTED BY THE ENGINEER.

REVISIONS	
NAME	DATE
7.	
6.	
5.	
4.	
3.	
2.	
1.	

SMITH ENGINEERING CONSULTANTS, INC.
 CIVIL/STRUCTURAL ENGINEERS AND SURVEYORS
 4500 PIERCE PARKWAY, SUITE 201
 McHENRY, ILLINOIS 60050
 TEL: 815-385-1776 FAX: 815-385-1781
 www.smithengineering.com E-MAIL: see@smithengineering.com
 McHENRY HUNTLEY YORKVILLE
 ILLINOIS PROFESSIONAL DESIGN FIRM # 184-000108

ILLINOIS DEPARTMENT OF TRANSPORTATION

CITY OF AURORA
 ILLINOIS AVENUE OVER THE FOX RIVER
 DETOUR PLAN

SCALE: "NTS" DRAWN BY CFR
 DATE 07-28-2006 CHECKED BY JLP

PLOT FILE STANDARD
 VBAK CE-22
 COMP. FILE: 050701-627.dwg