

F.A.U. RTE.	SECTION	COUNTY	TOTAL SHEETS	SHEET NO.
1321	0711 N-1	DUPAGE	54	9
STA.		TO STA.		
FED. ROAD DIST. NO. 1		ILLINOIS FED. AID PROJECT		

STA 1000+00.0 (CL IRVING PARK ROAD) =
STA 195+21.29, 4.15' LT (EXIST. CL IRVING PARK ROAD)

PROP. CL STA. 1005+27.33 (IL. RTE. 19) =
PROP. CL STA. 2007+74.70 (BLOOMINGDALE RD.)

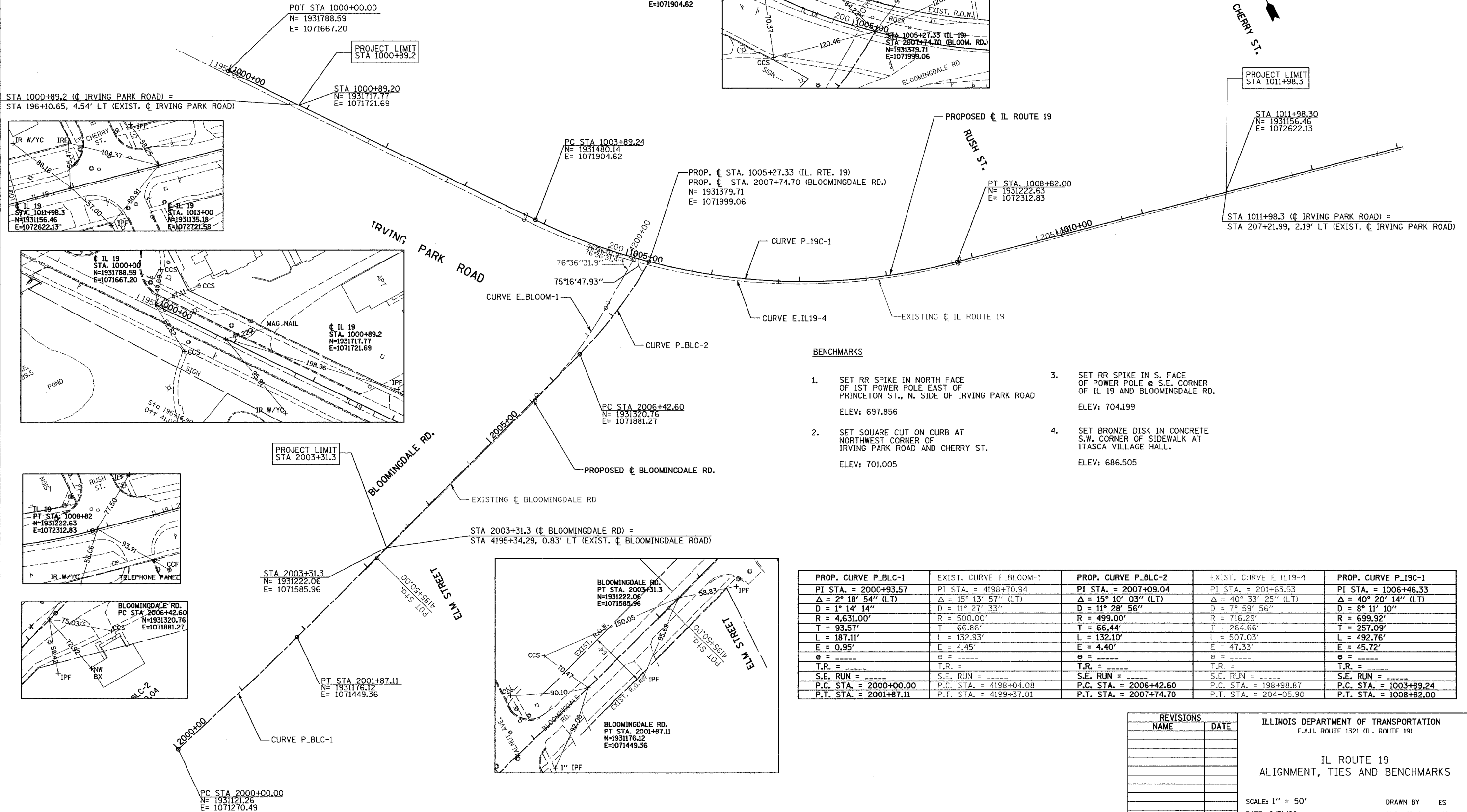
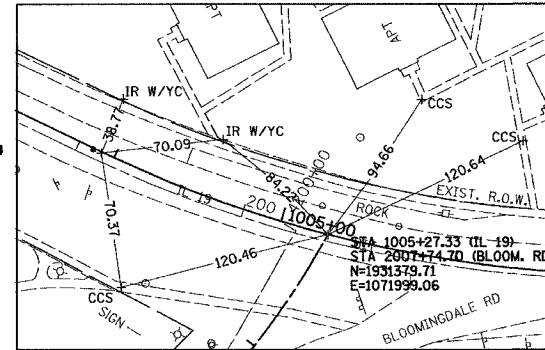

BENCHMARKS

- SET RR SPIKE IN NORTH FACE OF 1ST POWER POLE EAST OF PRINCETON ST., N. SIDE OF IRVING PARK ROAD
ELEV: 697.856
- SET SQUARE CUT ON CURB AT NORTHWEST CORNER OF IRVING PARK ROAD AND CHERRY ST.
ELEV: 701.005
- SET RR SPIKE IN S. FACE OF POWER POLE @ S.E. CORNER OF IL 19 AND BLOOMINGDALE RD.
ELEV: 704.199
- SET BRONZE DISK IN CONCRETE S.W. CORNER OF SIDEWALK AT ITASCA VILLAGE HALL.
ELEV: 686.505

PROP. CURVE P_BLC-1	EXIST. CURVE E_BLOOM-1	PROP. CURVE P_BLC-2	EXIST. CURVE E_IL19-4	PROP. CURVE P_19C-1
PI STA. = 2000+93.57	PI STA. = 4198+70.94	PI STA. = 2007+09.04	PI STA. = 201+63.53	PI STA. = 1006+46.33
$\Delta = 2^\circ 18' 54''$ (LT)	$\Delta = 15^\circ 13' 57''$ (LT)	$\Delta = 15^\circ 10' 03''$ (LT)	$\Delta = 40^\circ 33' 25''$ (LT)	$\Delta = 40^\circ 20' 14''$ (LT)
D = 1° 14' 14"	D = 11° 27' 33"	D = 11° 28' 56"	D = 7° 59' 56"	D = 8° 11' 10"
R = 4,631.00'	R = 500.00'	R = 499.00'	R = 716.29'	R = 699.92'
T = 93.57'	T = 66.86'	T = 66.44'	T = 264.66'	T = 257.09'
L = 187.11'	L = 132.93'	L = 132.10'	L = 507.03'	L = 492.76'
E = 0.95'	E = 4.45'	E = 4.40'	E = 47.33'	E = 45.72'
e =	e =	e =	e =	e =
T.R. =	T.R. =	T.R. =	T.R. =	T.R. =
S.E. RUN =	S.E. RUN =	S.E. RUN =	S.E. RUN =	S.E. RUN =
P.C. STA. = 2000+00.00	P.C. STA. = 4198+04.08	P.C. STA. = 2006+42.60	P.C. STA. = 198+98.87	P.C. STA. = 1003+89.24
P.T. STA. = 2001+87.11	P.T. STA. = 4189+37.01	P.T. STA. = 2007+74.70	P.T. STA. = 204+05.90	P.T. STA. = 1008+82.00

REVISIONS	
NAME	DATE

ILLINOIS DEPARTMENT OF TRANSPORTATION
F.A.U. ROUTE 1321 (IL. ROUTE 19)

IL ROUTE 19
ALIGNMENT, TIES AND BENCHMARKS

SCALE: 1" = 50'
DATE 8/31/06

DRAWN BY ES
CHECKED BY JIP

PLOT DATE = 8/28/06
 FILE NAME = D:\LATERAL\Bloomington\Proposed\Plan\Rev_Green\Cover\VL.dgn
 PLOT SCALE = AS CALLED
 USER NAME = USER*