

| F.A.U. RTE. | SECTION | COUNTY | TOTAL SHEETS | SHEET NO. |
|---------------------|----------|------------------|--------------|-----------|
| 1321 | 0711 N-1 | DUPAGE | 54 | 11 |
| STA. | | TO STA. | | |
| FED. ROAD DIST. NO. | ILLINOIS | FED. AID PROJECT | | |

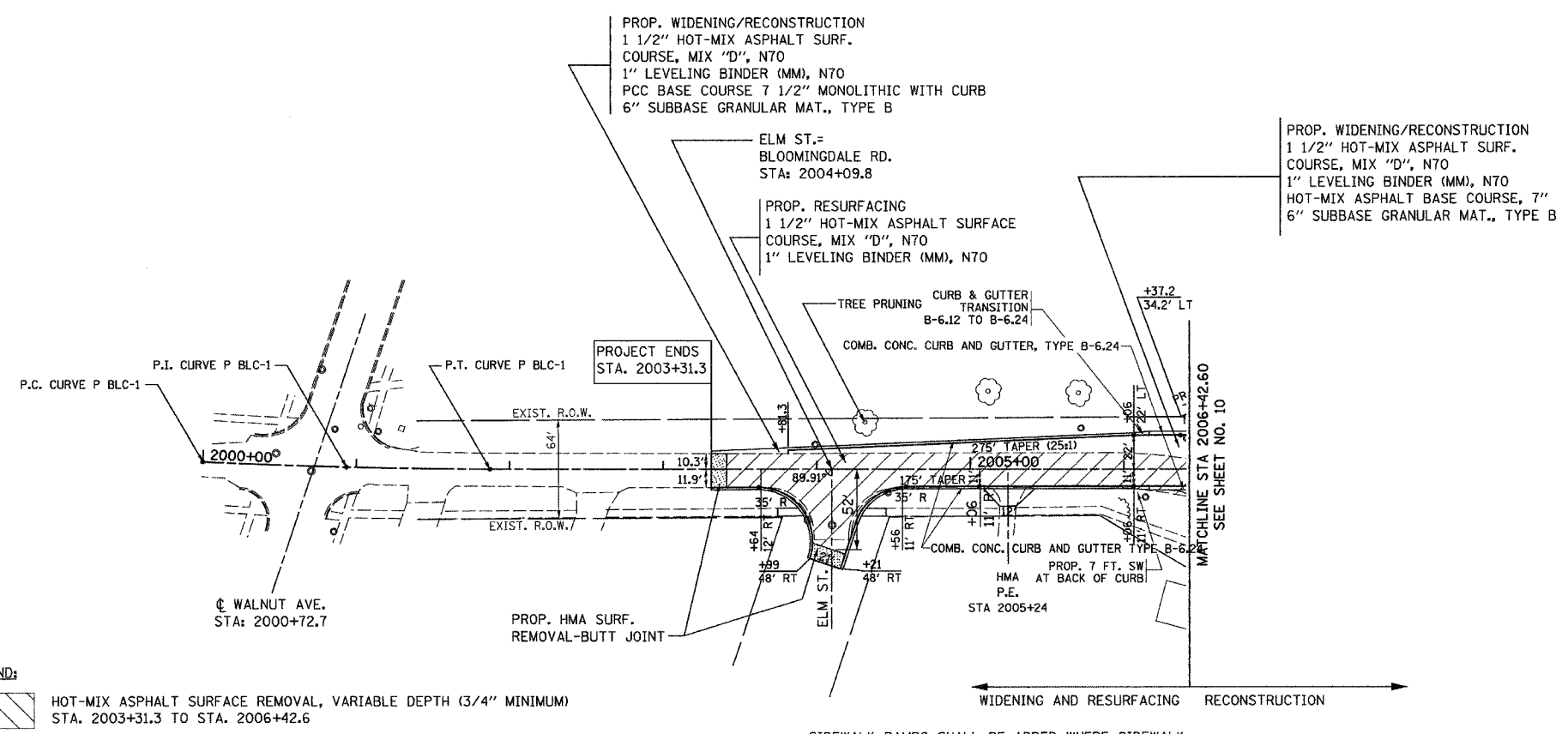

| | |
|------|------|
| PLAN | DATE |
| BY | |
| DATE | |
| BY | |
| DATE | |
| BY | |
| DATE | |



LEGEND:
 HOT-MIX ASPHALT SURFACE REMOVAL, VARIABLE DEPTH (3/4" MINIMUM) STA. 2003+31.3 TO STA. 2006+42.6

PROP. CURVE P BLC-1
 P.I. STA. = 2000+93.57
 $\Delta = 2^\circ 18' 54''$ (LT)
 $D = 1^\circ 14' 14''$
 $R = 4,631.00'$
 $T = 93.57'$
 $L = 187.11'$
 $E = 0.95'$
 P.C. STA. = 2000+00.00
 P.T. STA. = 2001+87.11

SIDEWALK RAMPS SHALL BE ADDED WHERE SIDEWALK (EX. AND PROP.) CROSSES THE PAVEMENT.
 DETECTABLE WARNINGS SHALL BE USED

| | |
|---------|------|
| PROFILE | DATE |
| BY | |
| DATE | |
| BY | |
| DATE | |

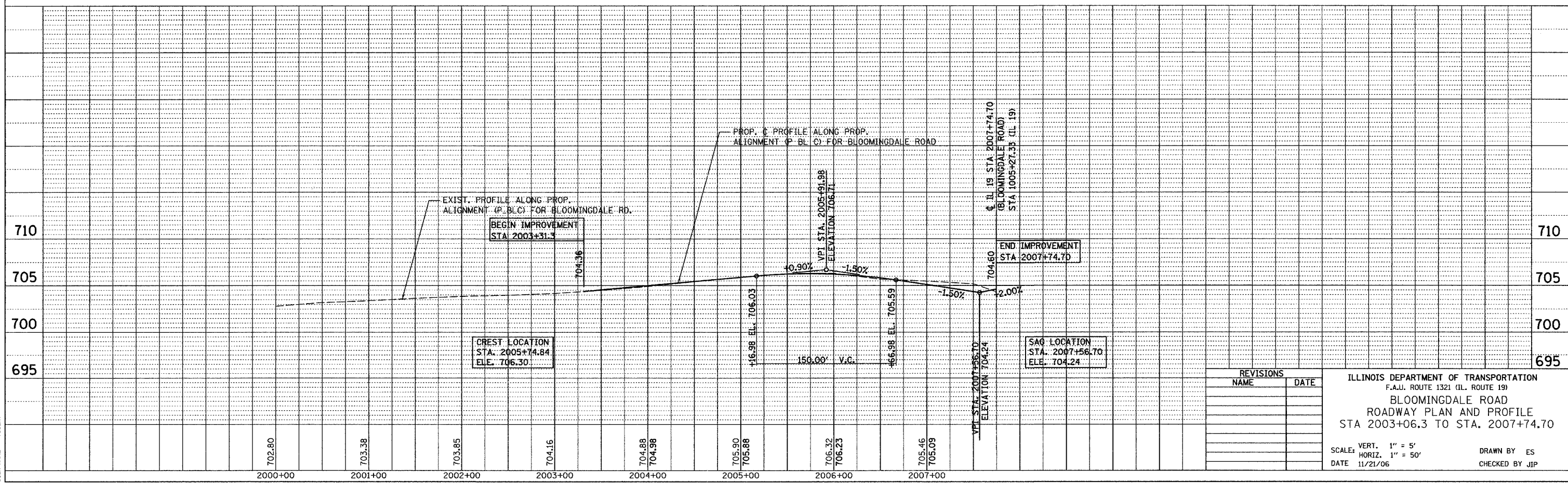

| REVISIONS | NAME | DATE |
|-----------|------|------|
| | | |
| | | |
| | | |
| | | |

ILLINOIS DEPARTMENT OF TRANSPORTATION
 F.A.U. ROUTE 1321 (IL. ROUTE 19)
 BLOOMINGDALE ROAD
 ROADWAY PLAN AND PROFILE
 STA 2003+06.3 TO STA. 2007+74.70
 SCALE: VERT. 1" = 5'
 HORIZ. 1" = 50'
 DATE 11/21/06
 DRAWN BY ES
 CHECKED BY JJP

PLOT DATE = 11/21/06
 FILE NAME = \\ALRTE1\Bloomngdale\Proposed\Plans_Rev_Geom\Plan\Profile\Profile.dwg
 PLOT SCALE = 1"=50'
 USER NAME = MUSER