

F.A.U. RTE.	SECTION	COUNTY	TOTAL SHEETS	SHEET NO.
1321	0711 N-1	DUPAGE	54	14
STA.		TO STA.		
FED. ROAD DIST. NO. 1		ILLINOIS FED. AID PROJECT		

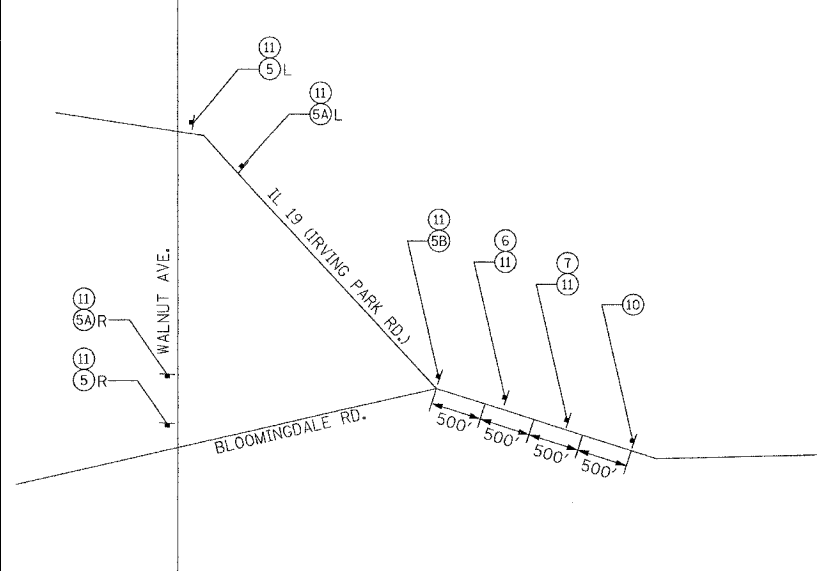
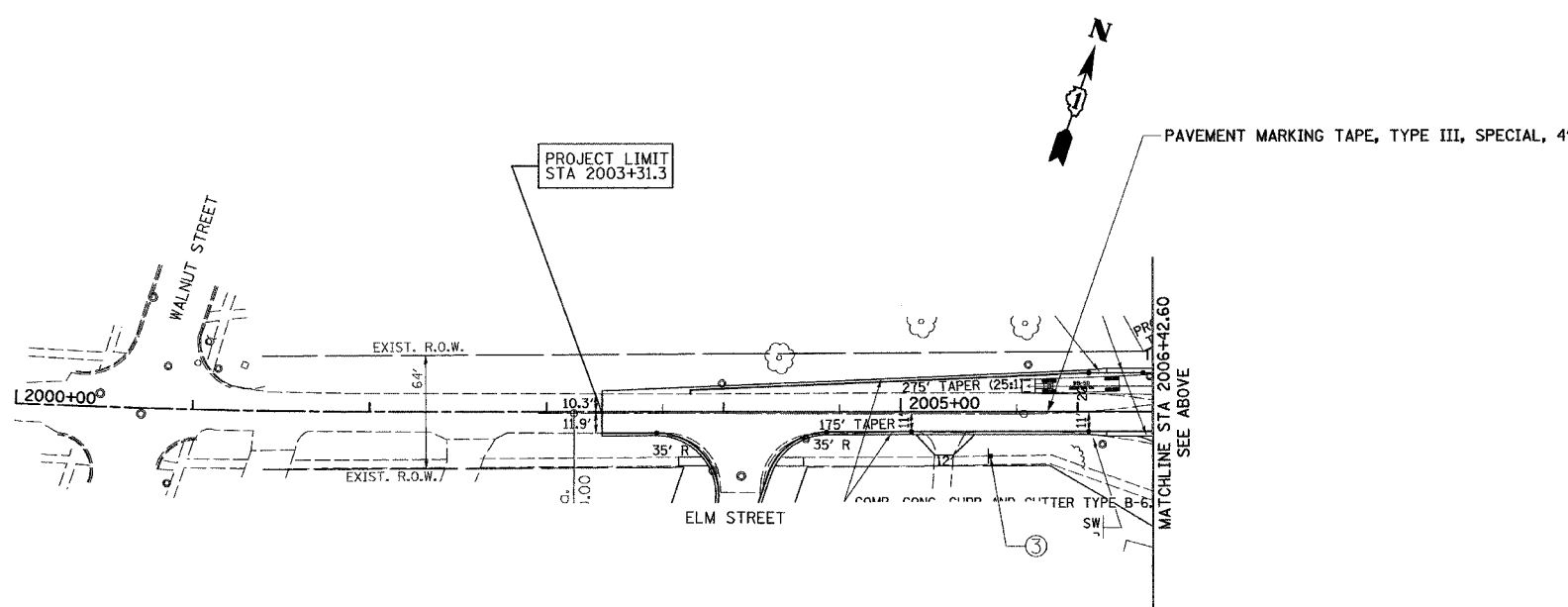
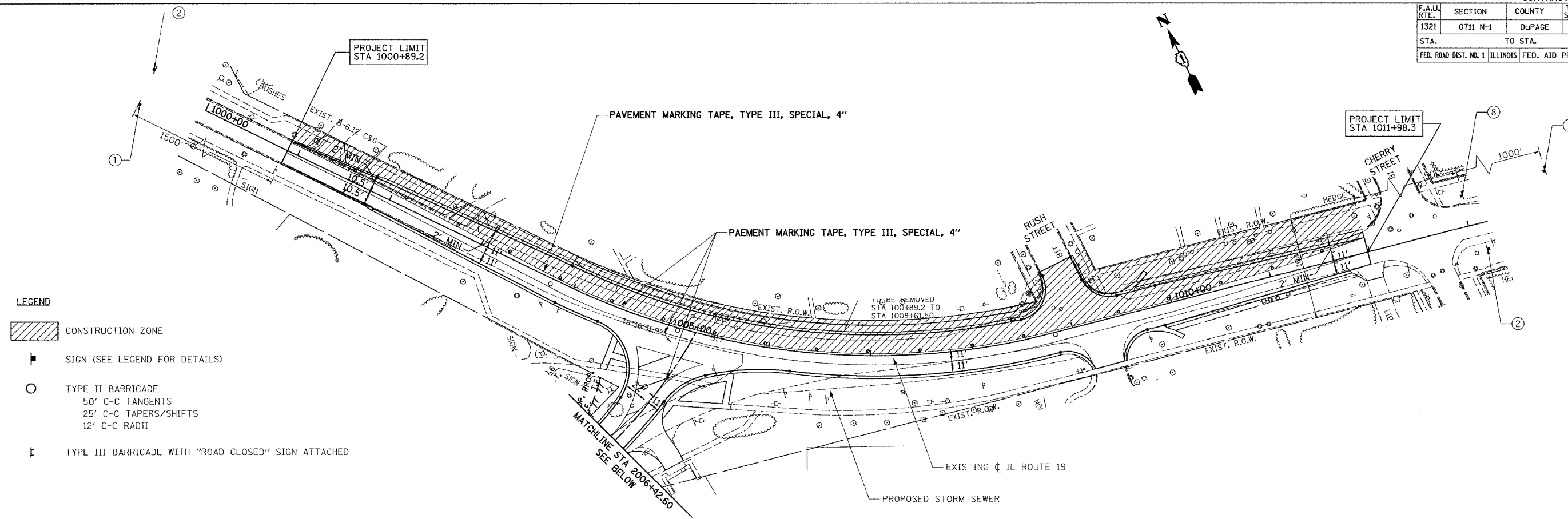

REVISIONS	
NAME	DATE

ILLINOIS DEPARTMENT OF TRANSPORTATION  
F.A.U. ROUTE 1321 (IL. ROUTE 19)

**MAINTENANCE OF TRAFFIC**

STAGE 2

SCALE: 1"=50'  
DATE 8/31/06

DRAWN BY ES  
CHECKED BY JJP

PLOT DATE = 8/31/06  
 FILE NAME = C:\PROJECTS\Bloomingsdale\Proposed\Plans\_Rev\Geom\DOT Concept\Plan\DOT Stage 2.dgn  
 PLOT SCALE = 1/8"=1'-0"  
 USER NAME = JJP