

F.A.U. RTE.	SECTION	COUNTY	TOTAL SHEETS	SHEET NO.
0177	01-00168-06-BT	LAKE	38	13
EROSION CONTROL PLAN				
FED. ROAD DIST. NO. 7 ILLINOIS FED. AID PROJECT HD-8003695				

## EROSION CONTROL PLAN & STORMWATER POLLUTION PREVENTION PLAN

THIS PROJECT DISTURBS 3.0 ACRES OF TOTAL LAND AREA. COMPLIANCE WITH THE NATIONAL POLLUTION DISCHARGE ELIMINATION SYSTEM (NPDES) STORMWATER PERMIT IS ONLY NECESSARY IF A PROJECT DISTURBS 1 OR MORE ACRES OF TOTAL LAND AREA; AN NPDES STORMWATER PERMIT WILL BE REQUIRED FOR THIS PROJECT.

**GRADING LIMITS**

STATION	LEFT OFFSET	RIGHT OFFSET
100+50	30.0	20.0
101+00	26.0	28.0
101+50	25.0	43.0
102+00	25.0	36.0
102+50	24.0	30.0
103+00	23.0	30.5
103+50	27.0	61.5
104+00	23.0	36.5
104+50	32.0	40.5
105+00	45.0	49.0
105+50	45.0	52.5
106+00	54.5	54.0
106+50	55.5	54.0
107+00	59.5	68.0
107+50	-	78.0
109+00	60.0	76.0
109+50	53.5	60.0
110+00	47.5	50.0
110+50	41.0	48.0
111+00	35.0	40.0
111+50	28.5	35.0
112+00	23.5	30.0
112+50	22.0	26.0
113+00	16.0	13.5
113+50	-	3.0

THE GRADING LIMITS ON MONAVILLE ROAD ARE THE PROPOSED RIGHT-OF-WAY LINES.

**STONE RIPRAP DETAIL**

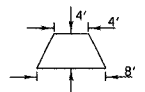

RIPRAP SHALL BE CLASS A2, 6" DEPTH

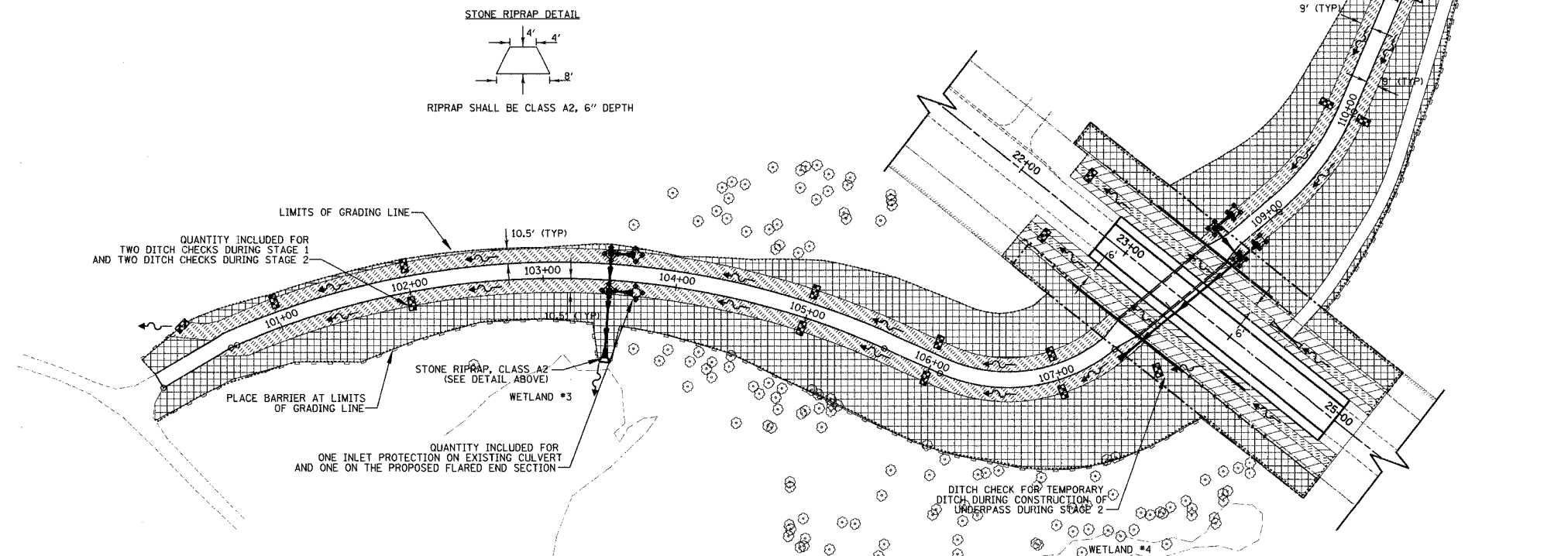

**DRAINAGE BASINS OF LAKE COUNTY**

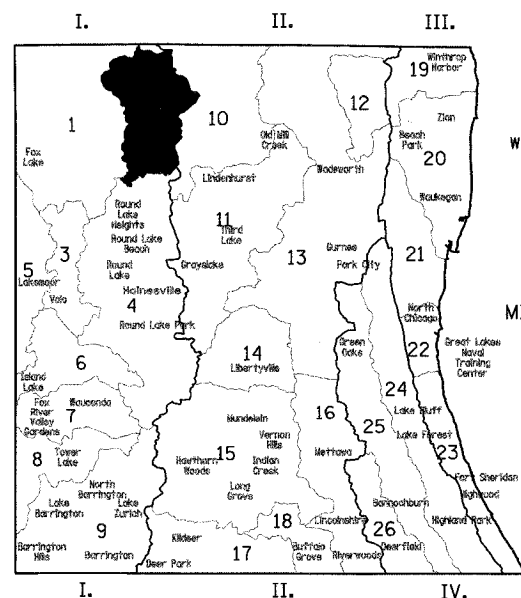

- I. FOX RIVER WATERSHED
  - 1. Upper Fox River
  - 2. Squall Creek
  - 3. Fish Lake Drain
  - 4. Squaw Creek
  - 5. Lower Fox River
  - 6. Mutton Creek
  - 7. Slocum Lake Drain
  - 8. Tower Lake Drain
  - 9. Flint Creek
- II. DES PLAINES RIVER WATERSHED
  - 10. North Mill Creek
  - 11. Mill Creek
  - 12. Newport Drainage Ditch
  - 13. Upper Des Plaines River
  - 14. Bull Creek
  - 15. Indian Creek
  - 16. Lower Des Plaines River
  - 17. Buffalo Creek
  - 18. Aptakela Creek
- III. LAKE MICHIGAN WATERSHED
  - 19. Kellogg Creek
  - 20. Dead River
  - 21. Waukegan River
  - 22. Pettibone Creek
  - 23. Bluff/Ravine
- IV. CHICAGO RIVER WATERSHED
  - 24. Skokie River
  - 25. Middle Fork
  - 26. West Fork

**GENERAL NOTES FOR SOIL EROSION CONTROL**

- 1.) PERIMETER EROSION BARRIER SHALL BE INSTALLED AT LOCATIONS SPECIFIED IN THE PLANS. AT 2 FEET OUTSIDE THE TOE OF SLOPE, OR INSIDE THE RIGHT-OF-WAY WHICHEVER IS CLOSER TO THE CENTERLINE, OR AS DIRECTED BY THE ENGINEER PRIOR TO THE START OF ANY EARTHWORK, CULVERT, OR STORM SEWER CONSTRUCTION.
  - 2.) THE PERIMETER EROSION BARRIER SHALL REMAIN IN PLACE UNTIL ALL DISTURBED AREAS HAVE BEEN STABILIZED WITH VEGETATION. AT THIS TIME, THE PERIMETER EROSION BARRIER SHALL BE REMOVED AND AREAS DAMAGED BY THE FENCE INSTALLATION RESTORED.
  - 3.) THE FENCE INSTALLATION, MAINTENANCE, REMOVAL AND THE RESTORATION OF THE AREA DISTURBED BY THE FENCE INSTALLATION IS INCLUDED IN THE PAY ITEM PERIMETER EROSION BARRIER.
  - 4.) TEMPORARY DITCH CHECK, URETHANE FOAM / GEOTEXTILE SHALL BE CONSTRUCTED AS PER STANDARD LC1005 ON 100 FOOT CENTERS AS SHOWN HEREON OR AS DIRECTED BY THE ENGINEER. THE DITCH CHECKS SHALL BE INSTALLED AS GRADING PROGRESSES THROUGH THE PROJECT.
  - 5.) THE PAY ITEM FOR TEMPORARY DITCH CHECK, URETHANE FOAM / GEOTEXTILE SHALL INCLUDE THE COST OF INSTALLATION.
  - 6.) THE AREAS DISTURBED DURING THE CONSTRUCTION OF THE TEMPORARY PATH DURING STAGE 1 SHALL BE RESTORED WITH TEMPORARY EROSION CONTROL SEEDING AND EROSION CONTROL BLANKET AS SHOWN ON THE TYPICAL SECTIONS.
- APPLICABLE STANDARDS, SPECIFICATIONS, AND SPECIAL PROVISIONS FOR EROSION AND SEDIMENT CONTROL
- STANDARDS  
LC1005 TRIANGULAR SILT DIKE INSTALLATION FOR ROADWAY DRAINAGE OR DRAINAGE DITCH  
280001 TEMPORARY EROSION CONTROL SYSTEMS
- SPECIAL PROVISIONS  
"EROSION CONTROL BLANKET"  
"INLET PROTECTION, SPECIAL"  
"PERIMETER EROSION BARRIER"

**LEGEND**

- PERIMETER EROSION BARRIER
- TEMPORARY DITCH CHECK, URETHANE FOAM / GEOTEXTILE
- INLET PROTECTION, SPECIAL
- STORM SEWER
- DITCH FLOW OR OUTFALL
- TOPSOIL, FURNISH AND PLACE 4" SODDING
- TOPSOIL, FURNISH AND PLACE 4" SEEDING, CLASS 4 EROSION CONTROL BLANKET
- TOPSOIL, FURNISH AND PLACE 4" SEEDING, CLASS 2 EROSION CONTROL BLANKET

**ESTIMATED QUANTITIES**

- 36 EACH TEMPORARY DITCH CHECKS, URETHANE FOAM / GEOTEXTILE
- 1,370 FEET PERIMETER EROSION BARRIER
- 9 EACH INLET PROTECTION, SPECIAL

REVISIONS	
NAME	DATE

ILLINOIS DEPARTMENT OF TRANSPORTATION  
MONAVILLE ROAD BIKE PATH UNDERPASS  
EROSION CONTROL PLAN

DESIGNED BY: D.J.K.  
CHECKED BY: J.R.V.  
DATE: 10/18/06