

F.A.S. RTE.	SECTION	COUNTY	TOTAL SHEETS	SHEET NO.
2796	(L,K)B	EFFINGHAM	35	9
STA.	TO STA.			
FED. ROAD DIST. NO.	ILLINOIS	FED. AID PROJECT		

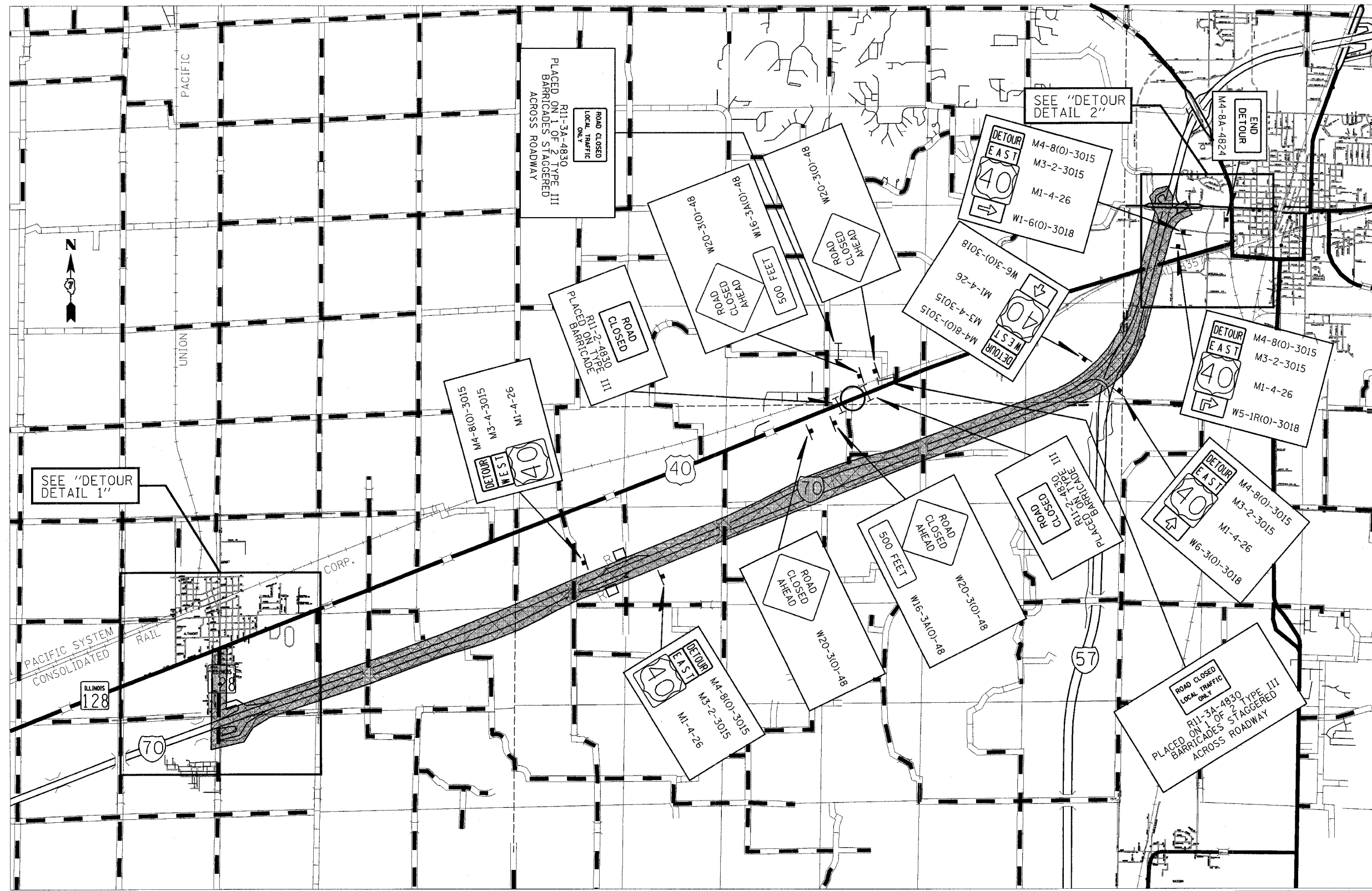

SEE "DETOUR
DETAIL 1"

SEE "DETOUR
DETAIL 2"

 **DETOUR ROUTE**

REVISIONS	
NAME	DATE

ILLINOIS DEPARTMENT OF TRANSPORTATION

DETOUR MAP

SCALE: VERT.
HORIZ.
DATE

DRAWN BY
CHECKED BY

PLOT DATE = 10/27/2006
FILE NAME = c:\proj\p06\94942\25\1002\p06.dgn
PLOT SCALE = 20,00000 / IN.
USER NAME = schferer, jr