

F.A.P. RTE.	SECTION	COUNTY	TOTAL SHEETS	SHEET NO.
331	3-2, 8X-1, 4-2	SALINE	233	61
STA.		TO STA.		
FED. ROAD DIST. NO.	ILLINOIS	FED. AID PROJECT		

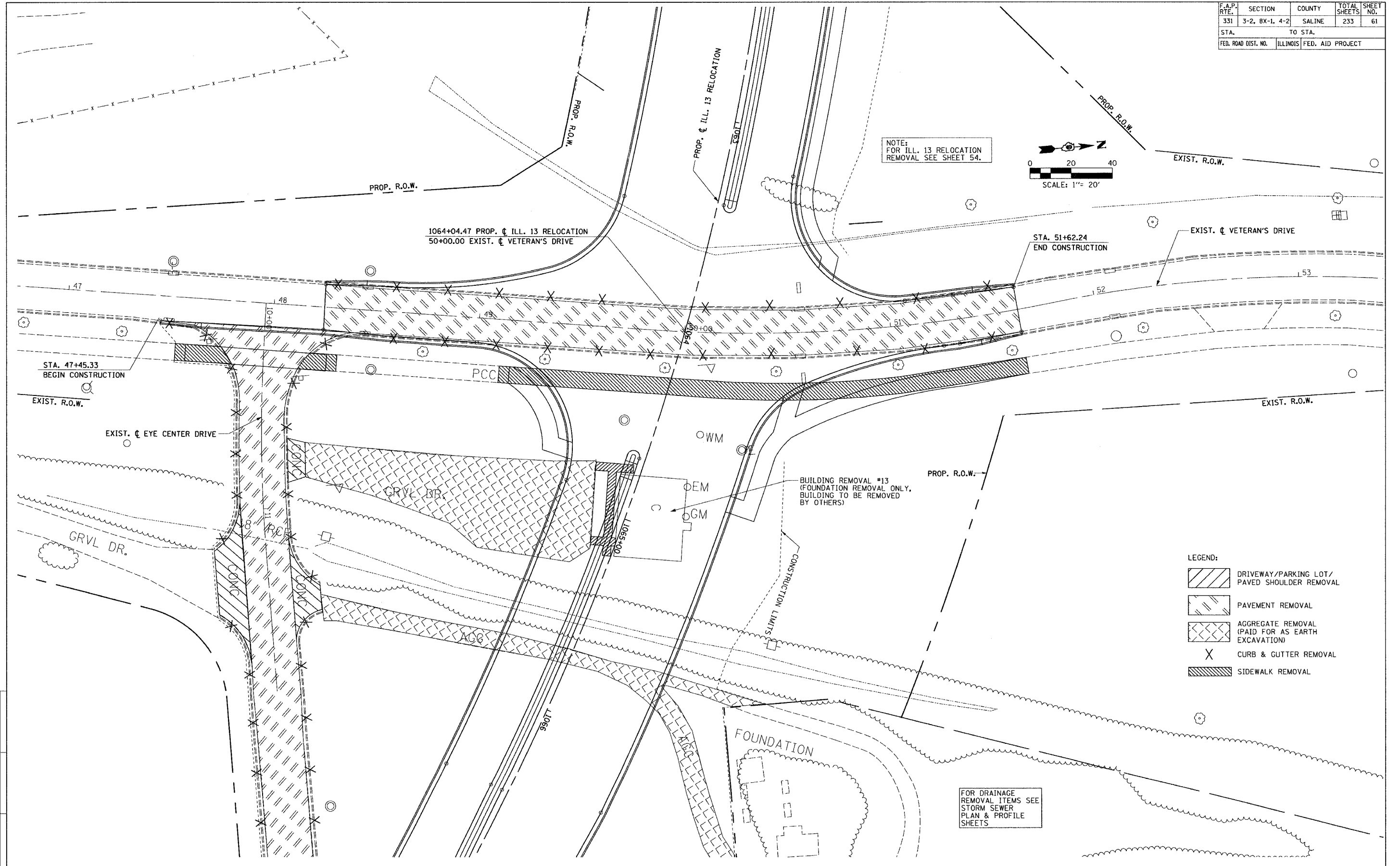

NOTE:
FOR ILL. 13 RELOCATION
REMOVAL SEE SHEET 54.

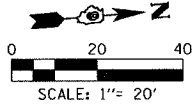

- LEGEND:
- DRIVEWAY/PARKING LOT/PAVED SHOULDER REMOVAL
 - PAVEMENT REMOVAL
 - AGGREGATE REMOVAL (PAID FOR AS EARTH EXCAVATION)
 - CURB & GUTTER REMOVAL
 - SIDEWALK REMOVAL

FOR DRAINAGE
REMOVAL ITEMS SEE
STORM SEWER
PLAN & PROFILE
SHEETS

DRAWN BY IS
CHECKED BY JS

NO.	PROJECTS/PROJISES/ROADWAY/CONTRACT I/STIPING/	DATE

REMOVAL PLAN - VETERAN'S DRIVE - STA. 47+45.33 TO STA. 51+62.24