

**RUNWAY THRESHOLD MARKING DETAIL**  
NOT TO SCALE

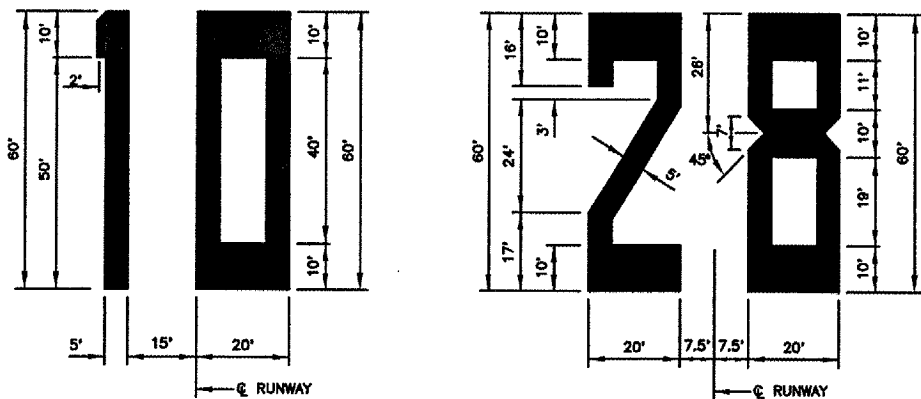
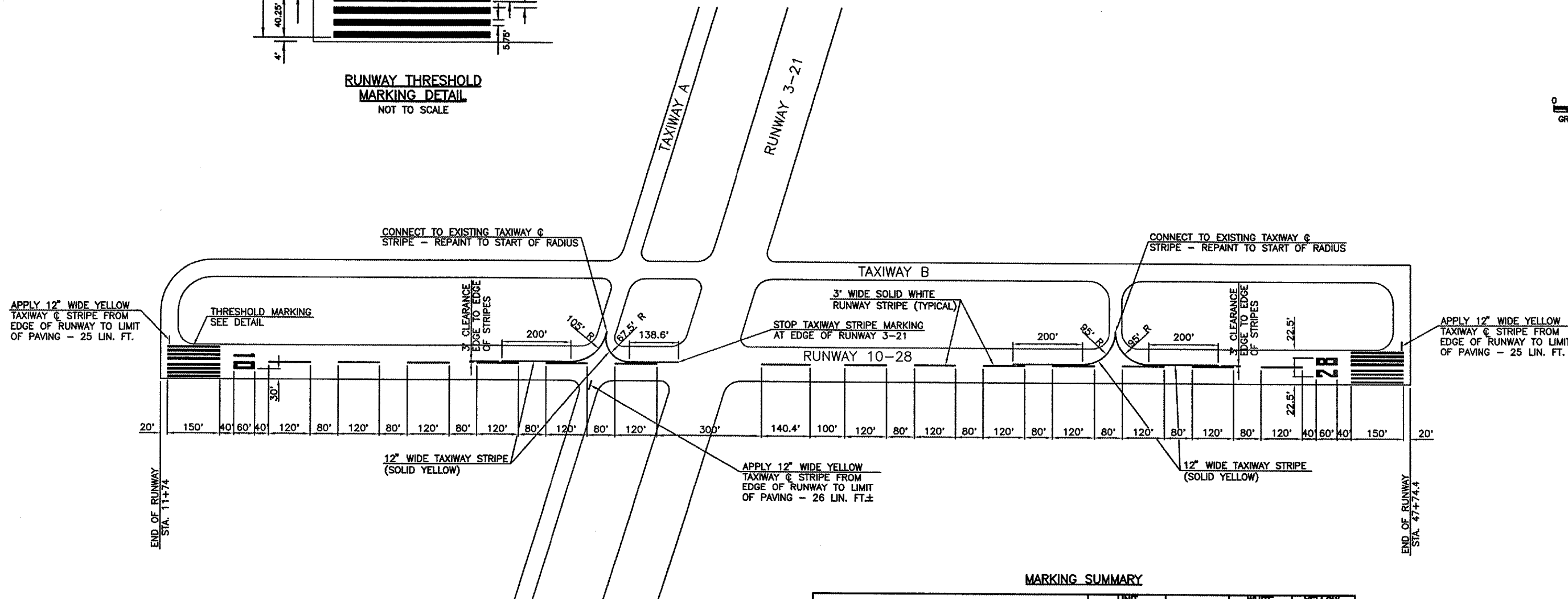

**NUMERAL DETAILS**  
NOT TO SCALE

**MARKING SUMMARY**

DESCRIPTION	UNIT AREA	NUMBER REQ'D	WHITE PAINT	YELLOW PAINT
	SQ. FT.		SQ. FT.	SQ. FT.
NUMERAL "0"	800	1	800	
NUMERAL "1"	318	1	318	
NUMERAL "2"	652	1	652	
NUMERAL "8"	876	1	876	
THRESHOLD MARKING	6,900	2	13,800	
RUNWAY CENTERLINE STRIPES (120' LONG)	360	13	4,680	
RUNWAY CENTERLINE STRIPES (140.4' LONG)	421	1	421	
TAXIWAY CENTERLINE STRIPES	1,373			1,373
<b>TOTALS</b>			<b>21,547</b>	<b>1,373</b>

**NOTES**

1. ALL RUNWAY MARKING SHALL BE SOLID MARKING AND WHITE IN COLOR.
2. ALL TAXIWAY MARKING SHALL BE SOLID MARKING AND YELLOW IN COLOR.
3. ALL PAVEMENT MARKING SHALL CONSIST OF TWO APPLICATIONS OF WATERBORNE PAINT AND ONE APPLICATION OF TYPE B GLASS BEADS (REFLECTIVE MEDIA). PAINT SHALL BE APPLIED AT THE RATE OF 115 SQ. FT./GAL. MAXIMUM PER APPLICATION. GLASS BEADS SHALL BE APPLIED AT THE RATE OF 7 LBS./GAL. MINIMUM.

GALESBURG MUNICIPAL AIRPORT  
GALESBURG, ILLINOIS

**MARKING LAYOUT**

HUTCHISON ENGINEERING, INC.  
JACKSONVILLE, ILLINOIS

DRAWN BY: T.J.D.      ILL. PROJ. NO. 090-3624  
DATE: NOVEMBER, 2006      AIP PROJ. NO. 3-17-0047-B9