

HA022

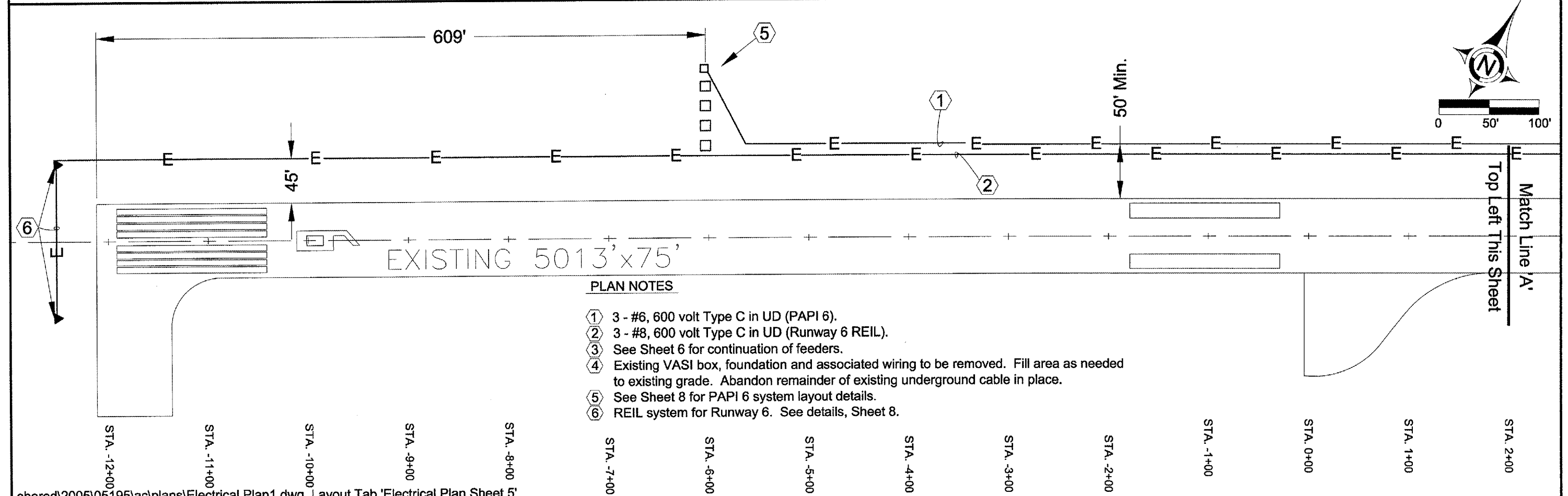
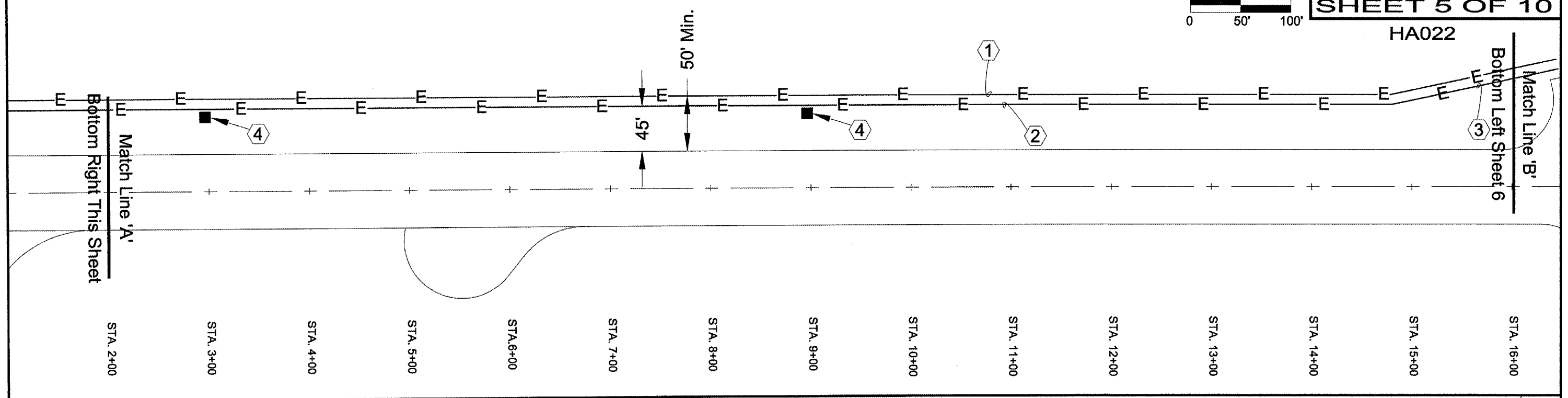

PLAN NOTES

- ① 3 - #6, 600 volt Type C in UD (PAPI 6).
- ② 3 - #8, 600 volt Type C in UD (Runway 6 REIL).
- ③ See Sheet 6 for continuation of feeders.
- ④ Existing VASI box, foundation and associated wiring to be removed. Fill area as needed to existing grade. Abandon remainder of existing underground cable in place.
- ⑤ See Sheet 8 for PAPI 6 system layout details.
- ⑥ REIL system for Runway 6. See details, Sheet 8.