

EROSION CONTROL

TEMPORARY EROSION CONTROL SEEDING AND PERMANENT SEEDING SHALL BE USED IN UNISON
TURF REINFORCEMENT MAT SHALL BE USED IN ALL DISTURBED AREAS

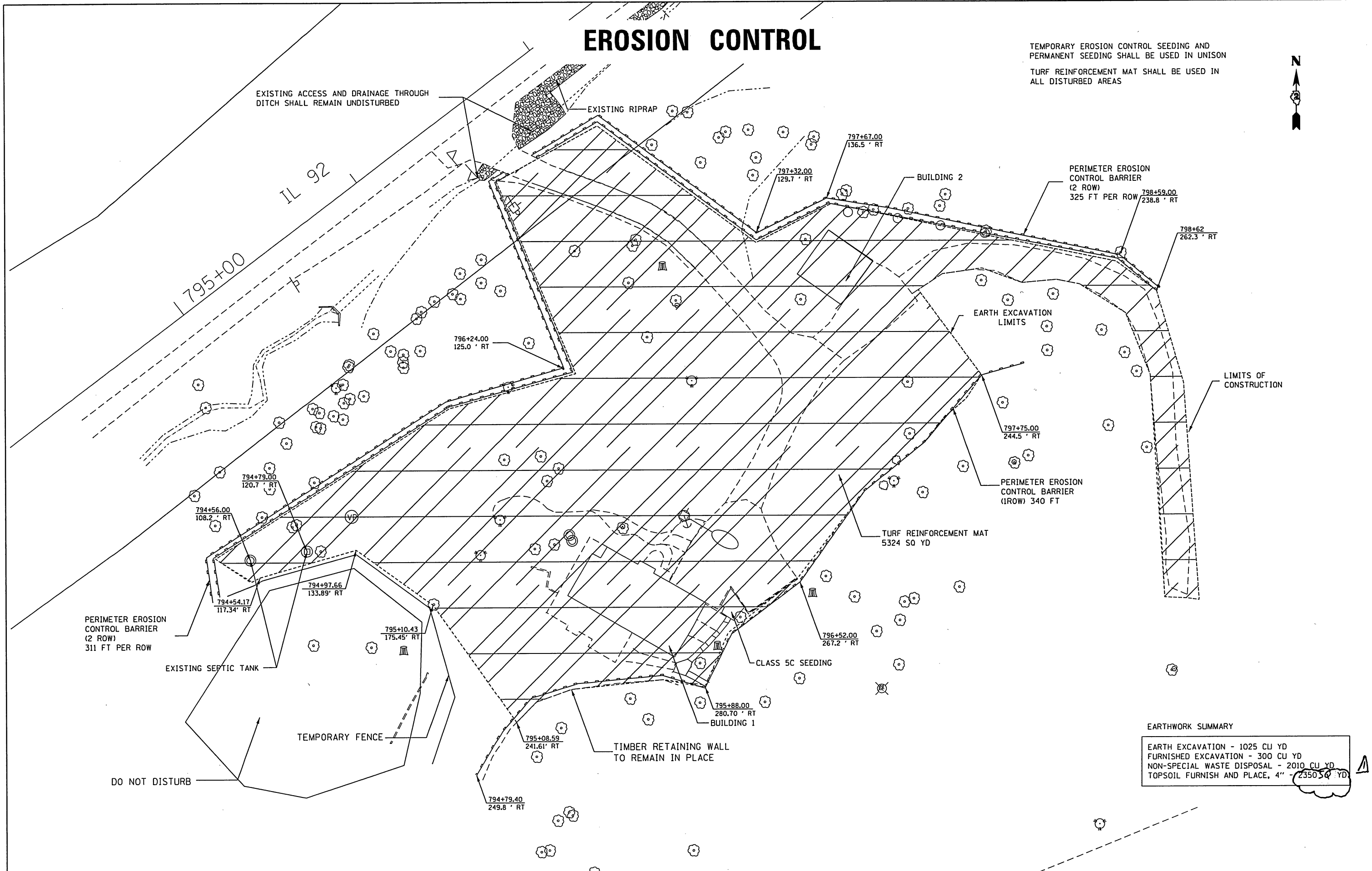

EARTHWORK SUMMARY

EARTH EXCAVATION - 1025 CU YD
FURNISHED EXCAVATION - 300 CU YD
NON-SPECIAL WASTE DISPOSAL - 2010 CU YD
TOPSOIL FURNISH AND PLACE, 4" - 2350 SQ YD

FILE NAME =	USER NAME = gouldm	DESIGNED -	REVISED -	STATE OF ILLINOIS DEPARTMENT OF TRANSPORTATION	EROSION CONTROL	F.A.P. RTE. 599	SECTION (B3MFT)DM	COUNTY ROCK ISLAND	TOTAL SHEETS 36	SHEET NO. 7	
CONTRACT NO. 64L35	CONTRACT NO. 64L35	CONTRACT NO. 64L35	CONTRACT NO. 64L35			CONTRACT NO. 64L35	CONTRACT NO. 64L35	CONTRACT NO. 64L35	CONTRACT NO. 64L35	CONTRACT NO. 64L35	CONTRACT NO. 64L35
SHEET OF SHEETS	STA. TO STA.	ILLINOIS FED. AID PROJECT	ILLINOIS FED. AID PROJECT			ILLINOIS FED. AID PROJECT	ILLINOIS FED. AID PROJECT	ILLINOIS FED. AID PROJECT	ILLINOIS FED. AID PROJECT	ILLINOIS FED. AID PROJECT	ILLINOIS FED. AID PROJECT
DATE	DATE	DATE	DATE			DATE	DATE	DATE	DATE	DATE	DATE