

N. MARYLAND ST

BEGIN IMPROVEMENTS
STA. 2000+04.24

TAP LOCATION
EX ROW

EX ROW

COMMERCIAL
ENTRANCE

MATCH LINE
STA. 2006+00

00+00

MILWAUKEE AVE

4" SCH80 PVC SLEEVE
30" MIN DEPTH (PUSHED)

2005+00

PERENNIAL PLANTING SCHEDULE

1	QTY	BOTANICAL NAME/ITEM	SPACING
	130	RUDBECKIA HIRTA "CHERRY BRANDY"	12" O.C.; MATCHED TO PLAN
	6	PENNISETUM ALOPECUROIDES 'HAMELN'	24" O.C.; MATCHED TO PLAN

2	QTY	BOTANICAL NAME/ITEM	SPACING
	78	RUDBECKIA FULGIDA 'GOLDSTURM'	12" O.C.; MATCHED TO PLAN
	6	PENNISETUM ALOPECUROIDES 'HAMELN'	24" O.C.; MATCHED TO PLAN

3	QTY	BOTANICAL NAME/ITEM	SPACING
	90	COREOPSIS 'JETHRO TULL'	12" O.C.; MATCHED TO PLAN
	9	PENNISETUM ALOPECUROIDES 'HAMELN'	24" O.C.; MATCHED TO PLAN

CONSTRUCTION NOTE:
IRRIGATION DESIGN IS BASED ON A STATIC
PRESSURE OF 50 PSI. IN THE EVENT
PRESSURE IS LESS, IMMEDIATELY BRING TO
THE ATTENTION OF THE ENGINEER PRIOR TO
INSTALLATION.

NOTE:
PIPING AND OTHER EQUIPMENT
SHOWN IN PAVED AREAS IS FOR
CLARITY ONLY. ALL PIPING SHOULD
RUN THRU LANDSCAPED AREAS.



LEGEND

- PERIMETER EROSION BARRIER
- TEMPORARY DITCH CHECK
- INLET FILTERS
- SODDING, SALT TOLERANT

CONSTRUCTION NOTE:
IRRIGATION DESIGN IS BASED ON A STATIC
PRESSURE OF 50 PSI. IN THE EVENT
PRESSURE IS LESS, IMMEDIATELY BRING TO
THE ATTENTION OF THE ENGINEER PRIOR TO
INSTALLATION.

NOTE:
PIPING AND OTHER EQUIPMENT
SHOWN IN PAVED AREAS IS FOR
CLARITY ONLY. ALL PIPING SHOULD
RUN THRU LANDSCAPED AREAS.

IRRIGATION NOTES

- 1" PGV SOLENOID VALVE INSTALLED IN VALVE BOX. ONE VALVE INSTALLED IN 10" ROUND BOX, THREE VALVES INSTALLED IN A STANDARD BOX
- CONTROLLER WITH A DUAL48M 2-WIRE MODULE INSTALLED INSIDE A STRONG BOX ENCLOSURE. 110-VOLT POWER INTO THE CONTROLLER SHALL BE INCLUDED IN THE COST OF IRRIGATION SYSTEM SPECIAL CONTROL WIRE SHALL BE ID1BLU CABLE WITH A 14-1 WIRE INSTALLED FOR LOCATING. DECODERS SHALL BE DUAL-1 OR DUAL-2 STATION DECODERS.
- DUAL-S. SURGE ARRESTOR. INSTALL WITH GROUND ROD PER MANUFACTURERS RECOMMENDATION.
- RAIN / WEATHER SENSOR LOCATION TO BE DETERMINED ONSITE
- 1" BACKFLOW PREVENTER WITH STRAINER INSTALLED WITH A 1" WATER METER IN A STRONG BOX ENCLOSURE. 1" TYPE K METERED WATER SERVICE SHALL BE INCLUDED IN THE COST OF IRRIGATION SYSTEM SPECIAL.
- 1" QUICK COUPLER. INSTALL PER DETAIL AND SUPPLY KEYS AND SWIVELS.
- 12" SPRAY HEAD WITH MPR NOZZLE
- POLYETHYLENE LATERAL PIPING. UNMARKED LINES ARE 1", SIZE REMAINING ACCORDING TO LABELS.
- 1 1/2" PVC MAINLINE PIPING

3000+00

MATCH LINE
STA. 2006+00

MILWAUKEE AVE

PERENNIAL PLANTING SCHEDULE

4	QTY	BOTANICAL NAME/ITEM	SPACING
	106	ECHINACEA 'HOT CORAL'	12" O.C.; MATCHED TO PLAN
	9	PENNISETUM ALOPECUROIDES 'HAMELN'	24" O.C.; MATCHED TO PLAN

5	QTY	BOTANICAL NAME/ITEM	SPACING
	90	RUDBECKIA HIRTA "CHERRY BRANDY"	12" O.C.; MATCHED TO PLAN
	9	PENNISETUM ALOPECUROIDES 'HAMELN'	24" O.C.; MATCHED TO PLAN

6	QTY	BOTANICAL NAME/ITEM	SPACING
	90	RUDBECKIA FULGIDA 'GOLDSTURM'	12" O.C.; MATCHED TO PLAN
	9	PENNISETUM ALOPECUROIDES 'HAMELN'	24" O.C.; MATCHED TO PLAN

7	QTY	BOTANICAL NAME/ITEM	SPACING
	90	COREOPSIS 'JETHRO TULL'	12" O.C.; MATCHED TO PLAN
	9	PENNISETUM ALOPECUROIDES 'HAMELN'	24" O.C.; MATCHED TO PLAN

8	QTY	BOTANICAL NAME/ITEM	SPACING
	90	ECHINACEA 'HOT CORAL'	12" O.C.; MATCHED TO PLAN
	9	PENNISETUM ALOPECUROIDES 'HAMELN'	24" O.C.; MATCHED TO PLAN

9	QTY	BOTANICAL NAME/ITEM	SPACING
	82	RUDBECKIA FULGIDA 'GOLDSTURM'	12" O.C.; MATCHED TO PLAN
	9	PENNISETUM ALOPECUROIDES 'HAMELN'	24" O.C.; MATCHED TO PLAN

3005+00

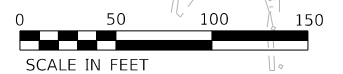

HRG PROJECT No. 200452
 HRG PROJ. CONTACT:
 FILE NAME: 200452-SHT-IRRS-CP-MIL-01.dgn
 PLOT DATE: 12/21/2023
 PEN TABLE: 100-Hatch.tbl



USER NAME = bhartma	DESIGNED - CW	REVISED - 12/21/2023
PLOT SCALE = 40.0000' / in.	DRAWN - W/JH	REVISED -
PLOT DATE = 12/21/2023	CHECKED - BDH	REVISED -
	DATE -	REVISED -

**STATE OF ILLINOIS
DEPARTMENT OF TRANSPORTATION**

**EROSION CONTROL AND LANDSCAPING PLAN
MILWAUKEE AVENUE**

SCALE: 1"=50' SHEET 1 OF 3 SHEETS STA. TO STA.

F.A. RTE.	SECTION	COUNTY	TOTAL SHEETS	SHEET NO.
VAR.	18-00131-00-SW	COOK	145	51
CONTRACT NO. 61174				
ILLINOIS FED. AID PROJECT				

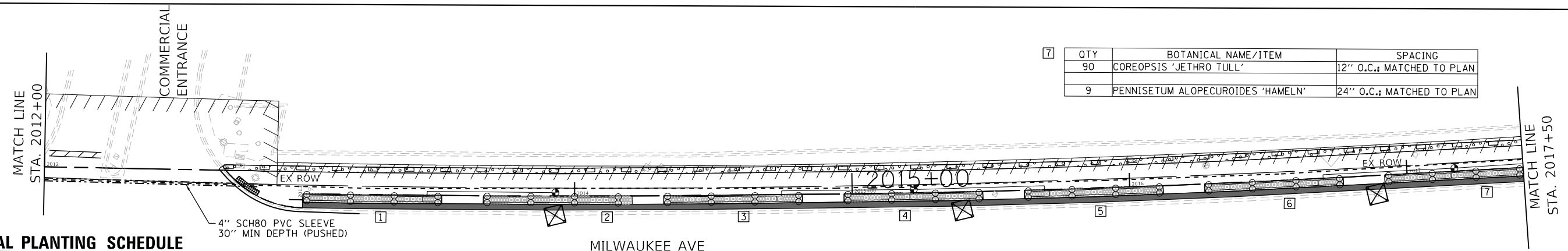

QTY	BOTANICAL NAME/ITEM	SPACING
90	COREOPSIS 'JETHRO TULL'	12" O.C.; MATCHED TO PLAN
9	PENNISETUM ALOPECUROIDES 'HAMELN'	24" O.C.; MATCHED TO PLAN

PERENNIAL PLANTING SCHEDULE

QTY	BOTANICAL NAME/ITEM	SPACING
90	RUDBECKIA HIRTA "CHERRY BRANDY"	12" O.C.; MATCHED TO PLAN
9	PENNISETUM ALOPECUROIDES 'HAMELN'	24" O.C.; MATCHED TO PLAN

QTY	BOTANICAL NAME/ITEM	SPACING
90	RUDBECKIA FULGIDA 'GOLDSTURM'	12" O.C.; MATCHED TO PLAN
9	PENNISETUM ALOPECUROIDES 'HAMELN'	24" O.C.; MATCHED TO PLAN

QTY	BOTANICAL NAME/ITEM	SPACING
90	COREOPSIS 'JETHRO TULL'	12" O.C.; MATCHED TO PLAN
9	PENNISETUM ALOPECUROIDES 'HAMELN'	24" O.C.; MATCHED TO PLAN

QTY	BOTANICAL NAME/ITEM	SPACING
90	ECHINACEA 'HOT CORAL'	12" O.C.; MATCHED TO PLAN
9	PENNISETUM ALOPECUROIDES 'HAMELN'	24" O.C.; MATCHED TO PLAN

QTY	BOTANICAL NAME/ITEM	SPACING
90	RUDBECKIA HIRTA "CHERRY BRANDY"	12" O.C.; MATCHED TO PLAN
9	PENNISETUM ALOPECUROIDES 'HAMELN'	24" O.C.; MATCHED TO PLAN

QTY	BOTANICAL NAME/ITEM	SPACING
90	RUDBECKIA FULGIDA 'GOLDSTURM'	12" O.C.; MATCHED TO PLAN
9	PENNISETUM ALOPECUROIDES 'HAMELN'	24" O.C.; MATCHED TO PLAN

CONSTRUCTION NOTE:
IRRIGATION DESIGN IS BASED ON A STATIC PRESSURE OF 50 PSI. IN THE EVENT PRESSURE IS LESS, IMMEDIATELY BRING TO THE ATTENTION OF THE ENGINEER PRIOR TO INSTALLATION.

NOTE:
PIPING AND OTHER EQUIPMENT SHOWN IN PAVED AREAS IS FOR CLARITY ONLY. ALL PIPING SHOULD RUN THRU LANDSCAPED AREAS.

IRRIGATION NOTES

- 1" PGV SOLENOID VALVE INSTALLED IN VALVE BOX. ONE VALVE INSTALLED IN 10" ROUND BOX, THREE VALVES INSTALLED IN A STANDARD BOX
- CONTROLLER WITH A DUAL48M 2-WIRE MODULE INSTALLED INSIDE A STRONG BOX ENCLOSURE. 110-VOLT POWER INTO THE CONTROLLER SHALL BE INCLUDED IN THE COST OF IRRIGATION SYSTEM SPECIAL CONTROL WIRE SHALL BE ID1BLU CABLE WITH A 14-1 WIRE INSTALLED FOR LOCATING. DECODERS SHALL BE DUAL-1 OR DUAL-2 STATION DECODERS.
- DUAL-S, SURGE ARRESTOR. INSTALL WITH GROUND ROD PER MANUFACTURERS RECOMMENDATION.
- RAIN / WEATHER SENSOR LOCATION TO BE DETERMINED ONSITE
- 1" BACKFLOW PREVENTER WITH STRAINER INSTALLED WITH A 1" WATER METER IN A STRONG BOX ENCLOSURE. 1" TYPE K METERED WATER SERVICE SHALL BE INCLUDED IN THE COST OF IRRIGATION SYSTEM SPECIAL.
- 1" QUICK COUPLER. INSTALL PER DETAIL AND SUPPLY KEYS AND SWIVELS.
- 12" SPRAY HEAD WITH MPR NOZZLE
- POLYETHYLENE LATERAL PIPING. UNMARKED LINES ARE 1", SIZE REMAINING ACCORDING TO LABELS.
- 1 1/2" PVC MAINLINE PIPING

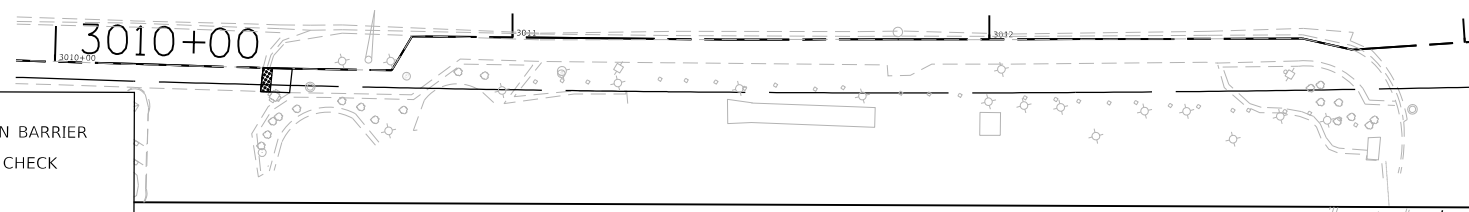

LEGEND

- PERIMETER EROSION BARRIER
- TEMPORARY DITCH CHECK
- INLET FILTERS
- SODDING, SALT TOLERANT

CONSTRUCTION NOTE:
IRRIGATION DESIGN IS BASED ON A STATIC PRESSURE OF 50 PSI. IN THE EVENT PRESSURE IS LESS, IMMEDIATELY BRING TO THE ATTENTION OF THE ENGINEER PRIOR TO INSTALLATION.

NOTE:
PIPING AND OTHER EQUIPMENT SHOWN IN PAVED AREAS IS FOR CLARITY ONLY. ALL PIPING SHOULD RUN THRU LANDSCAPED AREAS.

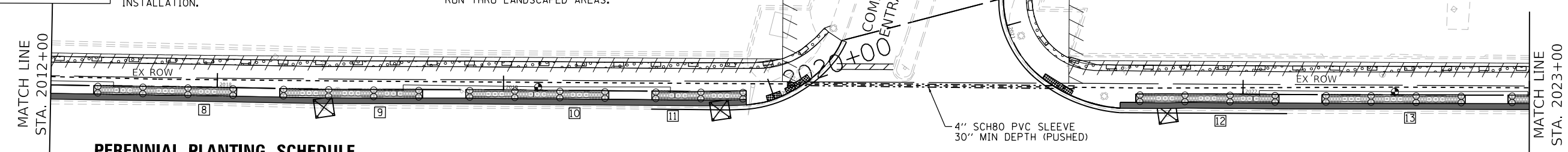

PERENNIAL PLANTING SCHEDULE

QTY	BOTANICAL NAME/ITEM	SPACING
90	ECHINACEA 'HOT CORAL'	12" O.C.; MATCHED TO PLAN
9	PENNISETUM ALOPECUROIDES 'HAMELN'	24" O.C.; MATCHED TO PLAN

QTY	BOTANICAL NAME/ITEM	SPACING
90	RUDBECKIA HIRTA "CHERRY BRANDY"	12" O.C.; MATCHED TO PLAN
9	PENNISETUM ALOPECUROIDES 'HAMELN'	24" O.C.; MATCHED TO PLAN

QTY	BOTANICAL NAME/ITEM	SPACING
90	RUDBECKIA FULGIDA 'GOLDSTURM'	12" O.C.; MATCHED TO PLAN
11	PENNISETUM ALOPECUROIDES 'HAMELN'	24" O.C.; MATCHED TO PLAN

QTY	BOTANICAL NAME/ITEM	SPACING
59	COREOPSIS 'JETHRO TULL'	12" O.C.; MATCHED TO PLAN
6	PENNISETUM ALOPECUROIDES 'HAMELN'	24" O.C.; MATCHED TO PLAN

QTY	BOTANICAL NAME/ITEM	SPACING
90	ECHINACEA 'HOT CORAL'	12" O.C.; MATCHED TO PLAN
9	PENNISETUM ALOPECUROIDES 'HAMELN'	24" O.C.; MATCHED TO PLAN

QTY	BOTANICAL NAME/ITEM	SPACING
90	RUDBECKIA HIRTA "CHERRY BRANDY"	12" O.C.; MATCHED TO PLAN
9	PENNISETUM ALOPECUROIDES 'HAMELN'	24" O.C.; MATCHED TO PLAN

HRG PROJECT NO.: 200452
 HRG PROJ. CONTACT:
 FILE NAME: 200452-shr-landscape-mil-02.dgn
 PLOT DRIVER: L...pdf...tbl...tbl
 PEN TABLE: plottable.tbl

	USER NAME = bhartma DESIGNED - CW DRAWN - WJH CHECKED - BDH PLOT DATE = 12/21/2023 DATE -	REVISED - 12/21/2023 REVISED - REVISED - REVISED -	STATE OF ILLINOIS DEPARTMENT OF TRANSPORTATION	EROSION CONTROL AND LANDSCAPING PLAN MILWAUKEE AVENUE	F.A. RTE. SECTION COUNTY TOTAL SHEETS SHEET NO. VAR. 18-00131-00-SW COOK 145 52	CONTRACT NO. 61174
	SCALE: 1"=50' SHEET 2 OF 3 SHEETS STA. TO STA.	ILLINOIS FED. AID PROJECT				

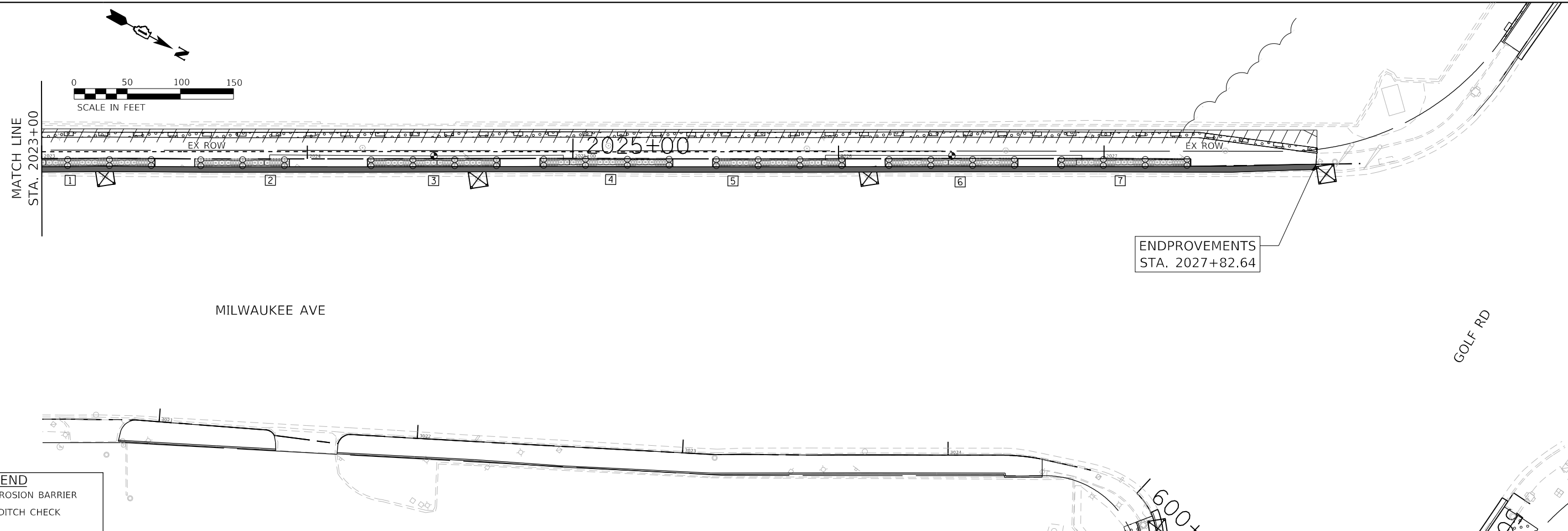

LEGEND

- PERIMETER EROSION BARRIER
- TEMPORARY DITCH CHECK
- INLET FILTERS
- SODDING, SALT TOLERANT

PERENNIAL PLANTING SCHEDULE

[]	QTY	BOTANICAL NAME/ITEM	SPACING
1	90	RUDBECKIA HIRTA "CHERRY BRANDY"	12" O.C.; MATCHED TO PLAN
	9	PENNISETUM ALOPECUROIDES 'HAMELN'	24" O.C.; MATCHED TO PLAN
2	66	RUDBECKIA FULGIDA 'GOLDSTURM'	12" O.C.; MATCHED TO PLAN
	6	PENNISETUM ALOPECUROIDES 'HAMELN'	24" O.C.; MATCHED TO PLAN
3	90	COREOPSIS 'JETHRO TULL'	12" O.C.; MATCHED TO PLAN
	9	PENNISETUM ALOPECUROIDES 'HAMELN'	24" O.C.; MATCHED TO PLAN
4	90	ECHINACEA 'HOT CORAL'	12" O.C.; MATCHED TO PLAN
	9	PENNISETUM ALOPECUROIDES 'HAMELN'	24" O.C.; MATCHED TO PLAN
5	90	RUDBECKIA HIRTA "CHERRY BRANDY"	12" O.C.; MATCHED TO PLAN
	9	PENNISETUM ALOPECUROIDES 'HAMELN'	24" O.C.; MATCHED TO PLAN
6	90	RUDBECKIA FULGIDA 'GOLDSTURM'	12" O.C.; MATCHED TO PLAN
	9	PENNISETUM ALOPECUROIDES 'HAMELN'	24" O.C.; MATCHED TO PLAN
7	90	COREOPSIS 'JETHRO TULL'	12" O.C.; MATCHED TO PLAN
	9	PENNISETUM ALOPECUROIDES 'HAMELN'	24" O.C.; MATCHED TO PLAN

IRRIGATION NOTES

- 1" PGV SOLENOID VALVE INSTALLED IN VALVE BOX. ONE VALVE INSTALLED IN 10" ROUND BOX, THREE VALVES INSTALLED IN A STANDARD BOX
- CONTROLLER WITH A DUAL48M 2-WIRE MODULE INSTALLED INSIDE A STRONG BOX ENCLOSURE. 110-VOLT POWER INTO THE CONTROLLER SHALL BE INCLUDED IN THE COST OF IRRIGATION SYSTEM SPECIAL CONTROL WIRE SHALL BE ID1BLU CABLE WITH A 14-1 WIRE INSTALLED FOR LOCATING. DECODERS SHALL BE DUAL-1 OR DUAL-2 STATION DECODERS.
- DUAL-S. SURGE ARRESTOR. INSTALL WITH GROUND ROD PER MANUFACTURERS RECOMMENDATION.
- RAIN / WEATHER SENSOR LOCATION TO BE DETERMINED ONSITE
- 1" BACKFLOW PREVENTER WITH STRAINER INSTALLED WITH A 1" WATER METER IN A STRONG BOX ENCLOSURE. 1" TYPE K METERED WATER SERVICE SHALL BE INCLUDED IN THE COST OF IRRIGATION SYSTEM SPECIAL.
- 1" QUICK COUPLER. INSTALL PER DETAIL AND SUPPLY KEYS AND SWIVELS.
- 12" SPRAY HEAD WITH MPR NOZZLE
- POLYETHYLENE LATERAL PIPING. UNMARKED LINES ARE 1", SIZE REMAINING ACCORDING TO LABELS.
- 1 1/2" PVC MAINLINE PIPING

CONSTRUCTION NOTE:
IRRIGATION DESIGN IS BASED ON A STATIC PRESSURE OF 50 PSI. IN THE EVENT PRESSURE IS LESS, IMMEDIATELY BRING TO THE ATTENTION OF THE ENGINEER PRIOR TO INSTALLATION.

NOTE:
PIPING AND OTHER EQUIPMENT SHOWN IN PAVED AREAS IS FOR CLARITY ONLY. ALL PIPING SHOULD RUN THRU LANDSCAPED AREAS.

HRG PROJECT No: 200452
 HRG PROJ CONTACT:
 FILE NAME: 200452-shr-irrig-scp-Mil-03.dgn
 PEN TABLE: 1/10/2023



USER NAME = bhartma	DESIGNED - CW	REVISED - 12/21/2023
PLOT SCALE = 40.0000' / in.	DRAWN - WJH	REVISED -
PLOT DATE = 12/21/2023	CHECKED - BDH	REVISED -
	DATE -	REVISED -

**STATE OF ILLINOIS
DEPARTMENT OF TRANSPORTATION**

EROSION CONTROL AND LANDSCAPING PLAN		
MILWAUKEE AVENUE		
SCALE: 1"=50'	SHEET 2 OF 3 SHEETS	STA. TO STA.

F.A. RTE.	SECTION	COUNTY	TOTAL SHEETS	SHEET NO.
VAR.	18-00131-00-SW	COOK	145	53
CONTRACT NO. 61174				
ILLINOIS FED. AID PROJECT				