

F.A.I. 80/94 (KINGERY EXPRESSWAY) BORING LOCATION ILLINOIS DEPARTMENT OF TRANSPORTATION, COOK COUNTY	F.A.I. RTE. 80/94	SECTION *	COUNTY COOK	TOTAL SHEETS 631	SHEET NO. 108
DATE: 7/18/2005 SCALE: 1"=100'	DESIGNED BY: LL	STA. TO STA.	TO STA.	FED. ROAD DIST. NO. ILLINOIS (2425 & 2626) R-2	FED. AID PROJECT CONTRACT NO. 62111
Wang Engineering, Inc. 1145 Mich Street Lombard, IL 60148 Geo-Environmental Engineers 630-953-9928 BASED ON DRAWINGS PREPARED BY TENG & ASSOCIATES 255-08-04					

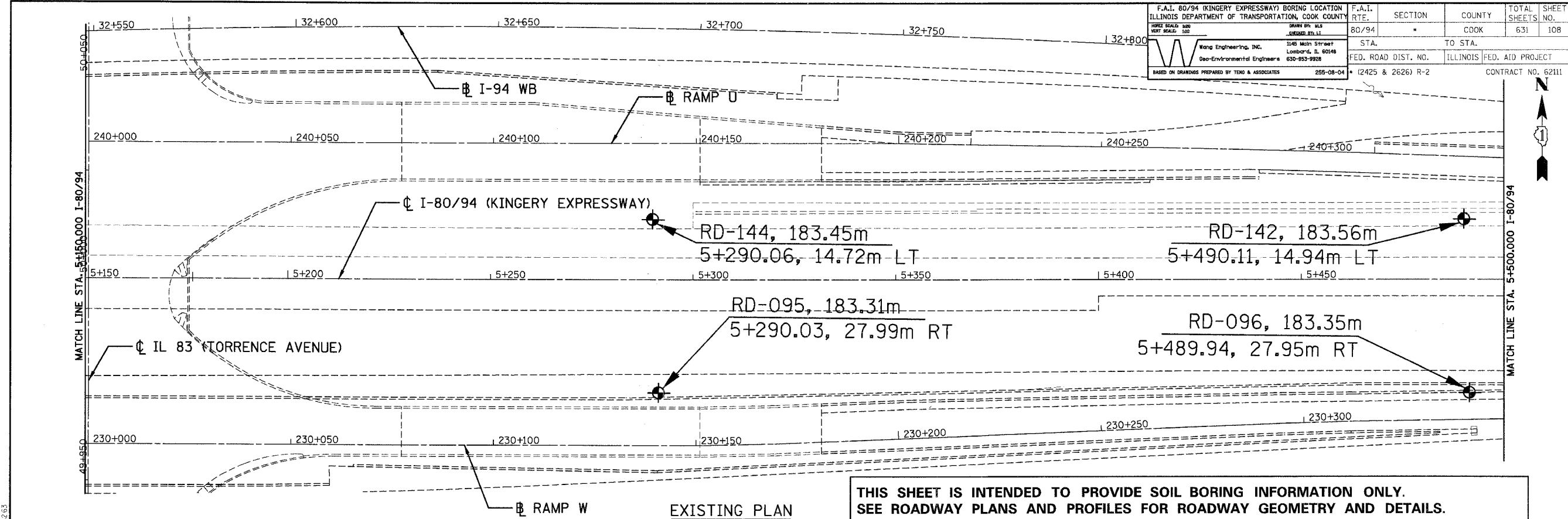

THIS SHEET IS INTENDED TO PROVIDE SOIL BORING INFORMATION ONLY.
SEE ROADWAY PLANS AND PROFILES FOR ROADWAY GEOMETRY AND DETAILS.

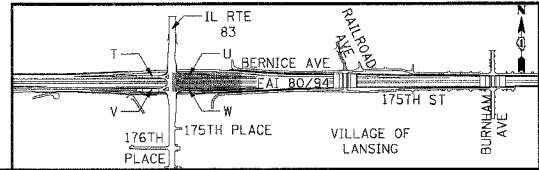
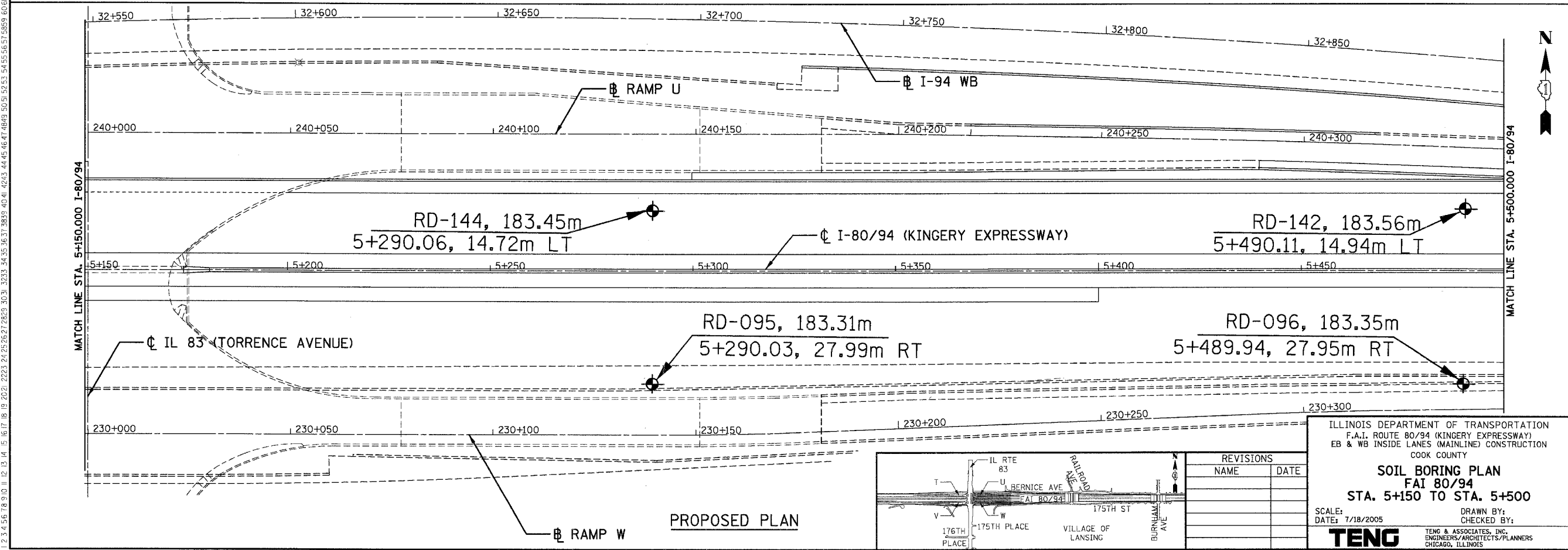

REVISIONS	
NAME	DATE

ILLINOIS DEPARTMENT OF TRANSPORTATION
F.A.I. ROUTE 80/94 (KINGERY EXPRESSWAY)
EB & WB INSIDE LANES (MAINLINE) CONSTRUCTION
COOK COUNTY

SOIL BORING PLAN
FAI 80/94
STA. 5+150 TO STA. 5+500

SCALE: DATE: 7/18/2005
DRAWN BY: CHECKED BY:

TENG
TENG & ASSOCIATES, INC.
ENGINEERS/ARCHITECTS/PLANNERS
CHICAGO, ILLINOIS

I:\REL\5500.DGN, ..\AB99002A.DGN
 7-12-2005, 10:34:33
 1,2,3,4,5,6,7,8,9,10,11,12,13,14,15,16,17,18,19,20,21,22,23,24,25,26,27,28,29,30,31,32,33,34,35,36,37,38,39,40,41,42,43,44,45,46,47,48,49,50,51,52,53,54,55,56,57,58,59,60,61,62,63